

(ATTACH #1, EMERGENCY PROCEDURE NO. 2)

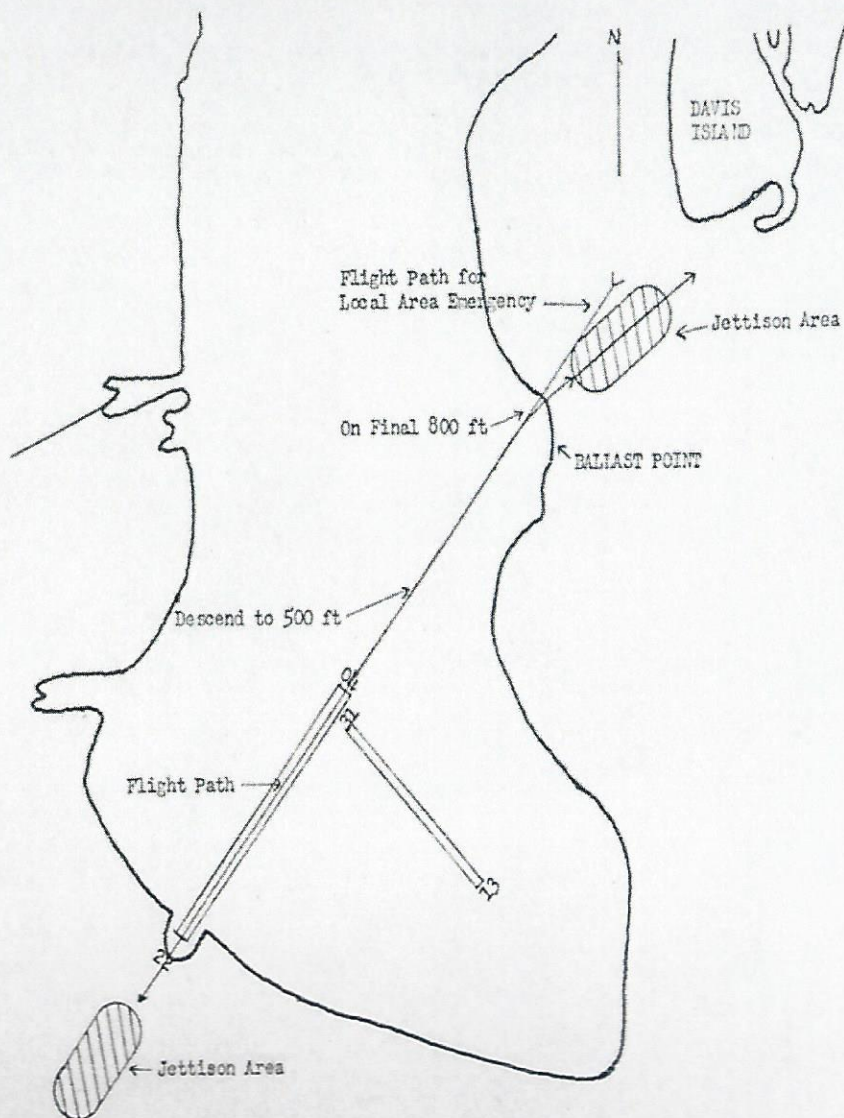

PROCEDURES FOR USE OF JETTISON AREA
FOR INFIGHT EMERGENCY IN LOCAL AREA

1. Obtain tower clearance.
2. Utilize standard pattern for Runway 22.
3. Do not descend below 500 feet.
4. Clear Jettison Area prior to release.

APP 3 to
Annex "A"

PROCEDURES FOR USE OF JETTISON AREAS
FOR EMP LAUNCH

1. For Runway 22: Count 13 seconds after passing end of runway.
2. For Runway 04: Count 50 seconds after passing end of runway.
3. Can be used both VFR and IFR.
4. Clear Jettison Area visually, if possible, prior to release.
5. Tower will confirm rack salvo, if possible.

~~SECRET~~

HEADQUARTERS 6TH AIR DIVISION
MACDILL AIR FORCE BASE, FLORIDA
15 September 1958

ANNEX "B"

TO

OPERATIONS ORDER

SERIAL NO. 25-58

COMMUNICATIONS-ELECTRONICS

Annex "B" to
6AD Order 25-58
15 Sep 58

~~SECRET~~

~~SECRET~~

HEADQUARTERS 6TH AIR DIVISION
MACDYLL AIR FORCE BASE, FLORIDA
15 September 1958

ANNEX "B"

TO

OPERATIONS ORDER

SERIAL NO. 25-58

COMMUNICATIONS-ELECTRONICS

1. COMMUNICATIONS:

- a. GENERAL: Procedures for this Operations Order will be in accordance with SAC CEI, CEES, 100 Series Manuals and Regulations except as amended herein. /U/
- b. EMERGENCY COMMUNICATIONS:
 - (1) Emergency communications will be in accordance with appropriate Radio Facility Charts and SFIDs. /U/
 - (2) HF - The best frequencies for HF contact in emergency are those USAF air/ground frequencies listed in monitor procedure Alfa. If time does not permit use of these frequencies, select emergency HF channel and turn emergency keying unit on. If contact can be established on UHF, the HF radio will not be used for this purpose. /S/
 - (3) UHF - Contact any station on 243.0 mcs, GCI, Tower, DF, airways, etc. /U/
 - (4) IFF - Turn IFF on emergency. /S/
 - (5) Aircraft may communicate with any station, air or ground in case of emergency; however, consideration should be given to security of the operation, safety of crew, location of aircraft, and other relative factors.

Annex "A" to
GAD OOrder 25-58
15 Sep 58

~~SECRET~~

SECRET

c. AUTHENTICATION, RECOGNITION AND IFF.

- (1) Authentication: All air/ground and air/air tactical radio calls will be authenticated using current editions of the KAC-1()/TSEC (to be replaced by KAC-26()/TSEC). /U/
- (2) Recognition: Challenge and reply authentication using current edition of KAC-1 (KAC-26). ~~TC~~
- (3) Identification: IFF on Mode 2 while within the outbound control line. IFF off outside the outbound control line. ~~TS~~

d. FREQUENCIES: HF and UHF channelization in accordance with current wing directives.

e. CALL SIGNS:

- (1) Air/Air - Assigned basic aircraft tactical call sign expanded by the use of colors to denote cells or flights, as required. Numerical suffixes authorized in SAC Manual 100-1 will be used in air refueling rendezvous. ~~TS~~
Example: 305 EW - Sunfish Purple 1
306 EW - Foxy Silver 1
- (2) Air/Ground - For HF, UHF and UHF air/ground communications, aircraft call signs will be in accordance with current SAC Manual 100-51 series, as applicable. Route designators, color designators and numerical suffixes will be used in communication with Air Traffic Control stations for identification of the flight.
Example: "Jax Center, this is Foxy Silver 1, flying Battle Cry primary route"
"Jax Center, this is Sunfish Purple 1, flying Battle Cry primary route"

~~SECRET~~

f. MISSION PROCEDURES:

- (1) Monitor procedure Alfa will be strictly adhered to on this mission. Monitor frequencies are as follows:
 - (a) Sunrise to sunset - 11228 kcs.
 - (b) Sunset to sunrise - 6730.5 kcs.
- (2) Positive Control Procedures: Positive control procedures will be passed to aircraft by HF Foxtrot broadcast through USAF StatCom air/ground station. In the event the go code is not received by the time the aircraft passes its last point of UHF contact prior to reaching its "positive Control" point, Aircraft Commander may request the "GO" code on UHF from the ground installation specified in the SAC CEI. (Reference applicable Unit 50-59 Plan.)
- (3) Air Traffic Control Procedures: All required civil reporting procedures will be complied with wherein it is possible to establish contact on UHF. The HF radio transmitter will not be used except in emergency.
- (4) Scene of Action Communications: The following frequencies will be used to establish communications with friendly forces at the combat scene of action where circumstances preclude prior agreement of a communication plan.
 - (a) 279.4 mcs - UHF.
 - (b) 116.1 mcs - VHF (Omni)
- (5) Strike reports will be submitted as soon as possible after bombs away via HF to Croughton Awys, primary; Torrejon Awys, secondary, or Lajes Awys tertiary on the appropriate HF

SECRET

frequencies for day or night. ~~/U/~~

(6) Air Refueling: In accordance with SAC Manual 100-1, 306th Bomb Wing will use ZI Alpha Ann CR Plan, 306th Bomb Wing will use ZI Alpha Dixie CR Plan. /U/

(7) Recall Procedures: There will be no recall for positive control alert forces. ~~/U/~~

8. AIR RESCUE COMMUNICATIONS:

(1) Frequencies.

(a) UHF - 243.0

(b) HF - Appropriate HF USAF air/ground frequencies. The emergency frequency 8364.0 kcs is to be used as a last resort because only a few stations monitor this frequency on a receive only basis. /U/

2. ELECTRONICS:

a. Every effort will be made by crews participating in this mission to complete a sweep jamming run against ADC Radar Site "SHEEPMAN" located at Tampa, Florida. /U/

b. This run will be attempted on the return leg of either primary or alternate route, and will be in accordance with AFR 55-44. Site availability will be determined by 2AF Sup-1 to AFR 55-44, dated 25 August 1958. Either multiple or single aircraft runs may be made. /U/

c. Under no circumstances will chaff be dispensed on this mission. /U/

d. Sweep jamming activity against "SHEEPMAN" will be logged on 2AF F8.

SACR 51-26 and 50-8 credit will be given. /U/

Annex "B" to
6AD OOrder 25-58
15 Sep 58

SECRET

~~SECRET~~

HEADQUARTERS 6TH AIR DIVISION
MACDILL AIR FORCE BASE, FLORIDA
15 September 1958

APPENDIX 1

TO

ANNEX "B"

OPERATIONS ORDER

SERIAL NO. 25-58

SAC FORM 100'S

App 1 to
Annex "B"
6AD Order 25-58
15 Sep 58

~~SECRET~~

SECRET (When Filled In)

COMMUNICATIONS RECAP SHEET		UNIT	AIR FORCE	HOME BASE	UNIT CALL SIGN	MOY/ASST CALL SIGN	ROUTE	PAGE NO	REF. NO.																																																																																																																																																																																																																																																																																																																				
		3050W	ZAF	MacDill AFB, Florida	*	*	311.0	1																																																																																																																																																																																																																																																																																																																					
<table border="1"> <thead> <tr> <th colspan="6">ENROUTE AIR/GROUND FACILITIES</th> <th colspan="6">CIVIL/TACTICAL REPORTING</th> <th colspan="2">US AIR PROCEDURES</th> </tr> <tr> <th>LOCATION</th> <th>CALL SIGN</th> <th>FREQ</th> <th>LOCATION</th> <th>CALL SIGN</th> <th>FREQ</th> <th>POSITION</th> <th>CTA</th> <th>CONTACT</th> <th>FREQ</th> <th>TYPE</th> <th>RELAY TO</th> <th>AREA</th> <th>LEVEL</th> </tr> </thead> <tbody> <tr> <td>HOOBY AFB, FLA</td> <td>*</td> <td>9 311.0</td> <td>HOOBY</td> <td>HOOBY TOWER</td> <td>1 236.6</td> <td>CLIDE CUT</td> <td></td> <td>MIAMI CENTER</td> <td>351.9</td> <td>POSITION</td> <td>ADC</td> <td>US</td> <td>2</td> </tr> <tr> <td>HUNTER AFB, GA</td> <td>* (280) * (307W)</td> <td>9 311.0 9 321.0</td> <td>HUNTER</td> <td>HUNTER TOWER</td> <td>2 236.6</td> <td>ABEAM JACKSONVILLE, FLA</td> <td></td> <td>JACKSONVILLE FLA</td> <td>379.9</td> <td>POSITION REPORT</td> <td></td> <td>US</td> <td>2</td> </tr> <tr> <td>FLATDUNN AFB, TX</td> <td>* (380W)</td> <td>9 311.0</td> <td>MIDDLE BEACH</td> <td>MIDDLE BEACH APC</td> <td>3 363.8</td> <td>ABEAM MIDDLE BEACH S E</td> <td></td> <td>MIDDLE BEACH RADIO</td> <td>5 255.4</td> <td>POSITION REPORT</td> <td>JAI CENTER</td> <td>US</td> <td>2</td> </tr> <tr> <td>WRIGHT AFB, MISS</td> <td>* (997W)</td> <td>9 311.0</td> <td>LANLEY</td> <td>LANLEY TOWER</td> <td>1 236.6</td> <td>ABEAM CAPE MAYAS MC</td> <td></td> <td>MORFOLD CENTER</td> <td>343.0</td> <td>POSITION REPORT</td> <td>ADC</td> <td>US</td> <td>2</td> </tr> <tr> <td>FRASE AFB, N H</td> <td>* (100TH)</td> <td>9 311.0</td> <td>PORTSMOUTH</td> <td>PORTSMOUTH TOWER</td> <td>2 236.6</td> <td>ABEAM ATLANTIC CITY N J</td> <td></td> <td>NEW YORK CENTER</td> <td>317.6</td> <td>POSITION</td> <td></td> <td>US</td> <td>2</td> </tr> <tr> <td>DOW AFB, ME</td> <td>* (343W) * (406TH)</td> <td>9 311.0</td> <td>LORING</td> <td>LORING APC</td> <td>4 363.8</td> <td>ABEAM NANTUCKET VOR</td> <td></td> <td>BOSTON CENTER</td> <td>352.0</td> <td>POSITION</td> <td></td> <td>US</td> <td>2</td> </tr> <tr> <td>LORING AFB, ME</td> <td>* (42ND)</td> <td>9 311.0</td> <td>ERNEST HUMPH</td> <td>HUMPH APC</td> <td>5 363.8</td> <td>ABEAM AUGUSTA VOR</td> <td></td> <td>YARMOUTH RADIO</td> <td>5 255.4</td> <td>POSITION REPORT</td> <td>MONCTON CENTER</td> <td>US</td> <td>2</td> </tr> <tr> <td>GOOSE BAY AB, LAE</td> <td>*</td> <td>9 311.0</td> <td>GOOSE</td> <td>GOOSE APC</td> <td>1 363.8</td> <td>ABEAM GREENWOOD RING NZ</td> <td></td> <td>MONCTON CENTER</td> <td>6 301.4</td> <td>POSITION</td> <td></td> <td>CANADA</td> <td>*</td> </tr> <tr> <td>ERNEST HUMPH AP</td> <td>*</td> <td>9 311.0</td> <td>OTHER</td> <td></td> <td></td> <td>HAGALEN ISLAND</td> <td></td> <td>MONCTON CENTER</td> <td>6 301.4</td> <td>POSITION REPORT</td> <td>GANDER CENTER</td> <td>CANADA</td> <td>2</td> </tr> <tr> <td></td> <td></td> <td></td> <td></td> <td></td> <td></td> <td>ABEAM STEPHENVILLE RING, NF</td> <td></td> <td>ERNEST HUMPH APC</td> <td>4 363.8</td> <td>POSITION REPORT</td> <td>GANDER CENTER</td> <td>NF</td> <td>2</td> </tr> <tr> <td></td> <td></td> <td></td> <td></td> <td></td> <td></td> <td>ABEAM ST ANTHONY RHW</td> <td></td> <td>ST ANTHONY RADIO</td> <td>10 364.2</td> <td>POSITION REPORT</td> <td>GANDER CENTER</td> <td>NF</td> <td>2</td> </tr> <tr> <td></td> <td></td> <td></td> <td></td> <td></td> <td></td> <td>AT 53-44N 51-27W</td> <td></td> <td>ST ANTHONY RADIO</td> <td>10 364.2</td> <td>POSITION REPORT</td> <td>GANDER CENTER</td> <td></td> <td></td> </tr> <tr> <td></td> <td></td> <td></td> <td></td> <td></td> <td></td> <td>DEPARTING OUT-BOUND CONTROL LINE</td> <td></td> <td></td> <td></td> <td></td> <td></td> <td>IFF OFF</td> <td></td> </tr> <tr> <td></td> <td></td> <td></td> <td></td> <td></td> <td></td> <td>ENTERING OUT-BOUND CONTROL LINE</td> <td></td> <td></td> <td></td> <td></td> <td></td> <td>IFF ON 2</td> <td></td> </tr> <tr> <td></td> <td></td> <td></td> <td></td> <td></td> <td></td> <td>NOTE: RETURN ROUTE RECIPROCAL OF OUTBOUND ROUTE TO TRAIT INTERSECTION</td> <td></td> <td></td> <td></td> <td></td> <td></td> <td></td> <td></td> </tr> <tr> <td></td> <td></td> <td></td> <td></td> <td></td> <td></td> <td>* IN ACCORDANCE WITH CURRENT SAC MANUAL 100-51 SERIES.</td> <td></td> <td></td> <td></td> <td></td> <td></td> <td></td> <td></td> </tr> <tr> <td></td> <td></td> <td></td> <td></td> <td></td> <td></td> <td>TRAIT INTERSECTION</td> <td></td> <td>JACKSONVILLE CENTER</td> <td>379.9</td> <td>POSITION</td> <td>ADC</td> <td>US</td> <td>2</td> </tr> <tr> <td></td> <td></td> <td></td> <td></td> <td></td> <td></td> <td>GATEWAY</td> <td></td> <td>JACKSONVILLE CENTER</td> <td>379.9</td> <td>POSITION</td> <td></td> <td>US</td> <td>2</td> </tr> <tr> <td></td> <td></td> <td></td> <td></td> <td></td> <td></td> <td>JACKSONVILLE BEACH</td> <td></td> <td>JACKSONVILLE CENTER</td> <td>379.9</td> <td>POSITION</td> <td></td> <td>US</td> <td>2</td> </tr> <tr> <td></td> <td></td> <td></td> <td></td> <td></td> <td></td> <td>TAMPA VOR</td> <td></td> <td>MIAMI CENTER</td> <td>351.9</td> <td>POSITION</td> <td></td> <td>US</td> <td>2</td> </tr> </tbody> </table>										ENROUTE AIR/GROUND FACILITIES						CIVIL/TACTICAL REPORTING						US AIR PROCEDURES		LOCATION	CALL SIGN	FREQ	LOCATION	CALL SIGN	FREQ	POSITION	CTA	CONTACT	FREQ	TYPE	RELAY TO	AREA	LEVEL	HOOBY AFB, FLA	*	9 311.0	HOOBY	HOOBY TOWER	1 236.6	CLIDE CUT		MIAMI CENTER	351.9	POSITION	ADC	US	2	HUNTER AFB, GA	* (280) * (307W)	9 311.0 9 321.0	HUNTER	HUNTER TOWER	2 236.6	ABEAM JACKSONVILLE, FLA		JACKSONVILLE FLA	379.9	POSITION REPORT		US	2	FLATDUNN AFB, TX	* (380W)	9 311.0	MIDDLE BEACH	MIDDLE BEACH APC	3 363.8	ABEAM MIDDLE BEACH S E		MIDDLE BEACH RADIO	5 255.4	POSITION REPORT	JAI CENTER	US	2	WRIGHT AFB, MISS	* (997W)	9 311.0	LANLEY	LANLEY TOWER	1 236.6	ABEAM CAPE MAYAS MC		MORFOLD CENTER	343.0	POSITION REPORT	ADC	US	2	FRASE AFB, N H	* (100TH)	9 311.0	PORTSMOUTH	PORTSMOUTH TOWER	2 236.6	ABEAM ATLANTIC CITY N J		NEW YORK CENTER	317.6	POSITION		US	2	DOW AFB, ME	* (343W) * (406TH)	9 311.0	LORING	LORING APC	4 363.8	ABEAM NANTUCKET VOR		BOSTON CENTER	352.0	POSITION		US	2	LORING AFB, ME	* (42ND)	9 311.0	ERNEST HUMPH	HUMPH APC	5 363.8	ABEAM AUGUSTA VOR		YARMOUTH RADIO	5 255.4	POSITION REPORT	MONCTON CENTER	US	2	GOOSE BAY AB, LAE	*	9 311.0	GOOSE	GOOSE APC	1 363.8	ABEAM GREENWOOD RING NZ		MONCTON CENTER	6 301.4	POSITION		CANADA	*	ERNEST HUMPH AP	*	9 311.0	OTHER			HAGALEN ISLAND		MONCTON CENTER	6 301.4	POSITION REPORT	GANDER CENTER	CANADA	2							ABEAM STEPHENVILLE RING, NF		ERNEST HUMPH APC	4 363.8	POSITION REPORT	GANDER CENTER	NF	2							ABEAM ST ANTHONY RHW		ST ANTHONY RADIO	10 364.2	POSITION REPORT	GANDER CENTER	NF	2							AT 53-44N 51-27W		ST ANTHONY RADIO	10 364.2	POSITION REPORT	GANDER CENTER									DEPARTING OUT-BOUND CONTROL LINE						IFF OFF								ENTERING OUT-BOUND CONTROL LINE						IFF ON 2								NOTE: RETURN ROUTE RECIPROCAL OF OUTBOUND ROUTE TO TRAIT INTERSECTION														* IN ACCORDANCE WITH CURRENT SAC MANUAL 100-51 SERIES.														TRAIT INTERSECTION		JACKSONVILLE CENTER	379.9	POSITION	ADC	US	2							GATEWAY		JACKSONVILLE CENTER	379.9	POSITION		US	2							JACKSONVILLE BEACH		JACKSONVILLE CENTER	379.9	POSITION		US	2							TAMPA VOR		MIAMI CENTER	351.9	POSITION		US	2
ENROUTE AIR/GROUND FACILITIES						CIVIL/TACTICAL REPORTING						US AIR PROCEDURES																																																																																																																																																																																																																																																																																																																	
LOCATION	CALL SIGN	FREQ	LOCATION	CALL SIGN	FREQ	POSITION	CTA	CONTACT	FREQ	TYPE	RELAY TO	AREA	LEVEL																																																																																																																																																																																																																																																																																																																
HOOBY AFB, FLA	*	9 311.0	HOOBY	HOOBY TOWER	1 236.6	CLIDE CUT		MIAMI CENTER	351.9	POSITION	ADC	US	2																																																																																																																																																																																																																																																																																																																
HUNTER AFB, GA	* (280) * (307W)	9 311.0 9 321.0	HUNTER	HUNTER TOWER	2 236.6	ABEAM JACKSONVILLE, FLA		JACKSONVILLE FLA	379.9	POSITION REPORT		US	2																																																																																																																																																																																																																																																																																																																
FLATDUNN AFB, TX	* (380W)	9 311.0	MIDDLE BEACH	MIDDLE BEACH APC	3 363.8	ABEAM MIDDLE BEACH S E		MIDDLE BEACH RADIO	5 255.4	POSITION REPORT	JAI CENTER	US	2																																																																																																																																																																																																																																																																																																																
WRIGHT AFB, MISS	* (997W)	9 311.0	LANLEY	LANLEY TOWER	1 236.6	ABEAM CAPE MAYAS MC		MORFOLD CENTER	343.0	POSITION REPORT	ADC	US	2																																																																																																																																																																																																																																																																																																																
FRASE AFB, N H	* (100TH)	9 311.0	PORTSMOUTH	PORTSMOUTH TOWER	2 236.6	ABEAM ATLANTIC CITY N J		NEW YORK CENTER	317.6	POSITION		US	2																																																																																																																																																																																																																																																																																																																
DOW AFB, ME	* (343W) * (406TH)	9 311.0	LORING	LORING APC	4 363.8	ABEAM NANTUCKET VOR		BOSTON CENTER	352.0	POSITION		US	2																																																																																																																																																																																																																																																																																																																
LORING AFB, ME	* (42ND)	9 311.0	ERNEST HUMPH	HUMPH APC	5 363.8	ABEAM AUGUSTA VOR		YARMOUTH RADIO	5 255.4	POSITION REPORT	MONCTON CENTER	US	2																																																																																																																																																																																																																																																																																																																
GOOSE BAY AB, LAE	*	9 311.0	GOOSE	GOOSE APC	1 363.8	ABEAM GREENWOOD RING NZ		MONCTON CENTER	6 301.4	POSITION		CANADA	*																																																																																																																																																																																																																																																																																																																
ERNEST HUMPH AP	*	9 311.0	OTHER			HAGALEN ISLAND		MONCTON CENTER	6 301.4	POSITION REPORT	GANDER CENTER	CANADA	2																																																																																																																																																																																																																																																																																																																
						ABEAM STEPHENVILLE RING, NF		ERNEST HUMPH APC	4 363.8	POSITION REPORT	GANDER CENTER	NF	2																																																																																																																																																																																																																																																																																																																
						ABEAM ST ANTHONY RHW		ST ANTHONY RADIO	10 364.2	POSITION REPORT	GANDER CENTER	NF	2																																																																																																																																																																																																																																																																																																																
						AT 53-44N 51-27W		ST ANTHONY RADIO	10 364.2	POSITION REPORT	GANDER CENTER																																																																																																																																																																																																																																																																																																																		
						DEPARTING OUT-BOUND CONTROL LINE						IFF OFF																																																																																																																																																																																																																																																																																																																	
						ENTERING OUT-BOUND CONTROL LINE						IFF ON 2																																																																																																																																																																																																																																																																																																																	
						NOTE: RETURN ROUTE RECIPROCAL OF OUTBOUND ROUTE TO TRAIT INTERSECTION																																																																																																																																																																																																																																																																																																																							
						* IN ACCORDANCE WITH CURRENT SAC MANUAL 100-51 SERIES.																																																																																																																																																																																																																																																																																																																							
						TRAIT INTERSECTION		JACKSONVILLE CENTER	379.9	POSITION	ADC	US	2																																																																																																																																																																																																																																																																																																																
						GATEWAY		JACKSONVILLE CENTER	379.9	POSITION		US	2																																																																																																																																																																																																																																																																																																																
						JACKSONVILLE BEACH		JACKSONVILLE CENTER	379.9	POSITION		US	2																																																																																																																																																																																																																																																																																																																
						TAMPA VOR		MIAMI CENTER	351.9	POSITION		US	2																																																																																																																																																																																																																																																																																																																

CAD October 25-58

SECRET

SECRET

SECRET

SECRET (When Filled In)

COMMUNICATIONS RECAP SHEET		UNIT	AIR FORCE	HOME BASE	UNIT CALL SIGN	UNIT CALL SIGN	UNIT CALL SIGN	ROUTE	PAGE NO.	NO. OF PAGES				
		3664	22F	MACDILL AFB, FLORIDA			321.0	Primary Route						
IAC CONTROL ROOM FACILITIES			ENROUTE AIR/GROUND FACILITIES			NON-IAC FACILITIES			CIVIL TACTICAL REPORTING			USC PROCEDURES		
LOCATION	CALL SIGN	FREQ	LOCATION	CALL SIGN	FREQ	POSITION	ETA	CONTACT	FREQ	TYPE	RELAY TO	AREA	CLASS	LENGTH
MACDILL AFB, FLORIDA	*	7 311.0	MACDILL	MACDILL	1 236.6	OLDSBY CRT		MIAMI CENTER	351.9	POSITION REPORTING RELATED AIR	ADC	U. S.	2	
BUNTER AFB, GEORGIA	* 2nd 300th	7 311.0	BUNTER	BUNTER	1 236.6	AREAM JACKSONVILLE, FLA.		JACKSONVILLE CENTER	379.9	POSITION REPORT		U. S.	2	
PLATTSBURGH AFB, NEW YORK	* 380th	7 311.0	MIDDLE BEACH	MIDDLE BEACH APPROACH CRT	14 363.8	AREAM MIDDLE BEACH AFB, S.C.		MIDDLE BEACH RADIO	254.4	POSITION REPORT	JACKSONVILLE, GEORGIA	U. S.	2	
WETTER AFB, MASS.	* 99th	7 311.0	LAWLEY	LAWLEY	1 236.6	AREAM CAMP PATTERSON, N. C.		BUFFALO CENTER	329.0	POSITION REPORT	ADC	U. S.	2	
PLAKE AFB, N.H.	* 100th	7 311.0	PUTNAM	PUTNAM	1 236.6	AREAM ATLANTIC CITY, N.J.		NEW YORK CENTER	317.6	POSITION REPORT		U. S.	2	
DW AFB, MAINE	* 311st 4060th	7 311.0	LANSING	LANSING APPROACH CRT	15 363.8	AREAM MANCHESTER VER. N.H.		BOSTON CENTER	352.0	POSITION REPORT		U. S.	2	
EDWARDS AFB, TEX.	* 40th	7 311.0	EDWENT HARBOR	EDWENT HARBOR APPROACH CRT	15 363.8	AREAM WASHINGTON FIELD, D.C.		YAKESBATH RADIO	245.4	POS REPORT & ENROUTE REPORT	MINOTON CENTER	U. S.	2	
OWICK BAY AFB, CAN.	*	7 311.0	OWICK	OWICK APPROACH CRT	15 363.8	AREAM QUEBEC N.S. CAN.		MINOTON CENTER	301.4	POSITION REPORT		CANADA	2	
EDWENT HARBOR S.F.	*					MACDILL ISLAND		MINOTON CENTER	301.4	POS REPORT & ENROUTE REPORT	CANADA CENTER	CANADA	2	
						AREAM STEVENSON S.W. VT		EDWENT HARBOR APC	363.8	POSITION REPORT	CANADA CENTER	S. F.	2	
						AREAM ST. ANTHONY I.M.		ST. ANTHONY RADIO	364.2	POS RPT & ENROUTE REPORT	CANADA CENTER	S. F.	2	
						ST-204 51-274		ST. ANTHONY RADIO	364.2	POS RPT & ENROUTE REPORT	CANADA CENTER		2	
						DEPARTING OUTBOUND CONTROL LINE						IFF OFF		
						ENTERING OUTBOUND CONTROL LINE						IFF ON	2	
						* IN ACCORDANCE WITH CURRENT AND PAST UNIT PROCEDURES.								
						NOTE: RETURN ROUTE IS RECIPROCAL OF OUTBOUND ROUTE TO TAMPA VIA								
						AREAM SAVANNAH VR		JACKSONVILLE CENTER	379.9	POS RPT & ENROUTE REPORT	ADC	U. S.	2	
						AREAM DUTONA BEACH VR		JACKSONVILLE CENTER	379.9	POSITION REPORT		U. S.	2	
						TAMPA VR		MIAMI CENTER	351.9	POSITION REPORT		U. S.	2	

SECRET

SECRET

SECRET (When Filled)

COMMUNICATIONS RECAP SHEET		UNIT	UNIT PREFIX	UNIT NAME	UNIT CALL SIGN	UNIT AIRCRAFT	UNIT TYPE	UNIT STATUS	UNIT OPERATOR	UNIT COMMENTS	UNIT LOCATION	UNIT ALTITUDE	UNIT SPEED	UNIT DIRECTION	UNIT RADIUS	UNIT EMISSIONS	UNIT IDENTIFICATION
SAC CONTROL ROOM FACILITIES		ENROUTE AIRBORNE FACILITIES				NON-SAC FACILITIES				CIVIL TACTICAL REPORTING				OTHER FACILITIES			
LOCATION	CALL SIGN	FREQ	LOCATION	CALL SIGN	FREQ	POSITION	ETA	CONTACT	FREQ	TYPE	RELAY TO	AREA	TYPE	AREA	TYPE	AREA	TYPE
MIRFLOR AVN, FLORIDA		311.0	TINDALL AFB, FLORIDA	TINDALL TAC	1 236.6	1100 AC		MIAMI CENTER	351.9	FIXATED RELAY		U. S.					
LAWTON AFB, TX		311.0	LAWTON AFB, TX	LAWTON TAC	1 236.6	ARMY HAWES, FLA.		MIAMI CENTER	351.9	FIXATED RELAY	LA WILCOX STATION	U. S.					
WRIGHT AFB, TX		311.0	WRIGHT AFB, TX	WRIGHT TAC	1 236.6	ARMY RM STEWART, LA.		NEW ORLEANS CENTER	279.6	FIXATED RELAY		U. S.					
WRIGHT AFB, TX		311.0	WRIGHT AFB, FLORIDA	WRIGHT TAC	1 236.6	ARMY LAW CHARLES, LA.		NEW ORLEANS CENTER	279.6	FIXATED RELAY		U. S.					
			WRIGHT AFB, FLORIDA	WRIGHT TAC	1 236.6	ARMY GARDNER, TX.		SAN ANTONIO CENTER	379.9	FIXATED RELAY		U. S.					
			WRIGHT AFB, TEXAS	WRIGHT TAC	1 236.6	27-000 94-004		SAN ANTONIO CENTER	379.9	FIXATED RELAY		U. S.					
						25-000 48-004		MIAMI CENTER	351.9	FIXATED RELAY		U. S.					
						ARMY HAWES, FLA.		MIAMI CENTER	351.9	FIXATED RELAY		U. S.					
						TANNA VR		MIAMI CENTER	351.9	FIXATED RELAY		U. S.					
* IN CONTACT WITH TANDON AND TANDON 10-01 10-03																	

SECRET

SECRET

CAP Order 23-58

1811

18 SEP 58

SECRET

~~SECRET~~

HEADQUARTERS 6TH AIR DIVISION
MACDILL AIR FORCE BASE, FLORIDA
15 September 1958

ANNEX "C"

TO

OPERATIONS ORDER

SERIAL NO. 25-58

WEAPONS

Annex "C" to
6AD Order 25-58
15 Sep 58

~~SECRET~~

~~SECRET~~

- c. The T-249 selector switch is never moved from the "safe" position.
5. Policies and procedures as outlined in SAC message DO 4905, 24 April 1958, subject "Air Operations with Nuclear Weapons" will be complied with. /S/
6. Commanders will insure that AEC custody of the weapon is maintained at all times. To insure a continuous capability to test launch the alert force, necessary custodial certificates will be executed by the Aircraft Commander in advance. The completed certificate will then be held in abeyance until such time as the alert is test launched, at which time the completed certificate will be presented to the SAECMR. /S/
7. Since information is limited concerning seal pit weapons, this Annex will be further expanded upon the availability of same. /S/

Annex "C" to
6AD OOrder 25-58
15 Sep 58

2

~~SECRET~~

~~SECRET~~

HEADQUARTERS 6TH AIR DIVISION
MACDILL AIR FORCE BASE, FLORIDA
15 September 1958

ANNEX "C"

TO

OPERATIONS ORDER

SERIAL NO. 25-58

WEAPONS

1. Only those aircraft loaded with sealed pit weapons (MK 15 Mod 2, MK 39 Mod 1, and MK 28 Mod 0) are authorized to be test launched. /S/
2. In-flight monitor and control will be with the T-249 in-flight control tester modified in accordance with T. O. 11N-T-249-1001, dated 19 February 1958. /U/
3. Aircrews will utilize appropriate alert pre-flight and scramble check lists until airborne. During the airborne phase of the mission, aircrews will comply with the general in-flight and abort procedures of the applicable delivery handbooks (-25 series T.O.), In the interest of safety, during Romeo Test Alternate Route launch, weapon strike procedures as outlined in the delivery handbook and alert check list will not be accomplished. /S/
4. Positive action will be taken to insure that during execution of Romeo alert:
 - a. The U-2 release remains locked in accordance with command policy. /U/
 - b. Weapon safing pins are not removed. /U/

Annex "C" to
6AD OOrder 25-58
15 Sep 58

~~SECRET~~

27

~~SECRET~~

HEADQUARTERS
6TH AIR DIVISION

OPERATIONS ORDER
22 - 58

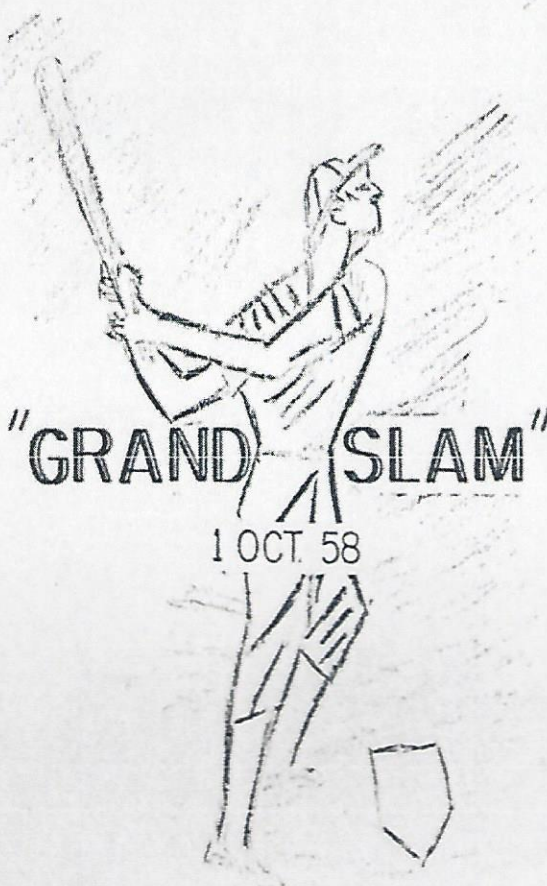

R-4650

~~SECRET~~

~~SECRET~~

CLASS: (b)(6)
AUTH: COMDR, 6AD
DATE: 1 OCT 58
NAME: *[Signature]*

HEADQUARTERS
6TH AIR DIVISION
United States Air Force
MacDill Air Force Base, Florida

DO

1 October 1958

SUBJECT: (Unclassified) Headquarters 6th Air Division Operations
Order Serial No. 22-58

TO: See Distribution - Basic Order

1. Attached is Headquarters 6th Air Division Operations Order Serial No. 22-58. Unclassified nickname is "GRAND SLAM". (Unclassified)

2. This Operations Order establishes subordinate unit requirements to conduct a "No Notice" USCM in accordance with SAC Operations Order 22-58. Period of liability for execution of this Order is the month of November. The 305th and 306th Bomb Wings will obtain USCM credit for this exercise. (Confidential)

3. Air weapons will not be flown during this mission. Ultimate weapons utilization during this USCM is not firm. Consequently, pending receipt of this information, this Order is published subject to later amendment concerning this subject. (Unclassified)

4. This Operations Order is classified Secret because it discloses tactics timing and capabilities of the participating units. (Unclassified)

5. When Inclosure #1 is withdrawn, this correspondence may be downgraded to Confidential in accordance with Air Force Regulation 205-1. (Unclassified)

FOR THE COMMANDER:

foia (b)(6)

1 Incl
6AD Order 22-58
(1 cy - S)

Director of Operations

R-4650

~~SECRET~~

~~SECRET~~

HEADQUARTERS 6TH AIR DIVISION
MACDILL AIR FORCE BASE, FLORIDA
1 October 1958

TABLE OF CONTENTS

OPERATIONS ORDER SERIAL NO. 22-58	Basic Order
ANNEX "A"	Intelligence
ANNEX "B"	B-47 Operations
Appendix 1	Recap Sheets
Appendix 2	Route Picture
Appendix 3	Flight Plans
Appendix 4	Form F
Appendix 5	Not Applicable
Appendix 6	ARTC B-47 Form 121's
ANNEX "C"	KC-97 Operations
Appendix 1	Timing Summary
Appendix 2	Route Picture
Appendix 3	Flight Plans
Appendix 4	ARTC KC-97 Form 121's
ANNEX "D"	Communications
Appendix 1	Communications Recap Form 100's
ANNEX "E"	ECM
Appendix 1	ECM Recap Sheets Form 99's
ANNEX "F"	Administration & Logistics

6AD OOrder 22-58
1 Oct 58

~~SECRET~~

~~SECRET~~

HEADQUARTERS 6TH AIR DIVISION
MACDILL AIR FORCE BASE, FLORIDA
1 October 1958

OPERATIONS ORDER

SERIAL NO. 22-58

"GRAND SLAM"

6AD OOrder 22-58
1 Oct 58

~~SECRET~~

3

~~SECRET~~

HEADQUARTERS 6TH AIR DIVISION
MACDILL AIR FORCE BASE, FLORIDA
1 October 1958

OPERATIONS ORDER SERIAL NO. 22-58

CHARTS AND MAPS: As required

TASK ORGANIZATIONS:

305th Bombardment Wing	Colonel F. L. O'Brien, Jr.
306th Bombardment Wing	Colonel R. J. Nolan
809th Air Base Group	Colonel L. L. Leibel
4234th USAF Hospital	Colonel A. D. Smith
Det 1, 26th Weather Squadron	foia (b)(6)

1. GENERAL SITUATION: A continuing requirement exists to conduct large scale SAC directed Unit Simulated Combat Missions (USCM's) on a "NO NOTICE" basis. This Order provides basic guidance to mesh the EWO concept into a peacetime USCM. The period of vulnerability for SAC units participating in this exercise is the month of November 1958. /U/
 - a. Intelligence:
 - (1) SAC Manual 55-12, SAC Manual 55-7, 2AF USCM Intelligence Catalog, and Annex "A", this Order, apply. /U/
 - (2) Target Intelligence - Assignment of target to a specific strike aircraft will be the Units' responsibility. /U/
 - b. Friendly Forces:
 - (1) MATS will provide airlift, base facilities, air/sea rescue and communications support, as required. /U/

6AD Order 22-58
1 Oct 58

~~SECRET~~

~~SECRET~~

(2) Eighth Air Force:

(a) Will provide base facilities and air refueling support as required. /U/

(b) Activates Tanker Task Force to provide "LEAP FROG" and turn around refueling of bomber forces. /U/

1. Pease Task Force. The 2d and 308th AREFS KC-97's refuel the 305th and 306th Bomb Wings' B-47's. /S/

(c) Provides weather scouts for all Tanker Task Forces. /U/

(3) 303d AREFS Command Post will provide timing information to B-47 cell leaders, as requested. Reference paragraph 20 Annex "B", this Order. /U/

2. MISSION: To conduct a SAC USCM that simulates the EWO of this unit, through the first refueling area, as closely as peacetime limitations allow. To check the unit's operational proficiency to insure its capability to perform the EWO assignment. EWO Option 5 will be used in planning the mission. /S/

3. TASKS FOR SUBORDINATE UNITS:

a. 305th Bombardment Wing.

(1) Prepare all available aircraft to participate in this mission as outlined in Annexes "B" and "C", this Order. /U/

(2) Launch strike/deploying aircraft in accordance with this Order. /U/

(3) Coordinate, prepare and present the General and Specialized briefings for "GRAND SLAM". /U/

6AD OOrder 22-58
1 Oct 58

~~SECRET~~

~~SECRET~~

- (4) Deploy a KC-97 20 Aircraft Turn Around Team in accordance with Annexes "C" and "F", this Order. /U/
 - (5) Coordinate airlift requirements of the 305th AREFS Turn Around Team with the 2d Strategic Support Squadron. /U/
 - (6) Provide personnel and material as required to support this Order. /U/
- b. 306th Bombardment Wing.
- (1) Prepare all available aircraft to participate in this mission as outlined in Annexes "B" and "C", this Order. /U/
 - (2) Launch strike aircraft in accordance with this Order. /U/
 - (3) Coordinate, prepare and present the General and Specialized briefing for "GRAND SLAM". /U/
 - (4) Provide two (2) strip alert aircraft and one (1) back-up aircraft, and generate remaining tankers in accordance with Annex "C", this Order. /U/
 - (5) Prepare and process for loading, personnel and cargo, in accordance with 6th Air Division Operations Order 44-59. /U/
 - (6) Provide personnel and material as required to support this Order. /U/
- c. 809th Air Base Group.
- (1) Provide support in preparing 305th and 306th Bomb Wings' aircraft for launching in accordance with 6th Air Division Operations Order 44-59, and this Order. /U/
 - (2) Provide such other support and procedures as may be required in accordance with the Base Support Plan. /U/

6AD OOrder 22-58
1 Oct 58

3

~~SECRET~~

~~SECRET~~

- (3) Provide clearance through Warning Areas 168 and R-167 during the period of this mission. /U/
- d. 4234th USAF Hospital.
 - (1) Comply with instructions contained in 6th Air Division Mobility Plan, Base Support Plan, and 6th Air Division Operations Order 44-59, as amended by this Order. /U/
- e. Det 1, 26th Weather Squadron.
 - (1) Comply with all requirements of 6th Air Division Operations Order 44-59, 305th-306th Bomb Wings Operations Orders 50-59, and this Order. /U/
- x. General Instructions.
 - (1) The timing for the preparation phase of this exercise will be in accordance with the assigned 6th Air Division EWO. All preparation phase requirements as outlined in SAC Manual 50-5, will be accomplished. Aircraft load and configuration will be as required to support this Order. /U/
 - (2) Planning Factors:
 - (a) This will be a "NO NOTICE" mission. /U/
 - (b) Bomber routes will be Round Robin, simulating EWO profile through terminal air refueling. /S/
 - (c) Tankers will employ "LEAP FROG" refueling tactics as directed by Task Force Commander. /S/
 - (d) Air weapons will not be utilized in airborne activity. /U/
 - (3) Flying and Ground Safety takes precedence over all other objectives of this mission. /U/

~~SECRET~~

- (a) Weather minimums will be as prescribed by AFR 60-16.

Missed air refueling alternates must have minimums as required by AFR 60-16. When weather precludes launching of any portion or wave of the scheduled mission, that portion or wave will be rescheduled in conjunction with subsequent phases. /U/

- (b) Commanders will provide for crew rest as required by SAC Reg 62-19 on this USCM. /U/

(4) Execution Instructions: /U/

- (a) The SAC Command Post will execute in accordance with provisions of 2AF OPLAN 300-59, Basic Order, paragraph 3x(3)(c), subparagraphs 1 through 6. /U/

- (b) Index number series for this exercise is 150. /S/

- (c) The normal peacetime "Alert Force" will be expanded to Option 5 Quick Strike strength. Only the expanded Quick Strike Force will launch. /S/

- (d) The SAC or 2AF Command Post will disseminate the "GO CODE" in standard "NOAH'S ARK" message. /S/

- (e) The "GO CODE", when decoded in the vocabulary of current KAC-72, are the words "FORCE" and "SCRAM". /S/

- (f) Alert aircraft will be considered as available aircraft during the preparation phase of the USCM. These aircraft will perform a "OOOO" type alert, or as directed by execution order. Alert aircraft will be considered as generated aircraft in accordance with SACM 55-7.

~~SECRET~~

However, for launch, these aircraft will be treated as not available. /U/

(g) Reflex Aircraft:

1. Airborne Reflex deploying aircraft, at A Hour, during this exercise, will not be considered as available aircraft. However, should the converse exist, aircraft are available and will be generated and launched in accordance with this Order.
 2. Airborne re-deploying Reflex aircraft at E Hour will be considered as available aircraft upon arrival at home station and will be generated and launched in accordance with this Order. Conversely, should these aircraft be launched after E Hour, they will not be considered available and need not be generated.
- (5) Units will conduct specialized briefings in accordance with SACM 50-12. Further, units will be responsible to provide assistance to 6th Air Division Staff in the preparation of General Briefing Aids. /U/
- (6) General Briefing will be conducted prior to 30 October 1958 (time to be announced later) in the Base Theatre. /U/
- (7) Units will develop flight crew flimsies in support of this Order. /U/
- (8) SACR 50-8, 51-6, 55-18, SACM 50-5, 55-7, 55-8, 55-12, 55-14, 100-1, and applicable Tactical Doctrines provide guidance in the USGM. /U/

~~SECRET~~

(9) Combat Reports:

(a) Submit reports in accordance with SACM 55-8 series and SAC letter, DCCO, subject: Combat Reports Required for Training Mission, dated 28 February 1958. /U/

(b) Reporting procedures at MacDill will be in accordance with 6th Air Division Operations Order 44-59. /U/

(c) Additional requirements:

1. Amended B-2 reports will be submitted for final metro adjustments to take off time. /U/

2. Distribution B: M-4A, M-22, M-23, R-18 and M-21. /U/

2. For the period of TDY, submit M-27 report with the following distribution: 1 cy SAC, 1 cy ADIV or AF exercising operational control during period of TDY, 10 cys 2AF and 2 cys 6AD. /U/

(10) This Operations Order is classified SECRET because it discloses tactics, timing and capabilities of participating units. /U/

4. ADMINISTRATIVE AND LOGISTICAL MATTERS:

a. See Annex "F", this Order. /U/

5. COMMAND AND COMMUNICATIONS MATTERS:

a. Command - Normal. /U/

b. Communications - See Annex "D", this Order. /U/

(1) Identification, recognition and IFF in accordance with SAC CEI. /U/

(a) IFF within ZI, Canada, and NEA, in accordance with SACR 55-23. /U/

~~SECRET~~

(2) SAC CEI 2101, 4a (2)(b)2 will be complied with in selecting HF frequencies and stations to monitor in accordance with monitoring procedure ALPHA. /U/

TIBBETS
Colonel, USAF
Commander

ANNEXES:

- Annex "A" - Intelligence
- Annex "B" - B-47 Operations
- Annex "C" - KC-97 Operations
- Annex "D" - Communications
- Annex "E" - Electronics Countermeasures
- Annex "F" - Administrative and Logistics Instructions

DISTRIBUTION:

- CinC, SAC - 4 cys
- Comdr, 2AF - 5 cys
- DODT - 1 cy
- DOC - 1 cy
- DM2A - 1 cy
- DM4 - 1 cy
- IG - 1 cy
- Comdr, 8AD - 3 cys
- Comdr, 38AD - 2 cys
- Comdr, 303 AREFS - 1 cy
- Comdr, 6AD - 6 cys
- Comdr, 305 BW - 25 cys

6AD OOrder 22-58
1 Oct 58

~~SECRET~~

DISTRIBUTION: (CONT'D)

Comdr, 306 BW - 25 cys

Comdr, 321 BW - 1 cy

Comdr, 809 ABG - 10 cys

Comdr, 4234 USAF Hosp - 1 cy

Comdr, Det 1, 26 Wx Sq - 1 cy

Base Historian - 4 cys

In addition, the following distribution will be made:

Hq SAC - 1 cy of App 6 to Annex "B" - DOOFF

Hq SAC - 1 cy of App 4 to Annex "C" - DOOFF

Hq SAC - 5 cys of App 2 to Annex "B"

Hq SAC - 5 cys of App 2 to Annex "C"

CinC, NORAD

5 cys of App 2 to Annex "B"

8 cys of App 2 to Annex "C"

5 cys of App 1 to Annex "B"

5 cys of App 3 to Annex "B"

8 Cys of App 3 to Annex "C"

5 Cys of App 6 to Annex "B"

8 Cys of App 4 to Annex "C"

HQ EADC, Stewart AFB, N.Y.

1 cy App 2 to Annex "B"

1 cy App 2 to Annex "C"

1 cy App 1 to Annex "B"

1 cy App 3 to Annex "B"

1 cy App 3 to Annex "C"

1 cy App 6 to Annex "B"

1 cy App 4 to Annex "C"

OFFICIAL:

foia (b)(6)

Colonel, USAF
Director of Operations

6AD OOrder 22-58
1 Oct 58

9

~~SECRET~~

12

A

~~SECRET~~

HEADQUARTERS 6TH AIR DIVISION
MACDILL AIR FORCE BASE, FLORIDA
1 October 1958

ANNEX "A"

TO

OPERATIONS ORDER

SERIAL NO. 22-58

INTELLIGENCE

Annex "A" to
6AD OOrder 22-58
1 Oct 58

~~SECRET~~

~~SECRET~~

HEADQUARTERS 6TH AIR DIVISION
MACDILL AIR FORCE BASE, FLORIDA
1 October 1958

ANNEX "A"

TO

OPERATIONS ORDER

SERIAL NO. 22-58

INTELLIGENCE

1. INTELLIGENCE SUMMARY:

a. General Situation.

- (1) See Volume I, SAC BIPG and current intelligence digest for details of current actual EWO enemy situation - simulated. /U/
- (2) In order to evaluate and enhance the capability of this Command to execute the assigned emergency war mission, the 305th and 306th Bombardment Wings will conduct a Unit Simulated Combat Mission (USCM) nicknamed "GRAND SIAM". This is a domestic round robin training mission designated to simulate the requirements of the actual EWO mission in all major respects save geography. /C/
- (3) The 35th Air Division (Defense) of the Eastern Air Defense Force (NORAD) is designated as simulated enemy territory for the inbound route of this mission. /U/

b. Enemy Order of Battle.

- (1) All fighter units and radar sites of the 35th Air Division (Defense) or the Eastern Air Defense Force

Annex "A" to
6AD OOrder 22-58
1 Oct 58

~~SECRET~~

~~SECRET~~

(NORAD) are designated as simulated enemy order of battle. These include F-86L's at CHARLESTON AFB and F-89H's at MCCOY AFB. Detailed order of battle will be presented at the General Mission Briefing. /S/

(2) Fighter intercepts will not be reported in M-12 Hot News Reports. /U/

c. Capabilities of Enemy Forces.

(1) The EW and GCI ranges of the 35th Air Division Coastal radars are 200 and 150 miles respectively. Detailed radar and fighter capabilities will be presented at the General Mission Briefing. /S/

2. INTELLIGENCE REQUIREMENTS:

a. IBDA and Photo Requirements.

(1) Phase I IBDA will be accomplished in accordance with Section II, SACM 200-2; SACM 55-5; and applicable navigator's SOP's. /U/

(2) Phase II IBDA will be accomplished in accordance with Section V, Para 14e, SACM 55-8B; and 2AF 69 Operations Order. /U/

b. Essential Elements of Information.

(1) Unusual or important incidents or occurrences of immediate intelligence value and information on friendly aircraft and crew distress as required "Hot News" reports in paragraph 5c, Section I, SACM 55-8. /U/

Annex "A" to
6AD OOrder 22-58
1 Oct 58

~~SECRET~~

- (2) Information from aerial photography and other sources regarding success of the bombardment mission as required by B-51 Immediate Photo Intelligence Reports. /U/
- (3) Means of Obtaining Information:
 - (a) Crew observation. /U/
 - (b) Interrogation of combat crews. All participating crews will report to their respective Wing Briefing Rooms immediately following landing for interrogation. M-12 and M-20 report formats will be used as interrogation guides. /U/
- (4) Means of Reporting EEI.
 - (a) The above EEI will be transmitted as expeditiously as possible in the M-12, M-20, and B-51 reports in accordance with SACM 55-8. /U/

3. INTELLIGENCE ACTIVITIES:

a. Target and Navigational Materials:

- (1) USCM Target:
 - (a) Center of railroad bridge over Caloosahatchee River at Fort Myers, Florida. /S/
- (2) Added SACR 50-8 RBS Target:
 - (a) Tampa Bomb Plot. /S/
- (3) Maps and Charts:
 - (a) As required for accomplishment of special USCM mission folders for issue to navigators. /U/
 - (b) Combat mission folders (EWO) will not be issued. /U/

~~SECRET~~

b. Survival Intelligence:

(1) Equipment.

- (a) Appropriate survival gear will be issued by Squadron
Personal Equipment Sections in accordance with SACR
60-8. Evasion and escape aids will be simulated. /U/

c. Reports and Distribution.

- (1) Distribution A: M-12 and M-20 reports in accordance with
SACM 55-3M. /U/
- (2) Distribution B: B-51 report in accordance with SACM
55-8B. /U/
- (3) COMAF 8 will be information addressee on B-51 reports. /U/

Annex "A" to
6AD OOrder 22-58
1 Oct 58

4

~~SECRET~~

17

B

1 1

~~SECRET~~

HEADQUARTERS 6TH AIR DIVISION
MACDILL AIR FORCE BASE, FLORIDA
1 October 1958

ANNEX "B"

TO

OPERATIONS ORDER

SERIAL NO. 22-58

B-47 OPERATIONS

Annex "B" to
6AD OOrder 22-58
1 Oct 58

~~SECRET~~

~~SECRET~~

HEADQUARTERS 6TH AIR DIVISION
MACDILL AIR FORCE BASE, FLORIDA
1 October 1958

ANNEX "B"

IG

OPERATIONS ORDER

SERIAL NO. 22-58

B-47 OPERATIONS

1. GENERAL:

- a. A continuing requirement exists to conduct large scale SAC directed USCM's on a "NO NOTICE" basis to exercise operational concepts of strategic air operations. The period of vulnerability for SAC units participating in this exercise is the entire month of November 1958. The USCM will simulate the unit EWO through the first refueling area as closely as peacetime limitations allow. EWO Option 5 timing has been used as a guide, amended as required, to comply with peacetime limitations. /S/

2. EXECUTION:

- a. SAC Command Post will execute in accordance with provisions of 2AF OPlan 300-59, Basic Order, paragraph 3x(3)(c), subparagraphs 1 through 6. /S/
- b. Index number series for SAC execution orders in this exercise is 159. /S/
- c. The normal peacetime "Alert Force" will be expanded to Option 5 Quick Strike strength of the Alert Force. Only the expanded Quick Strike Force will launch. /S/

Annex "B" to
6AD OOrder 22-58
1 Oct 58

~~SECRET~~

~~SECRET~~

- d. The "GO CODE", when included in the vocabulary of current KAC-92, is the words "REFLEX" and "SRAM". /S/
- e. Subsequent to the completion of strike refueling operations, the SAC Command Post will release tankers to the Numbered Air Forces for re-deployment to home rotational station. /U/
- f. Each Bomb Wing will launch a minimum of thirty (30) bombers or available bomber aircraft minus five (5), whichever is less (SAM 50-5, Section I, paragraph 26c). /X/

3. REFLEX SCHEDULES:

- a. Cinc SAC, with reference to SAM 50-5, paragraph 19a, has authorized parent Numbered Air Forces to revise Reflex schedules as required for compatibility with this exercise. Second Air Force Bomb Wings participating in this USGM and Reflex Action (MIF Order 96-58) will, upon receipt of the advance condition of readiness message, cancel the Reflex schedule and generate and launch aircraft only on the USGM until the completion of the USGM. Upon completion of the USGM, Second Air Force will evaluate the forward area Reflex Action posture and, after allowing sufficient time to prepare aircraft, schedule deployment of replacement aircraft as required. /X/

4. Aircraft configuration will be as required to accomplish this mission. The aircraft will be prepared in accordance with 6th Air Division Operations Order 44-59, using SAM 50-5 as a guide to accomplish EWG requirements that are in conflict with the requirements of this mission. Air weapons will not be flown. /U/

SECRET

5. ATC CLEARANCE:

- a. Approved ATC altitudes will be observed. /U/
- b. Aircraft Commanders will submit completed Form 175's (Section C will indicate "GRAND SLAM" _____ ROUTE as briefed), Form F's and flight orders to Unit Command Posts immediately after pre-take off briefing.
- c. IFR clearances will not be cancelled for VFR letdown except in case of emergency. /X/

6. TIMING:

- a. See Appendix 1, this Annex. /S/

7. ASSEMBLY:

- a. In accordance with SAC Tactical Doctrine. /X/

8. AIR REFUELING:

- a. The 2d and 308th AREFS will be scheduled to support the 306th and 305th Bomb Wings respectively in the BABY BED (Primary) and ALL OUT (Secondary) refueling areas. /S/
- b. Communications/Rendezvous procedures will be as contained in SACM 100-1. Communications settings will be ANN and CORA of designated column. /S/

PRIMARY						
CODE	KEY	A/R	FUEL	C/R	MISSED	KC-97
NAME	RNDZ	TRACK	TRANSFER	PLAN	A/R ALT	UNIT
	38-40N					
BABY BED	65-58W	079	30M	ALT/EUR	PEASE AFB	2 and 308
YO YO						
	38-40N					
BABY BED	65-58W	079	30M	ALT/EUR	PEASE AFB	2 and 308
ALTERNATE						
	35-40N					
ALL OUT	61-20W	038	30M	ALT/EUR	KINDLEY	2 and 308
YO YO						
	35-40N					
ALL OUT	61-20W	038	30M	ALT/EUR	KINDLEY	2 and 308

Annex "B" to
6AD Order 22-58
1 Oct 58

SECRET 3

~~SECRET~~

9. PLANNING FACTORS:

- a. Winds and temperatures in accordance with 2AFM 55-1. /U/
- b. Aircraft loading: Data is from applicable T. O. and SACTP 55-2. Fuel load will be maximum allowable for critical field length equal to available runway; however, in no event will the strike gross weight of the aircraft exceed 200,000#. All take offs have been computed utilizing water/alcohol augmentations. /S/
- c. Cruise Control: Consumption rates have been extracted from applicable T.O. /U/
- d. Fuel reserves have been computed to arrive over destination with at least 12,000#. /U/
- e. Refueling: SACM 55-5, 55-10 and 100-1, apply. Aircraft will refuel on a one to one basis. Scheduled off loads in primary area and 30,000# on "YO YO" in alternate Air Refueling area. /S/
- f. Weather Minimums: In accordance with AFR 60-16 and SACR 55-12. /U/
- g. Flying Safety has been given maximum consideration during mission planning. /U/

10. CELL TACTICS:

- a. Route cell (ie, stacked up 500 feet with one (1) mile interval) will be employed at all times when approaching a turning point with turns greater than 30°, and at all times prior to entering a maneuver area. /U/
- b. All other cell tactics will be in accordance with SAC Tactical Doctrine or as directed by Cell Leader. /U/

~~SECRET~~

g. Aircraft will be considered ineffective if neither of the above types of photography are accomplished.

13. COMMUNICATIONS:

a. As contained in Annex "D", this Order. /U/

14. ECM:

a. As contained in Annex "E", this Order. /U/

15. REQUIREMENTS:

- a. One (1) navigation leg.
- b. One (1) camera attack and IBDA.
- c. One (1) rendezvous (Cell Leader).
- d. One (1) ECM.
- e. One (1) cell tactics and formation as flown.
- f. Water/alcohol take off.

16. WEATHER SCOUT:

a. Eighth Air Force will designate weather scouts from their resources for all air refueling areas, this exercise. /U/

17. EMERGENCY BASES:

<u>AIR BASE</u>	<u>ELEVATION</u>	<u>RUNWAY LENGTH</u>
KINDLEY	11 ft	9700 ft
PEASE	101 ft	11300 ft
MCCOY	96	11000 ft
HUNTER	42	11400 ft
WESTOVER	245 ft	11600 ft
HOMESTEAD	7 ft	10200 ft

Annex "B" to
6AD OOrder 22-98
1 Oct 58

6

~~SECRET~~

~~SECRET~~

- c. Cell Leaders check list will be distributed at pre-take off briefing and the Cell Leader will brief his flight on tactics prior to departure to aircraft. /U/

11. NAVIGATION:

- a. Celestial navigation will be accomplished on the return leg, as scheduled in the flight plan, in accordance with SACR 51-11. No celestial navigation on outbound leg, as there is no terminal point in accordance with SACR 50-4 and 51-11. /U/

12. BOMBING:

- a. Bombing Altitude: As indicated in Recap Sheet, this Annex. /S/
- b. All bomb runs will be in accordance with current Tactical Doctrine. /S/
- c. Since air weapons will not be carried, each Bomb Wing will overfly Tampa RBS Site. RBS runs will be made only as required for additional 50-8 credit and when fuel is available. RBS runs will not count for or against the USGM. /S/
- d. One (1) camera attack on center of bridge over Caloosahatchee River, north of Fort Myers, Florida, (26-41-25N/81-49-00W) will be made. The effective point will be the center of the bridge and supporting scope photography will be required. IBDA will be accomplished.
- e. Target photography will be scored by the Wing Photo Interpreter for the purpose of B-51 reporting.
- f. G-15 or G-23 scope photography of the target will be considered effective for this mission.

~~SECRET~~

~~SECRET~~

18. FLYING SAFETY: Takes precedence over all other objectives of this mission. /U/
19. Strip alert tanker from MacDill will be available for the duration of this exercise. Airplanes in need of this strip alert tanker will contact FOXY CONTROL on 321.0 mcs. FOXY CONTROL will advise of CR Plan, RDZ, heading and altitude to be used. /U/
20. Cell Leaders will contact 303d AREFS Command Post, KINDLEY AFB, approximately 100 NM northeast, on 311.0 to adjust 30 minutes separation between cells. Cell leaders will give KINDLEY Command Post actual time over KINDLEY so subsequent cells can make good their 30 minute separation over KINDLEY.
21. Cell break up will be accomplished between SAVANNAH and JACKSONVILLE. Cell break up point, 31-06N 81-15W. The No. One aircraft will continue on course to PRE IP, No. Two aircraft will break first, obtaining a seven (7) minute separation in a 360° right turn, No. Three airplane will break second 3½ minute legs and 4 minute turn, losing fifteen (15) minutes, No. Four aircraft will break last flying seven (7) minute legs and four (4) minute turns, losing twenty two (22) minutes.
22. 302TH BOMB WING:
- a. COMM/RNDE PROCEDURES
- | | | | | |
|--------|----------------|------|------------------|---------|
| NEAC | ALT/EUR | CCRA | | |
| | <u>PRIMARY</u> | | <u>ALTERNATE</u> | |
| | 39-09N/66-06W | | 35-56N/63-50W | |
| AFN 76 | T-7 R-8 | | AFN 76 | T-7 R-8 |

Annex "B" to
GAD OOrder 22-58
1 Oct 58

~~SECRET~~

<u>PRIMARY</u>		<u>ALTERNATE</u>	
APN 69	1-1-2	APN 69	1-1-2
PRIM	375.4	PRIM	375.4
BACK UP	311.0	BACK UP	311.0

23. 306 BOMB WING:

a. COM/RNDZ PROCEDURES

NEAC ALT/EUR ANN

<u>PRIMARY</u>		<u>ALTERNATE</u>	
38-40N/65-58W		35-40N/63-20W	
APN 76	T-7 R-4	APN 76	T-7 R-4
APN 69	1-1-1	APN 69	1-1-1
PRIM	337.6	PRIM	337.6
BACK UP	311.0	BACK UP	311.0

Annex "B" to
6AD OOrder 22-58
1 Oct 58

8

~~SECRET~~

24

~~SECRET~~

HEADQUARTERS 6TH AIR DIVISION
MACDILL AIR FORCE BASE, FLORIDA
1 October 1958

APPENDIX 1

TO

ANNEX "B"

OPERATIONS ORDER

SERIAL NO. 22-58

RECAP SHEETS

App 1 to
Annex "B"
6AD OOrder 22-58
1 Oct 58

~~SECRET~~

SECRET (When Filled In)

RECAPITULATION SHEET
BOMBARDMENT - RECONNAISSANCE - PART I

APP 1 to Annex "D"
GAD Order 22-58, 1 Oct 58

AIR FORCE		WING		OPERATIONAL TAIL NUMBER		TYPE AND MODEL AIRCRAFT		OPERATIONS DESIGNS		EFFECTIVE DATE		PAGE NO.		OF TOTAL PAGES		
2AF		305TH B		SQUADRON		B-47E		22-58				1		18		
TARGET NAME AND COORDINATES	BIRD REF NO	ICD	CELL CALL SIGN AND NUMBER	REASON	TAKEOFF DATA						SCHEDULED REFUELING					
					MARK AND CAPABLE	DEPART	ORIG ALT (FEET)	CLIMB RATE (FT/MI)	TYPE OF TAKEOFF	TIME TO CLIMB (MIN)	AREA	NUMBER OF POINTS	TIME	AVAILABILITY	NUMBER OF POINTS	TIME
A	B	C	D	E	F	G	H	I	J	K	L	M	N	O	P	
1 Reflex	N/A	N/A	N/A	N/A	N/A	N/A	N/A	N/A	N/A	N/A	N/A	N/A	N/A	N/A	N/A	
2																
3																
4																
5																
6																
7 Base Base Alert																
8 Pt Mera S/B Bridge 26-41-56/81-45-00N	N/A	N/A	Grey 1	N/A	Mac011	20000	10000	Wt	0245	1	1271	317	30.0	30.0	17000	7600
			Grey 2						0245	1						7600
			Grey 3						0247	1						7770
			Grey 4						0248	1						7600
			Pink 1						0345	1						7600
			Pink 2						0346	1						7600
			Pink 3						0347	1						7770
			Pink 4						0348	1						7600
			Orange 1						0445	1						7600
			Orange 2						0446	1						7600
			Orange 3						0447	1						7770
			Orange 4						0448	1						7600
			Red 1						0545	1						7600

SECRET

RECAPITULATION SHEET
BOMBARDMENT - RECONNAISSANCE - PART II

AIR FORCE

NO. 1

UNIT TACTICAL CALL SIGN

TYPE AND MODEL AIRCRAFT

OPERATIONS ORDER NO. EFFECTIVE DATE

PAGE NO.

NO. OF PAGES

SECOND

3-50M

020710

B-47E

22-58

2

18

App I to Annex 1
GAD Order 22-58, 1 Oct 58

SECRET

STRIKE	BASE TO WHICH CONTROL POINT	TIME OF DAY	COORDINATES	HEIGHT	PENETRATION SPEED		PRE TARGET ENTER PRECISION SET				POST TARGET ENTER PRECISION SET				MIST STRIKE BASE	CELL CALL SIGN AND NUMBER
					START	DURATION	GEOMETRY	ALTITUDE T.A.S.	ALTITUDE T.A.S.	GEOMETRY	ALTITUDE T.A.S.	ALTITUDE T.A.S.				
					TIME	MIN	SEC	1	2	3	4	5	6	7		
1	N/A	N/A	N/A	N/A	N/A	N/A	N/A	N/A	N/A	N/A	N/A	N/A	N/A	N/A	N/A	1
2																2
3																3
4																4
5																5
6																6
7																7
8	2786	31.3	31-18E	100										HAZELL	GRAY	8
9	7100	33.3	76-00W	1500											GRAY	9
10															GRAY	10
11															GRAY	11
12															FINA	12
13															2	13
14															ORANGE	14
15															1	15
16															ORANGE	16
17															2	17
18															3	18
19															RED	19
20															2	20

SECRET

RECAPITULATION SHEET												7		18	
BOMBARDMENT - RECONNAISSANCE - PART I															
TARGET NAME AND COORDINATES		D.F.C. REF. NO.	TYPE	CALL SIGN AND NUMBER	WEAPON	TAKE-OFF DATA				SCHEDULED REFUELING					
						DEPART	ALTITUDE	TIME	TYPE	AMOUNT	AVAILABILITY	TIME	AVAILABILITY	TIME	AVAILABILITY
FT MITCHELL R/A BRIDGE		20-21-21A/B-49-00K S/A	S/A	S/A	INDIG	MACILL	200,000	104956	W21	4265					
					INDIG					4267					70,000
					INDIG					4268					70,000
					MARKANT					4267					70,000
					MARKANT					4268					70,000

App I to Annex 7B
 CAP Order 22-58, 1 Oct 58

App 1 to Annex "B"
 GAD Order 22-58, 1 Oct 58

SECURITY INFORMATION		RECONSTRUCTION SHEET		SERVICES		MILITARY		FINANCIAL		MEDICAL		PERSONAL		OTHER	
EDWARD GALT - RECONSTRUCTION - PART 1				218		220		222		224		226		228	
TARGET NAME AND COORDINATES		TYPE OF INFO		CLASSIFICATION		SOURCE		AMOUNT		DATE		STATUS		REMARKS	
21	21-41-25N 81-45W	S/A	S/A	SILVER 2	N/A	PARCEL	200,000	96,000	NET	0520					
22				SILVER 3						0421					
23				YELLOW 1						2420					
24				YELLOW 2						2420					
25				ORAL 1						2420					
26				ORAL 2						2420					
27				ORAL 1						2420					
28				ORAL 2						2420					
29				ORAL 1						2420					
30				ORAL 2						2420					
31				ORAL 1						2420					
32				ORAL 2						2420					
33				ORAL 1						2420					
34				ORAL 2						2420					
35				ORAL 1						2420					
36				ORAL 2						2420					
37				ORAL 1						2420					
38				ORAL 2						2420					
39				ORAL 1						2420					
40				ORAL 2						2420					
41				ORAL 1						2420					
42				ORAL 2						2420					
43				ORAL 1						2420					
44				ORAL 2						2420					
45				ORAL 1						2420					
46				ORAL 2						2420					
47				ORAL 1						2420					
48				ORAL 2						2420					
49				ORAL 1						2420					
50				ORAL 2						2420					

APP 1 to Annex "H"
 CAD Order 22-58, 1 Oct 58

~~SECRET~~

REGISTRATION SHEET		ARRIVE	NO.	OUTSTANDING	IN	OUT	IN	OUT	IN	OUT	IN	OUT	IN	OUT	IN	OUT	IN	OUT	
BASE TO BE CONTROL POINT		REGISTRATION	START	STOP	ORDER	ORDER	ORDER	ORDER	ORDER	ORDER	ORDER	ORDER	ORDER	ORDER	ORDER	ORDER	ORDER	ORDER	
1	32.0	N/A	N/A	N/A	N/A	N/A	N/A	N/A	N/A	N/A	N/A	N/A	N/A	N/A	N/A	N/A	N/A	N/A	11 18
2	32.0																		
3	32.0																		
4	32.0																		
5	32.0																		
6	32.0																		
7	32.0																		
8	32.0																		
9	32.0																		
10	32.0																		
11	32.0																		
12	32.0																		
13	32.0																		
14	32.0																		
15	32.0																		
16	32.0																		
17	32.0																		
18	32.0																		
19	32.0																		
20	32.0																		

SECRET

App I to Annex 1
 CAD Order 22-58, 1 Oct 58

RECAPITULATION SHEET		247	2008	2002	5-7E	22-10	Nov 58	15	18
ELECTRONIC COUNTERMEASURES		ELECTRONIC COUNTERMEASURES		ELECTRONIC COUNTERMEASURES		ELECTRONIC COUNTERMEASURES		ELECTRONIC COUNTERMEASURES	
CALL SIGN	MODE	START	STOP	START	STOP	START	STOP	START	STOP
13 SILVER 2	20%	21:00	21:05	21:00	21:05	21:00	21:05	21:00	21:05
14 SILVER 3									
15 YELLOW 1									
16 YELLOW 2									
17 ORANGE 1									
18 ORANGE 2									
19 REDDISH 1									
20 REDDISH 2									
21 BROWN 1									
22 BROWN 2									
23 BROWN 3									
24 BROWN 4									
25 BROWN 5									
26 BROWN 6									
27 BROWN 7									
28 BROWN 8									
29 BROWN 9									
30 BROWN 10									
31 BROWN 11									
32 BROWN 12									
33 BROWN 13									
34 BROWN 14									
35 BROWN 15									
36 BROWN 16									
37 BROWN 17									
38 BROWN 18									
39 BROWN 19									
40 BROWN 20									

SECRET

SECRET When Filled In

RECAPITULATION SHEET
BOMBARDMENT - RECONNAISSANCE - PART I

APP 1 to Annex 'B'
CAD Order: 22-58, 1 Oct 58

TARGET NAME AND COORDINATES		BPG REF NO	CGZ	PLANNED TIME	CELL CALL SIGN AND NUMBER	HEARIN MARKS	DEPART	ARRIVE	FLY	TYPE	TIME	AREA	REMARKS	DATE	TIME	TIME
S. S. BUCKY		20-41-25	01-40-04	N/A	N/A	VIGLT	N/A	N-011	2000	9506	WT	4115				
					VIGLT							4120				
					VIGLT							4121				
					BUFF							4119				
					BUFF							4200				

SECRET

NO

SECRET

~~SECRET~~

HEADQUARTERS 6TH AIR DIVISION
MACDILL AIR FORCE BASE, FLORIDA
1 October 1958

APPENDIX 2

TO

ANNEX "B"

OPERATIONS ORDER

SERIAL NO. 22-58

ROUTE PICTURE

App 2 to
Annex "B"
6AD OOrder 22-58
1 Oct 58

~~SECRET~~

11

APP 2 to
 Annex "H"
 GAD Order 22-58
 1 Oct 58

6TH AIR DIVISION OPS ORDER
 "GRAND SLAM"
 22-58

~~SECRET~~

~~SECRET~~

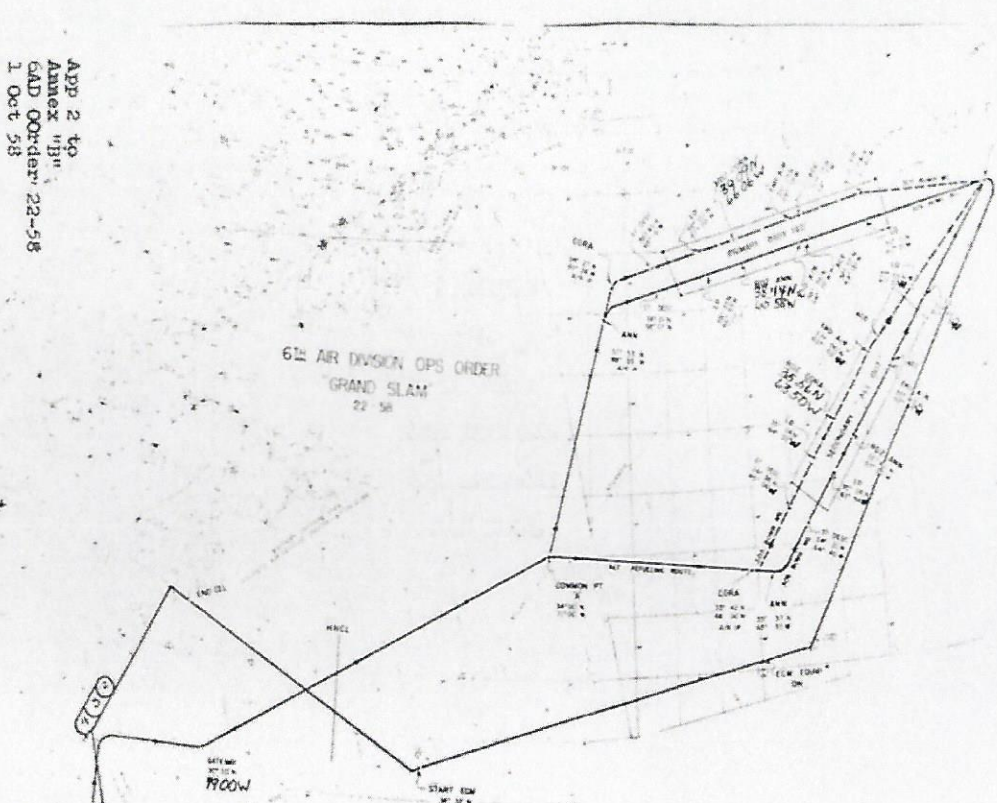

	306 BW	306 BW
T/O RATE	MAGELL	MAGELL
LANDING BASE	MAGELL	MAGELL
PRIMARY AIR	BAY BED CORA	BAY BED ANN
SECONDARY AIR	ALL OUT CORA	ALL OUT ANN
T/O GROSS WT	197,800	197,800
FUEL RESERVE	23,576	23,544
TARGET	AN BRIDGE NE OF ST WREPS	

~~SECRET~~

HEADQUARTERS 6TH AIR DIVISION
MACDILL AIR FORCE BASE, FLORIDA
1 October 1958

APPENDIX 3

TO

ANNEX "B"

OPERATIONS ORDER

SERIAL NO. 22-58

FLIGHT PLANS

App 3 to
Annex "B"
6AD OOrder 22-58
1 Oct 58

~~SECRET~~

ADDL
 1 Oct 58
 100-1007 22-18
 100-1007 22-18

MISSION FLIGHT PLAN - CONTINUATION SHEET

FROM	ROUTE	FLT COND	T.C.	WIND D/V	T.H.	VAR	M.H.	TEMP	IAS	T. A. S.	G. S.	GND DIS	TIME	AIR DIS	ETA	FUEL FLIGHT PLAN	
																PRED FUEL REMAINING	GROSS WT
39-00N/67-01W																62696	148200
CORA RNDZ				285/18								43	:07			1350	1350
39-09N/66-06W	CR	079		0	079	+18	097	15M		286	286	1371	3:17			61316	146850
END A/R				285/18								79	:19			6100	6100
39-25N/64-20W	CR	079		0	079	+18	097	15M		286	286	1450	3:36			55216	140750
ON LOAD																+ 30000	30000
																85216	170750
ACC TO CL SPEED			091	270/26						286	286	08	:02			700	700
				0	091	+20	111	15M		390	390	1158	3:18			84516	170050
L.O.	CL	091		270/26								76	:12			3200	3200
COMMON POINT "B"				0	091	+20	111	23-25		400	400	1574	3:50			81316	166850
39-31N/59-20W	CR	091		270/32								153	:20			4300	4300
				0	091	+21	115	23-25		425	425	1687	4:10			77016	162550
	ALTERNATE ROUTE																
CORA RNDZ 1P				275/32												73296	138900
39-42N/66-00W	CR	091		0	091	+12	106	29-31		430	430	1182	2:47			5900	5900
START DESCENT				273/32								73	:10			57196	153000
34-36N/65-06W	CR	036		-4	036	+35	047	29-31		430	408	1259	2:53			1200	1200
																65596	151200
TIME FUEL PAD																1500	1500
END DESCENT																64096	149500
35-21N/64-22W	CG	029		270/26								60	:08			700	700
CORA RNDZ																63296	148900
35-56N/63-50W	CR	039		270/26								43	:07			1350	1350
END A/R																62016	147550
37-00N/62-50W	CR	039		270/26								79	:19			6100	6100
																55916	143150
ON LOAD																+ 30000	30000
																85916	171150
ACC TO CL SPEED			049	270/26						286	286	08	:02			700	700
				-2	047	+20	067	15M		390	390	1445	3:35			85216	170750
L.O.	CL	049		270/26								76	:12			3200	3200
COMMON POINT "B"																82016	167550
39-25N/59-18W	CR	052		270/32								137	:18			3900	3900
																78316	163650
	COMMON ROUTE ALL AIRCRAFT																
LEVEL OFF START CEL																77016	162550
39-09N/59-13W	CL			270/32								30	:05			1200	1200
CONTROL POINT																75816	161350
32-18N/64-51W	CR	211		270/40								492	1:12			13650	13650
																62196	147700

SECRET

SECRET

MISSION FLIGHT PLAN - CONTINUATION SHEET

FROM	ROUTE	FLT COND	T.C.	WIND D/V		T.H.	VAR	M.H.	TEMP		T. A. S.	G. S.	GND DIS	TIME	AIR DIS		ETA	FUEL FLIGHT PLAN	
				DRIFT					ALT	MACH					ACC	ACC AIR DIS		PRED FUEL REMAINING	GROSS WT
JAX VOR				268/32										91	112			2000	2000
29-00N/81-00W	OR	161		+4	165	-1	160	33-35		430	440	3430	8:32					32396	117900
I. P.				268/32										37	105			32396	117900
28-25N/80-50W	OR	161		+4	165	-1	160	33-35	.81	460	470	3457	8:38					800	800
TGT				268/32										120	115			31596	117100
PT MEYERS	OR	209		+3	212	-1	211	31-35	.81	460	465	3587	8:50					2500	2500
				268/32										42	105			29096	114600
26-00N/81-15W	OR	177		+4	175	-2	173	32-35	.81	460	465	3629	9:00					960	960
PRE-IP				268/32										52	107			21136	113600
26-00N/82-30W	OR	270		0	270	-2	268	32-35	.81	460	430	3681	9:07					1100	1100
TP				268/32										46	105			27076	112500
26-40N/82-37W	OR	308		-4	300	-2	302	31-35	.81	460	460	3727	9:15					960	960
TGT				268/32										30	108			26076	111500
TPA J	OR	358		-4	360	-2	352	32-35	.81	460	460	3787	9:21					1300	1300
														72	110			24776	110200
TPA VOR										430	430	3809	9:31					1000	1000
																		21176	109800

APP 3 to Annex 11
 OAD Order 22-53
 1 Oct 58

SECRET

SECRET

APP 3 to Annex B
CAD Order 22-58
1 Oct 58

MISSION FLIGHT PLAN - CONTINUATION SHEET

FROM	ROUTE	FLT COND	T.C.	WIND D/V	T.H.	VAR	M.H.	TEMP	IAS	T. A. S.	G. S.	GND DIS	TIME	AIR DIS	ETA	FUEL FLIGHT PLAN	
																PRED FUEL REMAINING	GROSS WT
38-22N/66-52W				265/18				43				43	1:07			62966	147450
ANN RDZ				0	079	217	096	15		370	370	1358	3:16			61596	146100
38-10N/65-58W		CR	079	265/18								79	1:19			61000	61000
END AR				0	079		097			250	250	1437	3:35			55496	140000
38-56N/64-20W		CR	079													300000	300000
ON LOAD																85496	170000
ACC TO CL SPEED				270/26						286	286	08	1:02			700	700
			091	0	091	420	111	15K		390	390	1465	3:37			81796	169300
L/O				270/26								76	1:12			3200	3200
		CL	091	0	091	420	111	23-25		400	400	1521	3:39			81596	166000
COMMON POINT "B"				270/32								153	1:20			4300	4300
39-31N/59-20W		CR	094	0	094	421	115	23-25		425	458	1674	4:09			77296	161700
34-00N/71-00W																	
COMMON POINT "A"																	
35-37N				273/32								285	1:32			71296	158000
ARIP		CR	095	0	095	412	107	2-31		430	462	1217	2:48			7050	7050
ST				270/26								68	1:09			64206	151000
DBSO		CR	039	-3	036	415	051	29-31		430	448	1285	2:57			1000	1000
													1:06			63546	150000
																1600	1600
TIME FUEL PAD																1285	3:03
				270/26								60	1:08			63046	148000
L/O				-3	036	416	052	17-31		450	450	1345	3:11			700	700
RDZ				265/18								43	1:07			63046	147750
ANN				-3	036	417	053	14-18		370	370	1388	3:18			1350	1350
END				265/18								79	1:19			61936	146100
AR		CR	039	-2	037	418	055	14-18		250	250	1467	3:37			7100	6100
																55896	140500
																30000	30000
ON LOAD																85896	170300
ST CL		CR	039	265/18								8	1:02			700	700
ACC				-2	037	418	055	14-18		240	240	1475	3:39			85196	169500
				270/26								76	1:12			3200	3200
L/O		CL	039	-3	036	419	055	23-25		400	400	1551	3:51			81496	166000
COMMON				273/32								136	1:18			4100	4100
POINT "B"		CR	039	-4	035	421	056	23-25		430	450	1687	4:09			77576	162300
COMMON ROUTE																	
				ALL AIRCRAFT								1674	4:09			77296	161700
				270/32								30	1:05			1200	1200
LEVEL OFF ST CBL		CL	214	-3	211			28-30		400	400	1704	4:14			76096	160500
TIME				270/40								492	1:12			13500	13500
POINT		CR	214	25	219	418	237	30-32		430	408	2196	5:26			62596	147000

SECRET

SECRET

ADP 3-1-1964
 GAO OIG-100-22-10
 1 Oct 64

MISSION FLIGHT PLAN - CONTINUATION SHEET

FROM 26-00N/45W	FLT COND	T.C.	WIND D/V DRIFT	T.H.	VAR	M.H.	TEMP		IAS	T. A. S.	G. S.	GND DIS	TIME	AIR DIS	ETA	FUEL FLIGHT PLAN	
							ALT	MACH								ACC GND DIS	ACC TIME
ROUTE			268/32														
2600N			0	290	-2	268	33-35	.81	460	430	3714	9:08				1125	1125
82-35W	CR	270	268/32								46	1:06				2724	111645
26-45N			-4	354	-2	352	33-35	.81	460	460	3760	9:16				965	965
82-37W	CR	358	268/32								60	1:08				76276	110680
Target TAMPA J.			-4	354	-2	352	33-35	.81	460	460	3820	9:22				1280	1280
TAMPA VOR	CR										72	1:10				26996	109600
											430					1350	1350
											3842	9:32				23666	108050

~~SECRET~~

~~SECRET~~

~~SECRET~~

HEADQUARTERS 6TH AIR DIVISION
MACDILL AIR FORCE BASE, FLORIDA
1 October 1958

APPENDIX 4

TO

ANNEX "B"

OPERATIONS ORDER

SERIAL NO. 22-58

FORM F

App 4 to
Annex "B"
6AD OOrder 22-58
1 Oct 58

~~SECRET~~

DATE	AIRPLANE TYPE	SECRET	FROM	HOME STATION	
	B-47		MACDILL	MACDILL	
MISSION/Trip/FLIGHT NO.	SERIAL NO.		TO	PILOT	
			MACDILL		
REMARKS	DENSITY 6.4				
T/O	INDEX	REF	ITEM	WEIGHT	INDEX OR MOM
AM 17500	778	1	BASIC AIRPLANE (From Chart C) (WG TKS)	84560	290
FM 18500	398	2	OIL (52.5 Gal.)	394	290
CM 18000	418				
ATO 7800	556	3	DISTRIBUTION OF LOAD		
FAUX 6700	342				
BB 18496	423				
WG 20000	556				
TOT 106996	556				
LANDING					
FM 7000	068				
CM 7000	078				
AM 10000	382				
TOT 24000	382				
COMPUTER PLATE NO. (If used)	E 1062				
Pertinent Instructions to the pilot for shifting load and crew during takeoff and landing should be noted above.		4	OPERATING WEIGHT	87213	206
CORRECTIONS (Ref. 11)		5	COMPT. ROUNDS CALIBER		
CHANGES (+ or -)			H 700 20MM	441	233
COMPT.	START ITEM ENG	WEIGHT	INDEX OR MOM		
	15 MIN BEFORE T/O				
G	S/T/RU/T/O FUEL	900	512		
D	"	900	512		
F	"	900	482		
D	T/O W/A (62 SEC)	4400	540		
T/O TRIM					
3/2 ND (SLIGHT PULL)					
TOTAL WEIGHT REMOVED		-	-		
TOTAL WEIGHT ADDED		+ - + -			
NET DIFFERENCE (Ref. 11)		7100	540		
32 Ply Tires LIMITATIONS					
GROSS WT. TAKEOFF (lb.)		GROSS WT. LANDING (lb.)			
221000		125000			
PERMISSIBLE C.G. TAKEOFF	FROM 21%	TO (% M.A.C. @ IN.)	34		
PERMISSIBLE C.G. LANDING	FROM 11.4%	TO (% M.A.C. @ IN.)	34		
App 4 No Annex "B"					
6AD OOrder 22-58					
1 Oct 58					
DD FORM 1 SEPT 54 365F					
COMPUTED BY (Signature)					
WEIGHT AND BALANCE AUTHORITY (Signature)					
PILOT (Signature)					

SECRET

~~SECRET~~

HEADQUARTERS 6TH AIR DIVISION
MACDILL AIR FORCE BASE, FLORIDA
1 October 1958

APPENDIX 5

TO

ANNEX "B"

OPERATIONS ORDER

SERIAL NO. 22-58

MONTHLY GROSS WEIGHT ADJUSTMENT

(OMITTED)

App 5 to
Annex "B"
6AD OOrder 22-58
1 Oct 58

~~SECRET~~

~~SECRET~~

HEADQUARTERS 6TH AIR DIVISION
MACDILL AIR FORCE BASE, FLORIDA
1 October 1958

APPENDIX 6

TO

ANNEX "B"

OPERATIONS ORDER

SERIAL NO. 22-58

ARTC B-47 FORM 121'S

App 6 to
Annex "B"
6AD OOrder 22-58
1 Oct 58

~~SECRET~~

60

~~SECRET~~

STANDARD FORMAT FOR ALTITUDE RESERVATION FLIGHT PLAN				
E. AND CATEGORY NUMBER OF MISSION				
GRAND SLAM/ 1		PRIMARY AND ALTERNATE ROUTE		
A. UNIT TACTICAL CALL SIGN	PR		SOC DROP 6	DUTY PHONE
305 and 306 EWING	foia (b)(6)			36-711
TAG CALL SIGN PLUS TWO DIGIT	(b)(6)		SOC DROP 24	38-001
HOME PHONE				
63-2381				
65-3771				
B. NUMBER AND TYPE OF AIRCRAFT				
76 B-47s (38-305 th BOMB WING AIRCRAFT and 38-306th BOMB WING AIRCRAFT)				
C. POINT OF DEPARTURE				
MACDILL AIR FORCE BASE, FLORIDA				
D. ALTITUDES AND ROUTE (If additional space is required, continue on reverse and identify as "D" continued.)				
CLIMB ELMONT KEY :07				
CLIMB FORT MYERS DEPT. :19				
25-27N	2654N	8132W	L.O.	:27
25-27N	3015N	8125W	START CLIMB	:54
27-29N	3028N	8040W	L.O.	:58
27-29N	3030N	7900W		1:11
27-29N	3000N	7100W	COMMON POINT "F" START CLIMB	2:11
PRIMARY ROUTE AIR REFUELING (BABY BED) "ANN"				
29-31N	3430N	7047W	L.O.	2:15
29-31N	3753N	6935W		2:45
29-31N	3821N	6807W	START DESCENT	2:55
11-31N	3833N	6653W	L.O.	3:09
11-18N	3857N	6409W	START CLIMB	3:37
11-25N	3711N	6231W	L.O. 23-25M	3:49
23-25N	3931N	5920W	COMMON POINT "B"	4:09
(CONTINUED ON NEXT PAGE)				
E. DESTINATION				
MACDILL AIR FORCE BASE, FLORIDA				
F. ETD DATE TIME				
AS EXECUTED BY SAC IN NOVEMBER 58				
ETD Times listed on page 3 in relation to "E" hour				
G. TAS				
LOS KNOLS				
H. ETE				
9:14 TIMES ARE FOR THE FIRST AIRCRAFT				
REMARKS (Include estimated cumulative elapsed times between reporting/turning points and any other information pertinent to the mission. If additional space is required, continue on reverse.)				
PARSA IN BABY BED REFUELING AREA WITH TANKERS (KC-97) FROM HUNTER AND PEASE AFB AND 301st. BOMB WING.				
App 6 63				
Annex "B"				
D Order 22-58				
1 Oct 58				

~~SECRET~~

("D" CONTINUED) SAC FR 121

PRIMARY ROUTE AIR REFUELING (BABY BED) "CORA"

29-31M	3753N	6935W		2:45
29-31M	3827N	6928W		2:50
29-31M	3845N	6816W	START DESCENT	2:55
31-14M	3900N	6700W	L.O.	3:09
14-18M	3926N	6417W	START CLIMB	3:37
14-25M	3941N	6240W	L.O.	3:49
23-25M	3931N	5920W	COMMON POINT "B"	4:09

COMMON ROUTE ALL AIRCRAFT

28-30M	3909N	5915W	L.O.	4:14
28-30M	3218N	6451W	START CLIMB	5:26
30-32M	3214N	6525W	L.O.	5:30
30-32M	3032N	7400W	START CLIMB	6:41
32-34M	3034N	7425W	L.O.	6:45
32-34M	3118N	7600W	START CLIMB	6:59
33-35M	3125N	7615W	L.O.	7:01
33-35M		CHARLESTON VOR		7:34
33-35M	3230N	8100W	ENTER MANUEVER AREA	7:51
MANUEVER AREA BOUNDRIES, 3015N 8125W, 3015N 8200W, 3230N 8100W, 3230N 8135W				
33-35M		JACKSONVILLE VOR		8:00
33-35M	3015N	8130W	EXIT MANUEVER AREA	8:01
33-35M	2825N	8050W		8:19
33-35M		FORT MYERS FLA.		8:35
33-35M		NAPLES FLA.		8:41
33-35M	2600N	8235W		8:48
33-35M		TAMPA FLA.		9:02
33-35M		DADE CITY		9:06
33-35M		TAMPA VOR		9:14
				TOTAL TIME

ALTERNATE AIR REFUELING ROUTE (ALLOUT) "ANN"

27-29M	3400N	7100W	COMMON POINT "A" ST. CLIMB	2:11
29-31M	3400N	7032W	L.O.	2:15
29-31M	3337N	6533W		2:48
29-31M	3421N	6410W	START DESCENT	2:57
31-14M	3508N	6345W	L.O.	3:11
14-18M	3647N	6212W	START CLIMB	3:39
14-25M	3748N	6113W	L.O.	3:51
23-25M	3925N	5918W	COMMON POINT "B"	4:09

ALTERNATE AIR REFUELING ROUTE (ALL OUT) "CORA"

27-29M	3400N	7100W	COMMON POINT "A" ST. CLIMB	2:11
29-31M	3400N	7032W	L.O.	2:15
29-31M	3342N	6600W		2:44
29-31M	3436N	6506W	START DESCENT	2:57
31-14M	3524N	6422W	L.O.	3:11
14-18M	3712N	6240W	START CLIMB	3:39
14-25M	3758N	6132W	L.O.	3:51
23-25M	3925N	5918W	COMMON POINT "B"	4:09

AT COMMON POINT "B" ALL AIRCRAFT WILL FOLLOW COMMON ROUTE TO TAMPA VOR.

~~SECRET~~

SECTION "F" CONTINUED

<u>UNIT</u>	<u>CELL</u>	<u>T.O. TIME</u>	<u>E-PLUS</u>
306EW	BLUE 4 B-47		E PLUS 2:19
305BW	GREY 4 B-47		2:50
306EW	BRONZE 4 B-47		3:19
305BW	PINK 4 B-47		3:50
306EW	BROWN 4 B-47		4:19
305BW	ORANGE 4 B-47		4:50
306EW	SILVER 3 B-47		5:19
305BW	RED 4 B-47		5:50
306EW	YELLOW 2 B-47		25:19
305BW	GREEN 2 B-47		25:50
306EW	CORAL 2 B-47		26:19
305BW	WHITE 3 B-47		26:50
306EW	CHERRY 2 B-47		27:19
305BW	PEACH 2 B-47		27:50
306EW	RUST 2 B-47		28:19
305BW	LIME 2 B-47		28:50
306EW	MAROON 2 B-47		29:19
305BW	PURPLE 2 B-47		29:50
306EW	PINTO 2 B-47		30:19
305BW	WALNUT 2 B-47		30:50
306EW	OLIVE 2 B-47		38:19
305BW	GOLD 2 B-47		38:50
306EW	CHROME 2 B-47		39:19
305BW	MAPLE 2 B-47		39:50
306EW	CARDINAL 2 B-47		40:19
305BW	INDIGO 3 B-47		40:58
306EW	VIOLET 3 B-47		41:19
305BW	MAHOGANY 2 B-47		41:50
306EW	BUFF 2 B-47		42:20

App 6 to
Annex "B"
6AD Order 22-58
1 Oct 58

3

63

~~SECRET~~

C

1 1

~~SECRET~~

HEADQUARTERS 6TH AIR DIVISION
MACDILL AIR FORCE BASE, FLORIDA
1 October 1958

ANNEX "C"
TO
OPERATIONS ORDER
SERIAL NO. 22-58
KC-97 OPERATIONS

Annex "C" to
6AD OOrder 22-58
1 Oct 58

64

~~SECRET~~

~~SECRET~~

HEADQUARTERS 6TH AIR DIVISION
MACDILL AIR FORCE BASE, FLORIDA
1 October 1958

ANNEX "C"

TO

OPERATIONS ORDER

SERIAL NO. 22-58

KC-97 OPERATIONS

1. GENERAL:

a. Upon receipt of the advanced condition of readiness, the 305th and 306th Air Refueling Squadrons will generate all available aircraft in accordance with 6th Air Division Operations Order 44-59 and Supporting Plans, as amended by this Order.

2. All available aircraft and crews will participate in this exercise as outlined in the assigned EWO.

3. 306TH AREFS:

a. Four (4) KC-97 aircraft will be utilized to airlift a Twenty (20) KC-97 Turn Around Team to GOOSE AFB to provide support for "LEAP FROG" units. Launch times for these aircraft will be in accordance with the Recap Sheets, this Annex.

b. The remaining aircraft will be generated and will participate in the preparation phase of this exercise only. These aircraft may be loaded as required to meet the current training schedule.

Annex "C" to
6AD OOrder 22-58
1 Oct 58

~~SECRET~~

65

~~SECRET~~

- c. Aircraft generated subsequent to the first four (4) KC-97's will be released from this exercise as they become generated. At the discretion of the Wing Commander, these aircraft may then be used to meet current operational commitments.
- d. Route and weather briefings will be conducted by the 305th AREFS Operations in the Squadron Briefing Room.
- e. Deployment and Redeployment routes and fuel loads will be in accordance with attached flight plans, this Annex.
- f. Aircraft Commanders will submit completed Form 175's (Section C will contain detailed route, as outlined in Appendix 4, this Annex, followed by the phrase "GRAND SLAM DEPLOY").
- g. Communications will be in accordance with Annex "D", this Order.
- h. The four (4) deployed KC-97 aircraft, crews and Turn Around Team will come under the operational control of the GOOSE Task Force during this mission.
- i. Upon completion of strike refueling operations, Headquarters. SAC will release the deployed tankers to the Numbered Air Force for redeployment to home station.
- j. Deploying aircraft will maintain one (1) thousand foot vertical separation, with the first and third aircraft flying at 10,000 feet, and the second and fourth aircraft flying at 11,000 feet.
- k. Maximum 50-8 accomplishments will be obtained on both deploy and redeploy routes.

Annex "C" to
GAD OOrder 22-58
1 Oct 58

2

~~SECRET~~

~~SECRET~~

4. 306TH AREFS:

- a. Three (3) KC-97's and crews will be placed on strip alert for the duration of this exercise to provide emergency air refueling for the 305th, 306th and 321st Bomb Wings' B-47's.
- b. The remaining generated aircraft will participate in the preparation phase of this exercise only. These aircraft may be loaded as required to meet the current training schedule. Sorties one (1) through four (4) will be maintained on RDS and sorties five (5) through seven (7) will be assigned strip alert. All subsequent aircraft will be released from this exercise as they become generated. At the discretion of the Wing Commander, aircraft may then be used to meet current operational commitments.
- c. B-47's requiring the strip alert aircraft will contact the 306th Bomb Wing Command Post.

~~SECRET~~

HEADQUARTERS 6TH AIR DIVISION
MACDILL AIR FORCE BASE, FLORIDA
1 October 1958

APPENDIX 1

TO

ANNEX "C"

OPERATIONS ORDER

SERIAL NO. 22-58

TIMING SUMMARY

App 1 to
Annex "C"
6AD OOrder 22-58
1 Oct 58

68

~~SECRET~~

~~SECRET~~

HEADQUARTERS 6TH AIR DIVISION
MACDILL AIR FORCE BASE, FLORIDA
1 October 1958

APPENDIX 1

TO

ANNEX C

KC-97 TIMING SUMMARY SHEET

1. Deployment

Line #	Call Sign	Aircraft Commander	McD Dep Time		Altitude	ETA Goose	
			A +	Z		A+	Z
			3:00		11M	1202	
			3:29		11M	1231	
			3:30		10M	1232	
			4:00		11M	1302	

2. Redeployment

Line #	Call Sign	Aircraft Commander	Goose Dep Time		Altitude	ETA McD	
			A +	Z		A+	Z

App 1 to
Annex C
6AD OOrder 22-58
1 Oct 58

69

~~SECRET~~

SECRET

HEADQUARTERS 6TH AIR DIVISION
MACDILL AIR FORCE BASE, FLORIDA
1 October 1958

APPENDIX 2

TO

ANNEX "C"

OPERATIONS ORDER

SERIAL NO. 22-58

ROUTE PICTURE

App 2 to
Annex "C"
6AD OOrder 22-58
1 Oct 58

SECRET



SECRET

SECRET

App 2 to
Annex C
6AD 00Order 22-58
1 Oct 58

~~SECRET~~

HEADQUARTERS 6TH AIR DIVISION
MACDILL AIR FORCE BASE, FLORIDA
1 October 1958

APPENDIX 3

TO

ANNEX "C"

OPERATIONS ORDER

SERIAL NO. 22-58

FLIGHT PLANS

App 3 to
Annex "C"
6AD OOrder 22-58
1 Oct 58

72

~~SECRET~~

MISSION FLIGHT PLAN		O. O. AND NICKNAME		UNIT	TYP. ALT	WAVE	CELL CALL SIGN	REMARKS									
		CMA 22-58		305AREFS	KC-97			Deploy - T/A/T									
ACFT BASIC		POUNDS	1	10354	POUNDS			RUNWAY									
CREW		2124	2	8892	BOMBS			PRESSURE ALT									
OIL		1320	3	8892	AMMO			LENGTH									
ADDITIONAL PAX		453	4	10355	WATER AUG			AIR TEMP									
RACK			CR	7079	STATIC	157763		CRITICAL FIELD LENGTH									
EXT TANKS WEIGHT (Empty)					START ENGINES AND TAXI FUEL ALLOWANCE	1000	NR FULL ATO REQUIRED	CRITICAL AIR TEMP									
MISCELLANEOUS		1494			TAKE-OFF GROSS	156763	NR EMPTY ATO REQUIRED	TAKE-OFF DISTANCE									
ADDITIONAL PAX		15300	TOTAL FUEL	45572	TAKE-OFF GROSS	156763	ATO FIRING SPEED	TAKE-OFF SPEED									
OPERATING		112191						CRITICAL WIND COMPONENT									
								1ST LEG									
								2ND LEG									
								3RD LEG									
PRE-FLIGHT PLAN																	
FROM	ROUTE	FLY COND	T. C.	WIND D V	T. H.	VAR	M. H.	TEMP	IAS	T. A. S.	G. S.	GND DIS	TIME	AIR DIS	ETA	FUEL FLIGHT PLAN	
MACDILL AFB				DRIFT				ALT	MACH			ACC GND DIS	ACC TIME	ACC AIR DIS		PRED FUEL REMAINING	GROSS WT
TO & ACC	RTTU															45572	156763
Segment	27-34N	CL 1	220			-2			170	196	196	22	107	22		1375	375
Key	82-46W	CL 1	002			-2			170	196	196	22	110	22		43322	156388
40		CL 1	002			-2			170	196	196	43	113	43		1625	1625
14 N.M. West	29-39N	CR 1	002	280/10	359	-2	357	11M	177	215	213	79	122	79		1550	1550
Gainesville VOR	82-42W	CR 1	002	-3				11M	177	215	213	144	145	144		40147	152338
Alma VOR	31-32N	CR 2	002	290/10	000	0	000	0	177	215	212	118	133	118		2300	2300
12 NM West	33-32N	CR 3	002	280/15				0	177	214	211	262	118	121		37847	150038
Augusta VOR	82-24W	CR 3	002	-4	358	0	358	11M	177	214	211	382	118	383		35667	147798
Ashville VOR	35-24N	CR 4	002	280/15				0	177	214	211	112	132	114		2190	2190
19NM West	37-13N	CR 5	028	280/15				0	177	214	218	494	214	497		33417	145608
Pulaski VOR	81-05W	CR 5	028	-4	024	12	026	11M	177	214	218	618	218	619		31447	143638
Elkins RING	38-56N	CR 6	028	280/15				-5	177	212	216	117	132	113		1800	1800
18NM S.E.	41-09N	CR 7	050	280/15				-5	176	211	220	735	3130	732		29647	141838
Williamsport VOR	76-35W	CR 7	050	-3	047	16	053	11M	176	211	220	203	155	193		3000	3000
Albany RING	42-47N	CR 8	052	270/20				-5	175	210	226	938	4125	925		26647	138838
37NM N.W.	44-35N	CR 9	050	270/20				-5	175	210	225	158	142	147		2240	2240
Lewiston	70-46W	CR 9	050	-3	047	16	063	11M	175	210	225	1096	5107	1072		24407	136598
Houlton RING	46-10N	CR 10	051	270/20				-5	174	209	224	171	146	161		2390	2390
49-14N	67-47W	CR 10	051	-3	048	19	067	11M	174	209	224	1267	5153	1233		22017	134208
64-59W	49-14N	CR 11	032	270/20				-5	173	207	217	158	142	146		2160	2160
	64-59W	CR 11	032	-5	027	24	051	11M	173	207	217	1425	6135	1379		19857	132048
												216	1100	207		2960	2960
												1641	7135	1586		16897	129088

Apr 3, Annex C, GAD OFFICE 22-58

SECRET

App 3, Annex C, 6AD Order 22-58, dated 100558

MISSION - LIGHT PLAN		O. O. AND NICKNAME GRAND SIAM		UNIT 305 AREFS	TYF KC-97	WAVE	CELL CALL SIGN	REMARKS REDEPLOY
ACFT BASIC	POUNDS	1	10354					
CREW		2	8892	BOMBS				
OIL		3	8892	AMMO				
WATER AUG		4	10355					
WATER AUG		QW	7079	STATIC	157763	NR FULL ATO REQUIRED		
EXT TANKS WEIGHT (Empty)				START ENGINES AND TAXI FUEL ALLOWANCE	1000	NR EMPTY ATO REQUIRED		
MISCELLANEOUS	1494			TAKE-OFF GROSS	156763	ATO FIRING SPEED		
OPERATING	112191	TOTAL FUEL	45572					

PRE-FLIGHT PLAN																	
FROM	ROUTE	FLT COND	T. C.	WIND D/V DRIFT	T. H.	VAR	M. H.	TEMP ALT	IAS MACH	T. A. S.	G. S.	GND DIS ACC GND DIS	TIME ACC TIME	AIR DIS ACC AIR DIS	ETA	FUEL FLIGHT PLAN PRED FUEL REMAINING	GROSS WT
GOOSE BAY																45572	156763
T.O. & ACC		RTG											:03			1375	375
													:03			44197	156388
												61	:19	61		2380	2380
												61	:22	61		41817	154008
												240	1:10	246		4960	4960
	62-14N 64-59W	CR1	215	290/20	220	428	248	12M	177	212	206	301	1:32	307		36857	149048
	46-10N			270/20				-7				15	1:03	227		4200	4200
	MILTON RING 67-47W	CR2	212	290/20	217	424	241	12M	177	216	206	516	2:35	534		32657	144848
	17 NM NW			270/20				-7				158	:47	169		2760	2760
	NEWLSTON 70-46W	C3	232	290/20	235	419	254	12M	177	216	200	674	3:22	703		29897	142088
	42-47N			270/20				-7				171	:51	184		2910	2910
	ALBANY RING 73-48W	C4	231	290/20	234	416	250	12M	177	216	200	845	4:13	887		26987	139178
	18 NM SE			270/20				-7				158	:48	171		2670	2670
	WILLIAMSPORT VOR 76-35W	C5	232	290/20	235	412	247	12M	176	214	198	1003	5:01	1058		24317	136508
	38-56N			280/15				-7				203	1:00	212		3220	3220
	BLIKINS VOR 79-54W	C6	230	280/15	233	416	239	12M	174	212	203	1206	6:01	1270		21097	133288
	19 NM WEST			280/15				-2				117	:34	122		1780	1780
	PULASKI VOR 81-05W	C7	209	280/15	213	413	216	12M	173	213	208	1323	6:35	1392		19317	131508
	35-24N			280/15				-2				124	:36	128		1830	1830
	ASHVILLE VOR 82-16W	C8	208	280/15	212	412	214	12M	173	213	208	1447	7:11	1520		17487	129678
	12 NM WEST			280/15				-2				112	:31	109		1550	1550
	AUGUSTA VOR 82-24W	C9	182	280/15	186	410	186	12M	172	212	214	1559	7:42	1629		15937	128128
	31-32W			290/10				0				120	:34	119		1690	1690
	AIMA VOR 82-32N	C10	182	290/10	185	410	185	12M	171	211	214	1679	8:16	1748		14247	126438
	7 NM WEST			280/10				2				119	:33	116		1610	1610
	SAINESVILLE VOR 82-31W	C11	179	280/10	182	411	181	12M	171	211	214	1798	8:49	1864		12637	124828
				280/10				2				103	:29	102		1390	1390
	MACDILL AFB	C12	179	280/10	182	411	180	12M	170	210	213	1901	9:18	1966		11247	123438

SECRET

SECRET

page 3

~~SECRET~~

HEADQUARTERS 6TH AIR DIVISION
MACDILL AIR FORCE BASE, FLORIDA
1 October 1958

APPENDIX 4

TO

ANNEX "C"

OPERATIONS ORDER

SERIAL NO. 22-58

AFM KC-97 FORM 121'S

App 4 to
Annex "C"
6AD OOrder 22-58
1 Oct 58

76

~~SECRET~~

~~SECRET~~

STANDARD FORMAT FOR ALTITUDE RESERVATION FLIGHT PLAN			
NAME AND CATEGORY NUMBER OF MISSION			
GRAND SLAM DEPLOYMENT 1			
A. UNIT TACTICAL CALL SIGN CURRENT TACTICAL CALL SIGN + 2 DIGITS	PROJECT OFFICER (Name and Grade) Major William F Lane Sr	DUTY PHONE 34-781	HOME PHONE 8-2584
B. NUMBER AND TYPE OF AIRCRAFT 4 KD-97 (305 AREFS)			
C. POINT OF DEPARTURE MACDILL AFB			
D. ALTITUDES AND ROUTE (If additional space is required, continue on reverse and identify as "D1" continued.)			
CLIMB	TO	EGMONT KEY	:10
CLIMB	TO	L.O. 28-41N/82-42W	:23
10-11M	TO	29-39N/82-42W	:45
10-11M	TO	ALMA VOR 31-32N/82-32W	1:18
10-11M	TO	33-32N/82-24W	1:52
10-11M	TO	ASHVILLE 35-21N/82-16W	2:24
10-11M	TO	37-13N/81-05W	2:58
10-11M	TO	ELKINS RNG	3:30
10-11M	TO	41-09N/76-35W	4:25
10-11M	TO	ALBANY RNG	5:07
10-11M	TO	44-35N/70-46W	5:53
10-11M	TO	HOULTON RNG 46-10N/67-47W	6:35
10-11M	TO	49-14N/64-59W	7:35
10-11M	TO	52-00N/62-00W	8:33
10-11M	TO	GOOSE BAY	9:02
E. DESTINATION GOOSE BAY AFB			
F. ETD DATE/TIME AS EXECUTED BY HQ SAC DURING NOVEMBER 1958 "A" HOUR PLUS 3:00 1 AIRCRAFT 3:30 2 AIRCRAFT 4:00 1 AIRCRAFT			
G. TAS 210			
H. ETE 9:02			
REMARKS (Include estimated cumulative elapsed times between reporting turning points and any other information pertinent to the mission. If additional space is required, continue on reverse.) 1. MARSA WITH OTHER 305 AREFS AIRCRAFT PARTICIPATING IN THIS OPERATION. App 4 to Annex C 6AD OOrder 22-58 1 Oct 58			

~~SECRET~~

STANDARD FORMAT FOR ALTITUDE RESERVATION FLIGHT PLAN			
NAME AND CATEGORY NUMBER OF MISSION			
GRAND SLAM 3 (REDEPLOY)			
A. UNIT TACTICAL CALL SIGN ASSIGNED TACTICAL CALL SIGN + 2 DIGITS		PROJECT OFFICER (Name and Grade) Major #117en F Lane Sr	DUTY PHONE 34-791
HOME PHONE 8-2584			
B. NUMBER AND TYPE OF AIRCRAFT			
1 KC-97 (305 AREFS)			
C. POINT OF DEPARTURE			
GOOSE BAY AFB			
D. ALTITUDES AND ROUTE (If additional space is required, continue on reverse and identify as "D-1" continued.)			
CLIMB	TO	10 52-32N/61-23W	1:22
12M	TO	49-11N/64-55W	1:32
12M	TO	46-10N/67-47W	2:35
12M	TO	44-35N/70-46W	3:22
12M	TO	ALBANY RNG 42-47N/73-48W	4:13
12M	TO	41-09N/76-35W	5:01
12M	TO	ELKINS VOR 38-56N/79-54W	6:01
12M	TO	PULASKI VOR 37-13N/81-05W	6:35
12M	TO	ASHVILLE VOR 35-24N/82-16W	7:11
12M	TO	33-32N/82-24W	7:42
12M	TO	ALMA VOR 31-32N/82-32W	8:16
12M	TO	29-34N/82-31W	8:49
12M	TO	MACDILL AFB	9:18
E. DESTINATION			
MACDILL AFB			
F. ETD DATE, TIME			
AS DIRECTED BY SAC			
G. TAS			
212			
H. ETE			
9:18			
REMARKS (Include estimated cumulative elapsed times between reporting/turning points and any other information pertinent to the mission. If additional space is required, continue on reverse.)			
1. MARSA WITH OTHER 305 AREFS AIRCRAFT PARTICIPATING IN THIS OPERATION.			
App 4, to Annex C 6AD OOrder 22-58 1 Oct 58			

~~SECRET~~

A

B

C

D

1 1

~~SECRET~~

HEADQUARTERS 6TH AIR DIVISION
MACDILL AIR FORCE BASE, FLORIDA
1 October 1958

ANNEX "D"

TO

OPERATIONS ORDER

SERIAL NO. 22-58

COMMUNICATIONS

ANNEX "D" to
6AD OOrder 22-58
1 Oct 58

~~SECRET~~

~~SECRET~~

HEADQUARTERS 6TH AIR DIVISION
MACDILL AIR FORCE BASE, FLORIDA
1 October 1958

ANNEX "D"

TO

OPERATIONS ORDER

SERIAL NO. 22-58

COMMUNICATIONS

1. GENERAL: Second Air Force Operations Plan 300-59, SAC CEI, CED, Radio Facility Charts (United States, North Atlantic and East Canada), Flight Planning Document, Supplementary Flight Information Documents, appropriate JANAP's, ACP's, SAC Manuals in the 55-8 series, SAC Manual 55-12, procedures apply except as modified herein. /U/
2. EMERGENCY PROCEDURES:
 - a. In accordance with JANAP 130 () and 135 (), Radio Facility Charts, Supplementary Flight Information Document for DF procedures and distress and rescue procedures. /U/
 - b. Emergency use of IFF in accordance with JANAP 160 and SACR 55-23. /U/
 - c. Aircraft may communicate on any frequency with any station, air or ground in emergency. /U/
3. AUTHENTICATION, RECOGNITION, AND IDENTIFICATION:
 - a. Authentication: In accordance with KAC-1/TSEC. /U/
 - b. Recognition: Challenge reply with KAC-1/TSEC. /U/
 - c. Identification and IFF: Cell leader and individual aircraft on mode II, other aircraft on standby. /S/

Annex "D" to
6AD OOrder 22-58
1 Oct 58

~~SECRET~~

~~SECRET~~

4. CHANNELIZATION: In accordance with current Wing flip cards. /U/

5. CALL SIGNS:

- a. Air/Ground: Unit Tactical Call Sign plus 2 digit number. /U/
- b. Air/Air: Cell designator plus position in cell. /U/
- c. Air Refueling: In accordance with SACM 100-1. /U/
- d. All SAC Aircraft: SKY KING. /U/
- e. Any SAC Ground Station: SKYBIRD CONTROL. /U/

6. RECALL WORDS: *

- a. All "GRAND SLAM" aircraft: PLEASANT. /S/
- b. 305th "GRAND SLAM" aircraft:
 - (1) B-47 - PLEASANT SUNFISH. /S/
 - (2) KC-97 - PLEASANT PANCAKE. /S/
- c. 306th "GRAND SLAM" aircraft: PLEASANT FOXY. /S/

*Wing Tactical Call Signs in accordance with SACM 100-1 series.

p. PROCEDURES:

- a. Alfa Monitor Procedure: Cell leaders will designate aircraft to monitor the following frequencies in the order listed:
11228, 6730.5, 15016 and 4724.5 KCS.
- b. Position Reporting Procedures: Procedure Alfa applies for position reporting (SACM 55-3M, as modified by SACM 55-12). All civil procedures will be complied with as required by appropriate Facility Charts and SFID's. /U/
- c. Reports: B-11, T-11 and T-18 will be submitted to nearest SAC Command Post via UHF. /C/
- d. Air Refueling in accordance with SACM 100-1. /U/
- e. NOAH'S ARK procedures will apply for this mission. KAC-72 will be used for decoding NOAH'S ARK messages.

SECRET

- f. Strip alert tankers: Aircraft requiring strip alert tankers from MacDill AFB contact Foxy control on 321.0 MCS. Control Room will advise concerning C/R plan, RDZ, heading and altitude.
- 8. DISTRESS AND RESCUE FREQUENCIES:
 - a. One (1) of Alfa monitor frequencies when out of ZI if time permits otherwise activate Emergency Keyer on 8364 KCS. /U/
 - b. 243.0 MCS. /U/
 - c. 282.8 for coordination with Air Sea Rescue. /U/

~~SECRET~~

HEADQUARTERS 6TH AIR DIVISION
MACDILL AIR FORCE BASE, FLORIDA
1 October 1958

APPENDIX 1

TO

ANNEX "D"

OPERATIONS ORDER

SERIAL NO. 22-58

COMMUNICATIONS RECAP - FORM 100

App 1 to
Annex "D"
6AD OOrder 22-58
1 Oct 58

~~SECRET~~

A

B

C

D

E

1 1

~~SECRET~~

HEADQUARTERS 6TH AIR DIVISION
MACDILL AIR FORCE BASE, FLORIDA
1 October 1958

ANNEX "E"

TO

OPERATIONS ORDER

SERIAL NO. 22-58

ELECTRONIC COUNTER MEASURES

ANNEX "E" to
6AD OOrder 22-58
1 Oct 58

~~SECRET~~

~~SECRET~~

HEADQUARTERS 6TH AIR DIVISION
MACDILL AIR FORCE BASE, FLORIDA
1 October 1958

ANNEX "E"

TO

OPERATIONS ORDER

SERIAL NO. 22-58

ELECTRONICS COUNTER MEASURES

1. GENERAL INSTRUCTIONS:

- a. The ECM activity of this mission is designed to activate a portion of the Radars of the 35th Air Division (Defense), and by evasion, deception and electronic and/or mechanical jamming, to arrive at the target area with a minimum number of radar and/or fighter intercepts. /C/
- b. Necessary clearances for ECM activity will be coordinated by 2AF. ECM transmitters will be placed on "Standby" 15 minutes after take off. Individual crews will monitor normal communication channels. AFR 55-44 and applicable supplements will govern use of ECM equipment at all times. /C/

2. ROUTE:

- a. ECM "On" Line.
 - (1) The ECM "On" line bisects the track at 6600W.
 - (2) At this time, all electronic jammers and single unit chaff dispensers will be activated. Continuous jamming and chaff dispensing will take place until a point abeam Charleston, South Carolina is reached (32-56N/80-00W),

Annex "E" to
6AD OOrder 22-58
1 Oct 58

87

~~SECRET~~

~~SECRET~~

at which time all countermeasures will cease.

- (3) Upon receipt of the code word "STOP BUZZER", transmitted from an ADC site, all electronic countermeasures will cease. The code word "STOP STREAM" indicates all chaff dispensing will cease.

3. EQUIPMENT LOADING:

a. Jammers.

- (1) Equipment loading will be either 2 "L" band and 1 "S" band or 3 "S" band transmitters for Phase II aircraft. Phase III aircraft will either have 1 "L" band and 1 "S" band or 2 "S" band transmitters, as indicated in SAC Form 99, Appendix 1, this Annex. /C/

b. Chaff.

- (1) Chaff inserts will be used as available and will be loaded on the earliest aircraft generated. Additional generated sorties will hand-load training chaff only.
- (2) Chaff inserts will be loaded on earliest generated sorties until supply is exhausted. EWO chaff will be taped to side of insert to insure that EWO chaff cannot be dispensed through strippers. One (1) carton of RR-20 chaff will be top loaded in left chaff insert, and proper precaution will be taken that rope chaff, pre-loaded in left insert, cannot be dispensed. Six (6) carton of RR-39 training chaff will be top loaded in right insert, and

~~SECRET~~

proper precautions will be taken to insure that EWO chaff cannot be dispensed.

- (a) When supply of inserts has been depleted, training chaff will be hand-loaded in left and right hoppers. The maximum chaff load required for left dispenser system is one (1) carton of RR-20 chaff. Six (6) cartons per aircraft of RR-39 training chaff will be hand loaded in right dispenser, taped together and threaded through strippers.

4. EQUIPMENT CALIBRATION:

- a. All AN/APS-54 equipment will be operational. /C/
- b. All chaff dispensers will be operational and checked for SUD in accordance with SAC letter, DM6D, dated 24 August 56, and 2AF letter, dated January 1957. /C/
- c. Jammer Settings: Bomber aircraft will operate "S" or "L" band transmitters pre-set to sweep 2700 MC to 3100 MC at 100 MC/Sec and 1215 MC to 1365 MC at 60 MC/Sec, respectively. /C/

5. CONTROL:

- a. IFF will be on standby for all aircraft prior to the "Start ECM" line and remain on standby until reaching the ECM off point, at which time IFF will squawk as briefed. /C/

6. ACCOMPLISHMENTS:

- a. All aircraft will accomplish all possible 50-8 ECM requirements during the mission. /U/

Annex "E" to
6AD OOrder 22-58
1 Oct 58

3

~~SECRET~~

89

~~SECRET~~

- b. All aircraft will take credit for one sweep jamming run and one SUD. BIR runs will be accomplished if fighter aircraft are available. /U/
- c. AN/APS-54 Defensive ECM Log, 2AF Form 8, will be submitted to the debriefing team. /U/

~~SECRET~~

~~SECRET~~

HEADQUARTERS 6TH AIR DIVISION
MACDILL AIR FORCE BASE, FLORIDA
1 October 1958

APPENDIX 1

TO

ANNEX "E"

OPERATIONS ORDER

SERIAL NO. 22-58

FCM RECAP SHEETS FORM 991S

App 1 to
Annex "E"
6AD Order 22-58
1 Oct 58

~~SECRET~~

SECRET (When Filled In)

ECH RECAPITULATION SHEET		60th Bomb Wing (M)		A/C NO. 64		HOME STATION MacDill AFB, Florida		PAGE NO. OF PAGES 2 4							
LINE NUMBER	SERIES NUMBER	ALPHA AND/OR ALFA	SECTION I			SECTION II			SECTION III			SECTION IV			
			TIME ALTY			TIME ALTY			TIME ALTY			TIME ALTY			
			A	B	C	A	B	C	A	B	C	A	B	C	
6AD Order 22-58		D02		SWEEP WIDTH 2700 1215		SWEEP RATE 100 MC/S 60 MC/S		SWEEP RATE		SWEEP RATE		SWEEP RATE		SWEEP RATE	
1															
2															
3															
4															
5															
6															
7															
8															
9															
10															
11															
12															
13															
14															
15															
16															
17															
18															
19															
20															
21															
22															
23															
24															
25															
26															
27															
28															
29															
30															

3 SECRET

1 Oct 58

94

SECRET

SECRET

A

B

C

D

E

F

HEADQUARTERS 6TH AIR DIVISION
MACDILL AIR FORCE BASE, FLORIDA
1 October 1958

ANNEX "F"

TO

OPERATIONS ORDER

SERIAL NO. 22-58

ADMINISTRATIVE & LOGISTICS INSTRUCTIONS

Annex "F" to
6AD OOrder 22-58
1 Oct 58

HEADQUARTERS 6TH AIR DIVISION
MACDILL AIR FORCE BASE, FLORIDA
1 October 1958

ANNEX "F"

TO

OPERATIONS ORDER

SERIAL NO. 22-58

ADMINISTRATIVE & LOGISTICS INSTRUCTIONS

1. GENERAL: These instructions are in addition to, or modify, the instructions contained in SAC Manual 400-1, SAC Regulation 400-3, and 6AD Mobility Plan. Materiel and personnel load plans will be utilized. All logistics activities will be exercised in this operation.
2. SUPPLY:
 - a. Supply support of deployed SAC forms will be in accordance with applicable portions of SAC Manual 400-1 and applicable Ops Orders.
 - b. Supply support will be given in accordance with Volume XVI, AFM 67-1, as supplemented.
 - (1) SAC forces away from their home bases and within the continental limits of the United States will be given supply support from deployed or other locally available assets. Requirements (including deployed flyaway kit replenishment) not available locally will be obtained by the forward base in accordance with procedures used to obtain similar requirements of units permanently assigned to the forward base.
 - (2) SAC aircraft will be given normal supply support at their home bases.

- (3) Forward bases will requisition requirements as outlined in Volume XVI, AFM 66-1, except that requisition will:
- (a) Be sent to the appropriate home bases only. This will normally be the base from which the FAK was deployed; however, on peculiar items and power packs it should be the home station of the aircraft concerned or, if the transportation available from another base is significantly better, it should be this other base.
 - (b) Be transmitted by message (not transceiver) with the flag words "Project Home Brew" (not Project Star). An operational immediate (00) precedence will be assigned to all AOCF requisition messages.
- (4) On forward base requisitions home base supply officers will:
- (a) Except as indicated in paragraph 2b(4)(d) below, ship available items to the forward base by the fastest available means.
 - (b) Order items not available at the home base the same as home base requirements; however, AOCF requirements not available will be extracted to the headquarters of the SAC numbered air force to which the home station is assigned. The numbered air force headquarters will locate the required items and have them shipped to the forward base as fast as possible.
 - (c) Advise the forward base of complete shipping information on AOCF requests and of any delays in filling all requisitions. Status information will be sent

via message with a precedence similar to that assigned the requisition message.

- (5) Repairables at forward bases will be handled as prescribed by Volume XVI, AFM 67-1, except that items beyond local repair capability, but which can be repaired at the home base, will be immediately evacuated to the home base for repair.

c. Use of Flyaway Kit Assets.

- (1) FAK assets will not be used at their home bases except as authorized in SACM 50-5 (USCMs).
- (2) FAK assets deployed away from their home stations and outside of the Continental Limits of the United States may be used as required.

d. Supply Problems. These will be reported in accordance with SACR 67-3, as amended, and/or paragraphs 22 (M-17 Aircraft Delay Report) and 27 (M-23 Base Capability Report), SACM 55-8M, Feb 58, as appropriate.

e. An individual of the deploying unit will be designated to accept responsibility at enroute and TDY bases for housekeeping items and other property required by the unit.

f. Subsistence.

- (1) Flight lunches will consist of food packets - individual, combat, inflight, or precooked frozen meals, as applicable. The home or TDY base will provide flight lunches in sufficient quantities to provision personnel moving in military aircraft to final destination.

- (2) When commercial airlift is provided and subsistence is fur-

such subsistence is in sufficient quantities and nutritionally adequate for troop movement.

- g. Each person will deploy with individual equipment as directed in SAC manuals of the 400-1 series and one basic load of ammunition as prescribed in SACR 136-9.

3. ARMAMENT-ELECTRONICS.

- a. FAK items deployed for Armament-Electronics maintenance will be serviceable and compatible with aircraft involved in the movement.
- b. Test equipment will be serviceable and currently calibrated in accordance with applicable technical orders and regulations.

4. MAINTENANCE.

- a. Maintenance support required enroute will be provided from the resources of the organization as prescribed in SAC manuals of the 400-1 series.
- b. Maintenance support required beyond the combined capability of the SAC and local forces at any point will be reported to the appropriate numbered air force.
- c. The SAC maintenance activity at forward bases will be organized and operated as prescribed in:
 - (1) SACM 66-12, as amended.
 - (2) The unit mobility plan prepared in accordance with SAC manuals of the 400-1 series.
- d. Aircraft maintenance status and flow boards will be used as prescribed in SACH 66-13.
- e. Security Check:
 - (1) SAC aircraft commanders or designated representatives, will

perform a security check at all enroute and/or operating

stations to insure that:

(a) Fuel, oil, water, alcohol, demineralized water, and ADI fluid for servicing aircraft are not contaminated.

(b) Fuel and oil are of the grade specified by applicable TOs.

(2) A clean glass, paper, or metal container will be used to obtain a sample from each servicing unit. The sample will be given a thorough visual inspection for contamination before servicing each aircraft.

f. **Prepositioned Equipment.** Maintenance of this equipment has a critical effect on the successful execution of the mission. Availability of serviceable equipment will affect not only the capability of the organization presently using a forward base, but also the capability of organizations scheduled to use those bases in the future. To assure the availability of serviceable equipment, the following policies are established:

(1) **Ground Support Equipment.** Maintenance personnel will perform all organizational and field maintenance to insure that this equipment is serviceable before departure from forward bases. Ground support equipment includes such items as maintenance platforms, towbars, jacks, etc.

(2) If the task force commander considers the above procedure impracticable due to base facilities, aircraft parking, etc. he may devise a more suitable method of control while the organization is using the forward base.

(3) Only personnel qualified to operate ground powered equipment in accordance with SACR 66-17 and SACM 66-6 will be used as operators.

- (4) Under no circumstances will organizational and field maintenance be allowed to accumulate.
- (5) The provisions of TO 00-20C-1, Mar 55, and AFR 66-1, 27 Feb 56, will be strictly enforced.
- (6) If necessary parts become available before departure from the forward base, these end items of equipment will be returned to an in-commission serviceable status.
- (7) If the necessary parts are not available before departure from the forward base, copies of all DD Forms 1150, Request for Issue or Turn In, or SAC Form 466, Issue/Turn-In Request Card, will be furnished to the appropriate responsible personnel at the forward base. These issue requests will be properly marked to indicate the end item which is out of commission for the parts listed. These requests may then be used by forward base to continue action to acquire the necessary parts.

5. TRANSPORTATION.

a. Cargo.

- (1) Cargo will be prepared for shipment in accordance with SACM 400-1 and 6AD Mobility Plan SOP No. 2.
- (2) Units returning from overseas to the Zone of Interior will type the following statement on all cargo manifests: "Military equipment being returned to the United States for future use by the United States Armed Services".

b. Support Airlift.

- (1) Support airlift for personnel and cargo not scheduled in unit aircraft will be specified in the operations order.

Organization commanders will insure that unit personnel and their personal baggage transported in support of aircraft are not separated enroute.

- (2) For security purposes, three unit personnel will accompany each support aircraft carrying cargo.

c. Personnel and Baggage.

- (1) The maximum number of personnel to be transported in unit aircraft is specified in SACR 60-10.
- (2) The number of personnel to be transported in support aircraft will be specified by the supporting agency.
- (3) Baggage. Maintenance personnel and their baggage may weigh as much as 340 pounds per man (average), including baggage. Baggage weight will average 135 pounds and will include personal effects, tool kits, and other professional equipment. Transportation officers will insure that individuals do not possess excess personal baggage. Additional baggage will not be shipped by surface means.

d. Air Movement Reports. Air movement reports required in EWO and peacetime deployment of units will be submitted in accordance with paragraphs 14, 17, 21, and 22, SACM 55-8M, Feb 58.

e. Dependents and Household Goods. Travel of dependents and shipment of household goods are not authorized.

6. MEDICAL.

- a. Medical personnel and equipment will not accompany units.
- b. Personnel involved in the movement will be immunized in accordance with AFRs 160-101, as amended; AFR 160-102; and SACR 160-1.
- c. Hospitalization and evacuation will be in accordance with

procedures prevailing at enroute bases and at the destination. In an emergency and if determined necessary by the wing surgeon, evacuation using available aircraft may be effected if a qualified attendant is furnished to accompany the patient.

7. PERSONNEL.

- a. Deploying Personnel. Unit personnel to be deployed will be those assigned to the staging team as prescribed in SAC manuals of the 400-1 series, unless otherwise directed by the operations order. The limitation on total number of personnel imposed by the operations order will not exceed 227 persons without prior approval of higher headquarters.
- b. Personnel on leave who must accompany the unit on peacetime deployment may be recalled at the discretion of the organization commander concerned.
- c. Personnel in the following categories will not normally accompany the unit upon deployment.
 - (1) Officers who have submitted resignation under AFR 36-12, as amended.
 - (2) Officers who have been recommended for elimination under AFRs 35-66, 36-2, 35-62, 36-70, as amended, or for demotion under AFR 36-35.
 - (3) Officers who have been nominated as principals or alternates for assignment to a service school, including USAFIT, and pilot training. An exception to this ruling is made if it can be determined that personnel will be available for such assignment on the established reporting date.
 - (4) Personnel undergoing investigation or awaiting trial by court-martial.

- (5) Personnel tentatively qualified for aviation cadet training. Airmen who have successfully passed their physical examinations for flying and meet the minimum qualifications outlined in paragraphs 4a through f, AFR 51-3, 25 Aug 55, are considered tentatively qualified.
- (6) Airmen who have made application for OCS and meet the provision of AFR 53-3, as amended.
- (7) Personnel granted deferment under AFM 35-11, as amended.
- (8) Personnel attending formal or technical training courses. Key personnel may be recalled from schools only upon approval of SAC Headquarters. Commanders who consider such withdrawal necessary to meet operational commitments will forward complete justification to SAC Headquarters in each case.

- d. Personnel on whom action has been initiated under AFR 35-62 as security risks will be reassigned from deploying units.
- e. Personnel will conform to uniform regulations of the theatre to which deployed. Commander may authorize the wearing of the suit, working, when necessary for the performance of tasks enroute for which a class "A" uniform is not suitable.
- f. Customs Briefing. Personnel will be briefed concerning the following:
 - (1) Customs and courtesies of the country to which deployed.
 - (2) Prohibitions and penalties in connection with illegal commercial and black-market activities.
- g. Passports and visas will be procured and processed when required in accordance with the USAF Foreign Clearance Guide,

AFR 34-61, and SACM 55-12, as amended.

- h. Personal affairs and casualty reporting will be in accordance with AFR 30-11, as amended, AFR 34-43, and SACR 34-6.
- i. Personnel Records. For this directive, personnel records mean those records for which the Director of Personnel is responsible, (AF Form 11, Officer Military Record; AF Form 7, Airman Military Record; AF Form 617, Military Leave Record; organization morning reports, etc.).
 - (1) Peacetime Rotation. Personnel records will not accompany the unit.
 - (2) In cases of individual TDY, paragraph 1c(2), chapter 6, AFM 35-9, 1 Sep 56, and paragraph 16c(3), chapter 3, AFM 35-12, 1 Apr 57, will apply.

8. ADMINISTRATIVE SERVICES.

- a. Temporary duty orders will be issued in accordance with AFM 30-3, as amended, and AFM 30-3/SACSUP-1. CIPAP will be authorized. Orders will not be designated as group travel orders. Unless otherwise stated in the operations order, the orders will be unclassified regardless of the classification of the operations order.
- b. Justification for Orders. The following statement will be used verbatim in TDY orders to show the purpose of deployment: "Purpose - SAC Air Operations".
- c. Per diem is payable in the same manner as for ordinary TDY.
- d. Mail will be held at unit mail rooms until personnel return from TDY.
- e. Only those records that are essential to the operation of the unit will be taken on temporary duty. Rear echelon personnel

or, in their absence, the base records officer will assume custody and disposition responsibility for records which do not accompany the unit.

9. COMPTROLLER.

- a. Pay Records. Military pay records will not accompany organization.
- b. Financial Services Briefing. All personnel will be given a thorough briefing as follows:
 - (1) Method of payment of pay and allowances overseas under SACR 173-4, as amended.
 - (a) Method of payment of pay and allowances overseas under SAC finance mobility procedures.
 - (b) Use of pay identification card, if separated from unit.
 - (c) Type of currency used in the overseas area (indigenous, US dollars, and/or military payment certificates), approximate rate of exchange, method of procurement, and import restrictions, if any.
 - (2) After arrival at TDY destination. Pertinent currency data, including restrictions on use and export of foreign currency and use of military payment certificates, if applicable.
- c. Submission of Reports. All comptroller reports, except expense summary reports, will be submitted in accordance with SACMs 171-1, 171-2, 171-4, and 171-6.
- d. Expense Summary Reports. Expense summary reports for units concerned will be prepared and submitted in accordance with AFM 171-1, as amended, and AFM 171-8, as supplemented.

- e. Funding. SAC air operations orders will be funded in accordance with paragraph 21906, AFM 17-21/SACSUP-2, 13 Sept 57, as amended.
- f. Government Quarters and Messing Facilities. Government quarters and messing facilities will be used to the maximum extent practicable. Where such use is impracticable, paragraph 2b, chapter 6, AFM 30-3, SACSUP-1, 12 Mar 58, and paragraph 4451, JTR, will be complied with, and the following statement will be included in the TDY orders: "The requirement for the utilization of government quarters and messing facilities is impracticable and will adversely affect the assigned mission".

10. JUDGE ADVOCATE.

- a. Air Force personnel of SAC units, who are assigned or attached for temporary duty to any oversea SAC organization or component thereof, are under the jurisdiction, for court-martial and Article 15, UCMJ, of the commander of the oversea unit to which they are assigned or attached. This includes the processing of various administrative proceedings, including but not limited to, actions under AFRs 39-16, as amended; 39-17, as amended; 35-62; 35-66; 36-2; and 36-12, as amended.
- b. Personnel of returning units may, at the discretion of the commander exercising general court-martial jurisdiction temporarily over the unit, be retained if:
 - (1) Under investigation.
 - (2) Pending trial by, or review of, court-martial.
 - (3) Required as a material witness in court-martial or administrative proceedings.

11. SECURITY.

- a. Unit security officers appointed in accordance with SACR 205-1

will monitor unit protection procedures during the movement to and from forward areas.

b. Combat force protection operations at forward bases will be in accordance with SACR 205-5.

(1) The air police (combat defense) elements of units deploying to SAC bases will be integrated into the host base's air police complement to provide protection for the Category I resources of the deployed force.

(2) The senior SAC commander of the deployed unit, or his appointed representative, will exercise approval authority for access of all personnel to the Category I resources of the deployed unit and to the restricted areas in which those resources are contained.

c. Protection operations at enroute bases will be conducted as follows:

(1) The protection of SAC Category I resources staging through non-SAC bases normally will be provided by the air police (combat defense) element of the staging team designated for that station.

(2) The protection of SAC Category I resources staging through SAC bases will be the responsibility of the host SAC base. Additional air police (combat defense) personnel will not normally be provided by the staging organization.

27

28

C

C

C

1 1

~~SECRET~~

CLASS: ~~SECRET~~
AUTH: COMDR, 6AD
DATE: 15 OCT 58
NAME: *Christy*

HEADQUARTERS
6TH AIR DIVISION
United States Air Force
MacDill Air Force Base, Florida

DO

15 October 1958

SUBJECT: (Unclassified) Amendment No. One to Headquarters 6th Air
Division Operations Order 22-58 "GRAND SLAM"

TO: See Distribution - Basic Order

1. Attached is Amendment No. One to Headquarters 6th Air Division
Operations Order Serial No. 22-58, "GRAND SLAM", and is effective upon
receipt. (Unclassified)

2. Pages included in this Amendment will be inserted in the Basic
Operations Order as specified on the attached SAC Form 20. Removed
pages will be destroyed in accordance with Air Force Regulation 205-1,
as amended. (Unclassified)

3. This Amendment: (Unclassified)

- a. Outlines ground rules for the weapons portion of this
exercise.
- b. Changes coordinates of the camera target.
- c. Changes the third 305th AREFS tanker departure time.
- d. Amends the ECM instructions.
- e. Outlines ground rules for RDS aircraft participation,
and 305th AREFS TAT.

4. This document is classified Secret because it contains
amended instructions for Operations "GRAND SLAM". (Unclassified)

5. When Inclosure #1 is withdrawn, this correspondence may be
downgraded to Unclassified in accordance with Air Force Regulation
205-1, as amended. (Unclassified)

FOR THE COMMANDER:

FOIA (b)(6)

1 Incl
Amend #1 to 6AD
OOrder 22-58
(1 cy - 5)

Colonel, USAF -
Director of Operations

SECRET

R-4650-4

~~SECRET~~

- (a) Weather minimums will be as prescribed by AFR 60-16. Missed air refueling alternates must have minimums as required by AFR 60-16. When weather precludes launching of any portion or wave of the scheduled mission, that portion or wave will be rescheduled in conjunction with subsequent phases. /U/
- (b) Commanders will provide for crew rest as required by SAC Reg 62-19 on this USCM. /U/
- (h) Execution Instructions: /U/
 - (a) The SAC Command Post will execute in accordance with provisions of 2AF OPLAN 300-59, Basic Order, paragraph 3x(3)(c), subparagraphs 1 through 6. /U/
 - (b) Index number series for this exercise is 150. /S/
 - (c) The normal peacetime "Alert Force" will be expanded to Option 5 Quick Strike strength. Only the expanded Quick Strike Force will launch. /S/
 - (d) The SAC or 2AF Command Post will disseminate the "GO CODE" in standard "NOAH'S ARK" message. /S/
 - (e) The "GO CODE", when decoded in the vocabulary of current KAC-72, are the words "FORCE" and "SCRAM". /S/
 - (f) Aircraft launched under Positive Control which have not /// received the "GO CODE" prior to 39-31N/59-20W, will abort the bomber stream, using standard abort procedures in accordance with SAC Reg 55-3 and return to MacDill AFB. (See para 7g, Annex "D"). /U/

Amend 1 to
6AD OOrder 22-58
15 Oct 58

~~SECRET~~

(g) Alert aircraft will be considered as available aircraft during the preparation phase of the USCM. These aircraft will perform a "BRAVO" type alert, or as directed /// by execution order. Alert aircraft will be considered as generated aircraft in accordance with SACM 55-7.

Amend 1 to
6AD OOrder 22-58
15 Oct 58

5a

~~SECRET~~

3

~~SECRET~~

However, for launch, these aircraft will be treated as not available. /U/

(h) Reflex Aircraft:

1. Airborne Reflex deploying aircraft at A Hour, during this exercise, will not be considered as available aircraft. However, should the converse exists, aircraft are available and will be generated and launched in accordance with this Order.
 2. Airborne re-deploying Reflex aircraft at A Hour /// will be considered as available aircraft upon arrival at home station and will be generated and launched in accordance with this Order. Conversely, should these aircraft be launched after A Hour, they will not be considered available and need not be generated.
- (5) Units will conduct specialized briefings in accordance with SACM 50-12. Further, units will be responsible to provide assistance to 6th Air Division Staff in the preparation of General Briefing Aids. /U/
- (6) General Briefing will be conducted prior to 30 October 1958 (time to be announced later) in the Base Theatre. /U/
- (7) Units will develop flight crew flimsies in support of this Order. /U/
- (8) SACM 50-8, 51-6, 55-18, SACM 50-5, 55-7, 55-8, 55-12, 55-14, 100-1, and applicable Tactical Doctrines provide guidance in the USCM. /U/

Amend 1 to
6AD OOrder 22-58
15 Oct 58

~~SECRET~~

(2) SAC CBI 2101, 4a (2)(b)2, will be complied with in selecting HF frequencies and stations to monitor in accordance with monitoring procedure ALPHA. /U/

TIBBETS
Colonel, USAF
Commander

ANNEXES:

Annex "A" - Intelligence
Annex "B" - ~~B-47~~ Operations
Annex "C" - KC-97 Operations
Annex "D" - Communications
Annex "E" - Electronics Countermeasures
Annex "F" - Administrative and Logistics Instructions

DISTRIBUTION:

CinC, SAC - 4 cys
Comdr, 2AF - 5 cys
DODT - 1 cy
DOC - 1 cy
DM2A - 1 cy
DMLi - 1 cy
IG - 1 cy
Comdr, 8AF - 3 cys
Comdr, Pease T.F. 1 cy
Comdr, 38AD - 2 cys
Comdr, 303 AREFS - 1 cy
Comdr, 6AD - 5 cys
Comdr, 305 BW - 25 cys

Amend 1 to
6AD OOrder 22-58
15 Oct 58

8
~~SECRET~~

~~SECRET~~

- (2) Information from aerial photography and other sources regarding success of the bombardment mission as required by B-51 Immediate Photo Intelligence Reports. /U/
- (3) Means of Obtaining Information:
 - (a) Crew observation. /U/
 - (b) Interrogation of combat crews. All participating crews will report to their respective Wing Briefing Rooms immediately following landing for interrogation. M-12 and M-20 report formats will be used as interrogation guides. /U/
- (4) Means of Reporting EEL.
 - (a) The above EEL will be transmitted as expeditiously as possible in the M-12, M-20, and B-51 reports in accordance with SACM 55-8. /U/

3. INTELLIGENCE ACTIVITIES:

a. Target and Navigational Materials:

(1) USCM Targets:

- (a) Center of highway bridge over Calcoosahatchee River ///
at Fort Myers, Florida (26-39-24N/81-52-16W). /S/

(2) Added SACR 50-8 NBS Targets:

- (a) Tampa Bomb Plot. /S/

(3) Maps and Charts:

- (a) As required for accomplishment of special USCM mission folders for issue to navigators. /U/
- (b) Combat mission folders (EWO) will be simulated. /U/ ///

Amend #1 to
Annex "A"
6AD OOrder 22-58
15 Oct 58

~~SECRET~~

- d. The "GO CODE", when decoded in the vocabulary of current KAC-72, is the words "FORCE" and "SCRAM". /S/
 - e. Aircraft launched under Positive Control which have not received the "GO CODE" prior to 39-31N/59-20W, will abort the bomber stream, using standard abort procedures in accordance with SACR 55-3 and return to MacDill AFB (see para 7g, Annex "D"). /U/
 - f. Subsequent to the completion of strike refueling operations, the SAC Command Post will release tankers to the Numbered Air Forces for re-deployment to home/rotational station. /U/
 - g. Each Bomb Wing will launch a minimum of thirty (30) bombers or available bomber aircraft minus five (5), whichever is less (SACM 50-5, Section I, paragraph 26c). /R/
3. REFLEX SCHEDULES:
- a. CINC SAC, with reference to SACM 50-5, paragraph 19a, has authorized parent Numbered Air Forces to revise Reflex schedules as required for compatibility with this exercise. Second Air Force Bomb Wings participating in this USCM and Reflex Action (2AF OOrder 96-58) will, upon receipt of the advance condition of readiness message, cancel the Reflex schedule and generate and launch aircraft only on the USCM until the completion of the USCM. Upon completion of the USCM, Second Air Force will evaluate the forward area Reflex Action posture and, after allowing sufficient time to prepare aircraft, schedule deployment of replacement aircraft as required. /R/

~~SECRET~~

4. Aircraft configuration will be as required to accomplish this mission. The aircraft will be prepared in accordance with 6th Air Division Operations Order 44-59, using SACM 50-5 as a guide to accomplish EWO requirements that are in conflict with the requirements of this mission. Air weapons will not be flown. /U/

Amend #1 to
Annex "B"
6AD OOrder 22-58
15 Oct 58

2a

~~SECRET~~

8

~~SECRET~~

5. ATC CLEARANCE:

- a. Approved ATC Altitudes will be observed. /U/
- b. Aircraft Commanders will submit completed Form 175's (Section C will indicate "GRAND SIAM" _____ ROUTE as briefed), Form F's and flight orders to Unit Command Posts immediately after pre-take off briefing.
- c. IFR clearances will not be cancelled for VFR letdown except in case of emergency. /S/

6. TIMING:

- a. See Appendix 1, this Annex. /S/

7. ASSEMBLY:

- a. In accordance with SAC Tactical Doctrine. /S/

8. AIR REFUELING:

- a. The 2d and 308th AREFS will be scheduled to support the 306th and 305th Bomb Wings respectively in the BABY BED (Primary) and ALL OUT (Secondary) refueling areas. /S/
- b. Communications/Rendezvous procedures will be as contained in SACM 100-1. Communications settings will be ANN and CORA of designated column. /S/

PRIMARY						
CODE	KEY	A/R	FUEL	C/R	MISSED	KC-97
NAME	RNDZ	TRACK	TRANSFER	PLAN	A/R ALT	UNIT
BABY BED	38-40N 65-58W	079	30M	ALT/EUR	PEASE AFB	2 and 308
YO YO						
BABY BED	38-40N 65-58W	079	35M	ALT/EUR	PEASE AFB	2 and 308
ALTERNATE						
ALL OUT	35-40N 63-20W	038	28M	ALT/EUR	KINDLEY	2 and 308 ///
YO YO						
ALL OUT	35-40N 63-20W	038	28M	ALT/EUR	KINDLEY	2 and 308 ///

Amend #1 to Annex "B"
6AD Order 22-58
15 Oct 58

~~SECRET~~ 3

~~SECRET~~

9. PLANNING FACTORS:

- a. Winds and temperatures in accordance with 2AFM 55-1. /U/
- b. Aircraft loading: Data is from applicable T.O. and SACTP 55-2. Fuel load will be maximum allowable for critical field length equal to available runway; however, in no event will the static gross weight of the aircraft exceed 200,000#. All take offs have been computed utilizing water/alcohol augmentations. X/
- c. Cruise Control: Consumption rates have been extracted from applicable T.O. /U/
- d. Fuel reserves have been computed to arrive over destination with at least 12,000#. /U/
- e. Refueling: SACM 55-5, 55-10 and 100-1 apply. Aircraft will refuel on a one to one basis. Scheduled off loads in primary area is 30,000# for Leap Frog, for Yo-Yo is 35,000#. Alternate Air Refueling area is 28,000# for both "Leap Frog" and "Yo-Yo". ///
X/
- f. Weather Minimums: In accordance with AFR 60-16 and SACR 55-12. /U/
- g. Flying Safety has been given maximum consideration during mission planning. /U/

10. CELL TACTICS:

- a. Route cell (ie, stacked up 500 feet with one (1) mile interval) will be employed at all times when approaching a turning point with turns greater than 30°, and at all times prior to entering a maneuver area. /U/

Amend #1 to
Annex "B"
6AD OOrder 22-58
15 Oct 58

~~SECRET~~

~~SECRET~~

b. All other cell tactics will be in accordance with SAC Tactical Doctrine or as directed by Cell Leader. /U/

Amend #1 to
Amex "B"
6AD Order 22-58
15 Oct 58

la

~~SECRET~~

// 1 1

~~SECRET~~

- c. Cell leaders check list will be distributed at pre-take off briefing and the Cell leader will brief his flight on tactics prior to departure of aircraft. /U/

11. NAVIGATION

- a. Celestial navigation will be accomplished on the return leg, as scheduled in the flight plan, in accordance with SAOR 51-11. No celestial navigation on outbound leg, as there is no terminal point in accordance with SAOR 50-4 and 51-11. /U/

12. BOMBING:

- a. Bombing Altitude: As indicated in Recap Sheet, this Annex. /S/
- b. All bomb runs will be in accordance with current Tactical Doctrine. /S/
- c. Since air weapons will not be carried, each Bomb Wing will overfly Tampa RBS Base. RBS runs will be made only as required for additional 50-8 credit and when fuel is available. RBS runs will not count for or against the USCM. /S/
- d. One (1) camera attack on center of bridge over Caloosahatchee River, north of Fort Myers, Florida, (26-39-2LN/81-52-16W) /// will be made. The effective point will be the center of the bridge and supporting scope photography will be required. IBDA will be accomplished.
- e. Target photography will be scored by the Wing Photo Interpreter for the purpose of B-51 reporting.
- f. O-15 or O-25 scope photography of the target will be considered effective for this mission.

Amend #1 to
Annex "B"
64D OOrder 22-53
15 Oct 58

~~SECRET~~

~~SECRET~~

g. Aircraft will be considered ineffective if neither of the above types of photography are accomplished.

13. COMMUNICATIONS:

a. As contained in Annex "D", this Order. /U/

14. ECM:

a. As contained in Annex "E", this Order. /U/

15. REQUIREMENTS:

- a. One (1) navigation leg. (Grid celestial).
- b. One (1) camera attack and IBDA.
- c. One (1) rendezvous (cell Leader).
- d. One (1) ECM.
- e. One (1) cell tactics and formation as flown.
- f. Water/alcohol take off.
- g. Air refueling.
- h. Chaff dispensing.
- i. Cruise control.
- j. Communications (as briefed).

16. WEATHER SCOUT:

a. Eighth Air Force will designate weather scouts from their resources for all air refueling areas, this exercise. /U/

17. EMERGENCY BASES:

<u>AIR BASE</u>	<u>ELEVATION</u>	<u>RUNWAY LGTH</u>	<u>AIR BASE</u>	<u>ELEVATION</u>	<u>RUNWAY LGTH</u>
KINDLEY	11 ft	9700 ft	HUNTER	42 ft	11400 ft
PEASE	101 ft	11300 ft	WESTOVER	245 ft	11600 ft
MCCOY	96 ft	11000 ft	HOMESTEAD	7 ft	10200 ft

Amend #1 to
Annex "B"
6AD OOrder 22-58
15 Oct 58

~~SECRET~~

PRIMARY

APN 69 1-1-2
PRIM 375.4
BACK UP 311.0

ALTERNATE

APN 69 1-1-2
PRIM 375.4
BACK UP 311.0

23. 306 BOMB WING:

a. COMM/RNDZ PROCEDURES

NEAC ALT/EUR ANN

PRIMARY

38-40N/65-58W
APN 76 T-7 R-4
APN 69 1-1-1
PRIM 337.6
BACK UP 311.0

ALTERNATE

35-40N/63-20W
APN 76 T-7 R-4
APN 69 1-1-1
PRIM 337.6
BACK UP 311.0

24. AIR WEAPONS:

///

- a. GENERAL: Air weapons will not be flown, loaded aboard B-47 aircraft or removed from storage for execution of this operations order. /S/
- b. Though weapons will not be actually used, it is desirable to exercise Aviation Depot Squadron personnel to the maximum. In addition, in order not to compromise timing of the 6AD EWO plans for preparation of aircraft, weapons loadings will be simulated as follows: /U/
- (1) Aircraft will be moved to the desired loading site and will remain there during the period allocated for loading under the 6AD OO 44-59 plan. /U/
- (2) Bomb-bays will be properly configured and all applicable checks will be accomplished to include: /U/

~~SECRET~~

- (a) Release system functional checks. /U/
 - (b) Flight circuit tests. /U/
 - (c) Loading preparation check. /U/
 - (3) All required loading equipment will be available at the loading site. /U/
 - (4) The loading crew will remain at the aircraft during the programmed weapon loading period. No maintenance or other aircraft preparation may be accomplished during this time that cannot normally be done during weapon loading. /U/
25. Ammunition will be loaded in accordance with SAC Manual 50-5. ///
26. RDS AIRCRAFT:
- a. Will fly. Take off will be made complying with all peacetime restrictions. (ie, gross weight, usable runway.) ///
 - b. Ammunition not torqued in. ///
 - c. ATO: Unloaded. Upon completion of unloading, credit will be given for loading ATO on Sorties 11, 12, and 13. ///
 - d. Chaff - One (1) bundle of training chaff loaded on top of each insert and threaded in stripper. ///
 - e. ECM - Tuned in accordance with Form 99, this Order. ///

SECRET

RECAPITULATION SHEET
BOMBARDMENT - RECONNAISSANCE - PART III

MISSTION NUMBER	PRIORITY	ELECTRONIC COUNTERMEASURES				MILES TO TARGET	FLIGHT TIME	TAI	BOMB	OFFSET AP COORDINATES	AZIS	TAS	PRESSURE ALTITUDE	TARGET TO POINT STRIKE BASE				MISSION RESULT	
		START	STOP	START	STOP									BASE	DISTANCE	TIME	TYPE	TOTAL	PERCENT
1		3032	3300	3032	3300	1:37													
2		7400	8000	7400	8000	1:50													
3						1:47													
4						1:36													
5						1:40													
6						1:41													
7						1:41													
8						1:41													
9						1:41													
10						1:41													
11						1:41													
12						1:41													
13						1:41													
14						1:41													
15						1:41													
16						1:41													
17						1:41													
18						1:41													
19						1:41													
20						1:41													
21						1:41													
22						1:41													
23						1:41													
24						1:41													
25						1:41													
26						1:41													
27						1:41													
28						1:41													
29						1:41													
30						1:41													
31						1:41													
32						1:41													
33						1:41													
34						1:41													
35						1:41													
36						1:41													
37						1:41													
38						1:41													
39						1:41													
40						1:41													
41						1:41													
42						1:41													
43						1:41													
44						1:41													
45						1:41													
46						1:41													
47						1:41													
48						1:41													
49						1:41													
50						1:41													

Amend 1
App 1 to Annex 1
CAD Order 22-58, 15 Oct 58

SECRET

SECRET

SECRET

SECRET

RECAPITULATION SHEET
BOMBARDMENT - RECONNAISSANCE - PART III

2ND 366 FIVE 3-17E 22-58 NOV 58 12 18

NO	MUNITION	ELECTRONIC COUNTERMEASURES					BOMB RUN										TARGET TO DESTROY BASE				MISSION RESULT						
		MODE	START	STOP	START	STOP	NO	TYPE	TIME	ALT	OFFSET	COORDINATES	AVIS	TAS	PRESSURE ALTITUDE	BASE	DISTANCE	RESERVE	TOTAL	PERCENT							
1																											
8	BOMB 1	N/A	3030	3300	3032	3300	660																				
9	BOMB 2		7400	8000	7400	8000	727	8:30	7																		
10	BOMB 3						768	8:13	2																		
11	BOMB 4						838	8:55	1																		
12	BOMB 1						660																				
13	BOMB 2						727	8:34	2																		
14	BOMB 3						768	8:13	2																		
15	BOMB 4						838	8:55	1																		
16	BOMB 1						660																				
17	BOMB 2						727	8:34	2																		
18	BOMB 3						768	8:13	2																		
19	BOMB 4						838	8:55	1																		
20	BOMB 1						660																				

Amend I
App I to Annex "B"
GAD Order 22-58, 15 Oct 58

SECRET

SECRET

23

SECRET

SECRET

Amend 1
App 1 to Annex of
GAD Order 22-58, 15 Oct 58

RECAPITULATION SHEET BOMBARDMENT - RECONNAISSANCE - PART I										TAKEOFF	TIME	UNIT/TACTICAL CALL SIGN	TYPE AND MODEL AIRCRAFT	OPERATIONS CENTER AND EFFECTIVE DATE	PAGE NO.	NO. OF PAGES		
										2AF	1000W	FLY	B-47E	22-58	Nov 58	13	18	
MISSION NO.	TARGET NAME AND COORDINATES	DPO REF NO.	DSE	BY	CELL CALL SIGN AND NUMBER	WEAPON	TAKEOFF DATA					SCHEDULED REFUELING						
							WEAPON CAPSULE	DEPART	GRND BRNCH TIME	FUEL ON BRNCH	TIME TO CLIMB	CLIMB RATE	AREA	HEIGHT	OFF LOAD	ON LOAD	CRUISE AT	WIND
A	B	C	D	E	F	G	H	I	J	K	L	M	N	O	P	Q	R	
21	72-10000	80000	N/A	N/A	SILVER 2	N/A	YALDIE	000,000	00,000	000	0500							
22	26-39-24N				SILVER 3						0601						7700	
23	01-52-16W				YELLOW 1						2519						7600	
24					YELLOW 2						2510						7600	
25					ORAL 1						2619						7600	
26					ORAL 2						2620						7600	
27					ORAL 3						2719						7600	
28					ORAL 4						2720						7600	
29					ORAL 5						2819						7600	
30					ORAL 6						2820						7600	
31					ORAL 7						2919						7600	
32					ORAL 8						2920						7600	
33					PINK 1						3019						7600	
34					PINK 2						3020						7600	
35					OLIVE 1						3119						7600	
36					OLIVE 2						3120						7600	
37					ORANGE 1						3219						7600	
38					ORANGE 2						3220						7600	
39					CARDINAL 1						6000						7600	
40					CARDINAL 2						6000						7600	

SECRET

214

SECRET (When Filled In)

Amend 1 to Annex 98
SAD FORM 22-58, 15 Oct 58

SECRET

RECAPITULATION SHEET BOMBARDMENT - RECONNAISSANCE - PART III										ARMY FORCE	UNIT	TYPE AND MODEL AIRCRAFT	OPERATION NUMBER	EFFECTIVE DATE	PAGE NO.	TOTAL NO. OF PAGES				
										RAF	30004	F4U	9-471	22-58	15	18				
LINE NO.	OFFICIAL TARGET NUMBER	CODE	ELECTRONIC COUNTERMEASURES					START TIME	STOP TIME	TYPE	MODE	SHEET NO.	COORDINATES	ALTITUDE	SPEED	TARGET TO POST STRIKE BASE		MISSION RESULTS		REMARKS
			START	STOP	START	STOP	START									STOP	DATE	TIME	TOTAL	
NO.	NO.	NO.	NO.	NO.	NO.	NO.	NO.	NO.	NO.	NO.	NO.	NO.	NO.	NO.	NO.	NO.	NO.	NO.	NO.	NO.
11	SILVER 2	MA 3032	3032	3032	3032	3032	7:17	8:42	1	D	1	9-2	200	400	35.5	9:1	9:1	3791	25496	22
12	SILVER 3	7000	8000	7400	4000	7:20	8:42	2										3842	24796	23
13	YELLOW 1					7:27	8:42	3										3791	25496	24
14	YELLOW 2					7:27	8:42	4										3791	25496	25
15	ORAL 1					7:27	8:42	5										3791	25496	26
16	ORAL 2					7:27	8:42	6										3791	25496	27
17	ORBIT 1					7:27	8:42	7										3791	25496	28
18	ORBIT 2					7:27	8:42	8										3791	25496	29
19	ORBIT 1					7:27	8:42	9										3791	25496	30
20	ORBIT 2					7:27	8:42	10										3791	25496	31
21	ORION 1					7:27	8:42	11										3791	25496	32
22	ORION 2					7:27	8:42	12										3791	25496	33
23	PIND 1					7:27	8:42	13										3791	25496	34
24	PIND 2					7:27	8:42	14										3791	25496	35
25	OLIVE 1					7:27	8:42	15										3791	25496	36
26	OLIVE 2					7:27	8:42	16										3791	25496	37
27	ORONS 1					7:27	8:42	17										3791	25496	38
28	ORONS 2					7:27	8:42	18										3791	25496	39
29	ORONAL 1					7:27	8:42	19										3791	25496	40
30	ORONAL 2					7:27	8:42	20										3791	25496	41

SECRET

AS

SECRET

SECRET

RECAPITULATION SHEET
BOMBARDMENT - RECONNAISSANCE - PART III

REF ID: A7 306 PLY 1-7 * 22-50 JOURNAL 58 18 18

NO.	MUNITION	TYPE	ELECTRONIC COUNTERMEASURES				NO. TO TARGET	LOSING TIME	SOME PLAN				TARGET NUMBER AND EFFECTIVE DATE				PAGE NO.	NO. OF SHEETS
			START YEAR	STOP YEAR	START YEAR	STOP YEAR			NO.	TYPE	COORDINATES	ALT.	TYPE	NO.	DATE	NO.		
1	FLAK	1.5	1942	1945	1942	1945	50											
2	FLAK	1.5	1942	1945	1942	1945	100											
3	FLAK	1.5	1942	1945	1942	1945	150											
4	FLAK	1.5	1942	1945	1942	1945	200											
5	FLAK	1.5	1942	1945	1942	1945	250											
6	FLAK	1.5	1942	1945	1942	1945	300											
7	FLAK	1.5	1942	1945	1942	1945	350											
8	FLAK	1.5	1942	1945	1942	1945	400											
9	FLAK	1.5	1942	1945	1942	1945	450											
10	FLAK	1.5	1942	1945	1942	1945	500											
11	FLAK	1.5	1942	1945	1942	1945	550											
12	FLAK	1.5	1942	1945	1942	1945	600											
13	FLAK	1.5	1942	1945	1942	1945	650											
14	FLAK	1.5	1942	1945	1942	1945	700											
15	FLAK	1.5	1942	1945	1942	1945	750											
16	FLAK	1.5	1942	1945	1942	1945	800											
17	FLAK	1.5	1942	1945	1942	1945	850											
18	FLAK	1.5	1942	1945	1942	1945	900											
19	FLAK	1.5	1942	1945	1942	1945	950											
20	FLAK	1.5	1942	1945	1942	1945	1000											

Amend 1
App 1 to Annex 25
CAD Order 22-58 15 Dec 58

SECRET

SECRET

1/2

SECRET

Amend #1
 App 2
 Annex B
 GAD Order 22-58

ANNEX B

ANNEX B

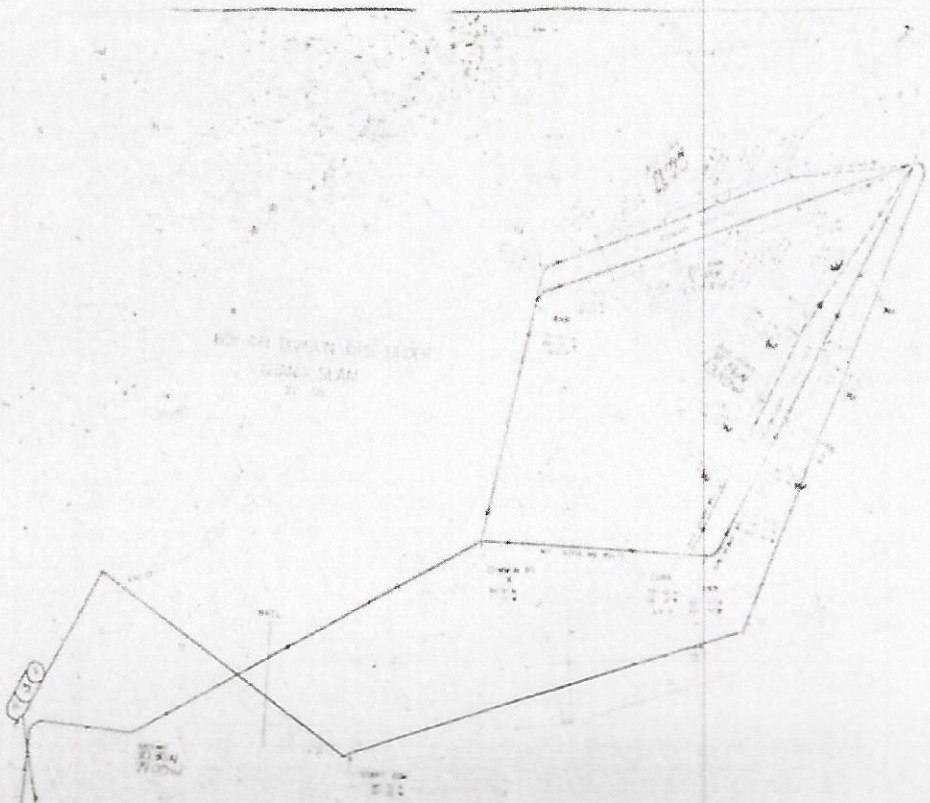

TO GO	500 SW	500 SW
LARGE AREA	10000	10000
FRONT AREA	10000	10000
STORAGE AREA	41.87 0284	41.87 0284
TOTAL AREA	10000	10000
FUEL RESERVE	25.1%	25.1%
TOTAL		

28

1

~~SECRET~~

- c. Aircraft generated subsequent to the first four (4) KC-97's will be released from this exercise as they become generated. At the discretion of the Wing Commander, these aircraft may then be used to meet current operational commitments.
- d. Route and weather briefings will be conducted by the 305th AREFS Operations in the Squadron Briefing Room.
- e. Deployment and Redeployment routes and fuel loads will be in accordance with attached flight plans, this Annex.
- f. Aircraft Commanders will submit completed Form 175's (Section C will contain detailed route, as outlined in Appendix 4, this Annex, followed by the phrase "GRAND SLAM DEPLOY").
- g. Communications will be in accordance with Annex "D", this Order.
- h. The four (4) deployed KC-97 aircraft, crews and Turn Around Team will come under the operational control of the GOOSE Task Force during this mission. /S/
- i. Upon completion of strike refueling operations, Headquarters SAC will release the deployed tankers to the Numbered Air Force for redeployment to home station.
- j. Deploying aircraft will maintain a minimum of 15 minutes separation. ///
- k. Maximum 50-8 accomplishments will be obtained on both deploy and redeploy routes.

~~SECRET~~

4. 306TH AREFS:

- a. Three (3) KC-97's and crews will be placed on strip alert for the duration of this exercise to provide emergency air refueling for the 305th, 306th and 321st Bomb Wings' B-47's.
- b. The remaining generated aircraft will participate in the preparation phase of this exercise only. These aircraft may be loaded as required to meet the current training schedule. Sorties one (1) through four (4) will be maintained on RDS and sorties five (5) through seven (7) will be assigned strip alert. All subsequent aircraft will be released from this exercise as they become generated. At the discretion of the Wing Commander, aircraft may then be used to meet current operational commitments.
- c. B-47's requiring the strip alert aircraft will contact the 306th Bomb Wing Command Post.
- d. 306th AREFS TAT Instructions:
 - (1) Personnel - All personnel assigned to support the 306th TAT commitment will be processed and loaded on board unit aircraft in accordance with 6th Air Division Mobility Plan. When passengers have been loaded aboard, the Aircraft Commander will call the 306th Command Post and ask for release. Release will be granted after scheduled take off time. ///
 - (2) Cargo: All TAT cargo will be processed and placed aboard unit aircraft or in the assigned loading area in accordance

Amend #1 to
Annex "C"
6AD OOrder 22-58
15 Oct 58

3

~~SECRET~~

30

with 6th Air Division Mobility Plan. Exception: No
306th AREFS FAK will be processed or removed from storage
area until the FAK conversion is complete, approximately
15 November 1958. (Second Air Force message IM2B 10378). ///

Amend #1 to
Annex "C"
6AD OOrder 22-58
15 Oct 58

4
~~SECRET~~

3/

~~SECRET~~

HEADQUARTERS 6TH AIR DIVISION
MACDILL AIR FORCE BASE, FLORIDA
15 October 1958

APPENDIX 1

TO

ANNEX C

KC-97 TIMING SUMMARY SHEET

1. Deployment

///

Line #	Call Sign	Aircraft Commander	McD Dep Time		Altitude	ETA Goose	
			A +	Z		A +	Z
			3:00		11M	1202	
			3:30		11M	1232	
			3:45		11M	1247	
			4:00		11M	1302	

2. Redeployment

Line #	Call Sign	Aircraft Commander	Goose Dep Time		Altitude	ETA McD	
			A +	Z		A +	Z

Amend 1 to
App 1
Annex C
6AD OOrder 22-58
15 Oct 58

~~SECRET~~

STANDARD FORMAT FOR ALTITUDE RESERVATION FLIGHT PLAN

NAME AND CATEGORY NUMBER OF MISSION			
GRAND SLAM DEPLOYMENT 1			
A. UNIT TACTICAL CALL SIGN	PROJECT OFFICER (Name and Grade)	DUTY PHONE	HOME PHONE
CURRENT TACTICAL CALL SIGN + 2 DIGITS	FOIA (b)(6)	34-781	8-2584
B. NUMBER AND TYPE OF AIRCRAFT			
4 KC-97 (305 AREFS)			
C. POINT OF DEPARTURE			
MACDILL AFB			
D. ALTITUDES AND ROUTE (If additional space is required, continue on reverse and identify as "D" continued.)			
CLIMB	TO	EXMONT KEY	:10
CLIMB	TO	L.O. 28-41N/82-42W	:23
11M	TO	29-39N/82-42W	:45
11M	TO	ALMA VOR 31-32N/82-32W	1:18
11M	TO	33-32N/82-24W	1:52
11M	TO	ASHVILLE 35-24N/82-16W	2:24
11M	TO	37-13N/81-05W	2:58
11M	TO	ELKINS RNG	3:30
11M	TO	41-09N/76-35W	4:25
11M	TO	ALEANY RNG	5:07
11M	TO	44-35N/70-46W	5:53
11M	TO	HOULTON RNG 46-10N/67-47W	6:35
11M	TO	49-14N/64-59W	7:35
11M	TO	52-00N/62-00W	8:33
11M	TO	GOOSE BAY	9:02
E. DESTINATION			
GOOSE BAY AFB			
F. ETD DATE TIME			
AS EXECUTED BY HQ SAC DURING NOVEMBER 1958			
"A" HOUR PLUS 3:00 1 AIRCRAFT			
3:30 1 AIRCRAFT			
3:45 1 AIRCRAFT			
4:00 1 AIRCRAFT			
G. TAS			
210			
H. ETE			
9:02			
REMARKS (Include estimated cumulative elapsed times between reporting/turning points and any other information pertinent to the mission. If additional space is required, continue on reverse.)			
1. MARSA WITH OTHER 305 AREFS AIRCRAFT PARTICIPATING IN THIS OPERATION.			
Amend 1 to			
App 4			
Annex C			
GAD OOrder 22-58			
15 Oct 58			

~~SECRET~~

HEADQUARTERS 6TH AIR DIVISION
MACDILL AIR FORCE BASE, FLORIDA
15 October 1958

ANNEX "D"

TO

OPERATIONS ORDER

SERIAL NO. 22-58

COMMUNICATIONS

1. GENERAL: Second Air Force Operations Plan 300-59, SAC CBI, CED, Radio Facility Charts (United States, North Atlantic and East Canada), Flight Planning Document, Supplementary Flight Information Documents, appropriate JANAP's, ACP's, SAC Manuals in the 55-8 series, SAC Manual 55-12, procedures apply except as modified herein. /U/
2. EMERGENCY PROCEDURES:
 - a. In accordance with JANAP 130 () and 135 (), Radio Facility Charts, Supplementary Flight Information Document for DF procedures and distress and rescue procedures. /U/
 - b. Emergency use of IFF in accordance with JANAP 160 and SACR 55-23. /U/
 - c. Aircraft may communicate on any frequency with any station, air or ground in emergency. /U/
3. AUTHENTICATION, RECOGNITION, AND IDENTIFICATION:
 - a. Authentication: In accordance with EAA-27 ()/TSEC. /U/ ///
 - b. Recognition: Challenge reply with EAA-27 ()/TSEC. /U/ ///
 - c. Identification and IFF: Cell leader and individual aircraft on mode II, other aircraft on standby while within 300 nautical mile range of North American continent. /S/ ///

Amend #1 to
Annex "D"
6AD OOrder 22-58
15 Oct 58

~~SECRET~~

SECRET

4. CHANNELIZATION: In accordance with current Wing flip cards. /U/
5. CALL SIGNS:
 - a. Air/Ground: Unit Tactical Call Sign plus 2 digit number. /U/
 - b. Air/Air: Cell designator plus position in cell. /U/
 - c. Air Refueling: In accordance with SACM 100-1. /U/
 - d. All SAC Aircraft: SKY KING. /U/
 - e. Any SAC Ground Stations: SKYBIRD CONTROL. /U/
6. RECALL WORDS: *
 - a. All "GRAND SIAM" aircraft: PLEASANT. /S/
 - b. 305th "GRAND SLAM" aircraft:
 - (1) B-47 - PLEASANT SUNFISH. /S/
 - (2) KC-97 - PLEASANT PANCAKE. /S/
 - c. 306th "GRAND SLAM" aircraft: PLEASANT FOXY. /S/
 - d. If aircraft are diverted to other than home base, the recall word /// will be suffixed with the geographical location call sign of the particular base. /S/

* Wing Tactical Call Signs in accordance with SACM 100-51 series. ///
7. PROCEDURES:
 - a. Alfa Monitor Procedure: Cell leaders will designate aircraft to monitor the following frequencies in the order listed:
11228, 6730.5, 15016 and 5710.5 KCS. ///
 - b. Position Reporting Procedures: Procedure Alfa applies for position reporting (SACM 55-8M, as modified by SACM 55-12). All civil procedures will be complied with as required by appropriate Facility Charts and SFID's. HF position reports are not required

Amend #1 to
Annex "D"
GAD OOrder 22-58
15 Oct 58

~~SECRET~~

as long as altitude reservations are retained and flight is within allowable timing and track limitations. /U/

- c. Reports: B-11, T-11 and T-18 will be submitted to nearest SAC Command Post via UHF. /S/
 - d. Air Refueling in accordance with SACM 100-1. /U/
 - e. NOAH'S ARK procedures will apply for this mission. KAC-72 will be used for decoding NOAH'S ARK messages.
 - f. Aircraft that receive a Noah's Ark message will relay it by UHF to all aircraft within the cell. /U/
 - g. Aircraft launched under Positive Control will query "SKY BIRD /// CONTROL" on UHF, "Do you have a message for me?" While within UHF range of MacDill AFB, McCoy AFB and Hunter AFB to obtain the "Go-Code" encoded in the KAC-72 ()/TSEC. For HF receipt of "Go-Code" listen during Alfa monitor periods. /S/
 - h. Strip alert tankers: Aircraft requiring strip alert tankers from MacDill AFB contact Foxy control on 321.0 MCS. Command Post will advise concerning C/R plan, RDZ, heading and altitude.
8. DISTRESS AND RESCUE FREQUENCIES:
- a. One (1) of Alfa monitor frequencies when out of ZI if time permits otherwise activate Emergency Keyer on 8364 MCS. /U/
 - b. 243.0 MCS. /U/
 - c. 282.8 for coordination with Air Sea Rescue. /U/

Amend #1 to
Annex "D"
6AD OOrder 22-58
15 Oct 58

~~SECRET~~

HEADQUARTERS 6TH AIR DIVISION
MACDILL AIR FORCE BASE, FLORIDA
15 October 1958

ANNEX "E"

TO

OPERATIONS ORDER

SERIAL NO. 22-58

ELECTRONICS COUNTER MEASURES

1. GENERAL INSTRUCTIONS:

- a. The ECM activity of this mission is designated to activate a portion of the Radars of the 35th Air Division (Defense), and by evasion, deception and electronic and/or mechanical jamming, to arrive at the target area with a minimum number of radar and/or fighter intercepts. ~~/C/~~
- b. Necessary clearances for ECM activity will be coordinated by 2AF. ECM transmitters will be placed on "Standby" 15 minutes after take off. Individual crews will monitor normal communication channels. AFR 55-44 and applicable supplements will govern use of ECM equipment at all times. ~~/C/~~

2. ROUTE:

a. ECM "On" Line.

- (1) The ECM "On" line bisects the track at 7400W. ///
- (2) At this time, all electronic jammers and single unit chaff dispensers will be activated. Continuous jamming and chaff dispensing will take place until a point abeam Charleston, South Carolina is reached (32-56N/80-00W),

AMEND #1 to
Annex "E"
6AD OOrder 22-58
15 Oct 58

~~SECRET~~

37

~~SECRET~~

at which time all countermeasures will cease.

- (3) Upon receipt of the code word "STOP BUZZER", transmitted from an ADC site, all electronic countermeasures will cease. The code word "STOP STREAM" indicates all chaff dispensing will cease.

3. EQUIPMENT LOADING:

a. Jammers.

- (1) Equipment loading will be either 2 "L" band and 1 "S" band or 3 "S" band transmitters for Phase VI aircraft. ///
Phase III aircraft will either have 1 "L" band and 1 "S" band or 2 "S" band transmitters, as indicated in SAC Form 99, Appendix 1, this Annex. ~~A/~~

b. Chaff.

- (1) Chaff inserts will be used as available and will be loaded on the earliest aircraft generated. Additional generated sorties will hand-load training chaff only.
- (2) Chaff inserts will be loaded on earliest generated sorties until supply is exhausted. EWO chaff will be taped to side of insert to insure that EWO chaff cannot be dispensed through strippers. One (1) carton of RR-20 chaff will be top loaded in left chaff insert, and proper precaution will be taken that rope chaff, pre-loaded in left insert, cannot be dispensed. One (1) carton of RR-39 ///
training chaff will be top loaded in right insert, and

Amend #1 to
Annex "E"
6AD OOrder 22-56
15 Oct 58

2

~~SECRET~~

SECRET

proper precaution will be taken to insure that EWO chaff cannot be dispensed.

- (a) When supply of inserts has been depleted, training chaff will be hand-loaded in left and right hoppers. The maximum chaff load required for left dispenser system is one (1) carton of RR-20 chaff. Six (6) cartons per aircraft of RR-39 training chaff will be hand loaded in right dispenser. One carton only to be /// threaded through strippers.

4. EQUIPMENT CALIBRATION:

- a. All AN/APS-54 equipment will be operational. /X/
- b. All chaff dispensers will be operational and checked for SUD in accordance with SAC letter, DM6D, dated 24 August 56, and 2AF letter, dated January 1957. /X/
- c. Jammer Settings: Bomber aircraft will operate "S" or "L" band transmitters pre-set to sweep 2700 MC to 3100 MC at 100 MC/Sec and 1215 MC to 1365 MC at 60 MC/Sec, respectively. /X/

5. CONTROL:

- a. IFF will be on standby for all aircraft prior to the "Start ECM" line and remain on standby until reaching the ECM off point, at which time IFF will squawk as briefed. /X/

6. ACCOMPLISHMENTS:

- a. All aircraft will accomplish all possible 50-8 ECM requirements during the mission. /U/

Amend #1 to
Annex "E"
GAD OOrder 22-58
15 Oct 58

3

SECRET

39

ENTRY AND DESTRUCTION CERTIFICATE			PAGE NR 1	NR OF PAGES 2
SECTION I - ENTRY AND DESTRUCTION DATA				
1. <i>Hq and Staff Agency (To be filled in only when certification required by originator)</i>		2. DOCUMENT		INSTRUCTIONS: 1 copy filed in basic document. 1 copy for appropriate Control Officer's file (AFM 181-1). 1 copy returned to originating Hq when item 1 accomplished. 1 additional copy for Top Secret Control Officer as required.
		Amend No. One to GAD Order 22-58 "GRAND SLAM", dtd 15 Oct 58		
3. SECTION(S) AMENDED	4. ENTER PAGE(S)	5. REMOVE PAGE(S)		
Letter of Transmittal	1			
Basic Order	5, 5A, 6 and 8	5, 6 and 8		
Annex "A"	3	3		
Annex "B"	2, 2A, 3, 4, 4A, 5, 6, 8 and 9	2, 3, 4, 5, 6 and 8		
Appendix 1, Annex "B"	1, 3, 4, 6, 7, 9, 10, 12, 13, 15, 16, 18	1, 3, 4, 6, 7, 9, 10, 12, 13, 15, 16, 18		
Appendix 2, Annex "B"	1	1		
Annex "C"	2, 3 and 4	2 and 3		
Appendix 1, Annex "C"	1	1		
Appendix 4, Annex "C"	1	1		
Annex "D"	1, 2 and 3	1, 2 and 3		
Annex "E"	1, 2 and 3	1, 2 and 3		
6. NR OF PAGES IN CHANGE	7. NR OF PAGES IN DOCUMENT	8. COPY NR OF BASIC DOCUMENT (in which pages listed in Item 4 have been incorporated)		
39				
Pages listed in Item 5 have been removed and destruction is authorized by Paragraph 5B, AFM 181-1.				
9. DATE	10. ORGANIZATION AND OFFICE	11. SIGNATURE (Individual preparing document)		
SECTION II - CERTIFICATE OF DESTRUCTION				
I CERTIFY THAT THE PAGES LISTED IN ITEM 5 HAVE BEEN DESTROYED IN ACCORDANCE WITH AFR 202-1.				
12. SIGNATURE	13. SIGNATURE	14. DATE DESTROYED		
15. TYPED/STAMPED NAME AND GRADE (Control Officer)	16. TYPED/STAMPED NAME & GRADE (Witnessing Officer)	17. CERTIFICATE NR		