

~~SECRET~~
ORCON/NOFORN

GRILL FLAME

PROJECT

SESSION REPORT

copy 2 of 2 copies

CLASSIFIED BY: Director, DIA
DECLASSIFY ON: 31 Dec 99
EXTENDED BY: Director, DIA
REASON: 2-301-C (3) (6)

GRILL FLAME

This document is made available through the declassification efforts
and research of John Greenewald, Jr., creator of:

The Black Vault



The Black Vault is the largest online Freedom of Information Act (FOIA)
document clearinghouse in the world. The research efforts here are
responsible for the declassification of hundreds of thousands of pages
released by the U.S. Government & Military.

Discover the Truth at: <http://www.theblackvault.com>

~~SECRET~~
23 Dec 79

SUMMARY ANALYSIS

REMOTE VIEWING (RV) SESSION CC40

1. (S) This report documents a Remote Viewing (RV) session conducted in compliance with a request from SOD, J3, OJCS, Pentagon, Washington, D.C. The purpose of the session was to provide information relevant to the hostage situation in the U.S. Embassy compound in Teheran, Iran.
2. (S) The remote viewer's impressions of the target are provided as raw intelligence data and as such have not been subjected to any intermediate analysis, evaluation or collation. Interpretation and use of the information provided is the responsibility of the requestor.
3. (S) The protocol used for this session is detailed in the document, Grill Flame Protocol, AMSAA Applied Remote Viewing Protocol (S), undated.
4. (S) Following is a transcript of the viewer's impressions during the remote viewing session. At TAB A are drawings made by the remote viewer reference his impressions of the target site. At TAB B is target cueing information provided the remote viewer.

TRANSCRIPT

REMOTE VIEWING SESSION CC40

#20.5 This will be a remote viewing session (edited for security).

PAUSE

For the past few minutes you've been looking at a photo of an individual. I want you to relax, relax and concentrate, and tell me about that individual. Describe where he's located. Relax and concentrate

PAUSE

+09

#14 The only impressions I've had so far is a dark roomthe walls are rough....stone like....cool..... cool dark. There's...seem to be pipes overhead on the ceiling. Then I saw a shape which was..uh.. totally independent image. This shape ..this shape reminded me of a roulette wheel. Shortly after that I seemed to be outside of the room looking down a long dark hallway.

#20.5 Walk down that hallway now. Walk down that hallway and tell me what you see.

PAUSE

+12

#14 I'm not.....I'm not sure if I see it or have a sense that I am perceiving. There's...there's... many, many rooms. I'm not sure whether...whether this is analytical overlay or whatever...it... it seems like some sort of jail setup. Very thick rough walls separating these rooms, after room. Very dark. Very uncomfortable. Very uncomfortable.

#20.5 Are there any people in these rooms?

PAUSE

#14 I saw one person, I assume .. I assume to be subject lying on aI can't describe it as a cot. It's almost like a slab of wood next..up next to the wall. Subject was lying on left side with knees drawn up and both hands between the knees. At the time you asked me if there were people, I seemed to go back to the point of origin where I started and that's why I believe this is we were focusing I had...at the same time.....um....brief flashes of other figure shapes and other positions. But, it

was an all at once thing. I...I did not move to another room, or anything. It's just..all these figure shapes came all at once. I keep getting a shape triangular shape. This shape is the one that reminded me....the roulette wheel. I seen this shape upside down, right side up, I don't know what's right side down, and right side up. I seen this shape from all different perspectives. At first I felt as if I was..uh..in some type of basement, or something, but that may have been only because of the surroundings. I'm not sure if I am below ground level or at ground level. I.....I'm not sure.

PAUSE

+24

#14

*BASMENT
of CHANTRY*

It's confusing. Uh...when I described this hallway with rooms...lots of rooms (mumbling) I had an impression I was on a....like a...ground floor level. I...before that...when I described these pipes and things.....in ceiling...had feeling of like a basement type thing.....and I tried to sort out the two different feelings that came up with the third, and it's...it's like I recognize the place from one of the other targets that we did....the Colonel....and it seemed to be the same place. I was at a lower level....and it was dark, rough, rough stone walls. Kind of like almost like a dungeon type atmosphere. But, you had to go up steps to get out of there. For some reason, I was.....the only thing that I could think there are several levels to this facility, whatever. This building. And, another thing that ...that may be significant, and I, very early passed it off as analytical garbage and may have to do with the outside of this structure...very before we started, I kept seeing these arches with pillars, arches and pillars, and, ..uh..they came back to me during this session. Very definitely, I believe ...something to do with the outside of this structure.

No level

#20.5

Ok. I want you to relax and do some of the drawingstake a little break and do some drawings, ok.

#14

I really had definite feeling of a ..a prison type atmosphere. More, more than..uh..anything else.

#20.5

Why don't we go ahead and draw imagery that you had.

#14 I guess the heaviest one was picture I had of a individual. I didn't get any close up....any detail on the face or anything, but a person lying on a slab couldn't even describe it as a cot or or bed or anything. It seemed more like a wooden slab up against the wall, and I'm not sure how it was arranged, but, the individual was..uh..kind of lying with the knees drawn up, and..uh..both hands rather kind of tucked in between the legs. This is a pretty poor drawing, but you get the idea. Everything seemed so dark, and there wasn't ..uh.. there wasn't much of anything around, and, I'm not sure what supported this plank or whatever, but, it's the type of pose somebody takes when....I don't know.....cold, or whatever. I had a feeling for.. way up here...way up high...perhaps there might have been a very narrow opening or window or something....

#20.5 This room was located someplace on this long hall?

#14 Yes. I'm almost positive of it because when I first saw this room.....no I didn't see the individual, at first, I saw this room with...it seemed like pipes going over the ceiling, whatever. And, then I was out in this hallway, and then when you asked if there were any people there, or, maybe you took me back to the hallway, or something, I don't remember, but, the hallway seemed to be outside of this particular room here. Uh...there just wasn't much in there, and the walls were very rough...and...uh...uh...I had feeling that...you know...there were pipes and stuff. Uh...going down the ceiling. I don't know where they came from or where they went to, or anything like that. Everything was very dark. Um...and I do believe that to be the subject that we were focusing on.

(Mumbling) this hallway all seemed very rough. Very dark and there seemed to be..um..very solid partitions.. walls that broke up these separate rooms. I mean real thick. Now, I'm not absolutely sure if there were doors there, there were doors of some kind...but, whether they were solid or whether they were..uh..other kinds.

#20.5 Were there rooms on both sides?

#14 Well, I came from this side into the hall and..uh.. I perceived all the rooms on this side.

#20.5 How did you get out of there?

- #14 For some reason, down the hallway. Down to... but it was...the overall feeling I had was like a fortress or the inside of a fortress, or something, and very old. Or it would appear old because of all this real massive solid..uh..I had this feeling of massive stone and mortar.
- #20.5 Ok. Tell me a little bit.....describe that roulette wheel type thing.
- #14 That was really odd. Uh..it really broke off my concentration. It threw me way off track. Uh.. 'cause the first question I asked myself, you know, is gambling legalized in Iran, or something. It really...but,,,at first...and I'll label these as they..uh..this is three..how they came to me. Now the first one was kind of like that. Now, that ..that was just a shape to me. The second one I saw...and they all had kind of a little...kind of a knob on top...but the second one seemed to come out like this and there may have been...something like that. Now B is the one that really reminded me of a roulette wheel, for some reason. I don't know why. May be just an analytical association. But, I also, later on, saw this same shape from the side angle. Now, I'll orient this thing north and I saw A, it was...it appeared upside down, B, it appeared right side up, and C, I saw it sideways.
- #20.5 Ok. This was just an isolated.....
- #14 Yes. They kept popping in. The first time I saw this..I saw A about just before I saw the separate room where I perceived the subject to be, and after that I saw B, and somewhere in between the session stuff I saw C. It's..uh..it was a recurrence type of thing.
- #20.5 You couldn't tie it together with something else.
- #14 No. Absolutely not. I'm sure it's tied together with the..uh..the facility or the building or the structure or something, where we were at. Again, and I had a feeling this was another level, very rough construction, and this is...may have been just pure analytical overlay. But, I certainly had the feeling of being at a lower level...uh...subterranean level, or something. Almost looked like the old..uh..prison type thing or dungeon, whatever. You know, with bars and all that stuff, and..uh..

in order...it's the same thing I had before. In order to get out of this place, you had to go up these stone steps, and they were....these were stone. They almost seemed like they were carved out of rock or something...to get out of this place. And, from where I was, I was here, and there seemed to be these rooms or cells or divided off to my left. It was ...more like a dungeon type atmosphere than it was even a prison. That we would thing of.....

- #20.5 Do you go up these stairs to the front door?
- #14 To a door which leads to the..uh..upper level or whatever.
- #20.5 Can you describe any of that area up there?
- #14 I believe it's still the same structure. I believe..uh..that may lead up to somewhere connecting to that hallway up on the first level. It's almost...I had the same feeling and the same view of one of the past sessions that we had with Colonel, what's his name?
- #20.5 Colonel Holms. (Holland) *REF CC 35 CC 26*
- #14 Holland. We had two individuals who were targeting out at the same time. One seemed to be on an upper level and then I went to a lower level, which was more...which was just like.....
- #20.5 Ok. We'll try to cross that out....cross-check it out.
- #14 Yes. It seemed to be kind of like the same situation.
- #20.5 Ok. Anything else then?
- #14 Uh...the one other thing that..that I could put down...which...the shape kept popping in...and, there's no doubt in my mind, it relates to the outside of this structure, or a structure nearby, or something, but, at first I tried to put it off because of the analytical overlay, you know, but, it...it kept kind of popping back. I saw these pillars ...or columns or whatever. Seemed to be..uh..funny arches, and behind it it was dark. Oh, I would say that perhaps it was a walkway, or something. I'm not sure what was above or behind the thing.
- #20.5 Ok. Good. Anything else that you can remember?
- #14 No. Except that, at the same time I got a real good look of the one individual laying on the slap, you

~~SECRET~~

know, kind of drawn up...uh...I had about three or four flashes of others in different positions or other figures, or whatever. But, I did not move. In other words, I didn't go to another room, or whatever. It all came at once.

#20.5 But, you don't know where that was?

#14 Well, I had the feeling there were other people located in that structure.

#20.5 Ok. We'll have to have someone run this back by the other one and compare it, you know, the other sessions.

How do you feel about this session?

#14 Well it's really hard to say. I didn't...I didn't go very deep but then at times I seemed to be.. kind of like the "wink" affect...in and out... I really don't know.

#20.5 Anything else you want to add?

#14 I can't think of anything.

#20.5 Ok.

TAB

①

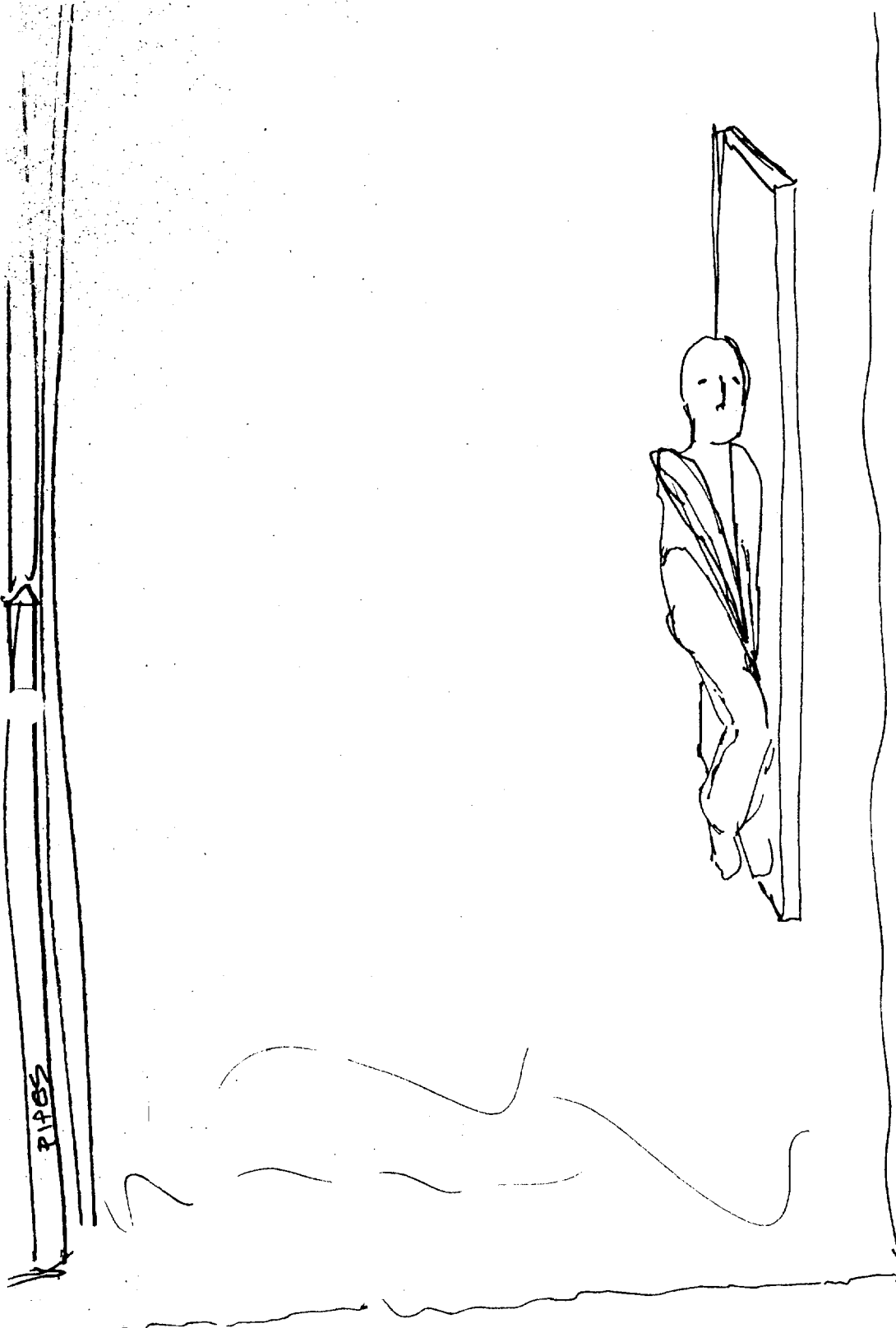

P1482



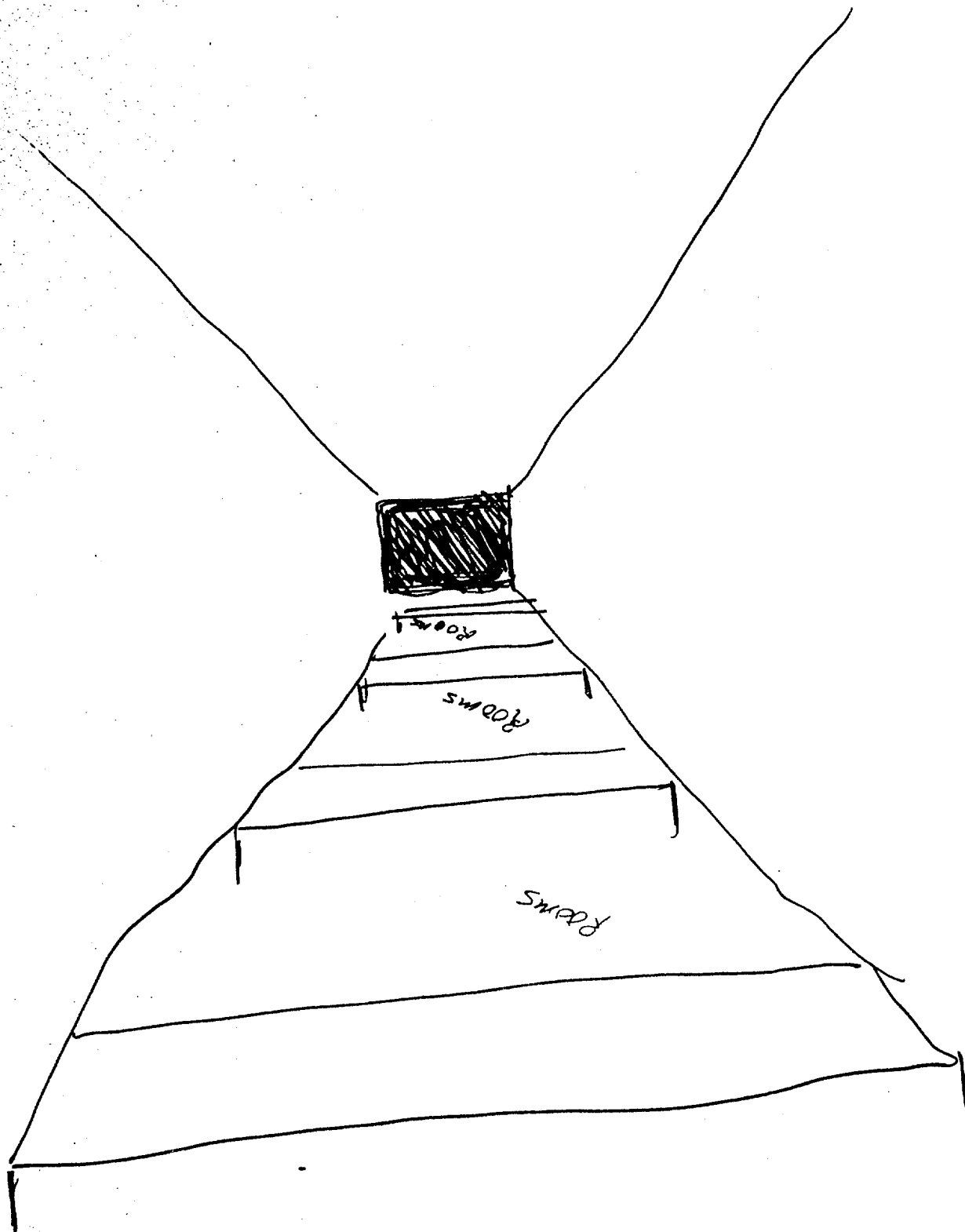

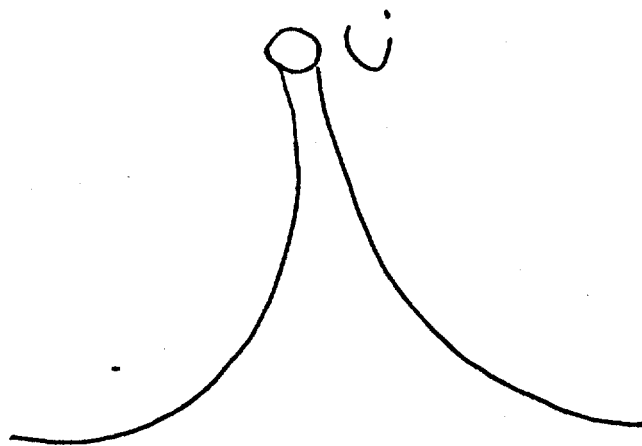
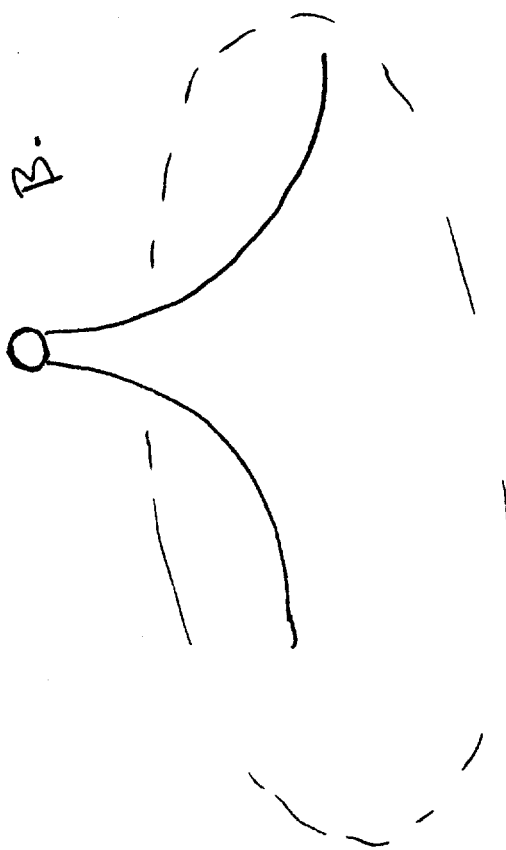
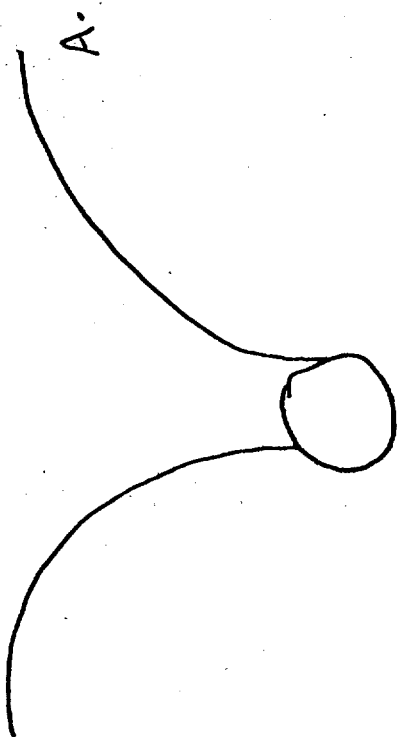
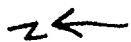

4

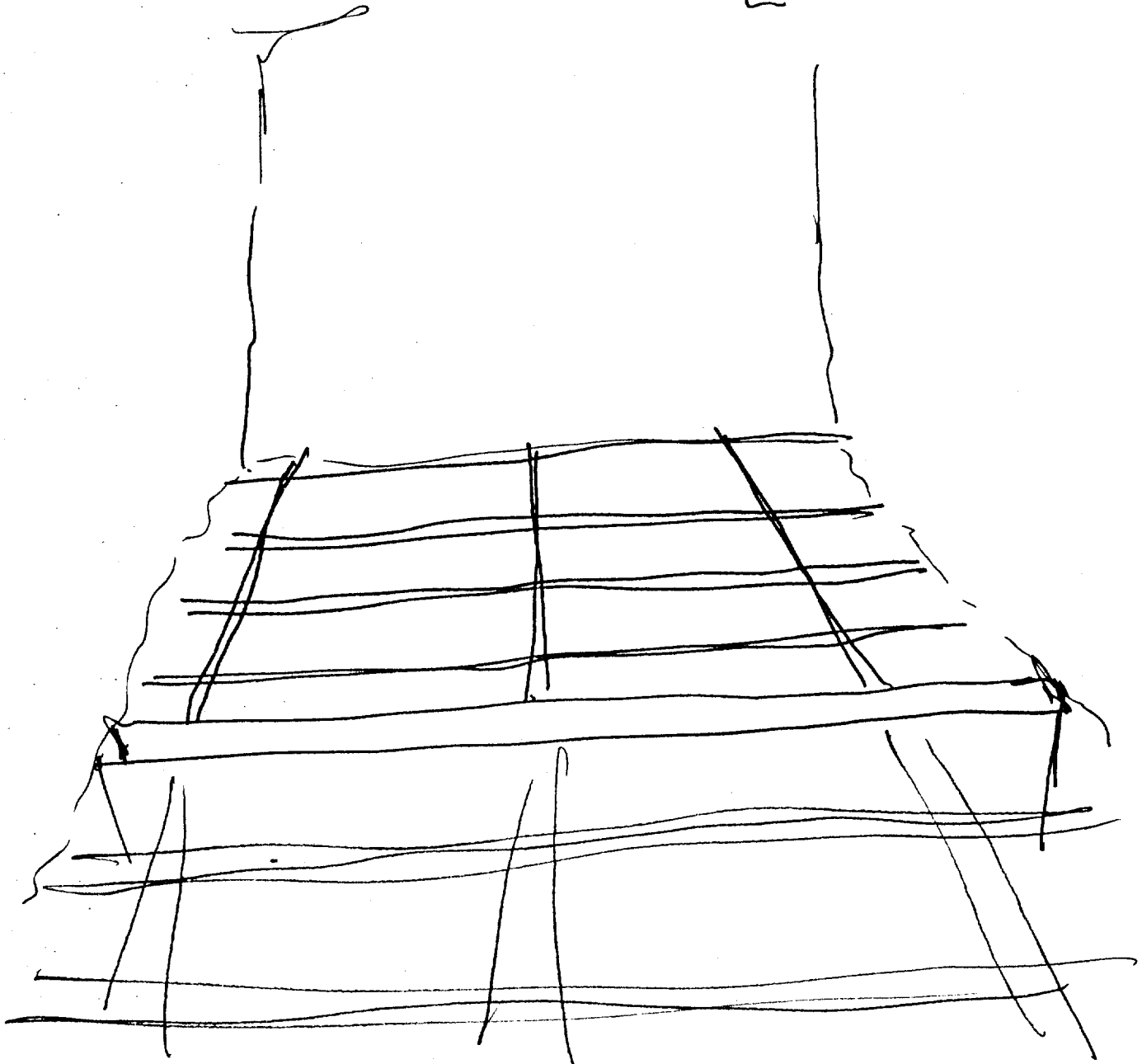
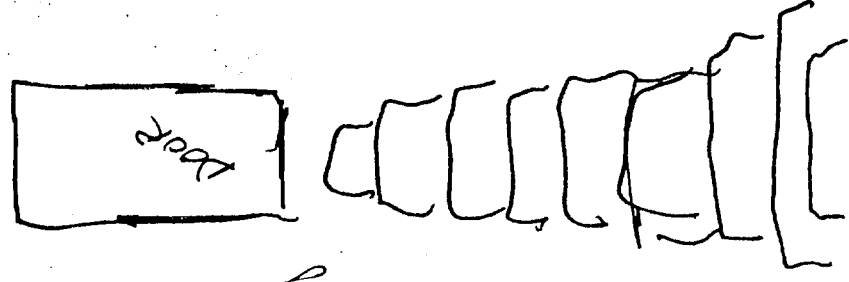
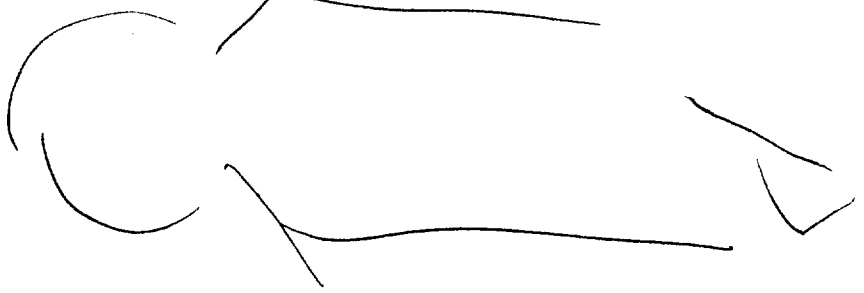

15

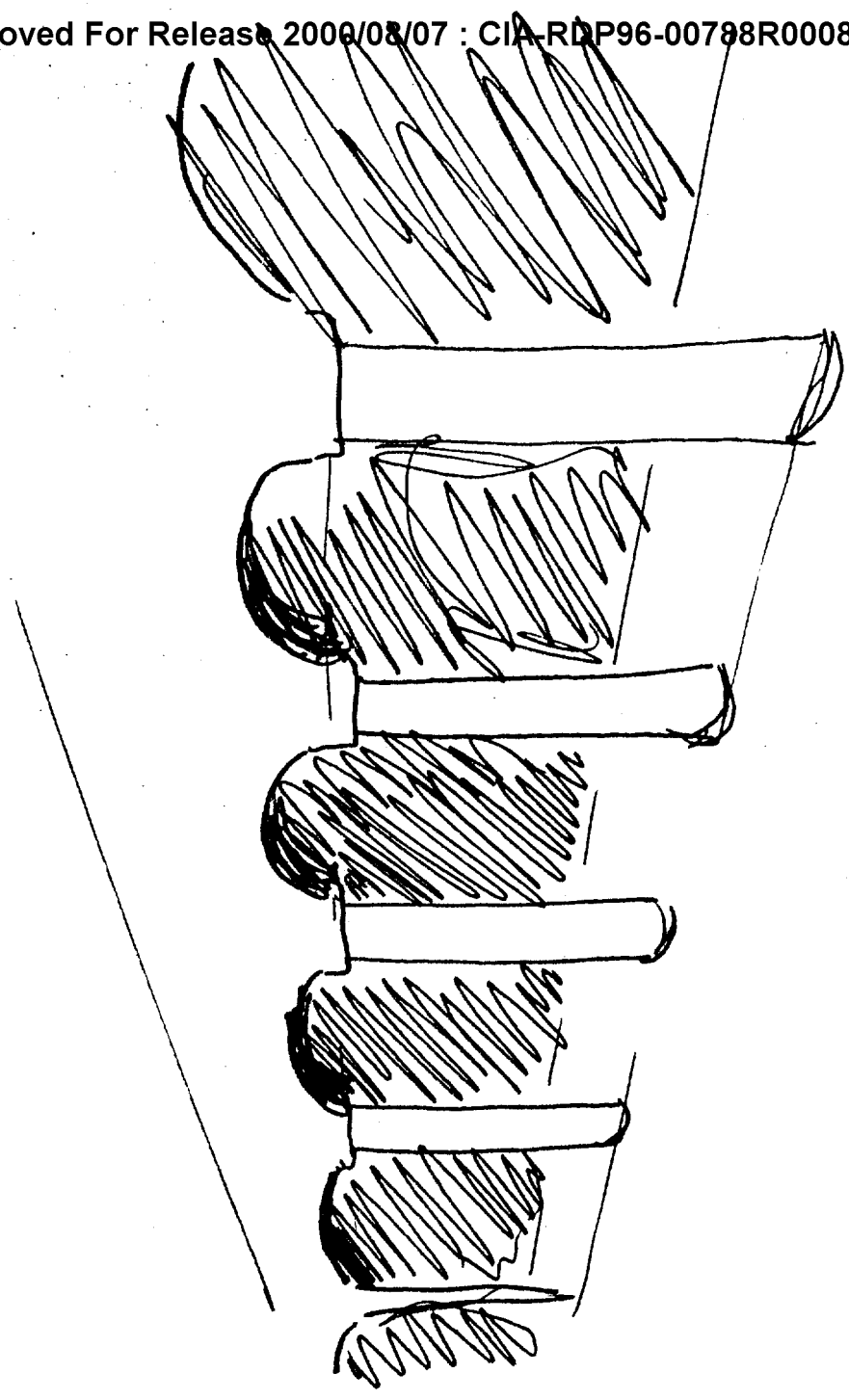

TAB

~~SECRET~~

TARGET CUBING INFORMATION

REMOTE VIEWING (RV) SESSION CC40

1. (S) The viewer has been exposed to open source news media information as well as classified overhead imagery. He knew he would be working against the hostage situation in Iran.
2. (S) At the time of the session, the viewer was shown the following photograph.

~~SECRET~~

SGFOIA3

Approved For Release 2000/08/07 : CIA-RDP96-00788R000800320001-9

Approved For Release 2000/08/07 : CIA-RDP96-00788R000800320001-9