

101
8607
SOLD

Summary written at 0900 17 April 86. Done at 2300, 16 April Helga style.

Set down in a narrow street level at night on a warm evening. Looking up STREET (SK#1) SEE ROWS OF TAN CONNECTED BUILDINGS, NONE HIGHER THAN FOUR STORIES, STRETCHING UP HILL. BUILDINGS LOOK ALMOST EUROPEAN. LIKE WHAT YOU MIGHT SEE IN AN OLD MID-SIZED TOWN IN FRANCE OR GERMANY. LARGE BUILDING ON CORNER APPEARS PARTIALLY DAMAGED. THERE IS NO ONE ON STREET AND NO LIGHTS IN BUILDING. STAR LIGHT IS VERY BRIGHT HOWEVER.

TURNING AROUND AND LOOKING BACK ON THE SAME SIDE OF STREET AS DAMAGED BUILDING BUT SEPERATED FROM THAT BUILDING. IS A COMPOUND. COMPOUND IS SURROUNDED BY LOW WALL (MAYBE 7') WALL TURNS AT ANGLES SO COMPOUND HAS MORE THAN 4 SIDES



THERE IS ONE GAYRD, IN A LIGHT TAN UNIFORM OUT SIDE GATE. GATE MAY BE METAL, REST OF WALL APPEARS TO

This document is made available through the declassification efforts
and research of John Greenewald, Jr., creator of:

The Black Vault



The Black Vault is the largest online Freedom of Information Act (FOIA) document clearinghouse in the world. The research efforts here are responsible for the declassification of hundreds of thousands of pages released by the U.S. Government & Military.

Discover the Truth at: <http://www.theblackvault.com>

BE OF NATURAL TAN COLOR MATERIAL.²
THERE IS NO ACTIVITY IN COMPOUND.

LARGE BUILDING IN COMPOUND IS IMPORTANT.
BUILDING IS LIGHT COLORED, MADE OF STONE
OR BRICK AND APPEARS TO BE EUROPEAN
IN DESIGN. MOST OF THE LIGHTS IN
THE BUILDING ARE ON, BUT THERE
IS NO ACTIVITY. THERE ARE *SOME
"WATCH OFFICERS" AWAKE, BUT THAT
APPEARS TO BE THE ONLY ACTIVITY.

WHAT IS IMPORTANT HERE IS
LACK OF ACTIVITY.

SK 1

COMPOUND

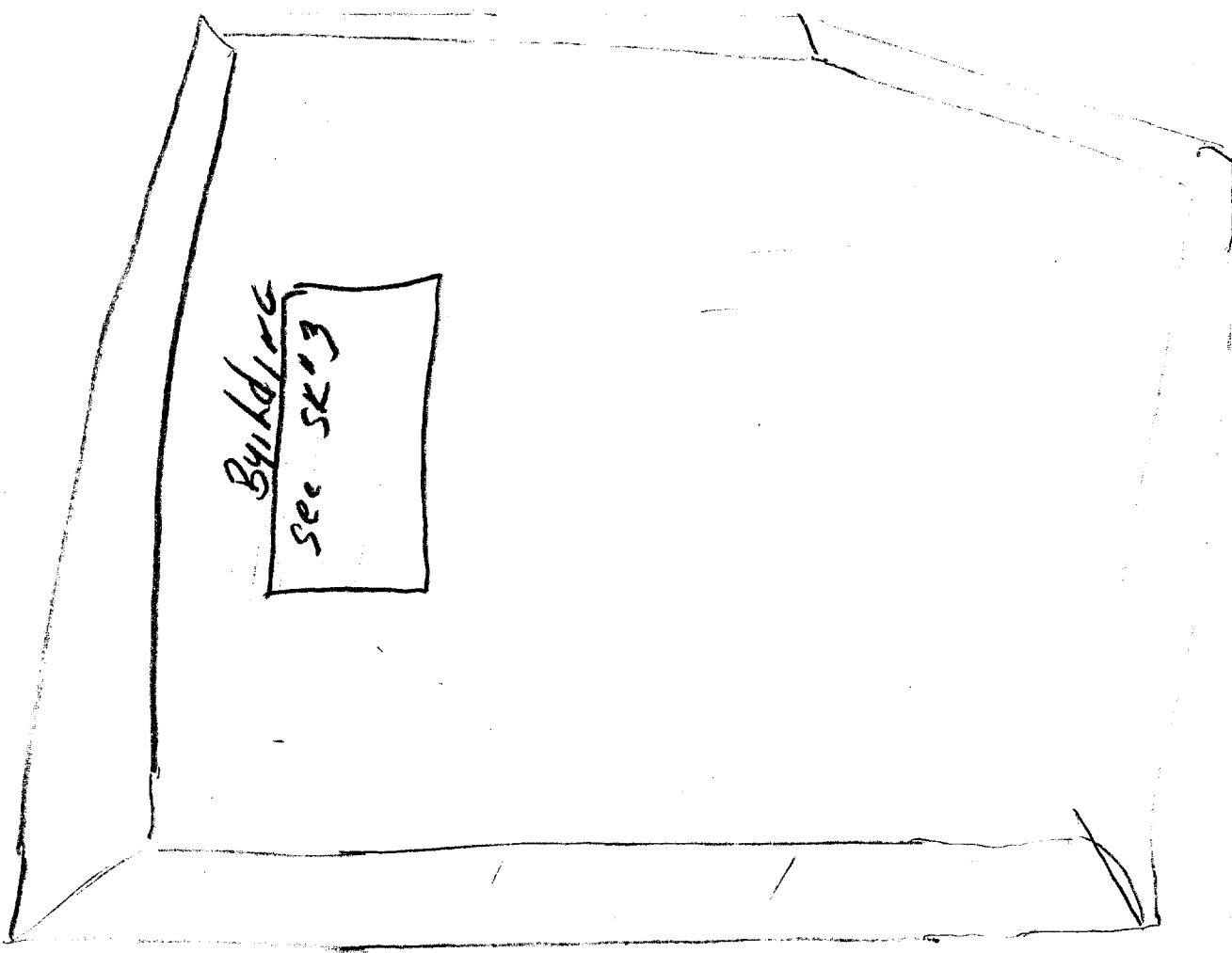

see
SK#2
→

SK 2

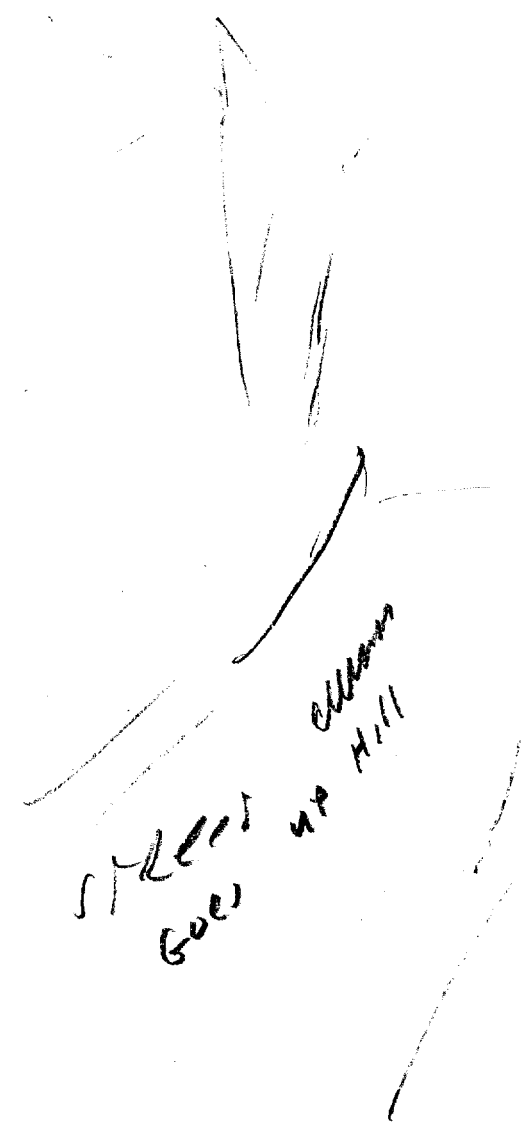
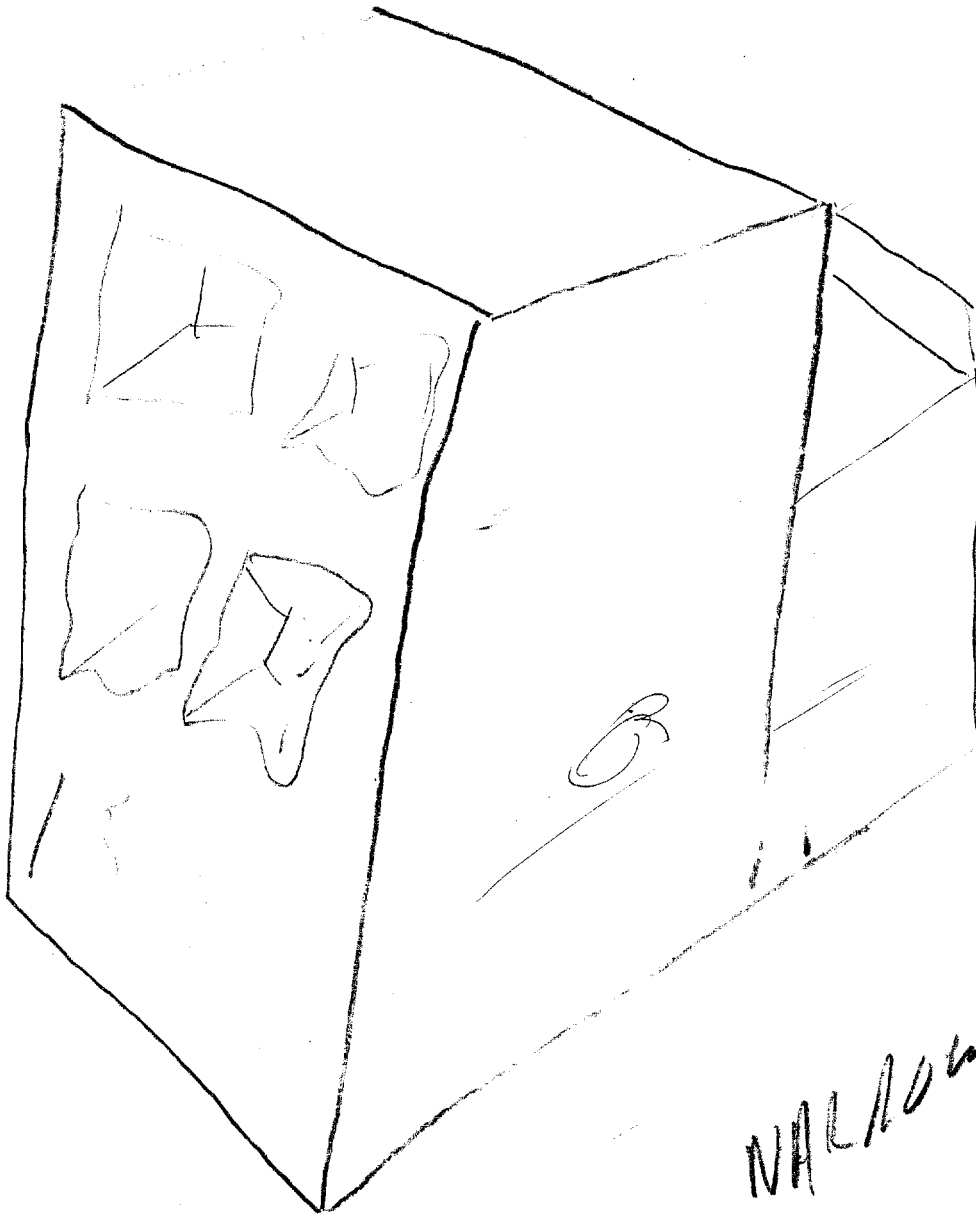

NARROW

STREET
GOES UP HILL

Hill

ADL LOOKS LIKE
A NARROW EUROPEAN
STREET, EXCEPT IT
FEELS TOO SPICY

Building, LONG, LOW 2 OR 3 STORIES. MAYBE 2 1/2 STORIES.
MADE OF STONE. SEMI-ORNATE. LOOKS ALMOST
EUROPEAN.

