

Project CY 8609

Task

1. Describe the technical facility located vic:

SG1A

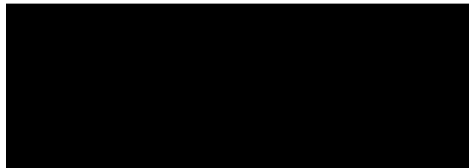

2. Within the following ten year period determine if and when any "special events" occur:



* Note: If you do find any "special events" - - - subsequent sessions will be focused on each separate "special event."

This document is made available through the declassification efforts
and research of John Greenewald, Jr., creator of:

The Black Vault



The Black Vault is the largest online Freedom of Information Act (FOIA)
document clearinghouse in the world. The research efforts here are
responsible for the declassification of hundreds of thousands of pages
released by the U.S. Government & Military.

Discover the Truth at: <http://www.theblackvault.com>

Paul
23 Oct 82
F. (M...)
Ed
1342

SG1A

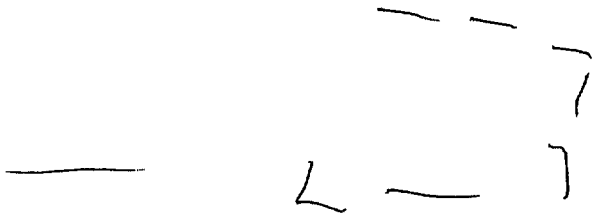

A. over
fat
used
to land

A. also
has
inside

confusion 51

Can



d. above
flat
now
B. (unclear)

A. along any
above
any
Solv
B. (unclear)

A. along
any
along
Solv
B. (unclear)

5-2
white
slightly
got
cold
brown
green
grey
rough
smooth
salty
hard
bumps
black
. animal smell
red
flat foot
dirty smell
green
up
any red
flat
angle

*random
derogis fact*

*for Bk
Dundak
warin
Journal*

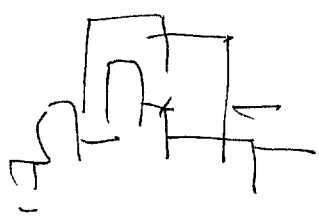
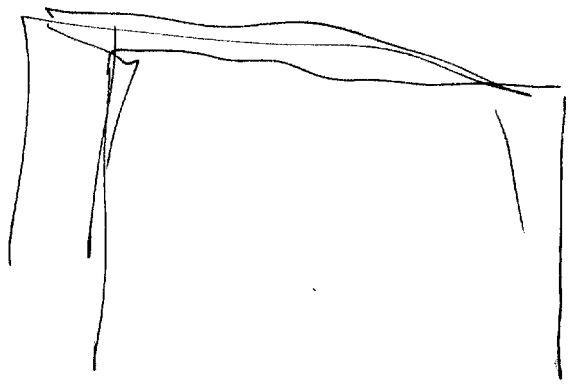
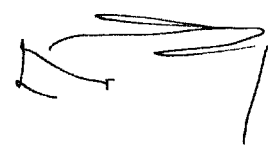
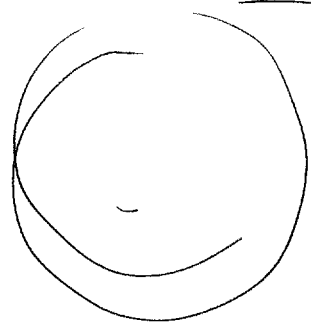
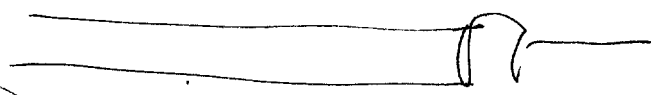
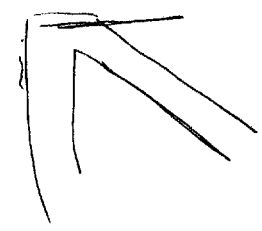
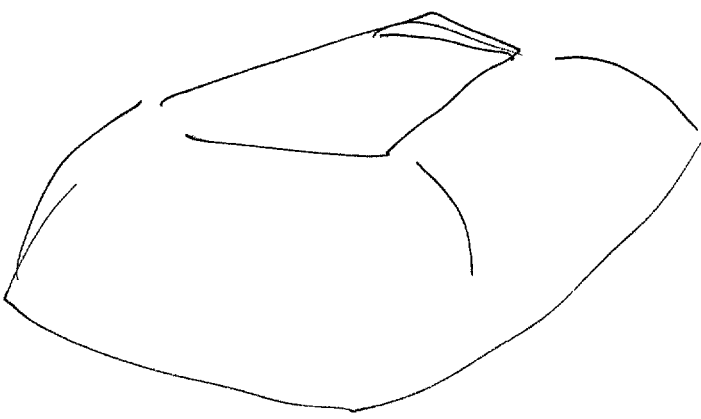

S2
S. 1/2
sunny
cool
cold
wet
blue

gray

die
colored
flappies
sand
breezy
brown

several
structures

objects

Complex

compound

fence

rusty

weeds

S2

D PZ EL T L H/L

5
ALS

pipe



founder
fall

structure



structure

Summary

open
area

Compound/
facility

structure
groupings

surrounds
fence

different
height
different
structures
but
related

various
objects
gate

S2

D A2 B2 C2 D2 E2 F2 G2 H2 I2 J2 K2 L2 M2 N2 O2 P2 Q2 R2 S2 T2 U2 V2 W2 X2 Y2 Z2

Ob, cuts

long
thin

shiny

round

the LBU
live
pipelines

machinery
has used

S4 1/2 - not "abandoned", just not used for a while

S VI

7

S2

D

AZ

EZ

T

I

402

AB

A I Be
Whills

P. 1

Ob; cut

blak
grey

ground

sort of
yellow

metallic

very
large

3 or more

disassembled

~~part~~

M-BK
put together

Special events?

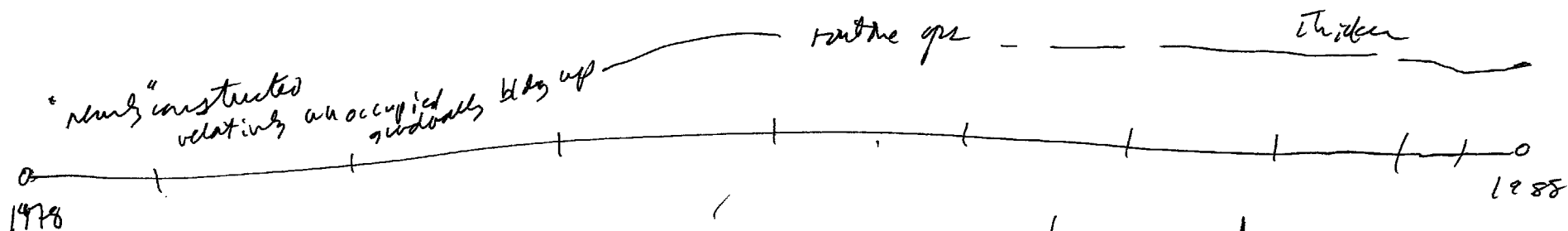

52

D

AZ

FF

T

I

AVL

AS

S VI

round
cone-shaped

parts

metal

5 1/2 - to be put on the end of @
E cylinder.

finger
~~knob~~
preserver

laying down

to be used
elsewhere

P+ 2

fundamental

AZ Box
chords

remedy
vibration
moving
high mass
hand held
remedy

SVI

7

S2

D

AZ

EZ

T

I

AL

AL

large
shape

horns



Shady

AL BK
large dark
cloud
moving
fine

AL BK
space
launched

fuel-surrounds

Site is a compound of numerous structures + objects. A sense of being run down is present. Impression of several ~~of~~ round, silvery, perhaps pipe, remains parallel. Various machinery here + there; impression of not of "abandoned," but of "not being used" for a while. 2 points of ^{possible} interest in part. First (ca. mid '83?) large black metal cylinders w/ tapered "caps" to be attached + moved elsewhere. Next (in late '84?) keep running sound + large mass on slope moving off diagonally ~~at~~ first starts for very short distance, then slowly further on.

end
1449