

SOURCE 079
19 OCT 87

DURING THIS SESSION, I FIRST SAW A LARGE, SQUARE, THICK, STRUCTURE THAT WAS POINTED. IT SEEMED AS THOUGH A SOFT CLOTH MATERIAL WAS HANGING FROM THE STRUCTURE BECAUSE I COULD SEE THE WIND BLOWING AND THIS SOFT CLOTH WAS FLAPPING IN THE WIND. THIS MIGHT BE A FLAG.

ALTHOUGH THE STRUCTURE WAS PLACED IN A BIG, WIDE, OPENED AREA ON LOW FLAT HILLS AND THERE WAS GREEN GRASS AND TREES, I COULD SEE SMALLER STRUCTURES NEARBY SPREAD OUT AND THERE WAS ROADS CIRCLING THIS WHOLE AREA THAT BRINGS YOU TO AND FROM THE STRUCTURES. THERE ARE PARKING SPACES NEARBY.

I COULD SEE MEN AND WOMEN WALKING AND TALKING OUTSIDE AND THIS WAS A BUSINESS AREA.

BEHIND THE STRUCTURE, I COULD SEE MEN WORKING AND BEING CONCERNED WITH THE STORAGE OF BIG OBJECTS. THEY WERE CONCERNED WITH TRACKING DOWN, ACCOUNTING FOR, AND COLLECTING LARGE OBJECTS. THIS AREA WAS SPACIOUS AND IT WAS BUSY.

AS I ENTERED THE LARGE STRUCTURE, I COULD SEE FEMALES STANDING BEHIND A LARGE THICK COUNTER AND THEY HELPED PEOPLE WHO ENTERED. THEY GUIDED THE WAY AND POINTED THE WAY. THEY WERE DRESSED NICE. BEHIND THIS THICK COUNTER, I COULD SEE A CIRCULAR STAIRCASE THAT YOU CAN WALK UP TO A HIGHER FLOOR.

THERE WAS SECURITY IN ALL AREAS OF THE STRUCTURE. THERE WERE BIG, THICK, HIGH WALLS. IT LOOKED AS THOUGH WALLS WERE BEING BUILT. THIS WAS A NEW STRUCTURE OR ELSE NEW THINGS WERE

VIEWER 079
19 Oct '87

(1)

This document is made available through the declassification efforts
and research of John Greenewald, Jr., creator of:

The Black Vault



The Black Vault is the largest online Freedom of Information Act (FOIA)
document clearinghouse in the world. The research efforts here are
responsible for the declassification of hundreds of thousands of pages
released by the U.S. Government & Military.

Discover the Truth at: <http://www.theblackvault.com>

BEING ADDED TO GIVE THE FEELING THAT THIS STRUCTURE IS NEW. IT SEEMED AS THOUGH PEOPLE WERE PLACED IN SMALL CUBICLES OR SMALL BOX-LIKE AREAS TO WORK IN.

THE WORK HERE IS ON MANY DIFFERENT LEVELS AND I SENSED MANY DIFFERENT DIVISIONS. I SENSED MANY PAPERS. PEOPLE READ PAPERS, WRITE PAPER, AND STUDY PAPERS.

AT ONE LEVEL, I COULD SEE A YOUNGER MAN IN CHARGE OF OLDER MEN. THE WORK HERE WAS OF A TECHNICAL NATURE.

AT ANOTHER LEVEL, I COULD SEE YOUNGER PEOPLE WORKING IN SMALLER AREAS AND THEY WERE CONCERNED WITH MAPS AND ANALYZING INFORMATION.

ALL IN ALL, THE WORK HAD TO DO WITH RECEIVING INFORMATION, STUDYING INFORMATION, AND WRITING PAPERS.

THE PEOPLE WERE DRESSED VERY NICE. SOMETIMES I COULD SEE PEOPLE EATING. PEOPLE WHO WORKED HERE WERE SERIOUS. THE SURROUNDINGS WERE VERY NICE. THE FURNITURE WAS VERY EXPENSIVE.

I RECEIVED MANY DIFFERENT IMPRESSIONS HERE. EVEN THOUGH PEOPLE WERE WORKING FOR THE SAME GOAL, THERE IS DIFFERENT TYPES OF WORK GOING ON HERE. THERE ARE A LOT OF PEOPLE CONCERNED WITH DIFFERENT TYPES OF WORK.

19 Oct '87

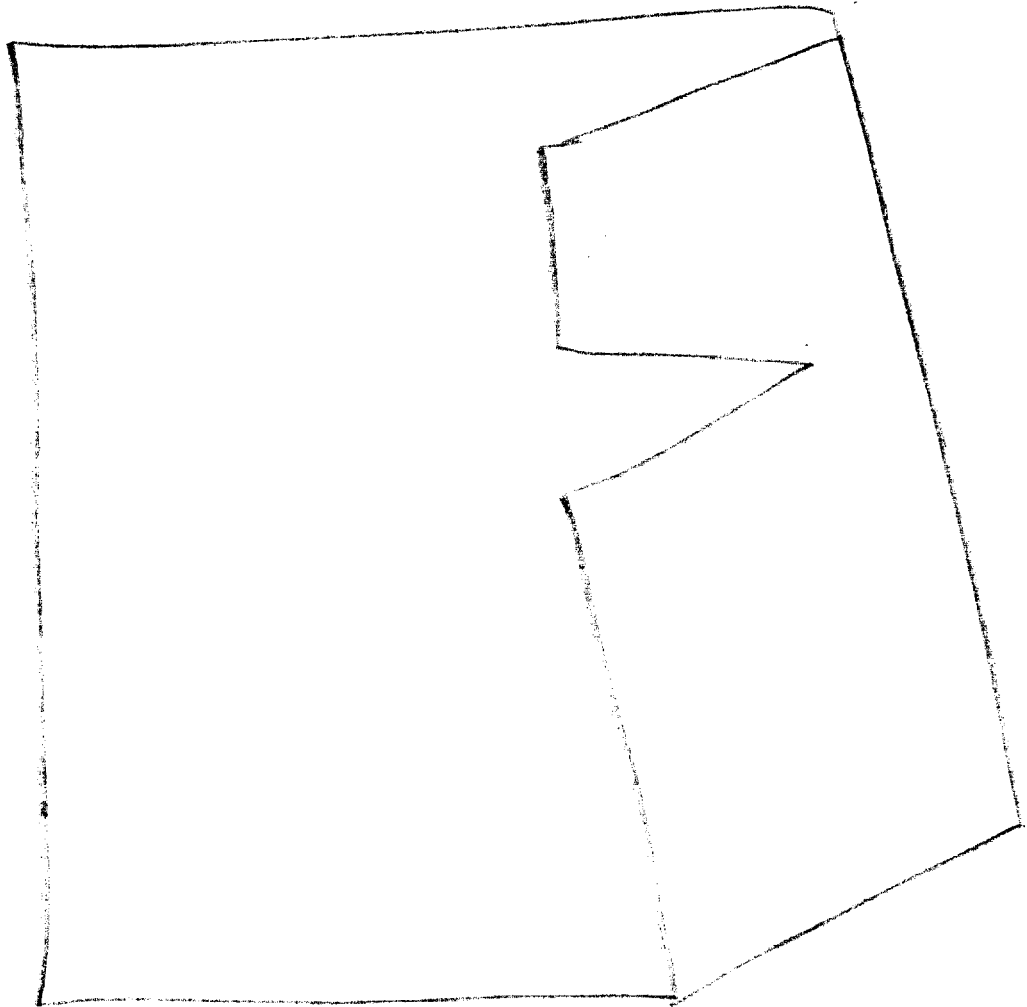

Structure

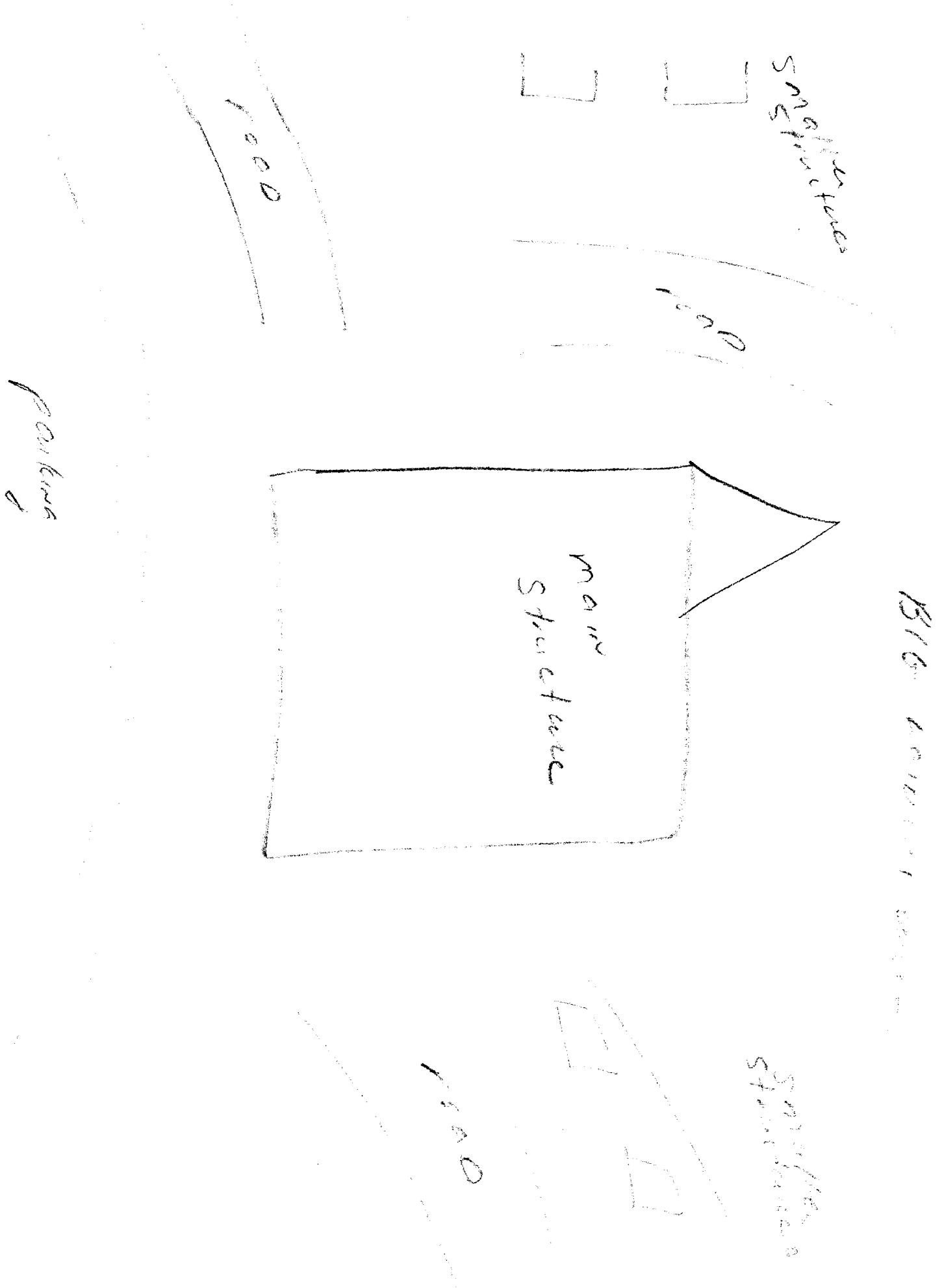

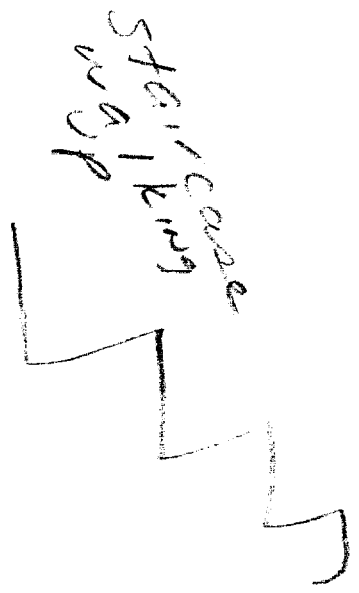
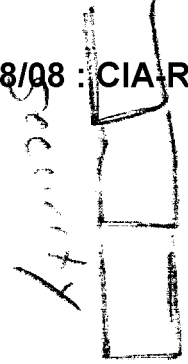

also inside structure

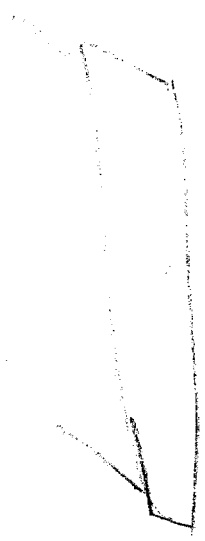
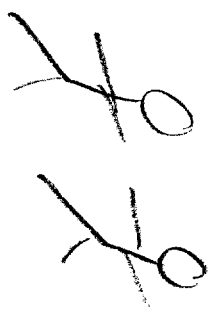
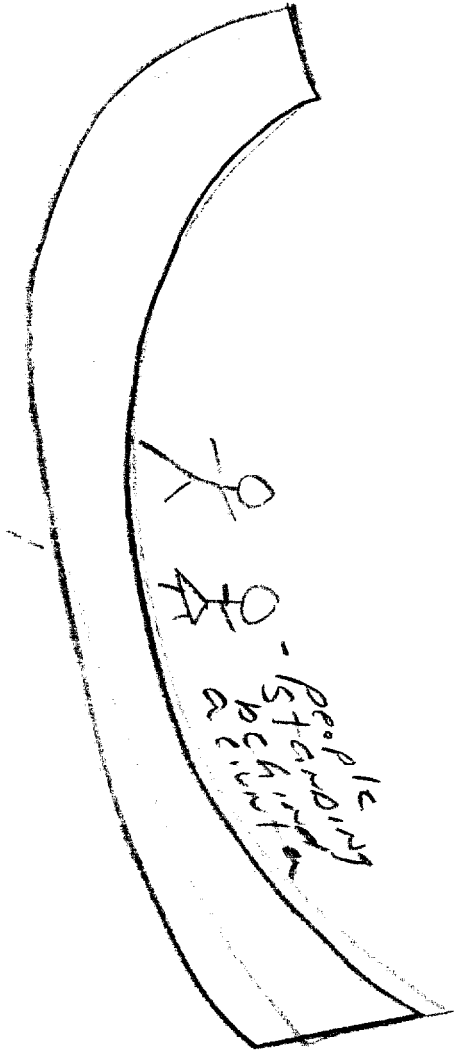

like
cabinets
people
placed
small
back
over
box-like

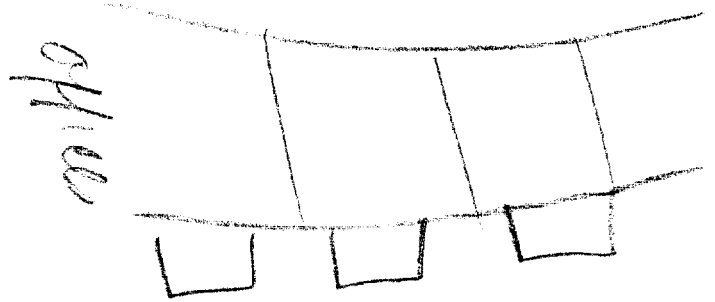

hazy

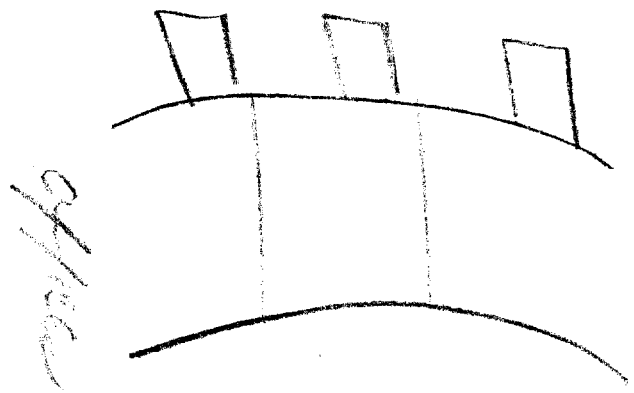

(2)

→ 14752 / 1213

★ MEN ARE WORKING, MEN, FORMING, NEW, COMING DOWN MOTION, A CIRCLING MOTION, HARD, SPINNING AROUND, STRUCTURE, THE WIND IS BLOWING, THE STRUCTURE IS POINTED AND SQUARE, I CAN SEE THE WIND FLAPPING AGAINST THE STRUCTURE. THE TOP IS POINTED. ITS LONG, THICK AND WIDE, THERE ARE MEN INSIDE. ITS GREEN, IT SITS BY ITSELF, LIGHT AND DARK, ITS LIT UP WHENEVER ITS DARK, ITS TRIANGULAR, POINTED, THICK, TALL AND WIDE, ITS NEAR HILLS, HIGHLANDS, PLACED ON A HILL, GREEN GRASS, BY ITSELF

→ CIRCULAR MOTION

★ I DON'T KNOW WHERE THATS COMING FROM

→ TELL ME ABOUT THE ACTIVITY AROUND THE STRUCTURE

★ MEN IN UNIFORM, CLOTHING THEY MUST WEAR, DRESSED UP, WALKING AROUND, ITS CROWDED INSIDE, THE OUTSIDE IS ROOMY, HOMEY, ITS NICE

→ NICE

★ TAKEN CARE OF - STRUCTURE WASN'T ALWAYS USED FOR THIS

→ TELL ME ITS USE NOW

★ STORING, SAVING, HELPING

→ STORING RAW DATA

(3)

★ KEEP MATERIAL HERE THAT YOU CAN'T ALWAYS KEEP AFTER ORDERING, HOLDING HERE, STAYING, KEEPING

→ DESCRIBE THIS MATERIAL STORED HERE

★ BIG, BIG, HEAVY, OBJECTS ARE HERE OR REPORTS OF, TRACKING DOWN, ACCOUNTING FOR, COLLECTING, LARGE, BUSY, BUSY PEOPLE CONCERNED WITH OBJECTS, THE CONCERN, THIS PLACE IS BUSINESS PLACE, BUSINESS PROCEEDINGS GO ON HERE, CLASPING DOWN, HOLDING ON TO, SITTING ON OBJECT - THERE'S SPACE IN THE BACK, ROOM, MAKING SURE THERE IS ENOUGH SPACE, ROOM FOR SPACES, GAPPING,

→ FOCUS NOW INSIDE THE STRUCTURE

★ A LARGE ENTRANCE, LOOKING UP, MEETINGS, HELPERS HERE TO MEET YOU, TELL PEOPLE WHERE TO GO, POINTING, BEING HELPED OUT, THESE PEOPLE ARE DRESSED NICE, FEMALES HERE, THEY WORK HERE, THEY HOLD, MEET PEOPLE, GUIDING PEOPLE -

→ PAUSE, RE-RELAX - THESE THINGS ARE NOT IMPORTANT TO ME. FOCUS NOW ON THE AREA OF PRIMARY IMPORTANCE TO ME. -

★ CIRCULAR AREA, THICK WALLS, WALLS CUTTING OFF PORTIONS, NEW AREA, PUT IN NEW, CHANGING TO MAKE NEW

→ TELL ME ABOUT THIS CIRCULAR AREA

(4)

★ HIGH WALLS, WHITE WALLS, PEOPLE WORKING, PEOPLE WALKING AROUND, HARDLY ANYTHING ON THE FLOOR, BUSINESS AREA, PEOPLE SITTING DOWN THINKING, A BUSINESS AREA

→ BUSINESS AREA

★ PEOPLE MEETING, PEOPLE PLANNING, PEOPLE TALKING, PAPERS HERE, CONCERN WITH PAPERS,

→ TELL ME ABOUT THE PAPERS

★ WHITE PAPERS, READ BY MANY PEOPLE, PEOPLE READ THEM TO SEE THE INFORMATION, A LOT OF PAPERS, FINAL PAPERS

→ PAUSE - MOVE AWAY FROM THIS AREA. DESCRIBE THE AREA THAT INTEREST ME - THE CURRENT ACTIVITY

★ PEOPLE TALKING, RE-HASHING, NEW INFORMATION, TAKING OUT THE OLD,

→ PAUSE - BACK OUTSIDE - START OVER

★ SQUARE, POINTED, THICK, NOT IN THE CITY, SITS BY ITSELF,

→ TELL ME ABOUT THE ACTIVITY

★ PEOPLE WALKING IN, PEOPLE, SERIOUS PEOPLE, WALKING IN AND OUT, THESE PEOPLE WANT INFORMATION, THEY GO THERE TO RECEIVE INFORMATION, STRUCTURE, SITS BY ITSELF - THERE'S - A NATURAL SETTING, WITH ROAD NEARBY -

(3)

→ Purpose of this structure

★ People being met, people going in and getting help, people here, help other people, helpers are placed behind part - looks like counters, shelves, placing them, the helpers help people coming in - upper floors -

→ Pause - take a moment or two - stop reporting move around the structure - learn the structure. now - focus only in the activity which concerns me -

★ There's many different levels. There's a man working by himself, nice

→ nice

★ Surroundings are nice - upper levels, higher floor, he's in a higher floor, sitting with a window on his side, he sits and meets and talks to people - sits in a big chair - speaking, thinking planner - a younger man, younger than those around him, managing many different things

→ Pause - This man does not interest me - Focus only on the activity that interest me -

★ There's much activity here, mental activity, studying, reporting, observing, -

→ Tell me about the things they observe

★ Others, others, studying, people walking, talking, spaciousness, very big, there's a lot going on here

→ Describe these things

(6)

★ People, levels, a security

→ Security raw data

★ Area is secured, paperwork, different levels, men and woman working,

→ Tell me about the work

★ Reading, Reporting, writing, many specialist - People placed into divided areas, unusual working in areas, split up - concerned with strategy, looking ~~into~~ into, future developments -

→ Go to another level - Describe the activity

★ more crowded, people working closer together, quiet, putting away, shutting in

→ Explain to me shutting in

★ Shelving, information

→ Go to the next level

★ I need time because I'm repeating - On area where its quiet, man standing, crossing his hands, a man sitting crossing his hands, casual dress, physical work, obedience, circular area,

→ tell me about this area

①

★ Its not crowded, Big, spacious, one or two men are here, matted,

→ Raw data

★ yw can pull up, a man pulling up, shooting, pulling, physical work

→ The work

★ Training, precision, being precise, used for protection, its clean in here,

→ tell me about here

★ In the large area, glass, in a lower area, dark, lighting that is controlled, practicing, training, men being made ready to go - men prepared,

→ tell me about the activity

★ men standing in line, making noise, being armed, younger men

→ Armed

★ wearing underwear -

→ next level -

★ I'm outside

→ Focus around the area

★ green grass, people walking -

Handwritten scribble

~~SECRET/NOFORN~~

PROJECT SUN STREAK

WARNING NOTICE: SENSITIVE INTELLIGENCE SOURCES AND METHODS INVOLVED

PROJECT NUMBER: 8713 SESSION NUMBER: 3

DATE OF SESSION: 27 Oct '87 REPORT: 27 Oct '87

METHODOLOGY: ERV VIEWER IDENTIFIER: 079

1. (S/NF/SK) MISSION: Describe the nature, scope and purpose of the activity at 14752/1213.

2. (S/NF/SK) VIEWER TASKING: Based on results of previous two sessions, access "multi-level structure" described as "hard deep with sides that are round" and describe the nature, scope of activity and personnel involved.

3. (S/NF/SK) COMMENTS: No inclemencies noted. Contrary to what is being reported by other viewers, there is a conspicuous absence of water even though one of the structures described resembles a submarine. 079 describes the round (submarine) as being parked within a huge rectangular cement structure. 079 described anew the presence of an elitist group, a "handful" of VIP types. 079 also described an activity surrounding the presence and use of "silvery objects" that can be launched and subsequently hit by "rays of light" (at a high altitude). Session Number 4 will be initiated from the multi-level structure and the activities of the larger group of personnel will be pursued; also the flag (piece of cloth) will be identified.

SG1J



HANDLE VIA SKEET CHANNELS ONLY
SPECIAL ACCESS REQUIRED

~~SECRET/NOFORN~~

CLASSIFIED BY: DIA (DT)
DECLASSIFY BY: OADR

Handwritten notes:
Ag... may come
for... control
... ..

SOURCE 079
27 OCT 87

THE OUTSIDE OF THE STRUCTURE WAS BIG, LARGE, SQUARE, POINTED WITH A FLAT ROOF. THE STRUCTURE HAS MANY SIDES WHICH ARE FLAT, HARD, SMOOTH, AND ROUGH.

THE AREA SURROUNDING THE STRUCTURE IS OF NATURAL LANDSCAPE (GREEN GRASS, TREES, HILLY) AND THE AREA CLOSE TO THE STRUCTURE IS HARD AND CEMENTED. THE WHOLE AREA IS LAID OUT FLAT AND AS ONE GETS CLOSER TO THE STRUCTURE YOU CAN SEE CEMENT ROADS AND PARKING. I COULD SEE PEOPLE WALKING AROUND AND NEAR THE STRUCTURE ENTERING IT AND LEAVING. THIS AREA HAD A BUSINESS FEELING TO IT. I COULD SEE VEHICLES DRIVING BACK AND FORTH ALSO.

THERE WERE SMALLER STRUCTURES PLACED WITHIN AND AROUND THIS BIG AREA AND THEY SUPPORTED THE MAIN OR BIG STRUCTURE. THEY SERVE THE ROLE OF SUPPORTING.

WHEN I RECEIVED THE IMPRESSION OF PARKING, I GOT CONFUSED. AT FIRST I COULD SEE MILITARY VEHICLES AND THEN I SAW REGULAR VEHICLES AND THEN I SAW LUXURY CARS. LATER ON AT ANOTHER POINT I COULD SEE MOTORCADES. AT FIRST IT LOOKED AS THOUGH THESE VEHICLES WERE PARKED SEPARATELY AND THEN WITHIN THE NEXT SECOND, IT LOOKED AS THOUGH THE VEHICLES WERE ALL PARKED TOGETHER. THEN I KEPT SENSING THAT SOME OF THE VEHICLES ARE DISGUISED OR HIDDEN AND THEY ARE USED FOR PURPOSES THAT ARE NOT BEING TOLD. THIS IS A SECRET.

AT THE BACK OF THE STRUCTURE, IN A SEPARATE LOWER LEVEL, IN A CIRCULAR AREA, I COULD SEE MEN DOING HARD, PHYSICAL WORK.

THESE MEN WERE PUSHING OBJECTS FORWARD AND SLIDING OBJECTS THROUGH. THEY WERE SPREADING OUT AND MAKING PREPARATIONS. I SAW A ROUND, SMOOTH, HARD, HEAVY, THICK OBJECT HERE LAYING OUT. THE INSIDE OF THE OBJECT WAS THE SAME AS THE OUTSIDE. HOWEVER, ONCE I WAS INSIDE OF THIS OBJECT, I COULD SEE SHINY SILVER BLOCKS PADDING THE INSIDE AND IT WAS NARROW. THE OUTSIDE OF THE OBJECT WAS MORE DULL IN COLOR. ALSO, ONCE INSIDE, IT LOOKED AS THOUGH THE OBJECT TOOK ON A TUBULAR LOOK AND ONLY ONE MAN COULD STAND OR ENTER IT AS A TIME. IT LOOKED AS THOUGH YOU HAD TO LOOK UPWARD TO GET OUT OR TO SEE OUT. WHEN THIS OBJECT IS IN USE, IT IS SPREAD OUT AND A MAN-MADE LIGHT FROM A MAN-MADE VEHICLE HITS THE OBJECT AND THIS LIGHT CAN CUT OR SLICE THE OBJECT. THIS IS A SOPHISTICATED TECHNIQUE AND THERE IS ALWAYS PLANNING AND TRAINING AND PREPARATIONS CONNECTED WITH THIS OBJECT AND ITS WORKINGS.

WHEN ASKED TO ACCESS ANOTHER ACTIVITY OF THIS SITE, I SENSED A HANDFUL OF MEN WHO WERE OLDER AND CONSERVATIVE AND VERY POWERFUL. THEY WERE HIRED BY A MAN HIGHER IN STATUS THAN THEMSELVES AND WERE CHOSEN TO DO A JOB WHICH CONSISTS OF GOING OUT AND MEETING WITH PEOPLE AND GOING OVER PAPER WORK. THESE MEN ARE CONCERNED WITH ISSUES OF A POLITICAL NATURE. ALTHOUGH I COULD SENSE THAT THESE MEN WERE SOMEHOW CONNECTED TO OR CONCERNED WITH THE MILITARY, THEIR PRIMARY ROLES ARE POLITICAL. THESE MEN ARE CONCERNED WITH TRYING TO PRESERVE A SYSTEM THAT IS VERY OLD. THIS SYSTEM HAS SOMETHING TO DO WITH A CULTURE AND THEIR PAST HISTORY, WEALTH, AND RELIGION.

I KEPT SEEING MEN DRESSED UP IN COSTUMES DANCING.

Structure

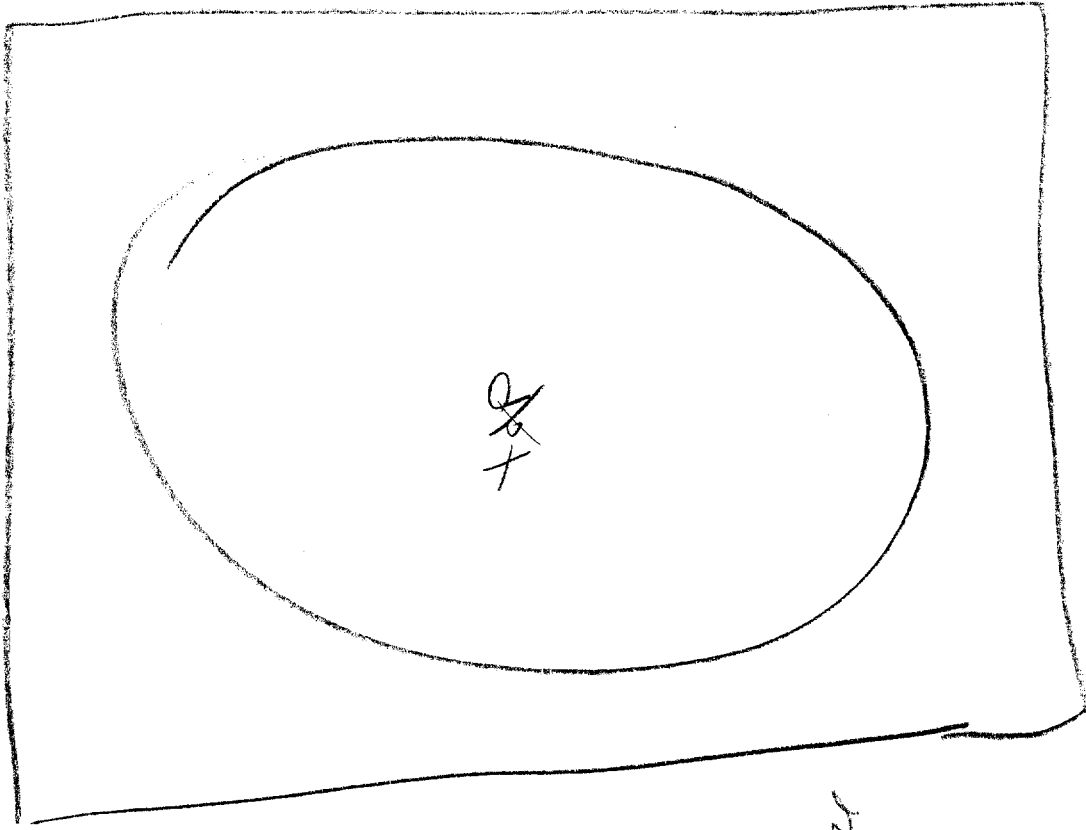

TOP VIEW

Rectangular

of

Circular in front

plus

other circular area

behind

principal structure

writings
on wall

flat roof

DISCOUNTS

Side

Side View
of
multiple structure

Handwritten scribbles

Structures outside of structure

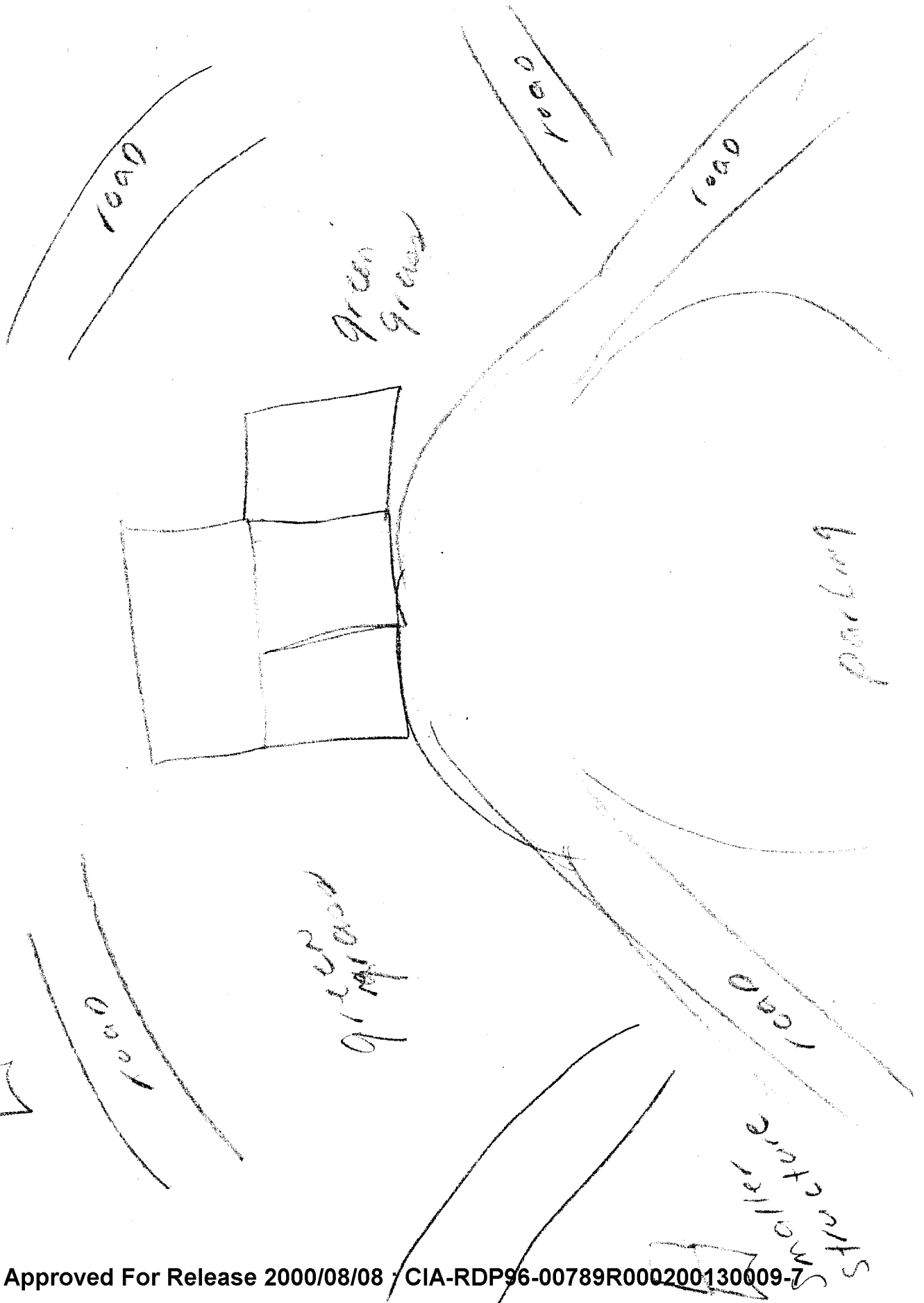

green grass

grass

parking

Structures

Area inside
Structure
men work

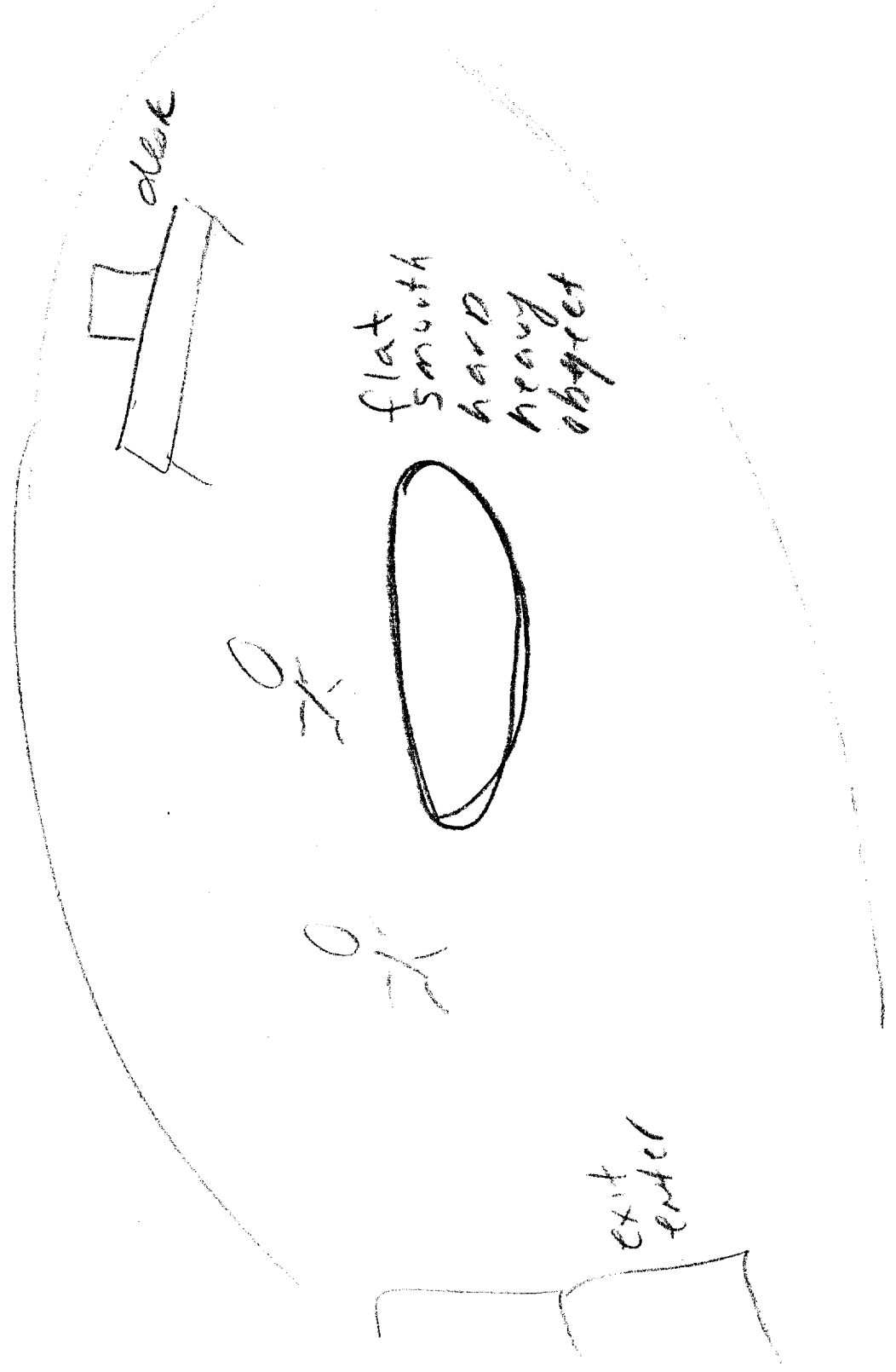

Shroud of
object

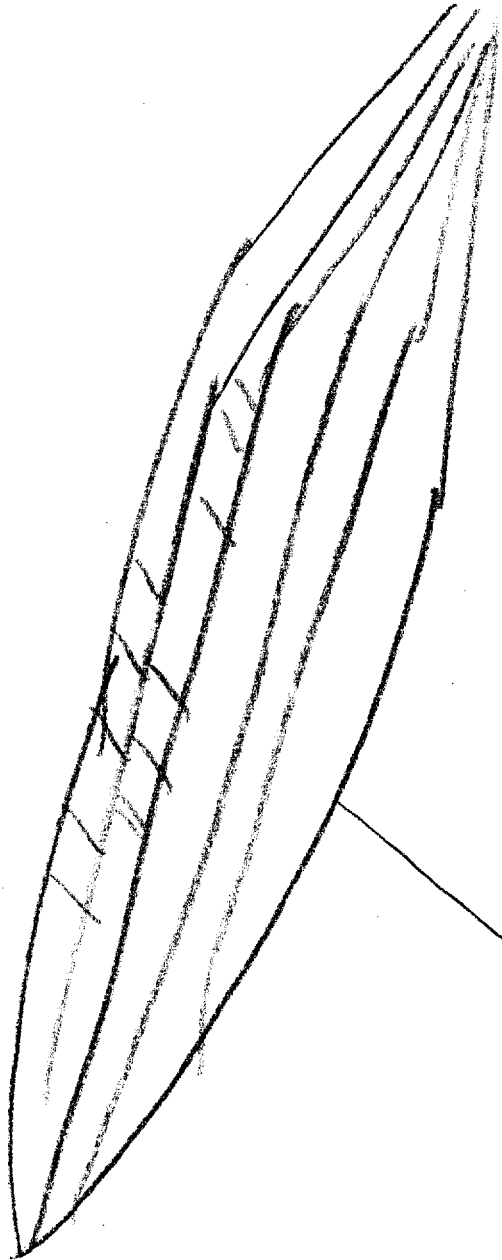

OBJECT UNFOLDS
INTO FLAT
SURFACE AT
DESTINATION

Object - Laid out - Flatter

Object
spread
out
men
preparing
this.

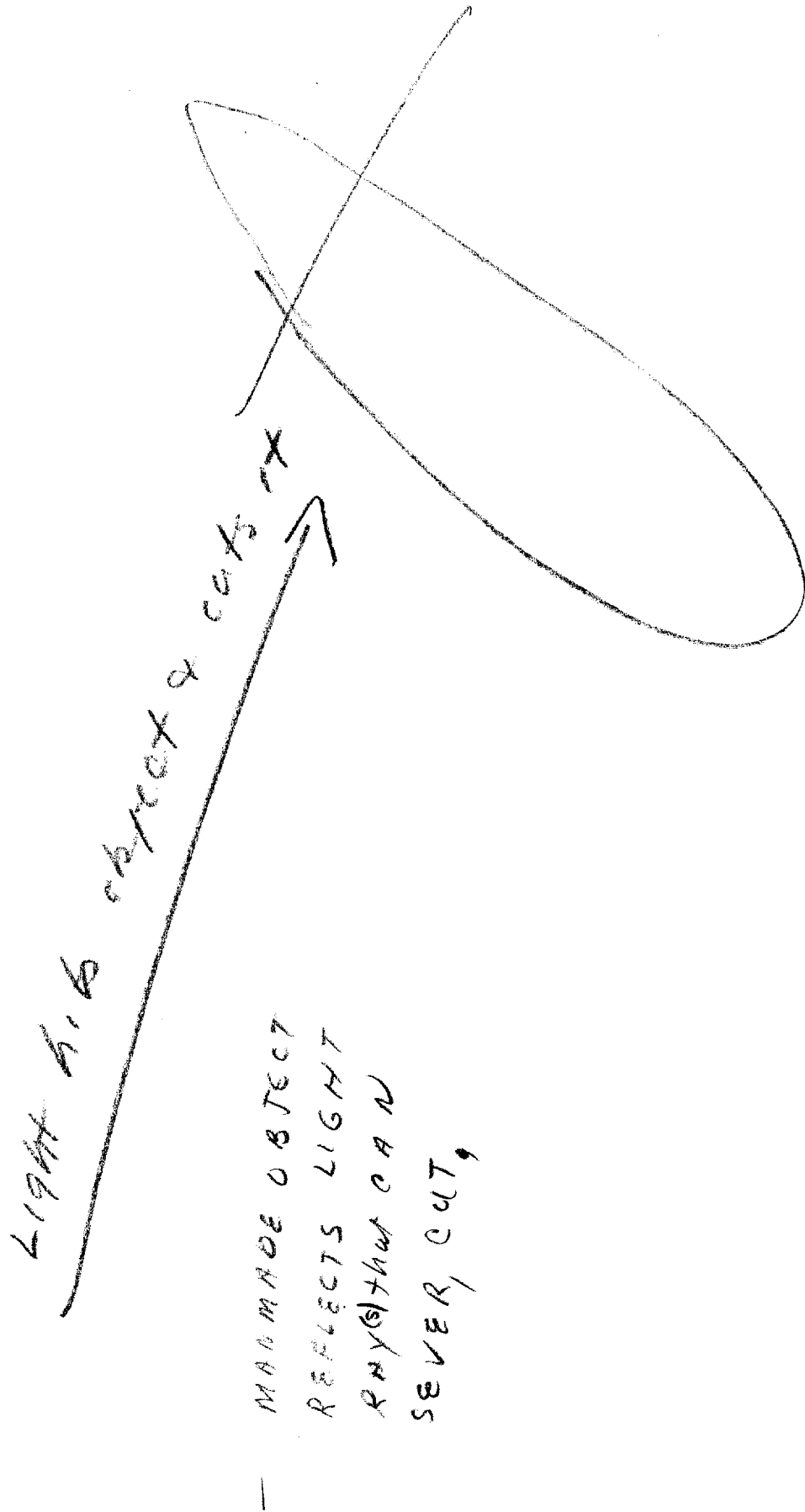

27 Oct 87

8713

079

Out 1035

IN

Prebrief: Operational
~~Prebrief~~ ~~operational~~

Reference previous sessions when you accessed a multi-level structure with lower levels - described as hard deep with sides that are round

⊖ I'm in sanctuary (1045)

→ We will now access the multi-level structure you have previously described.

→ Access this structure - become familiar with ones - I will wait for your report

⊖ Square - inside - round circular - men working at a lower level - push stone thru sliding objects - move out. Man in chair - supervisor - Object circular but smooth bumpy - notched -

→ Object

⊖ circular smooth - men spreading out = object + not being used rock heavy - can be picked

→ Inside the object?

⊖ Soled thick - similar to outside - marked squares that no walls but heated, heated - silver shiny function?

→ Contain - held in keep + here - narrow one man car span inside - light may hit this object - light at a distance - ray of light. (A)

→ Describe reaction when ray of light hit it!

⊖ Cuts cut - smooth cuts
 sawn off - becomes wide - emits at long distances - preparati for all of this to occur - plan light is forceful and big - light. (A)

→ follow light to source

⊖ Approved For Release 2000/08/08 : CIA-RDP96-00789R000200130009-7

⊖ convey from another object - controller used

when plan comes from another aspect.

- Reaccess structure

→ No thing the walls look back -

⊙ square, thick hard - tall very tall
crossing long narrow

→ Outside

⊙ All slant - smaller structures
very very square.

⊙ hard cement ched sharp rough
wide - different sides - coming across
vertically horizontally - parking

→ parking?

⊙ Disguised, hidden, normal, used in
other ways - authority - drug.

- hard cement, making green land -

→ Fifty feet down -

⊙ - Area secluded, - seen - Street

→ Texture of

⊙ lower structure, support

→ Purpose

→ Support help out big street

→ Reaccess structure describe distinct
activities (ies)

⊙ People - teaching very important people
people being taught - brought in
teaching - people being pulled up -

→ Describe people making/preserving

Thinking over ~~the~~ many current situation

A

⊖ Take out - hit - pull out - hit rear out
going out hit down hard smart p.
they won't do the no alternate
they change their minds - make decision
they don't have to go by facts - human
study -

→ second distinct activity - report at you en-

⊖ men here w/ high posn served dressed
peched - up - driver around - protected
high level.

⇒ How many

- Wonderful - black - suits - thick man
black hair - rides car - open car - black
coat - warm coat - other men shorter -
very very intelligent - in this LINE OF
WORK -

⇒ system?
Political than military - chosen
same goal - good

⇒ re terminate goal?

⊖ each go different way take care
of different things - make decisions
behind them IAW policy set.

→ common purpose for them!

⊖ Effect - work - gaining - receiving
already put down what has already
been determined - doing things -
addressing separate issue - goal is
to preserve - strength - insure
everything stays in place to insure
no change, preserve what already
is - don't want it.

→ assess & describe that which they do not
want to do

preserve
way of
life

working with a system - expect for a long time

- System?
- ⑥ conserve - power - strength - survive
older men run the system.
wealth - wealth - religious
feeling → not concerned with
already have.
- We have accessed elite group & next time we will
access the greater group.
- Go to sanctuary 1122
- You will feel fresh and alert 5-4-3-2-1 (1130)

SG1J



30 Oct 87

~~SECRET~~/NOFORN

PROJECT SUN STREAK

WARNING NOTICE: SENSITIVE INTELLIGENCE SOURCES AND METHODS INVOLVED

PROJECT NUMBER: 8713 SESSION NUMBER: 4
DATE OF SESSION: 29 Oct 87 DATE OF REPORT: 30 Oct 87
METHODOLOGY: ERV VIEWER IDENTIFIER: 079

1. (S/NF/SK) MISSION: Describe the nature, scope, and purpose of the activity at 14752/1213.

2. (S/NF/SK) VIEWER TASKING: Based on results of Session Number 3, re-access target site, specifically, access the multi-level rectangular structure. Determine and describe the flag (flying piece of cloth). Describe the second, larger group or personnel.

3. (S/NF/SK) COMMENTS: Viewer 079 confirmed the nature of the structure, the ongoing activity, and the personnel involved. The norther nordic quality of the site surfaced as a result of the dress and language of the personnel accessed. Attention was refocused on the "special nature of the project (mission)." The project mission will serve as a basis to launch 079 in what would appear to be a last viewing session on this project.

SG1J



HANDLE VIA SKEET CHANNELS ONLY
SPECIAL ACCESS REQUIRED

~~SECRET~~/NOFORN

CLASSIFIED BY: DIA (DT)
DECLASSIFY BY: OADR

SOURCE 079
29 OCT 87

Summary

DURING TODAY'S SESSION, THE INTERVIEWER FIRST ASKED ME TO DESCRIBE THE FLAPPING CLOTH WHICH I REPORTED IN AN EARLIER SESSION. I SHALL REFER TO THIS PIECE OF CLOTH AS A FLAG. I FIRST REPORTED THAT THE FLAG WAS OUTSIDE AND WAS FLAPPING. I COULD SEE MEN HOLDING THE FLAG. THE FLAG WAS WHITE AROUND THE EDGES, AND IT HAD BLUE AND RED STRIPES GOING UP AND DOWN AND THE CLOTH WAS NEATLY PRESSED. OVERALL, I RECEIVED THE IMPRESSION THAT THE FLAG CARRIED A SYMBOLIC MEANING AND REPRESENTED A GROUP OF MEN OR AN ORGANIZATION. THE MEN WHO WERE ASSOCIATED WITH THIS ORGANIZATION CAME FROM A COLD COUNTRY AND WERE NORDIC. I COULD SEE THE MEN DRESSED UP IN SOMETHING LIKE A UNIFORM BUT THE COATS THEY WORE WERE BIG AND HEAVY AND FURRY AND THEY HAD ON TALL, BLACK, FURRY, HATS. IT LOOKED AS THOUGH THEY WERE A YOUNG GROUP OF MEN DRESSED UP IN VERY OLD UNIFORMS. THE BIGNESS AND HEAVINESS OF THE UNIFORMS HID THE MEN. THE MEN SPOKE WITH SHORT SYLLABLES. THEY WERE A DISCIPLINED GROUP. THIS GROUP OF MEN HAVE RECEIVED HONORS AND REWARDS AND HAVE HAD EXPOSURE. THEY ARE A SPECIAL GROUP AND THEY PRACTICE HARD AT WHAT THEY DO. THEY HAVE EXTENDED THEMSELVES BEYOND THE NORMAL LINE OF DUTY. THEIR JOB HAS SOMETHING TO DO WITH GUARDING AND THEY ARE SOMEHOW CONNECTED TO WATER.

WHEN ACCESSING THE STRUCTURE AGAIN, I REPORTED THAT THE STRUCTURE WAS FLAT, HARD, SMOOTH, ROUGH, AND ROUNDED. THE AREA SURROUNDING THE STRUCTURE OUTSIDE IS CLEAN AND NEAT.

8713
VIEWER 079
29 Oct 87

WHEN INSIDE THE STRUCTURE, THERE WERE MANY MORE HALLWAYS AND SECTIONS THAN I PREVIOUSLY REPORTED IN EARLIER SESSIONS.

I THEN FOUND MYSELF IN THE CIRCULAR AREA WHERE THE MEN WERE WORKING WITH AN OBJECT. I THEN RECEIVED THE IMPRESSION THAT THIS OBJECT WAS NEW AND THAT IT HAD A SPECIAL MEANING OR PURPOSE AND THAT IT WAS A SPECIAL PROJECT. I COULD THEN SEE THE MEN OUTSIDE WORKING WITH THE OBJECT. IT WAS SQUARE, BIG, HEAVY, AND IT WAS MAN DRIVEN. IT HAD A LONG, TUBULAR PIECE STICKING OUT OF THE BACK WHICH REMINDED ME OF A GUN. I THE RECEIVED THE IMPRESSIONS OF MIXING, REFUELING, AND POCKETING THAT WERE ASSOCIATED WITH THE OBJECT.

8713
VIEWER 079
29 Oct 87

①

Flag

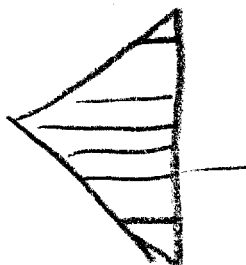

blue &
red stripes
white border

①

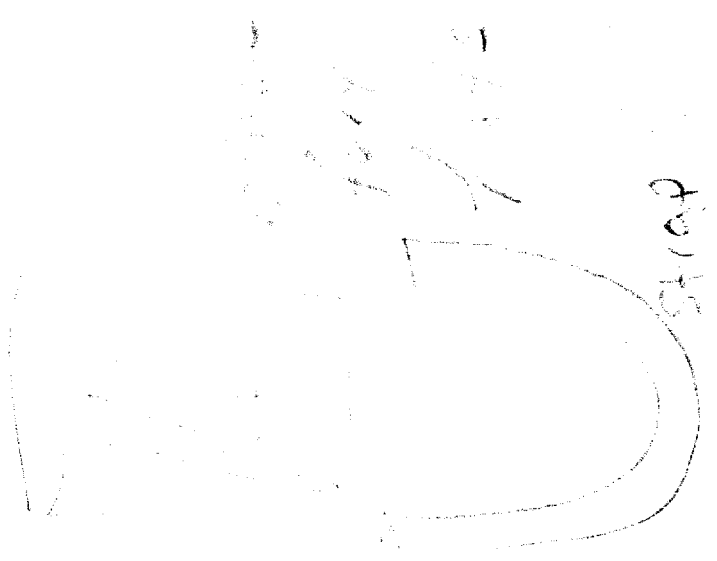
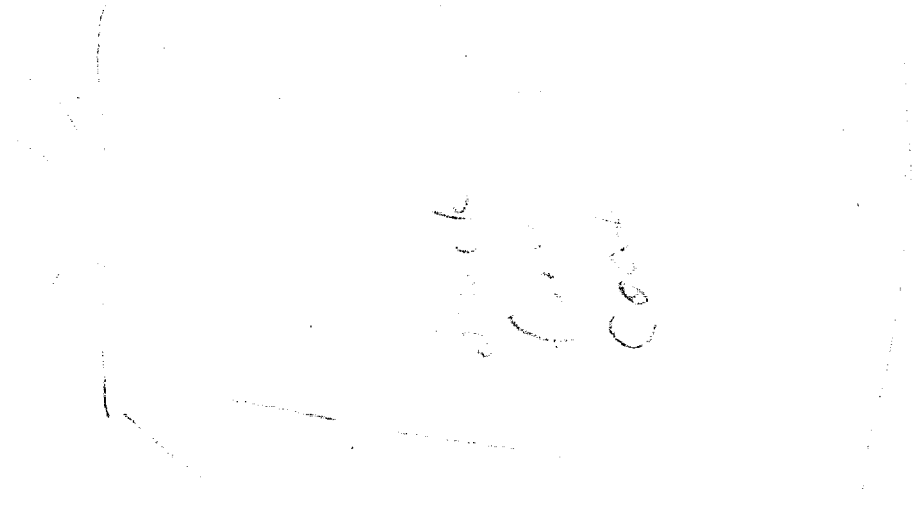

3

Missile structure

missile structure
& a copy of the
records

5

cbj/ed

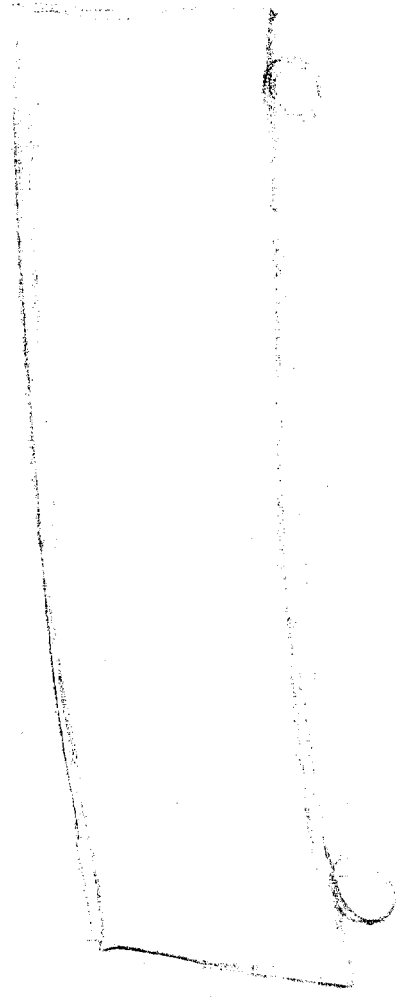

OK

079
29 Oct 87

Out 1136

In

⊖ I am in sanctuary - (1143)

Inclomence

→ Very well, I shall return to get you in 5 min.

→ (1148) your body is relaxed your mind is alert. While remaining alert, tell your body to let go.

⊖ Flaps - up - white around edge blue + red gear down - up - well - core for - pressed

→ follow the flag

- man handle it - steady up - folding - men well hongan flapper up by out side by steel - stand by itself - represents group of men organized - not universal - not with people

→ Ethnic boy

⊖ red, cold country, old, tall white light eye dressed up - big guy red coats - tall hats

→ Speed

short syllables - discipline group with connection with WATER. men guard in old old uniforms - clothes hides them
→ access one person

⊖ practice, exposure, honors, rewards important people - belonging to this very good feeling - Clean group - respect fun - good time - special understanding - each other -

→ they are not
⊖ Team discipline group then

excludes themselves

o land/ceremonies, land many away guy
away upward -

→ reward!

o special group brought in at day
guarding - meters

→ weather bad bad

o exposure - people would like precise next
honorary county - for further - on the
this will be any -

→ name of indiv

o YOLVE -

→ access multi-level structure - other now!

o back

→ front

→ turn around up

o flat-land - 3 structures rounded ←

→ other details

o mainly outside - pretty - area clean - next
inspecting

→ access inside multi-level structure.

o more walkways, rounded lines
section off large previously thought. see
hard str -

→ Describe object in

o placed inside - man touch it - run across -
new utilized, special means purpose

→ Describe main purpose utilized

o had plan repress -
semi type of vehicle small not full-sized

→ Res of vehicle

o Driver pointed part out to out w - parts out
fers square had my 4 4

→ follow when on

o On land to wait and capture.

→ Destination

o Outside - nature setting men with it - men
not dry it.

→ Turn on

→ Describe what happens when it's turn

o Hurt people - slowly - mixing together
mixing - putting in little strong containers
weighing. - pocketing put into little square
little squares - refueling - doing again.

→ final destination

o Rp - in - siding in - project (1221)

Sanctuary

1222 to 1

Covert back - feel good refreshed alert

DETERMINE Structure from data.

26887

need to

- access the multi-level structure, big, rectangle.
of square, flat, roof - w/ many flat hard.
smooth rough sides.
 - landscape w/ grass trees hills.
 - smaller structures
- Explore the soft cloth material
 - allow colors to fill-in
 - allow geometric patterns to appear & outline
 - allow symbols of patterns & colors to sit.
- ~~Access~~ Previously accessed the cluster flow
 - need to access big group
- Globe and space -
- pinpoint geographical location.
- ~~Activity~~ Essence of the current, ongoing activity is the issue of significant interest -
- Sanctuary +

~~SECRET~~/NOFORN

14752/1213
- *Wongula*
- *cylindrical*
bird.

PROJECT: 8713

VIEWER 079

REFERENCE SESSIONS DTD 6 Oct '87 and 19 Oct 87.

- STRUCTURE THAT IS VERY BIG, HARD, DEEP WITH SIDES THAT ARE ROUND - A MULTI LEVEL STRUCTURE WITH LOWER LEVELS.
- MEN WORKING WITH BIG HEAVY OBJECTS - A STORAGE AREA CONNECTED WITH THE BIG HEAVY OBJECTS.
- TECHNICAL NATURE OF WORK - DIFFERENT TYPES OF WORK GOING ON .
- STRUCTURE PREVIOUSLY USED FOR A DIFFERENT FUNCTION
- SOMEWHAT YOUNG MAN WITH A MUSTACHE AS BEING IN CHARGE AND SITTING IN A COMFORTABLE CHAIR AND DIRECTING A PRINCIPAL ACTIVITY.
- ~~TECHNICAL NATURE OF WORK~~ - ~~SEPARATE THRUSTS~~ - ~~NATURE~~

NEED TO EXPLORE THE SURROUNDINGS - SIDES - BELOW - ABOVE - FEEL TASTE - SEE - HEAR - ODORS.

flag
other
groey

flag

Director
the top
bottom of
world

attracts

+ need to explore ^{not cloth material} piece of cloth

+ location -