

2

~~SECRET~~/NOFORN--SKEET CHANNELS ONLY

PROJECT SUN STREAK (U)

WARNING NOTICE: INTELLIGENCE SOURCES AND METHODS INVOLVED

CRV Session Procedures Report (S/NF/SK)

Control Number	: 8702
Date of Session	: 22Jan87
Date of Report	: 29Jan87
Source Identifier	: 003



1. (S/NF/SK) Tasking: See original tasking data sheet (attached). Per ops officer, source had probably acquired the site during his last session, but not necessarily the correct target building; more data needed.
2. (S/NF/SK) Session: Session result should be discounted; monitor, while waiting for source to arrive, attempted to remote view the site, thereby overlaying the session (at least subconsciously) with signal line noise. Also, monitor interrogated source during this session, disturbing structure.
3. (S/NF/SK) Summary: AOL Drive (probably monitor-induced) of "high tech composite aircraft/secret project".
4. (S/NF/SK) Feedback: None provided source.

SG1J

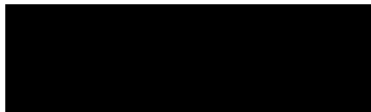

CPT, USA

~~SECRET~~/NOFORN--SKEET CHANNELS ONLY

CLASSIFIED BY: DIA-DT

DECLASSIFY : OADR

This document is made available through the declassification efforts  
and research of John Greenewald, Jr., creator of:

# The Black Vault



The Black Vault is the largest online Freedom of Information Act (FOIA) document clearinghouse in the world. The research efforts here are responsible for the declassification of hundreds of thousands of pages released by the U.S. Government & Military.

**Discover the Truth** at: <http://www.theblackvault.com>

Project FY 8702

Interviewer/Monitor Tasking

1. Describe the structure known as "Building C",  
SG1A

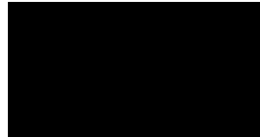

Note: "Building C" is in a complex of other lettered (A, B, etc.) buildings. "Building C" is "the most unusual at the complex."

2. To be announced

Paul  
22 Jan 8  
F. Meade, et al  
Ed  
0908

456 200  
633160

S2 D A2 E1 T I AL A15

As the  
chills

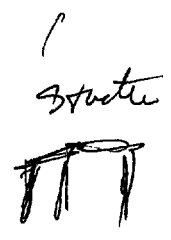

df  
bed

bumpy  
man

brown  
not  
red

tall  
wide

long  
head

green

flat  
wa  
open

brassy

A I Be  
slight feeling  
of exhilaration  
by being in open

52

scrutop

sloping



Space  
inside

like  
airplane  
hangar

white  
shiny  
smooth  
rounded

like  
swords  
long  
thin  
round



like  
ribcage

people  
working

underway

underway

54 1/2 underside - not exactly in "spy" sense - like you & their work  
are to be passively-protected from outside observation.

54 1/2 has to do with an apparatus or machine of some sort.

Slack

high tech

not  
metal

Composite

54 1/2 when you know it, it's hard, strong, light; slightly  
flexible, but doesn't sound like or feel like any sort  
of structural metal. Has the feeling of craftsmanship  
& high quality & quality design. Pleasing in its  
contours & feel.

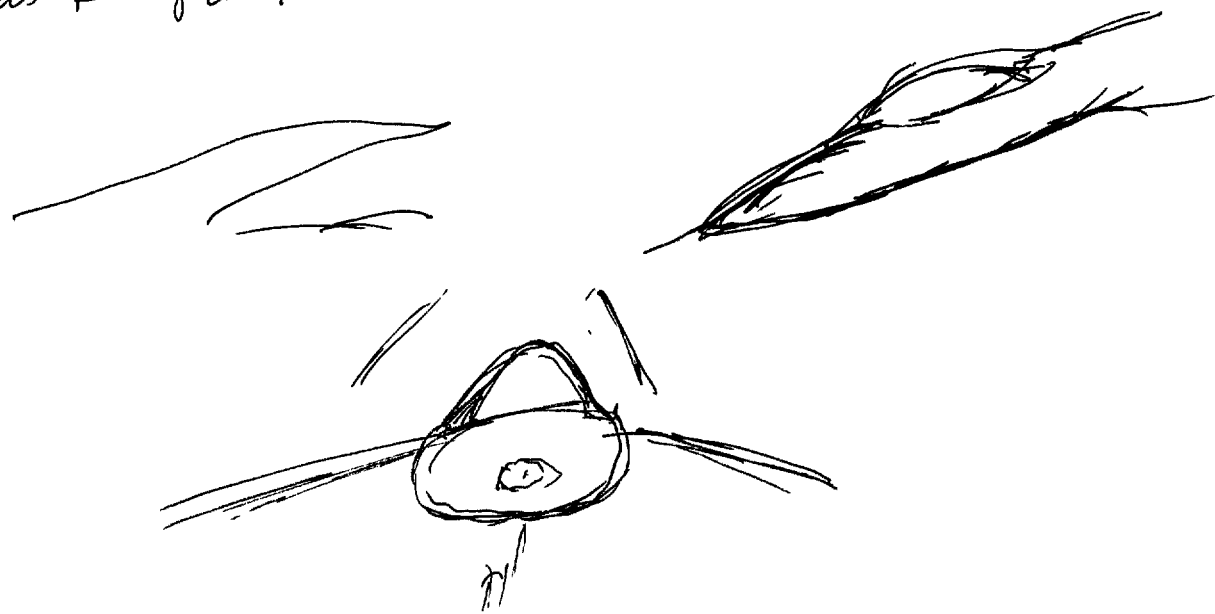

Squatty  
with section

Experimental  
semi-operational

52

B A I T I AOL AS 5

I think  
it flies  
hasn't yet  
but is  
interesting  
to.

S 4 1/2 Unusual slope or direction or orientation to  
bearing + control surfaces. There are some  
unexpected non-curved angles.

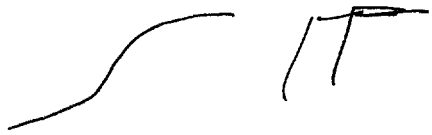

lowes

supt

alloy  
tungsten

spacing

luntds



S 4 1/2 relatively small in proportion to others of its  
class or category



S 2:

framework  
on top

support by

electronics

high  
up

rails,  
platform  
corrugated  
steel

hinged  
door

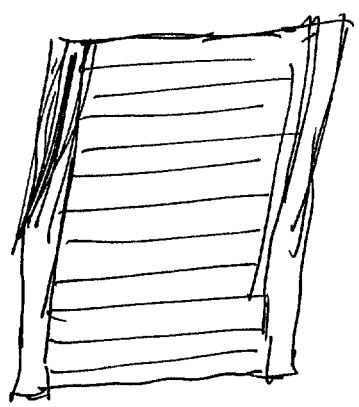

wie ein  
Schubladen  
Rollladen

doors  
open  
ingers

5 1/2 not for identification components - they go through

finished object.

SUI

52

D

A2

F1

T

I

AOL

#6

several  
structures  
bliss

large open  
areas

flat  
spread  
out

round  
squares  
lands

large  
complex

windows

S4<sup>1/2</sup> part has lots of windows. Part doesn't  
have any.

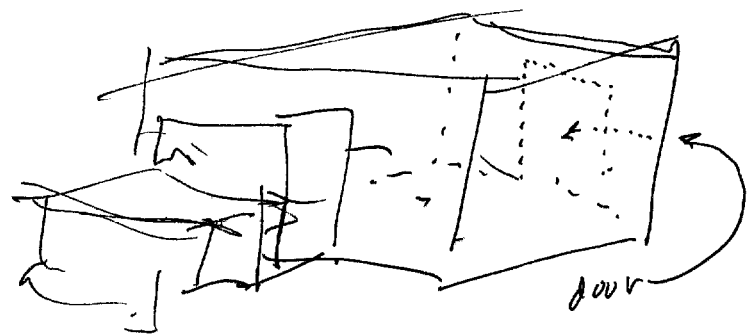

-like a couple structures combined in one. smaller

"dense" structures w/ smaller rooms attached internally to larger  
"spacier" structures w/ a few a one large room.

function

S4/2 function seems to be integrated effort (R&D engineering, design, prototyping, production) to go from concept to final product; not volume production but high prototype production.

summary

Site involves large flat open areas reminiscent of  
 a field, w/ large + small structures associated. Site occupies  
 extensive territory. One structure is notably large,  
 but seems an ~~an~~ amalgamation of a couple of  
 structures into one for one overall purpose. ~~One~~ portion  
 of structure is smaller "den" - various small rooms with  
 closer association of people. Other part is large +  
 "Spacious" - consists of a few, or perhaps only one  
 large "room" or bay. A <sup>way</sup> door that "rolls up" - like a  
 German "Rolladen". This door is not used to admit  
 constituent parts - They come through other access.  
 This door allows ingress + egress of finished  
 product, which is light-grey or white, smooth,  
 tapered, curved, shiny painted part transparent  
 with planes + surfaces that are curved, slopes  
 slanted, ~~smooth~~ swept + angled. It moves  
 smoothly along ground, but suggest strong AC  
 + Aircraft.

Experimentation + semi-operations are element  
 involved. Materials of object are hard, strong  
 smooth, but don't sound metallic when struck.

0745

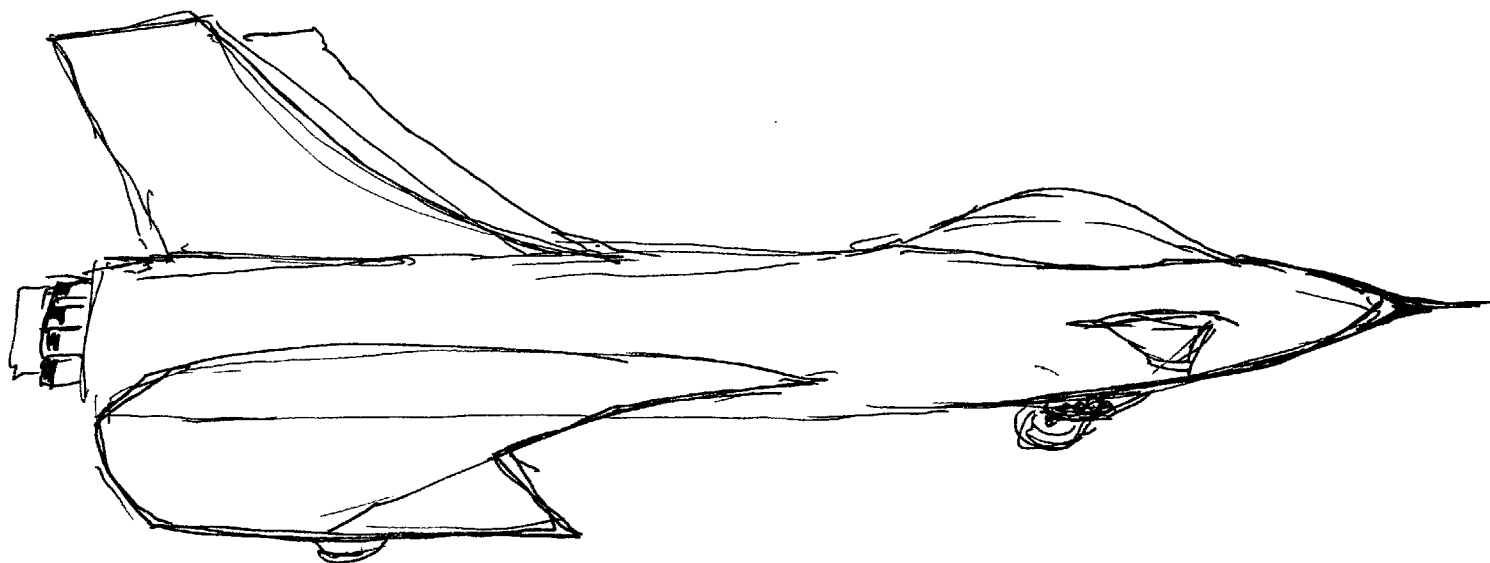

AOL-like land by sea

low slung to ground

AOL/s Ducting has to do with engines

AOL/s something near nose reminded me of whisker on cat but wider + thicker.

Approved For Release 2000/08/08 : CIA-RDP96-00789R000300150001-2  
with lots of 10, it was ground sufficiently  
but no more - to be effect