

~~SECRET~~/NOFORN

PROJECT SUN STREAK

WARNING NOTICE: INTELLIGENCE SOURCES AND METHODS INVOLVED

PROJECT NUMBER: 8911-1 (W-7) SESSION NUMBER: 01
DATE OF SESSION: 2 NOV 89 DATE OF REPORT: 2 NOV 89
START: 0930 END: 1000
METHODOLOGY: ERV VIEWER IDENTIFIER: **025**

1. (S/NF/SK) MISSION: Describe the SRI target and the activity at the target.

2. (S/NF/SK) VIEWER TASKING: Utilizing Encrypted Coordinates 8911-1, describe the target and the activities at the target.

3. (S/NF/SK) COMMENTS: No inclemencies noted. A Summary of Information is attached to this report.

4. (S/NF/SK): EVALUATION: **3**

HANDLE VIA SKEET CHANNELS ONLY

~~SECRET~~/NOFORN

CLASSIFIED BY: DIA (DT)
DECLASSIFY: OADR

This document is made available through the declassification efforts
and research of John Greenewald, Jr., creator of:

The Black Vault



The Black Vault is the largest online Freedom of Information Act (FOIA) document clearinghouse in the world. The research efforts here are responsible for the declassification of hundreds of thousands of pages released by the U.S. Government & Military.

Discover the Truth at: <http://www.theblackvault.com>

UNCLASSIFIED

8911-01 (W-7)
891102
V: 025
S: 01
0930 - 1000

SUMMARY - INFORMATION

A traditional off-white structure with columns and stairs in front is located in a city environment. Cars with headlights are in the immediate vicinity. Woods can be found to the upper left of this structure and a muddy drainage system. Light, heat, linear motion, and exhaustion, are related to the piping. A fountain, cinder block wall, and ramp are present. A lapse, indentation, gap, division or impression, is structurally clear cut into the lower front of the structure. The purpose of the building is logistics related and involves statesmanship. Communication devices are present. A circular object associated with the color red is shaped like a cake pan with a raised center.

UNCLASSIFIED

Woods

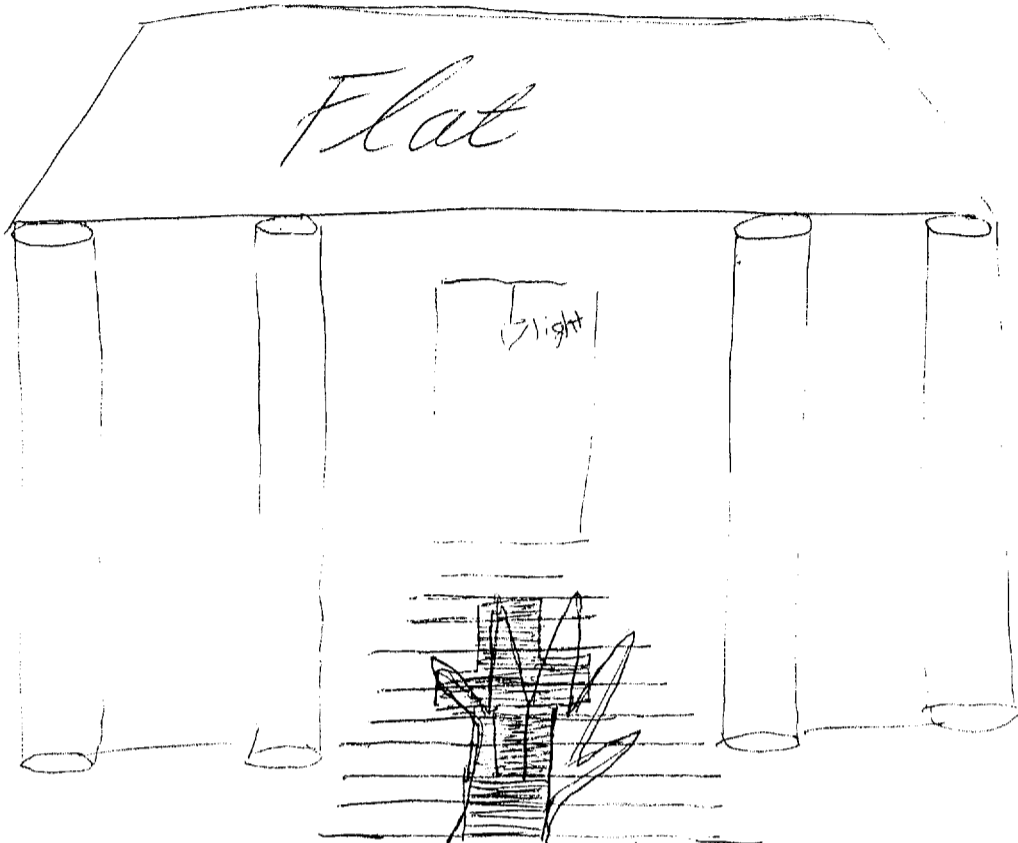

Muddy
Drainage
Septic
Hole

Indentation -
Impression Structurally



*Take from original object
Circular casting*

2

