

~~SECRET~~/NOFORN

PROJECT SUN STREAK

WARNING NOTICE: INTELLIGENCE SOURCES AND METHODS INVOLVED

PROJECT NUMBER: 8914-I	SESSION NUMBER: 1
DATE OF SESSION: 890418	DATE OF REPORT: 890420
START: 1420	END: 1445
METHODOLOGY: CRV	VIEWER IDENTIFIER: 003

1. (S/NF/SK) MISSION: Describe the most unique aspect and function of the target site and provide an overhead sketch of the target area.
2. (S/NF/SK) VIEWER TASKING: Coordinates. After viewer was in firmly in stage 4, the cue "what is the most unique aspect and function of the site" was given.
3. (S/NF/SK) COMMENTS: Next session will be spent getting more specifics on the most unique aspect and function of the site and doing a stage 6 exercise to obtain a detailed overhead sketch of the site.
4. EVALUATION:

1
9 Jun 89

HANDLE VIA SKEET CHANNELS ONLY
SPECIAL ACCESS REQUIRED

~~SECRET~~/NOFORN

CLASSIFIED BY: DIA (DT)
DECLASSIFY ON: OADR

This document is made available through the declassification efforts
and research of John Greenewald, Jr., creator of:

The Black Vault



The Black Vault is the largest online Freedom of Information Act (FOIA)
document clearinghouse in the world. The research efforts here are
responsible for the declassification of hundreds of thousands of pages
released by the U.S. Government & Military.

Discover the Truth at: <http://www.theblackvault.com>

~~SECRET~~

Working paper

Proj. no: 8914
Date: 18 Apr 89
Viewer: 003
Session: 001

Summary of Information

Site involves structures of dramatically varying shapes and forms within an expansive, enclosed area. There is a sense of "smoothly curving", grey, and turning. Also a concept of a cube within a cube--as in a cubical shape or structure contained inside a larger, similarly-shaped structure. The cube inside is oblique or at an angle to the expected inside dimensions of the external structure. [source note: there is a feeling that this is an unusual or "different" sort of a site or target. Doesn't seem to be an operational site.] The cue of "most unique aspect/function of site produced "motion, movement, shifting planes and elevations, height, wide, spread out, tall, unique patterns and construction," with a lack of uniformity structure to structure. It seems to be a place where people gather. Site produced and AI of melancholy and nostalgia. Also a sense of timelessness--bygone days but not obsolescence. People gather at this site--both relatives and friends, and complete strangers-- it's a public access place--a lot of different people come here all at once. There's something large, circular, and metallic, tilted, turning, with spaces in it. There's a sense of excitement and involvement. Site seems segregated off from outside, and access is controlled but not restricted. There are open areas among the structures, and walking areas that are not

(?)

Handwritten signature

(sidewalks per se, but are for walking--hard surfaced, winding, wide. There seems to be a large variety of things occurring. A/S of some sort of people diversion. A/S Associated with the site seemed to be a black-and-white image or photograph of young children in short pants sitting on something; one has his arm *WJ* around something cylindrical or projecting.

Handle Via SKEET Channels Only

~~XXXXXXXXXX~~

Paul
18 Apr 89
Ft. Meade, MD
Rabi
14 20

300 652
870 735

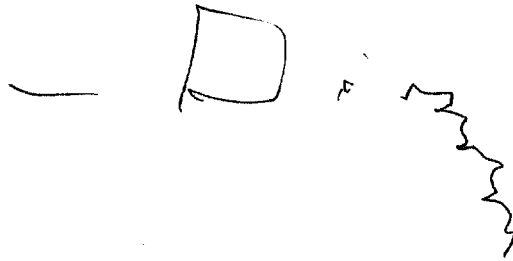

A. arm
ft
vnd

B. lnd

A. rod
ugh
knd
sld

B. snto

A. roud
sft

B

t. insis
repetens
moyher

B act hts

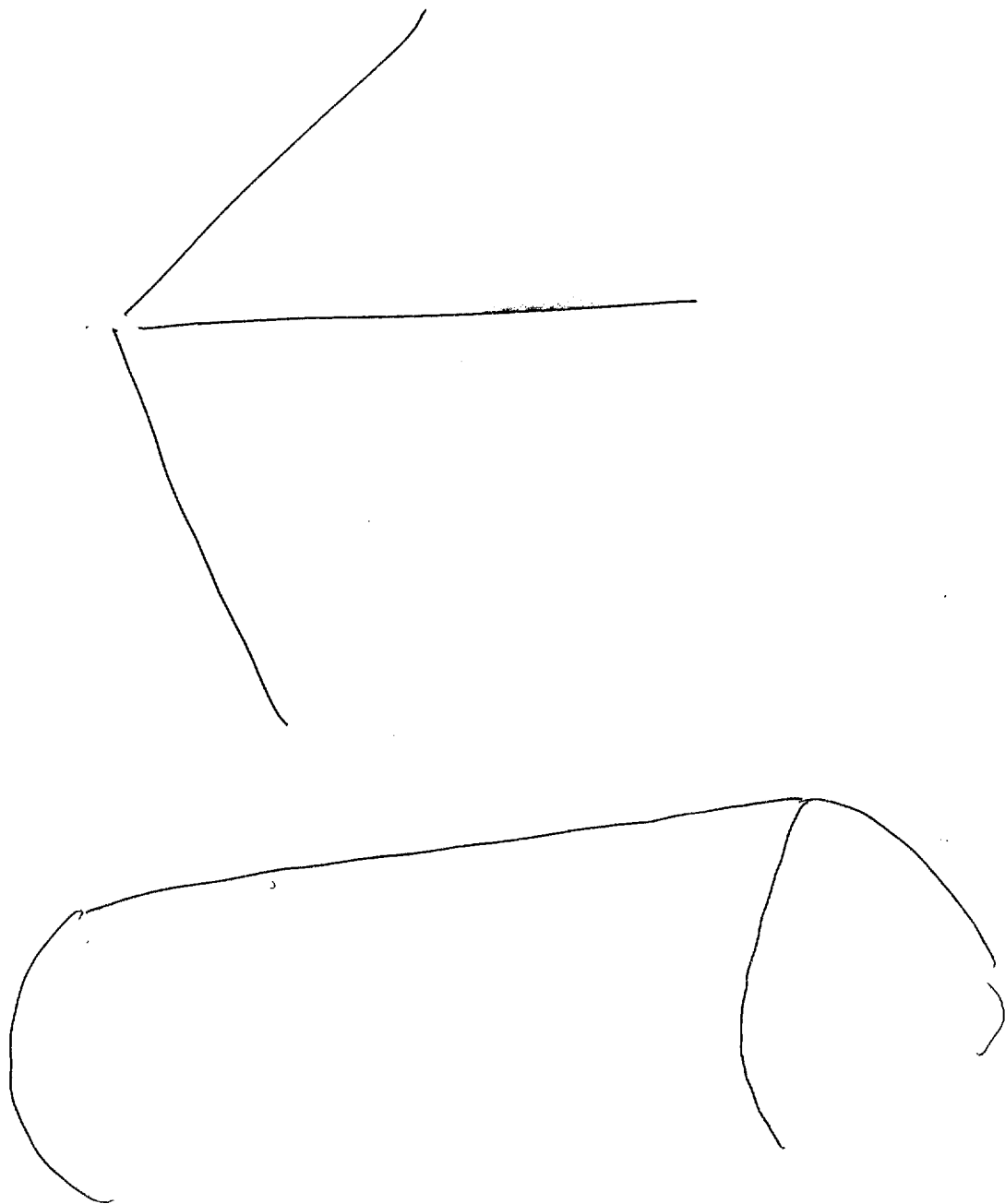

4

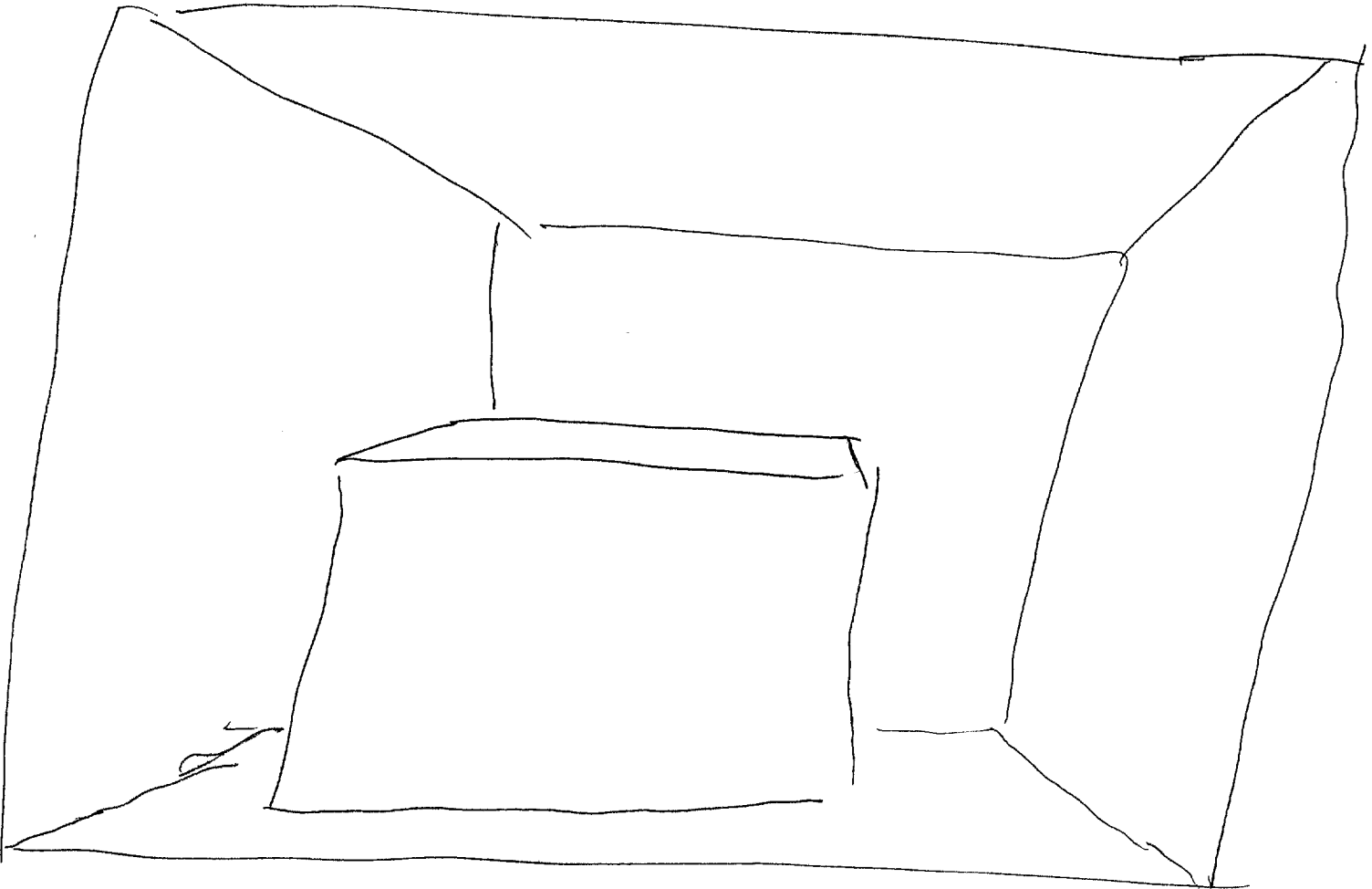

52 D A2 F3 T I AL AS
 pupu
 puu

ney
 family
 chun
 smooth
 rough
 mottle
 Gaps
 w/in a hole
 irregularity
 rounding

black
 +
 white
 white
 non-us

East
 Europe

effs
 children
 sitting
 image

1; 4
 photos
 photo

52

[Down comment]. Unusual or "different" sort of a site or forest. Doesn't seem to be on ground site.

Interests

not unique aspect + function at site (c)

motion movement starting planes + directions height width spread out fall

Structures

Various shapes size dimensions

Sub 1/2 unique patterns + construction. Not uniform structures & starts. Seems to be a place where people are.

AK BK

search and use of technology

52 D M FI T I AOL A/S

"Good old dog"

Self seen of timeleaves - by gone days but not obsolete.

54 1/2 / 4/9 "Image" of photo of several kids in street part sitting on something - one has an arm across something as individual. Old image "live" from somebody's photo album.

Self people gather at this site - both relatives + friends, and complete stranger - it's a public access - a lot of different people are here all at once "like" a gathering place

Self something large, circular, & metallic tilted, sparses in it

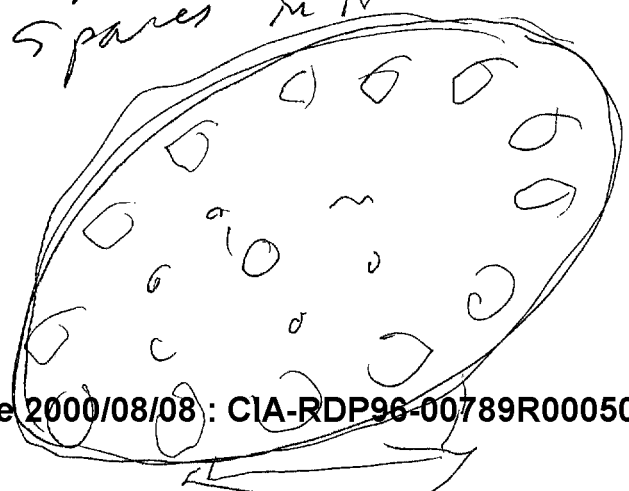

52

SVI
F7
Airtant
Involvement

H6

Sit(c)

long
spreadout
asymmetrical
ell rounded

Sequences
off
controlled once
but not restricted

open area

Further
walking area

Self/2 not sidewalk per se, but are for walking - hard surface,
wide, winding.

AI BK
r darkly

Self/2 large variety of things occurring. H/S same sort
of people diversiten.

AVL BK
Klaus Dunder, 445

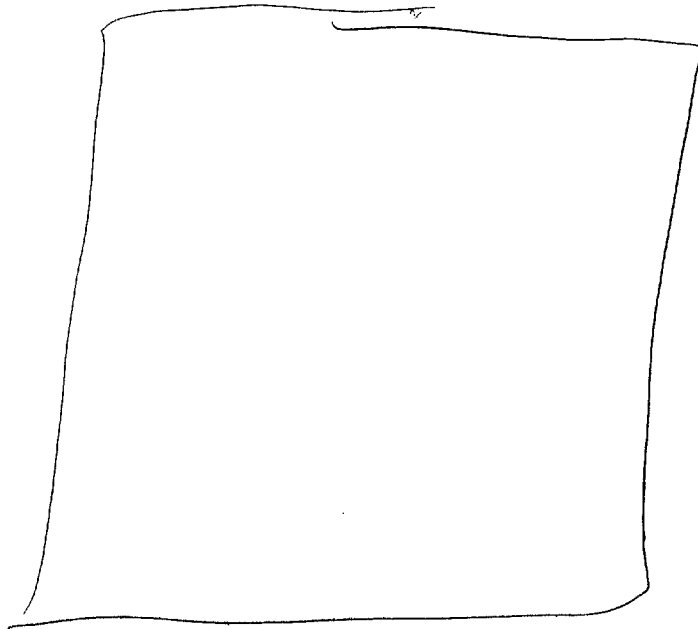

Am 5814 F
viewer: 003
Session: 1

OVERHEAD SKETCH

entrance
through
enclosed

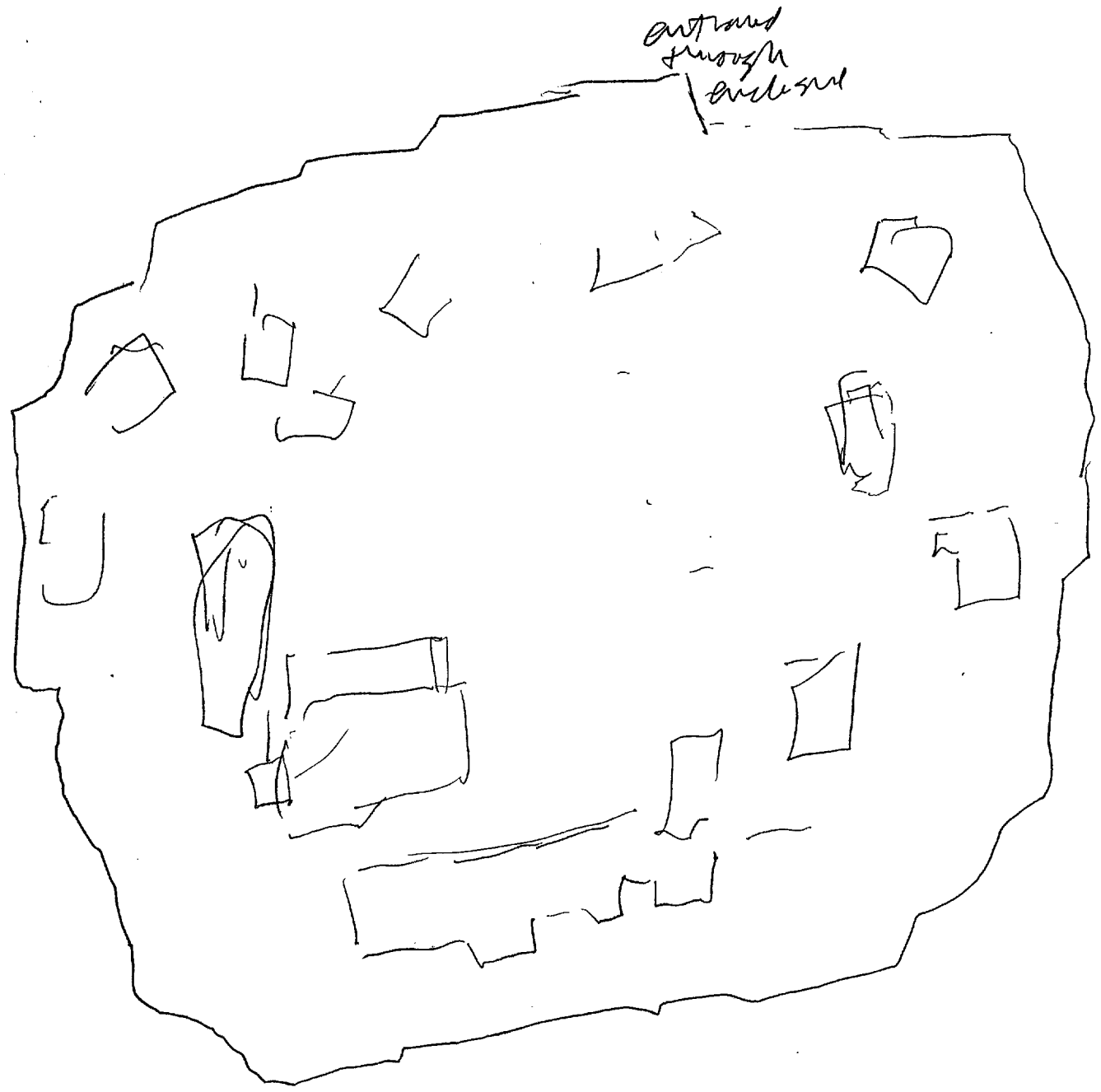

many 3 sectors
of different shapes
and forms

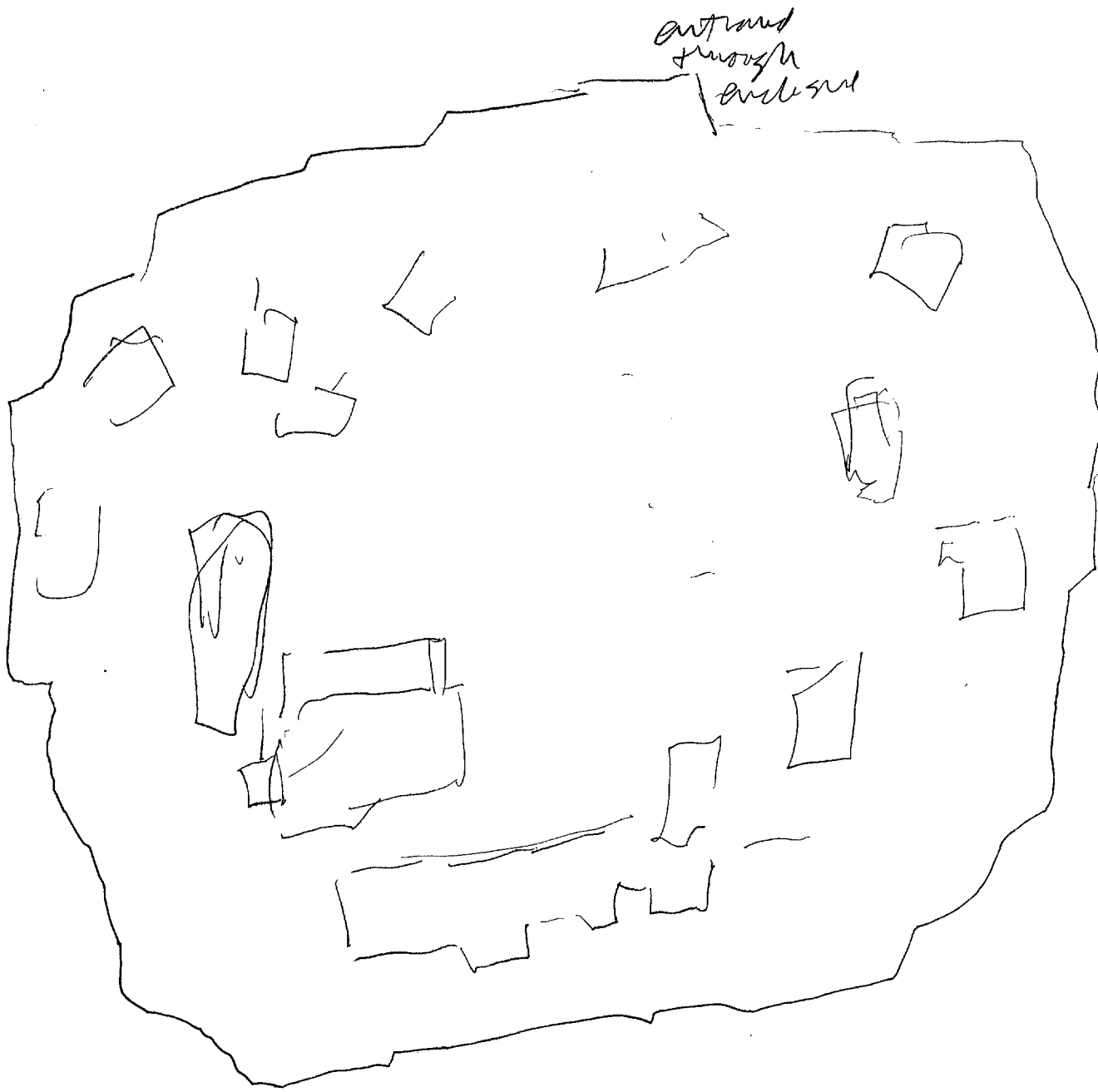

entrance
through
enclosed

many 3 sectors
of different shapes
and forms