

~~SECRET~~/NOFORN

PROJECT SUN STREAK

WARNING NOTICE: INTELLIGENCE SOURCES AND METHODS INVOLVED

PROJECT NUMBER: 8929 SESSION NUMBER: 02
DATE OF SESSION: 13 NOV 89 DATE OF REPORT: 14 NOV 89
START: 1412 END: 1444
METHODOLOGY: SOLO VIEWER IDENTIFIER: 018

SG1B

- 
2. (S/NF/SK) VIEWER TASKING: Continue to access and describe the target in terms of function and physical configuration.
 3. (S/NF/SK) COMMENTS: No inclemencies noted. Need Session 03 to be devoted mainly to sketching to focus on nature and location of the target. A summary of Information is attached to this report.
 4. (S/NF/SK): EVALUATION:
 5. (S/NF/SK) SEARCH EVALUATION:



HANDLE VIA SKEET CHANNELS ONLY

~~SECRET~~/NOFORN

CLASSIFIED BY: DIA (DT)
DECLASSIFY: OADR

This document is made available through the declassification efforts
and research of John Greenewald, Jr., creator of:

The Black Vault



The Black Vault is the largest online Freedom of Information Act (FOIA) document clearinghouse in the world. The research efforts here are responsible for the declassification of hundreds of thousands of pages released by the U.S. Government & Military.

Discover the Truth at: <http://www.theblackvault.com>

~~SECRET~~

WORKING PAPER

Project: 8929
Date: 891113
Time: 1412-1444
Viewer: 018
Session: 02

SUMMARY OF INFORMATION:

1. (S/NF/SK) Describe the lower area of the target structure and its contents: (see sketch, Figure 1 for overall diagram of site).

a. The lower area of the target structure is dimly lit. There are several "localized" lighted areas, mainly centering around work stations or "positions" (see sketch, Figure 2), of the kind you would find in a Field Station SKIF, or C³ Command Center. There was an overall sound of fans or air vents.

b. The work station viewed had a microphone, typewriter, radio(s), and switches for comms. I did not find any computer-like terminal or screen.

c. To the left (from my viewing angle) of this area is a quiet, closed-in room which is decorated in shades of blue. It is very well furnished. A tall, balding man who has an air of authority was walking around the room. This man was wearing a dark grey uniform. There is a plaque on the wall, and a woman's picture on his desk. His desk also holds a telephone with the number 642? (last number not perceptible) and some papers. A closer look at the papers produced a glimpse of the word "attache" or "attaching". Other papers appeared to deal with coordinating and control of "distant things".

d. This place has a close link with a distant city which has withstood a military attack within the memory of its residents. It also has

HANDLE VIA SKEET CHANNELS ONLY

~~SECRET~~

~~SECRET~~

a comms link with aircraft (type not discernable), and control over that aircraft's activities.

e. There is a see-through wall of some sort, with glowing yellow graphics and lettering on it. There is no perception, however, of picture-tubes or computer screens anywhere.

f. Below the flooring of this area is another dark area. It is used mainly for storage of boxes, but in one corner is a power supply which seems to be powering all the equipment in the room above.

HANDLE VIA SKEET CHANNELS ONLY

~~SECRET~~

(S)

SKETCH

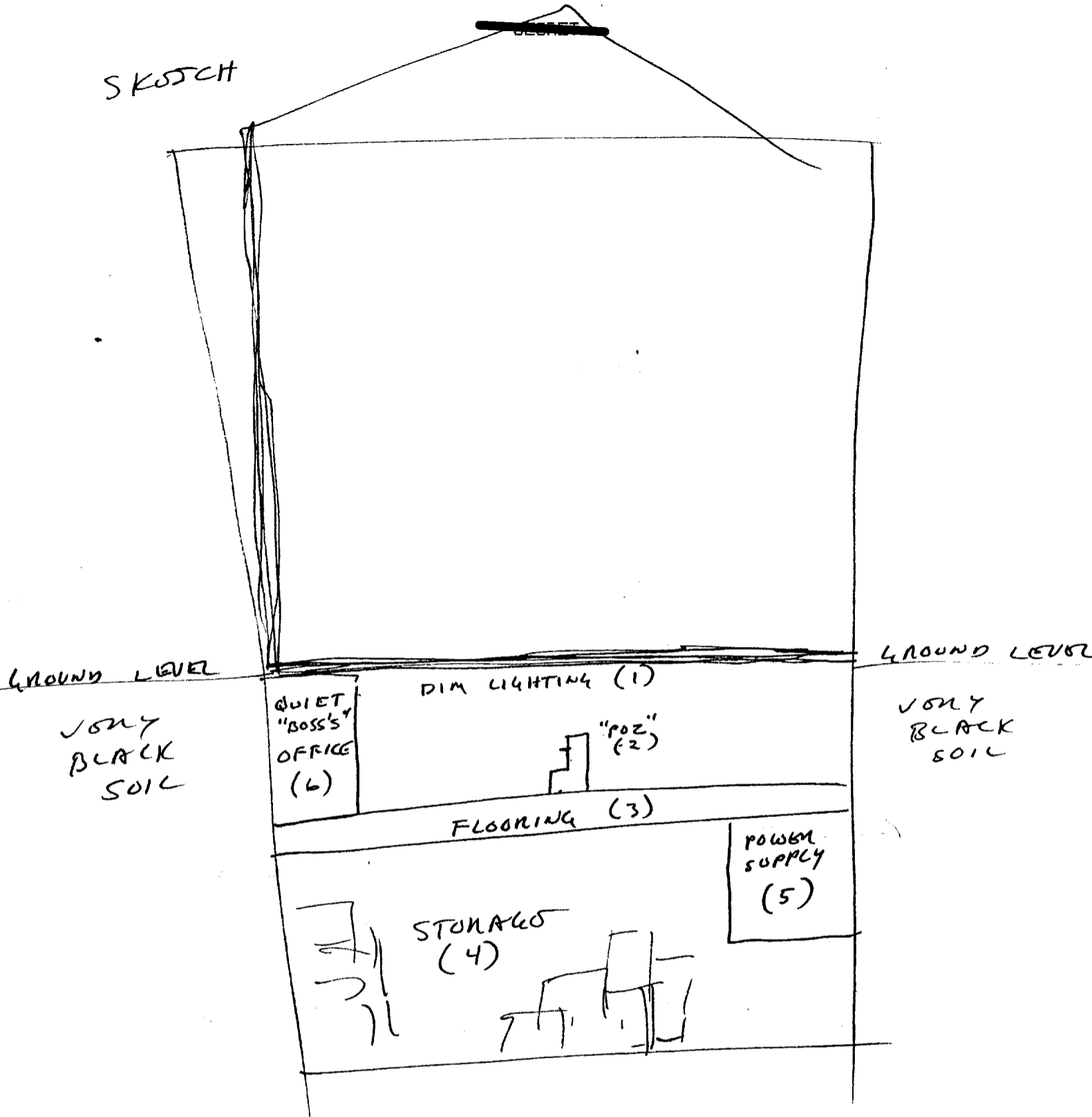

FIGURE 1. OVERALL SITE SKETCH

HANDLE VIA SKEET CHANNELS ONLY

~~SECRET~~

~~SECRET~~

SKETCH:

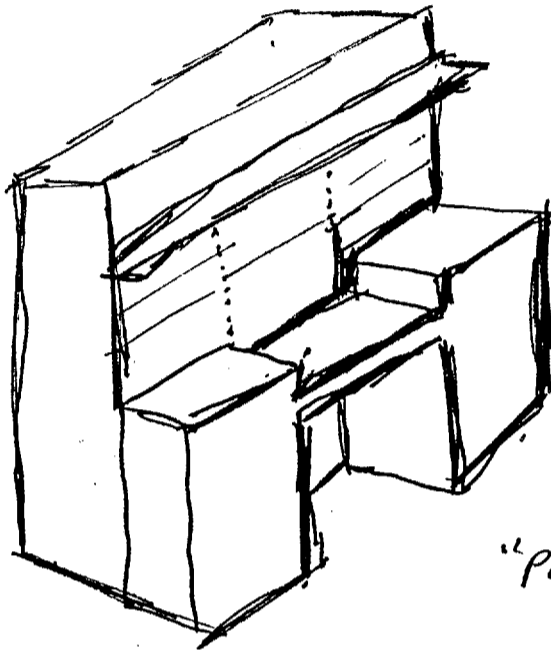

"POZ"

FIGURE 2. WORK POSITION
HANDLE VIA SKEET CHANNELS ONLY

~~SECRET~~

0/8

13 NOV 89
1412 HRS
FT. MONROE
SOLD

P.I. NONE
A.V. PREVIOUS SESSION

8929

STAGE 6: (SEE PROBE MAP, P. 1A)

S2 D M O T I AOL A/S,

LIGHTS

①

YELLOWISH
DIM
INCANDESCENT.

SOME ON DESKTOPS
SOME OVER WORKAREAS

A/S
"POZ"

AOL MK
LIKE A WORK
POSITION (POZ) IN
A FIELD STATION
OR C3 SITE

1A

STAGE 6 PROBE MAP
(SEE STAGE 6 STRUCTURE ON PAGES 1-
FOR PERCEPTIONS DOWSED AT EACH
NUMBERED POINT)

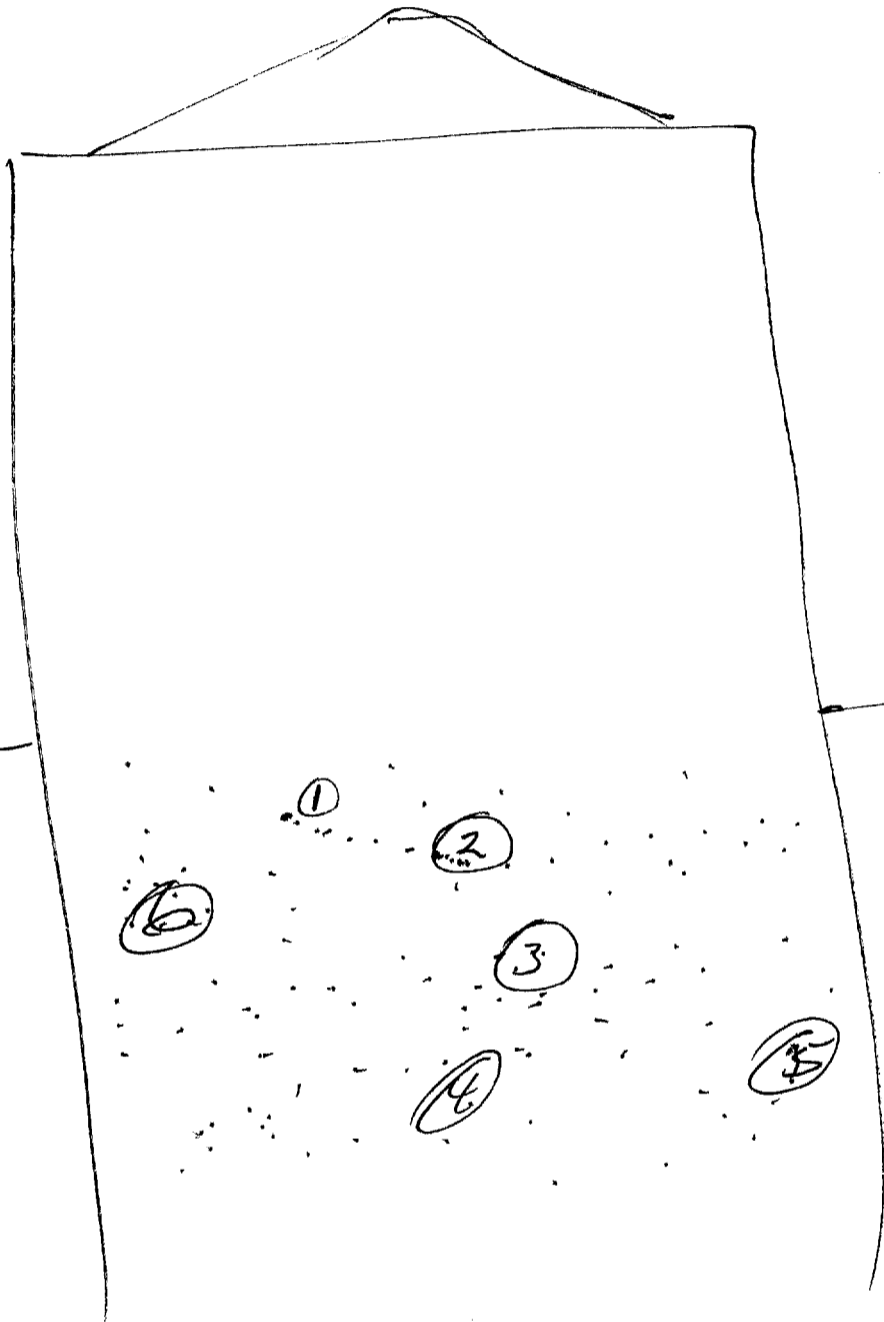

SEE P. 8 FOR SKETCH USING
PERCEPTIONS FOUND.

2

~~SE~~ S2 D 102 57 T 1 102 1/5.

2

SOLID
HEAVY
BOLTED DOWN
SQUAMISH

KEY
DIPLOD SURFACE
METALLIC

~~DESK~~

A/S
DESK

S: 6 1/2: THIS OBJECT IS NOT ONLY
A "DESK". IT IS MORE A WORK
STATION OR POSITION.

LOW LIGHTING
LOCALIZED LIGHT.

~~MICROPHONE~~

MICROPHONE
TYPEWRITER
RADIO
COMMS
SWITCHES

3

52 ① AT ET T, now n/s.

DESK

BI-LEVEL
LOWDOWN IN CENTER

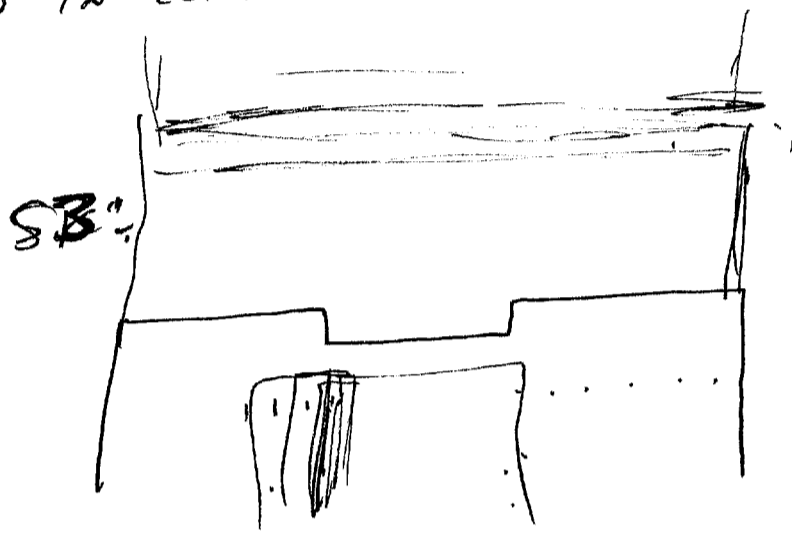

SB"

SKETCH:

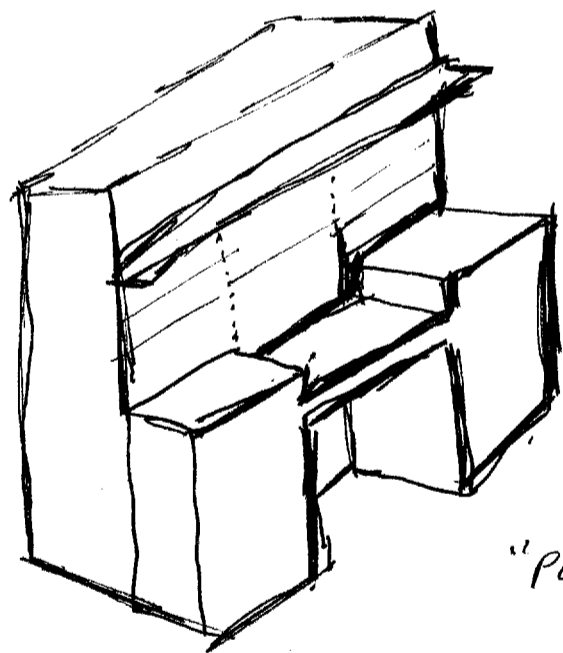

"POZ"

4

SZ D RT OT T I ALL ABS.

3

FLOORING

4

DARK
EMPTY
BLACK

"THINKS"

STORAGE

BOXES

5

METALLIC
SLOTTED
HOT
HUMMING SOUND

MACHINES

POWER SUPPLY

REGULATED

~~V. POWER~~
BOLUS GROUND WOUND

(5)

SL D M O T 1 M A/S

OFFICES

505 APART

LIGHT

BLUISH COLORS

QUIET

S6 1/2 THIS PLACE IS QUIET, HOWEVER THE LARGON AREA, OUTSIDE, HAS A CONSTANT "FAN" OR "AIR-WHOOSH" NOISE.

NOT ON

WELL-UPHOLSTERED FURNITURE

MAN

AUTHORITY

BOSS FIGURES

UNIFORMED

(CRANK UNIFORM)

BALDING. HATRLING

6

S2 D M O T , Au A/S.

A/S,
PHONE # ON DESK
642?

PLAQUE ON WALL
WOMEN'S PICTURES
PAPERS

(PAPERS)

THINKS AT A DISTANCE
CONTROL
COORDINATING

S7
"ATTACHE"
"ATTACHING"

S6 1/2 IMPRESSION OF A CLOSE LINK
WITH A DISTANT CITY WHICH HAS
WITHSTOOD A MILITARY ATTACK
WITHIN THE MEMORY OF ITS RESIDENTS.

2

SL D M O T I M A/S.

SG 1/2 IMPRESSION OF COMMUNICATION
W/ AIRCRAFT, AND CONTROL OVER IT.

CONFUSION MK: PERCEPTION OF
GLOWING GRAPHIC(S) IN A VERTICAL
POSITION, BUT NO PERCEPTION OF
A PICTURE-TUBE/COMPUTER SCREEN/ETC.

A/S.

LIKE A SEE-THROUGH
WALL W/ GLOWING
GRAPHICS ON IT.

YELLOW
GLOWING.

AOZ MK:
ONE OF THOSE
CLEAR MAPS FOR
TRACKING THINGS

AFROD I'M IN DRIVE - SESSION END - 1444

8

SKETCH

