

~~SECRET STIPPLED NOFORN  
SPECIAL ACCESS REQUIRED~~

WARNING NOTICE: INTELLIGENCE SOURCES AND METHODS INVOLVED

---

PROJECT NUMBER:	9027	SESSION NUMBER:	2
DATE OF SESSION:	16 MAY 90	DATE OF REPORT:	18 MAY 90
START:	1351	END:	1435
METHODOLOGY:	CRV	VIEWER IDENTIFIER:	049

---

1. (S/STD) MISSION: To describe the target structure, identifying the entrances, the personnel who control it (who works/stays there; who comes and goes), its interior, and the contents of "containers in the structure".
2. (S/STD) VIEWER TASKING: Encrypted coordinates and "Target is a structure".
3. (S/STD) COMMENTS: No Physical Inclemencies reported.
4. (S/STD) EVALUATION:
5. (S/STD) SEARCH EVALUATION: N/A

Monitor: 011  
Proj Mgr: 018

CLASSIFIED BY: DIA (DT)  
DECLASSIFY: OADR

~~SECRET STIPPLED NOFORN  
SPECIAL ACCESS REQUIRED  
Handle Via SKEET Channels only~~

This document is made available through the declassification efforts  
and research of John Greenwald, Jr., creator of:

# The Black Vault



The Black Vault is the largest online Freedom of Information Act (FOIA)  
document clearinghouse in the world. The research efforts here are  
responsible for the declassification of hundreds of thousands of pages  
released by the U.S. Government & Military.

**Discover the Truth** at: <http://www.theblackvault.com>

P: 9027  
S: 02

1) Tunnel leading to "Room w/ Boxes":

- row of plain light bulbs along ceiling of tunnel (two)

2) Room w/ boxes:

- at least one step down into room from tunnel
- [iron?] grate door across doorway; slides vice opens in or out (opening in or out would interfere with sensor [?]. apparatus)
- small wooden "housing box" in corner just right of doorway
  - 36" x 40" tall; 8" on a side
  - firmly attached to corner
  - contains something associated with electrical energy (but doesn't control "sensor apparatus")
- black wooden door and wooden panel in right near corner
  - 1 or 2 steps up to door
  - small room occurs behind black wooden door (door opens into room).

3) 2d room (behind Black Door):

- truncated shape (w/ prepared, brick walls)
- one table has a clutter of items, like tools, on top.
- a second table or shelves along another wall
- dark opening into a 3d room in right rear corner.
- step up into 3d room

4) 3d room:

- cut or hollowed out of bedrock or parent rock/soil (walls are undressed rock)
- large rocks along 3 walls
- floor is prepared brick
- humming sound associated with this room
- small opening in left rear corner
- opening leads to staircase

5) Staircase:

- leads up two flights to small landing and wooden door
- dark, open space left of, and behind, stairway.
- large open room behind door; sits above  
further room (abot of light w/in room)

c) Panel in "Room w/ Boxes":

- wooden panel covers a shallow cupboard area w/ rocks
- <sup>inside</sup> of cupboard is damp, rotten, decayed;
- there is a lot of confusion about what is behind this panel/cupboard.
- feeling that a maze or labyrinth of something occurs behind panel/cupboard.

TABC

BEDROCK OR PARENT SOIL

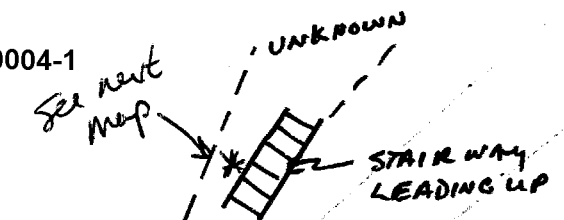

Room is cut out of parent rock/soil

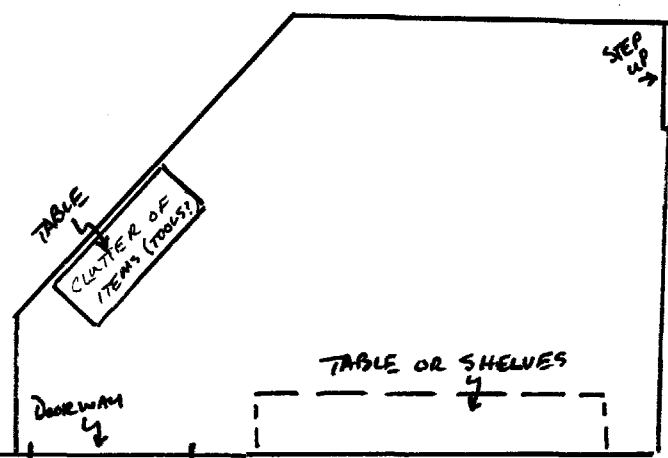

WOODEN CRATES BURIED BY BOXES

STACKED BOXES

Room w/ Boxes

TABLE

wooden "box" attached to corner

UNKNOWN (CONFUSING)

9027  
9005  
049  
S.O.C.



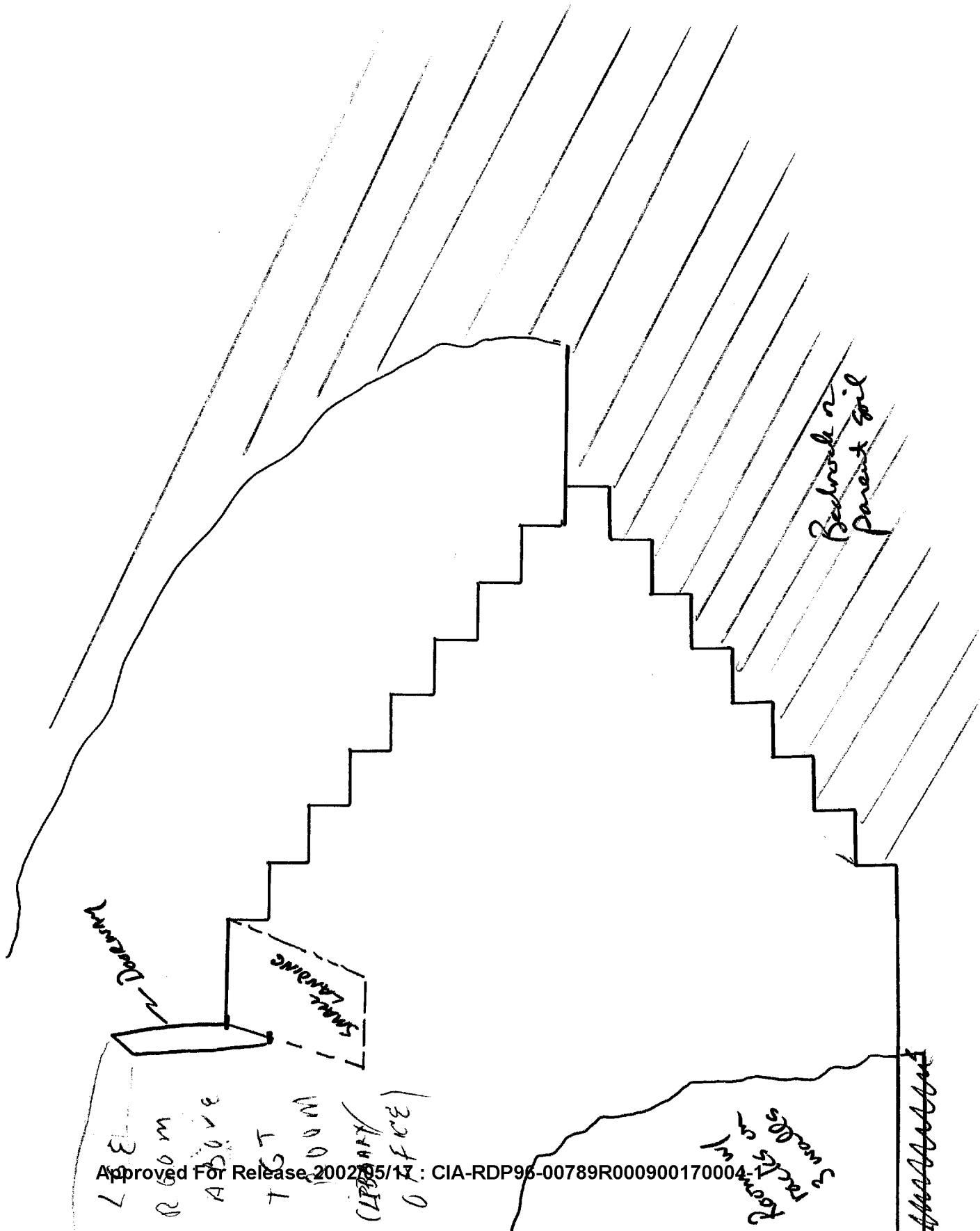

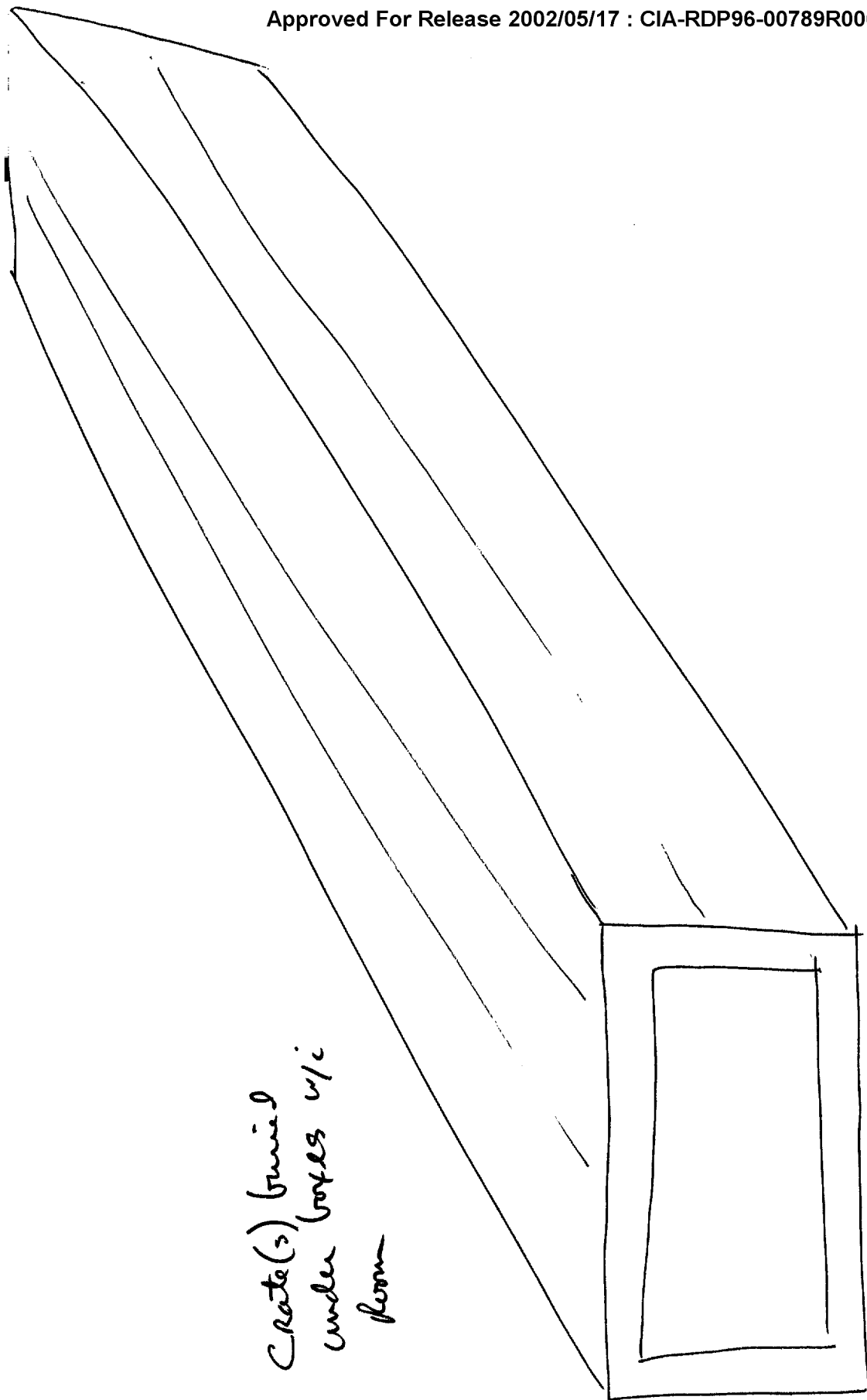

Crate(s) buried  
under boxes w/i  
room



PI - Fried  
AV - none

049  
16 May 90  
R. Meade  
011  
1351

AVC BK  
Stinger Missile

[Room]

Damp  
Wet  
Musty

Low

Row of lights  
on ceiling of  
passageway

Two lights;  
just bulbs

At least no step down  
into room.

Trin quite down;  
slides rather than  
opens in a art.  
walled interior of  
being apparatus

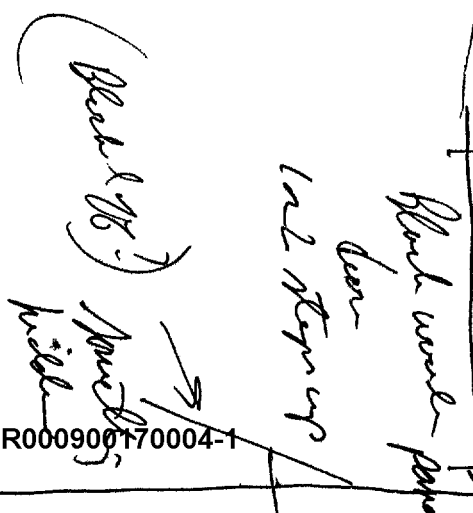
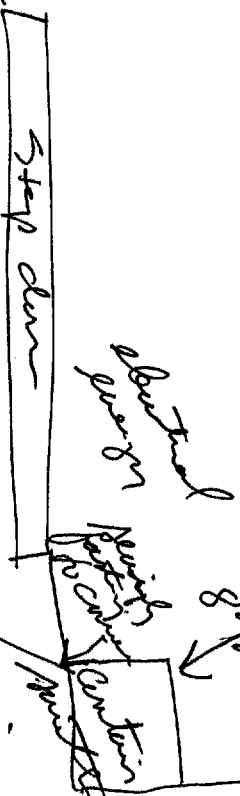
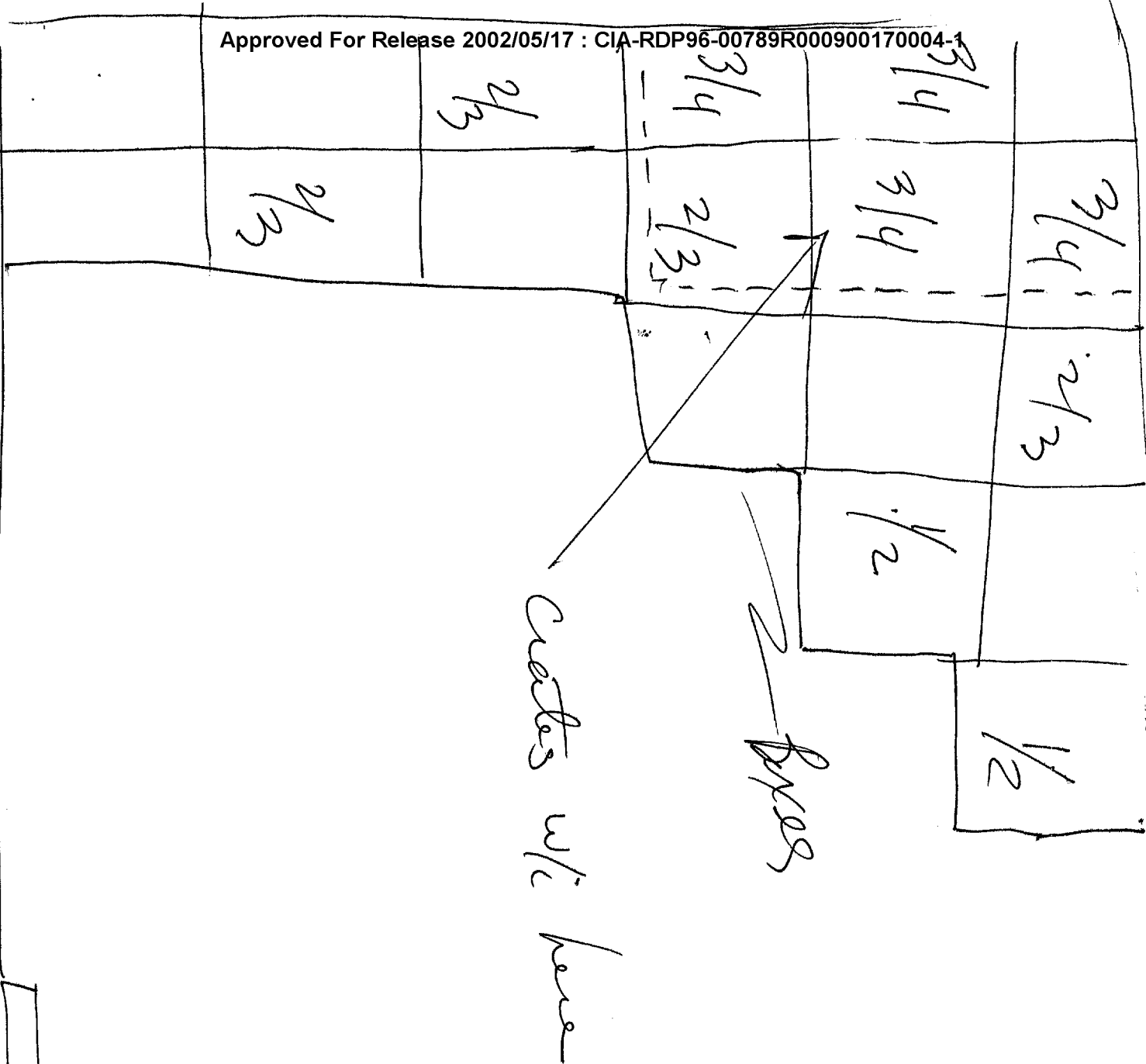

[Smaller Room  
behind door]

Tables or shelves  
Clutter of items on  
top of one table  
Tools

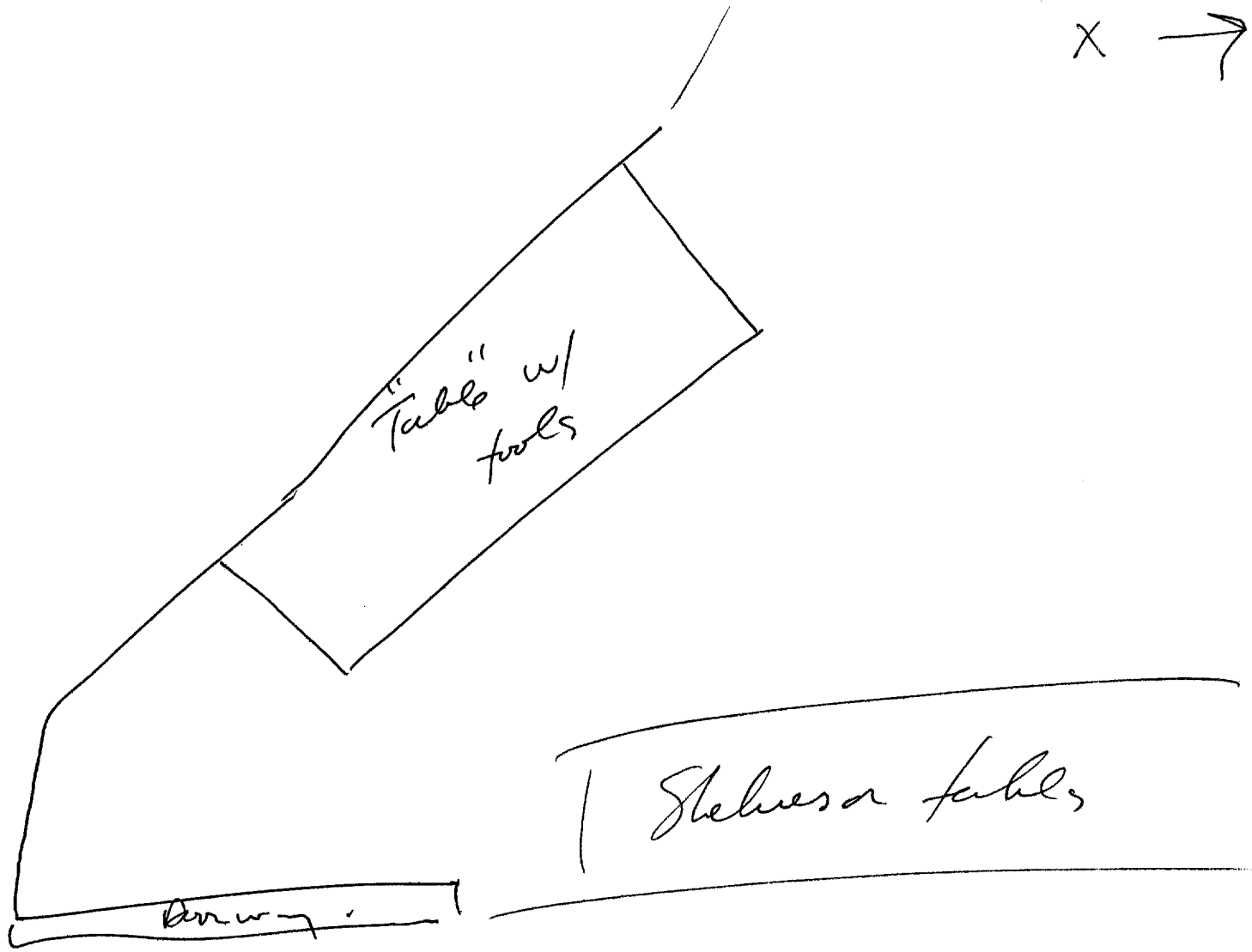

Hemming

Prepared bed  
with floor  
Docks or shelves on  
3 sides

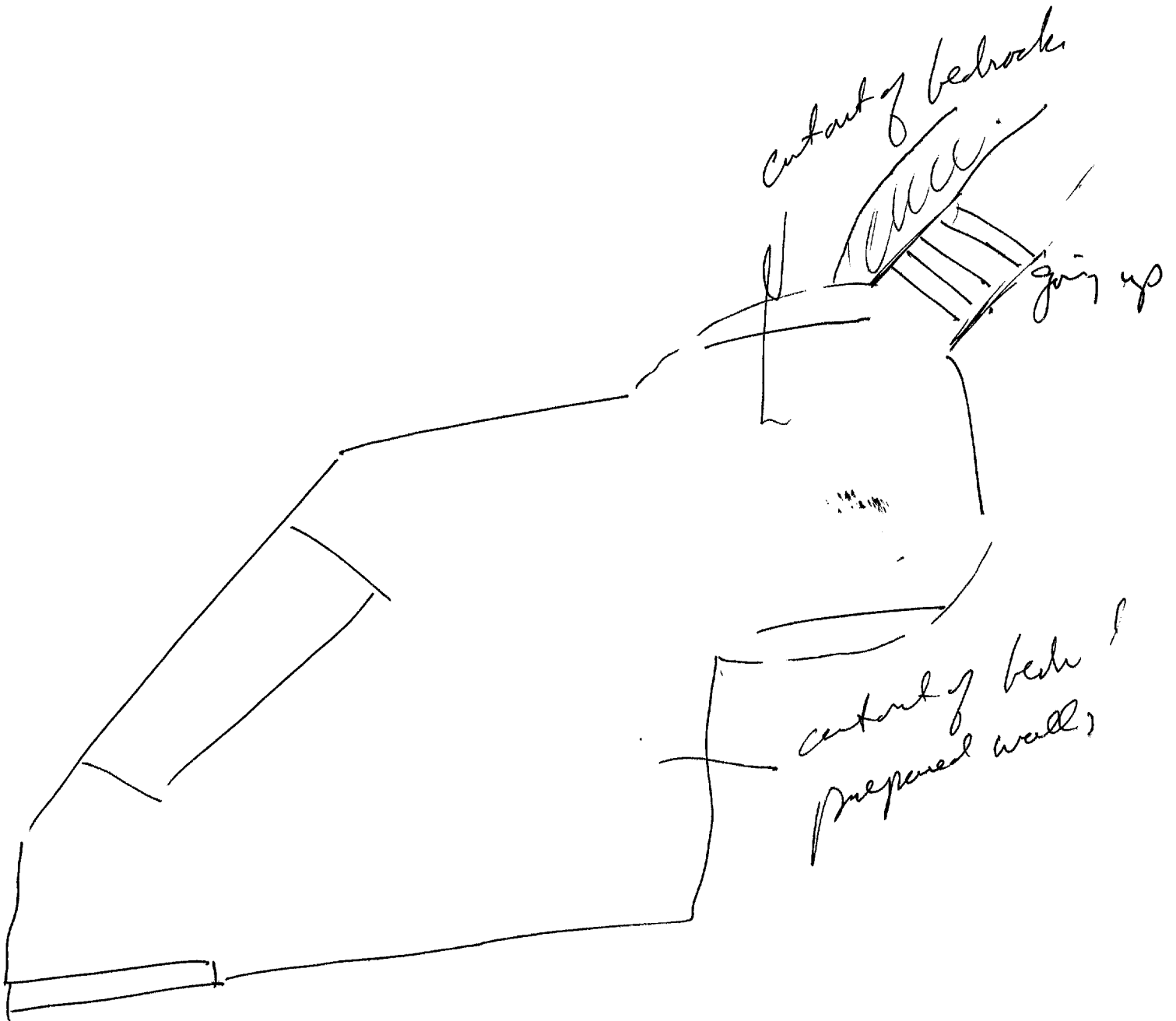

52

D AI EI T I Ac Ac 15

Approved For Release 2002/05/17 : CIA-RDP96-00789R000900170004-1

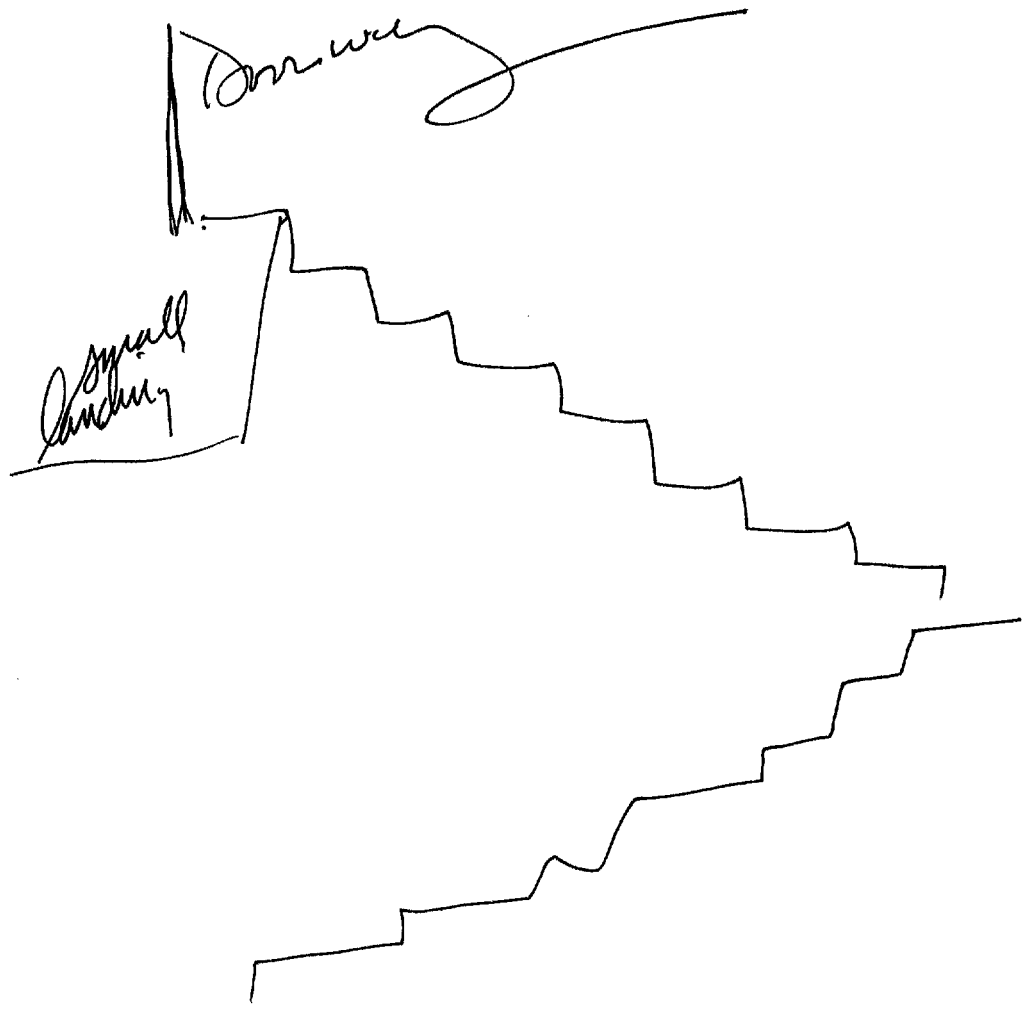

Approved For Release 2002/05/17 : CIA-RDP96-00789R000900170004-1

32 D

Bright  
open

AOC/S  
Office  
AOC/S  
Library  
AOC  
Bedroom

[Panel in "Box" Room]

It's like a shallow cupboard  
w/ rocks

AI  
Damp rotter

Decayed

ET 1435

ACC/S  
Not there that  
print falls do not  
know about