

FORWARD ←

~~BOARD~~

RU/SMA  
BOARD

ALL BOARD  
 COVERED  
 DARK  
 ENCLOSURE  
 INSIDE  
 MOUNT NOISES  
 NUMBER SOUND

MAN/JUNNA

FACING SIDEWAYS

S4 1/2 CLOSED ROOM. FEELS LIKE  
 CLOSE TO ROOM OF SHIP. (± 3/4 WAY  
 BACK)

S4 1/2 IMPRESSION THERE AND NOT THE  
 ONLY NOISES ON BOARD.

This document is made available through the declassification efforts  
and research of John Greenewald, Jr., creator of:

# The Black Vault



The Black Vault is the largest online Freedom of Information Act (FOIA) document clearinghouse in the world. The research efforts here are responsible for the declassification of hundreds of thousands of pages released by the U.S. Government & Military.

**Discover the Truth** at: <http://www.theblackvault.com>

16 JUL 90  
1733 HR.  
KEY WEST  
OOF

P.I. HEADACHE  
A.V. [REDACTED]

SG1A

~~900716  
900062~~

A: RISING  
ACROSS  
HMM

O:

A: ANSWER  
DOOR  
HMM  
DOWN  
HMM

B: STRUCTURE

ACR ONE  
SHIP

A: ANSWER  
SHOOT

B: WATER.

~~900716  
900062~~

A: ANSWER  
SHOOT

B: WATER

A: DOWN  
HMM

B: STRUCTURE

82!  
YOU WISH  
LONG  
DISTANT

(54)

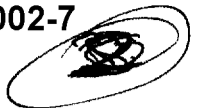

S2S moving  
RIGHT  
SUNNY  
WINDY  
NOISY  
LARGE  
WIDE  
TALL

CONF BAK  
~~FOR BAK~~

A VISUAL OF  
A LARGE SHIP  
W/ THINGS STICKING  
UP AT ANGLE, BUT  
W/ THE MAIN PORTION  
OF THE SHIP LOOKING  
MORE LIKE A SPACE  
OCCUPY LINE (IN  
DESIGN)

S2S. YELLOWISH TINGED  
WINDY  
WIDE  
TALL

FOR BAK  
FISHING VESSEL

3

82: TALL  
LARGE

84

S2 ~~K~~ D 07 07 T 1 00R A/S.

(LIMITATIONS  
OF [REDACTED])

SG1A

ROTORAL  
ROTORAL

MONEY

BIL. DOLL

T.RANSPOAT

CONF MK

WHY DOES  
TRANSPORT COME  
IN THE T  
COLUMN?  
DIFF. MATHS?

PICK UP  
POZZUMY  
EXCHANGES

84/2 IMPRESSION THAT THIS TRANSFER  
WILL BE A 2-WAY TRANSACTION.

AN MK  
LIKE MONEY -  
FOR ARMS SONS  
KIND OF ~~EXCHANGES~~

(4)

SZ O M ER = 1 OR AL,  
NO L PUC  
MANS. DORZ.

(CONTINUOUS  
OF [REDACTED])

SG1A

.STATION  
KNOWN  
WORKS  
PACKETS - SIZED

54 1/2 VISUAL IMPRESSION OF A  
LARGE MOUNTY - STACKED "CUBS"  
OF PACKAGES - PACKAGES ARE  
SHINY - (LIKE WRAPPED IN COPPER  
OR ALUMINUM), + ARE APPROX. 4" X 6"  
X 8" IN A RECTANGULAR AREA



5

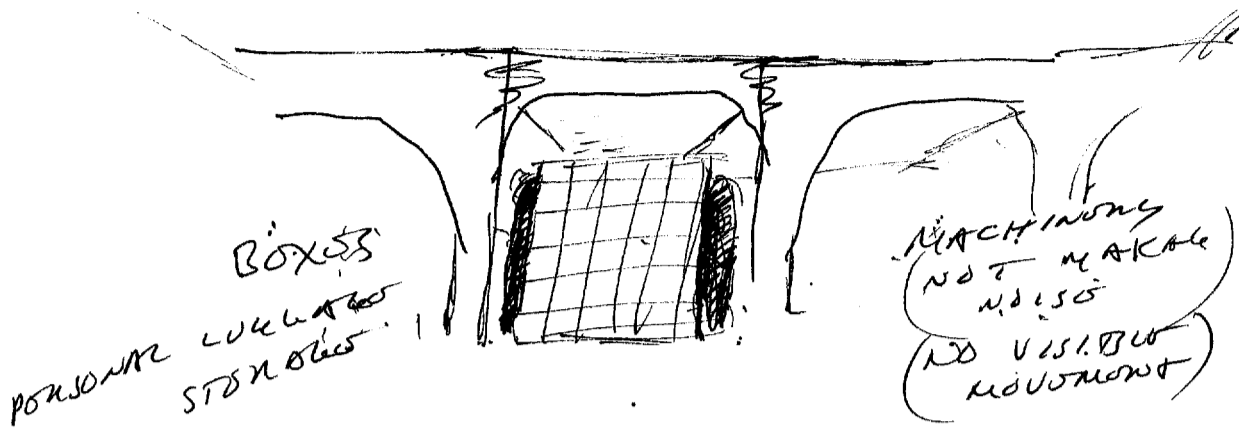

BOXES  
PERSONAL EFFECTS  
STORAGE

MACHINERY  
(NOT MAKE  
NOISE)  
(NO VISIBLE  
MOVEMENT)

FORWARD

~~BOARD~~

RU/STRA  
BELOW

ALL ABOVE  
COVERED  
DARK  
ENCLOSURE  
INSIDE  
MOTOR NOISES  
NUMBER SOUND

MANJUNA

FACING SIDEWAYS

S 4 1/2 CLOSED ROOM. FEELS LIKE  
CLOSE TO ROOM OF SHIP. (± 3/4 WAY  
BACK)

S 4 1/2 IMPRESSION THAT NOT THE  
ONLY DRUGS ON BOARD.

(a)

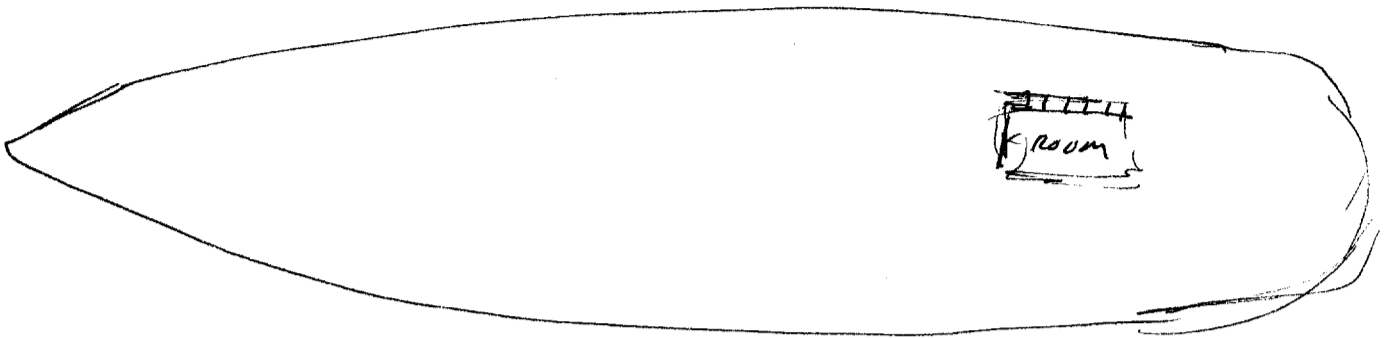

METAL WALLS.

THAT'S NOT THE ONLY HAULT  
ON BOARD.

THIS IS A HUGE  
AMOUNT.



⑦

SZ 0 at of T, for abs,  
(interviews)

(ST)  
"ANTHUR"

EXCHANGES,

(A.D.)

MILK & FATS RUCK  
EXCHANGES  
NO TRUST.  
"WHEN I GOT RUCK,  
I WANT A MOTORCYCLE"  
AT SOA  
EXCHANGES AT SOA

A/S.  
WNE

316 SHOP

A/S.  
LIKES A TANKER.  
ADL RUCK  
LIKES A JAPANESE  
TANKER.



S6 (SOS P. 8A)

S2 @ A1 O7 T1 AN AL  
RELATIONSHIP

① PURPOSE  
HIGH MICHAEL  
ON CO  
FROM KN TO RD  
TAK'

S6 1/2 AN ACTION FROM AD TO AN ~~THIS ALSO~~,  
BEGINS TAKING PLACE AT THE SAME TIME AN  
ACTION FROM AN TO RD BEGINS TAKING PLACE.  
HOWEVER, THE ACTION FROM AN TO RD  
STALLS OR SLOWS OFF TO THE SIDE UNTIL  
THE ACTION FROM AD TO AN IS COMPLETED.  
THEN (ONLY THEN) IS THE ACTION FROM  
AN TO RD COMPLETED.

A/S  
THE LACK OF TRUST  
IS INVOLVED &  
SOMEHOW IMPORTANT,  
NOT ONLY TO THIS ACTION,  
BUT AS A KEY FACTOR  
FOR "US".

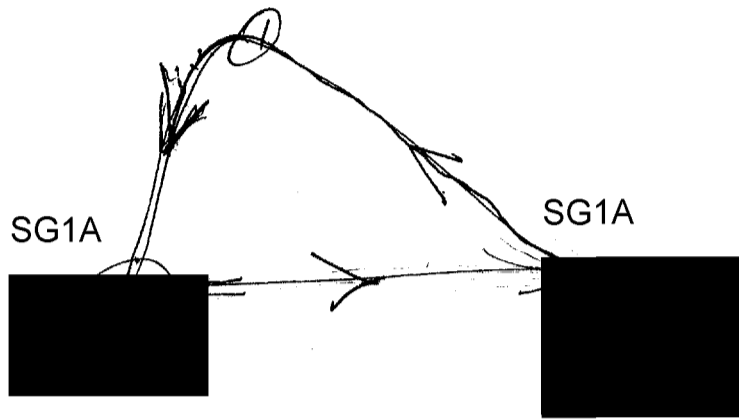

9

86 (555 P. 9/11/9)

52 0 m or v 1 1102 n/s.

①

ANXST.

②

PAIN IN HAND

③

COCKSURE,  
FOOLISH OF THINK SO SOME OF  
YOURSELF AS TO FOOL THE OTHER  
CS AT YOUR MONEY + "LENDING  
IT OWN" SOMEONE

④

SUDON STOP

ADS  
INTROLOFT  
+  
INTRODUCTION

~~XXXXXXXX~~

~~XXXXXXXX~~  
~~XXXXXXXX~~

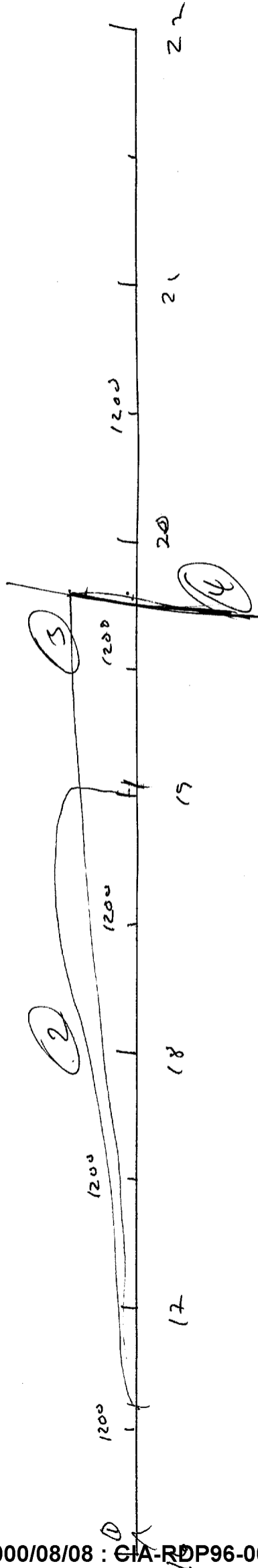

22

080587N4

....

1108N / 5250W

8008N / 5700W

8050N / 5225W

53510W 520  
1535