

SG1A

Approved For Release 2000/08/08 : CIA-RDP96-00789R001100210002-5

Approved For Release 2000/08/08 : CIA-RDP96-00789R001100210002-5

This document is made available through the declassification efforts  
and research of John Greenewald, Jr., creator of:

# The Black Vault



The Black Vault is the largest online Freedom of Information Act (FOIA) document clearinghouse in the world. The research efforts here are responsible for the declassification of hundreds of thousands of pages released by the U.S. Government & Military.

**Discover the Truth** at: <http://www.theblackvault.com>

18 JUL 90  
1445  
KEY WEST  
~~OFF~~

P.I. NONE  
A.V. NONE

AREA "S,"

900718  
900067

~~AI~~ ~~OFF~~ BNC.  
SUNRISE AT 1000GROM.

900718  
900067

A: ACROSS  
RISING  
TWO  
HUMANITARIAN  
B: STRUCTURES.

SZ:

BLVD  
CANDYISH BRUSH  
DARTY KROY.  
MOTEL  
TALL  
EMPTY

ALL BNC.  
EMPTY = MOSTLY OPEN SPACES  
NOT TOTALLY EMPTY.

ALL BNC  
WAREHOUSE.

A02 BNC.  
VISORS: KROY  
MULTISTORIED  
OFFICE BLDG.

2

S2: ROD  
BLASTING  
METALLIC  
LAMINATE  
STOPPED UP

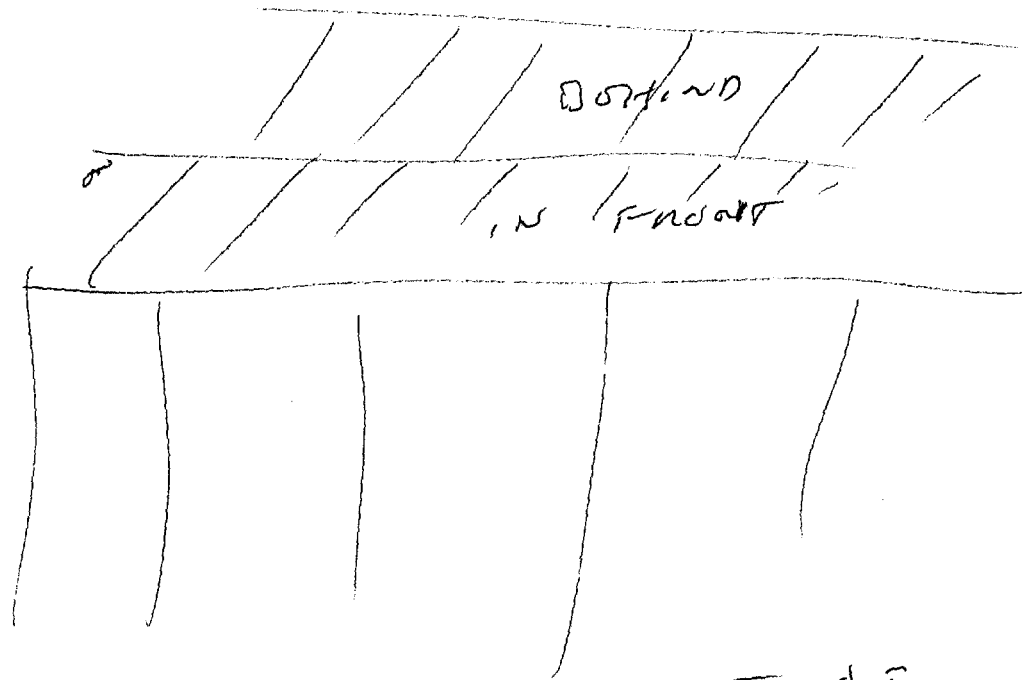

OUT IN FRONT OF  
ANOTHER

SLOPING

3

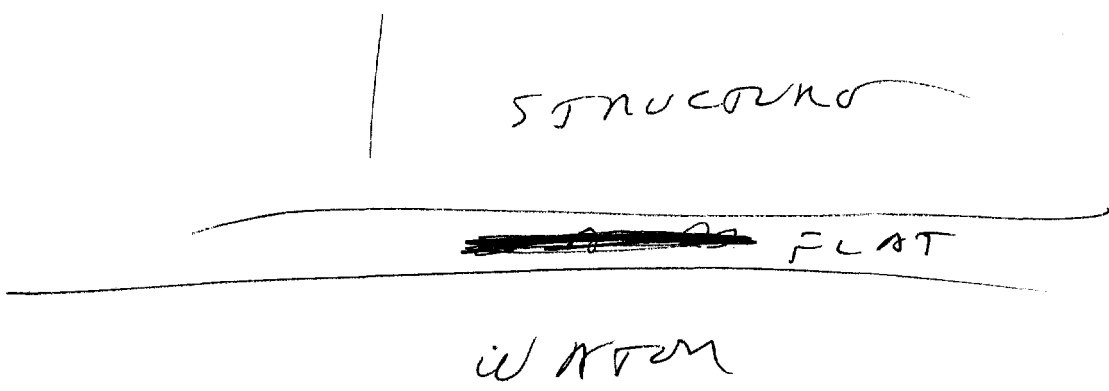

NOTE FOR K  
WAREHOUSE ON DOCK

AKA BRK  
WOODEN DOCK.

S6: SSG PHOTO, P. 4A

S2 D RI OT T, AGL A/S.  
(AREA OF ANKLES)

see page 4A

① A: BRK  
OOOOO!

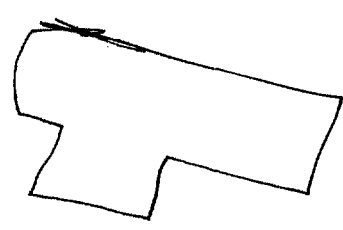

(DRAWING OF BRK IN  
MIDDLE OF AREA 'S')

DIRECTIONAL  
CENTRO &  
SETUP  
DIRECTOR OF ACTIVITIES  
ORGANIZATION

S 2 0 A 1 2 5 1 00 1/2

See page 4A  
2

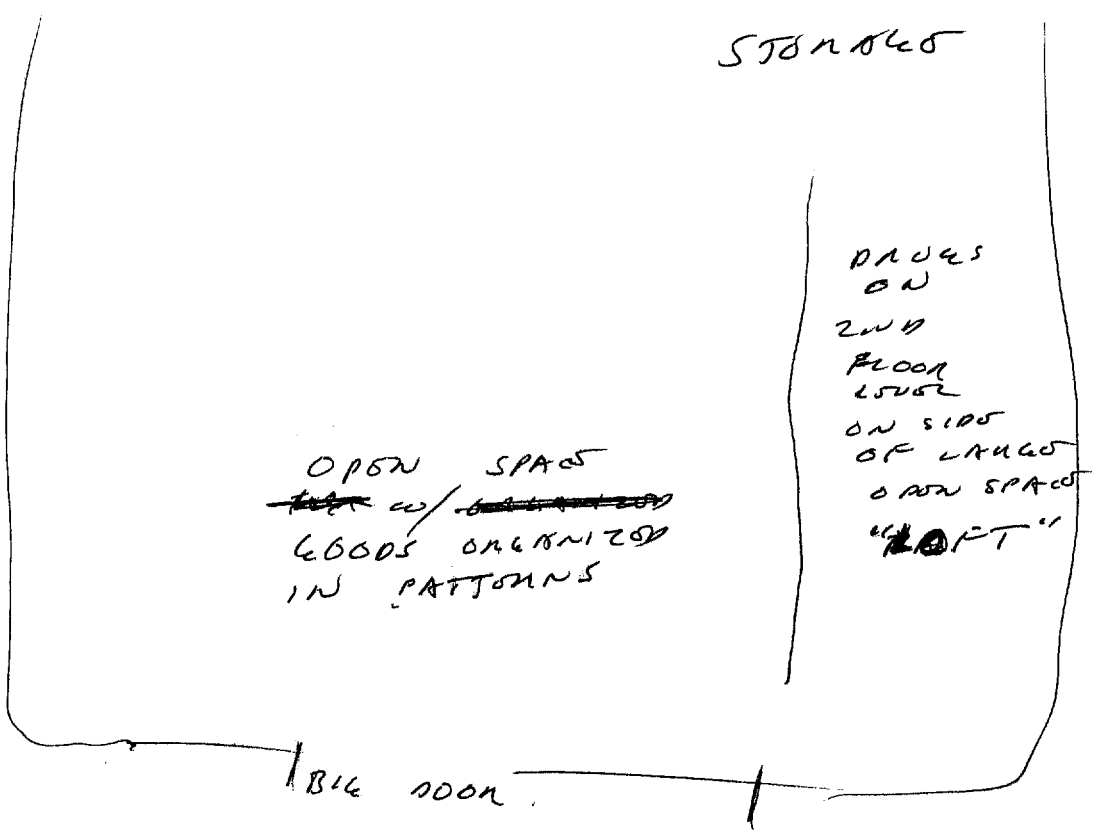

~~see page~~  
ONLY ~~MARK~~ JUAN

ADL THE  
SEEN FROM END  
OF BLDG.

See page 4A  
3

S 6 1/2  
SMALL BOAT (1-2 persons)  
HOLD ABILITY TO STEAL ~~goods~~ IN  
~~goods~~ FROM THE WAREHOUSE; AT  
NIGHT.

5

56: SOS PHOTO, P. 4A

52 D RI ST I AOL A/S

See page 4A  
4

56 1/2 LOADING/UNLOADING FACILITY.  
THERE IS A SPECIM TEMPORARY  
~~SPECIAL~~ HOLDING PLACE UNDERNEATH  
THIS FACILITY FOR LOADING  
CONTRABAND GOODS. (IMPRESSION OF A  
ROOM-TYPE LOCATION) <sup>HIDDEN</sup> AMID THE  
PILINGS.

IMPRESSION THAT THE ONLY SHIPS  
WHICH CAN LOAD <sup>LARGE QUANTITIES</sup> CONTRABAND AT  
THIS LOCATION ARE THOSE WHICH  
DOK RIGHT NEXT TO THIS FACILITY.  
THOSE ARE THE SHIPS ~~TO~~ SUSPECT  
WHEN THEY LOAVE. THOSE WHICH DO  
NOT DOCK NEXT TO THE FACILITY  
WILL NOT HAVE PICKED UP A  
LARGE QUANTITY OF CONTRABAND  
WHILE HERE.

4

HOW MANY STOPS AND <sup>PRESENTLY</sup> IN PORT?

8

A

B

C - DRUGS

FROM SOMEWHERE ELSE, (OF NO CONCERN TO THE PEOPLE HERE)  
(MAY HAVE HOME PORT OF ARUBA)

D

E - DRUGS

("SOLANS") NOW BEING LOADED

F - DRUGS

NOT AT DOCK ("RINCON")  
FUELLATION. BLACK HULL

G  
H

~~MOVING~~ MOVING FROM ONE DOCK POSITION TO ANOTHER, BUT PRESENTLY IN A HOLDING PATTERNS AWAY FROM DOCK NOT YET LOADED.

SZ: "SOLAR (FLAME?)"  
"SOLAR (DRY?)"  
"SOLANE"

(5)

SZ: "RINCON"

SESSION END 1543



6 A  
(taken from  
photo page 4A)

AREA "S" (SEE SB MATRIX, P. 6)

