

Tasker JT4-080-90 (26 Jul 90) SG1A

Target: S/V [REDACTED] 41 foot ketch, fiberglass, white hull, blue SS, two masts.

EEI:

1. What is its location?
2. What activity is it involved in?
3. Is it carrying contraband drugs?
4. Provide any additional information available.

This document is made available through the declassification efforts
and research of John Greenewald, Jr., creator of:

The Black Vault



The Black Vault is the largest online Freedom of Information Act (FOIA) document clearinghouse in the world. The research efforts here are responsible for the declassification of hundreds of thousands of pages released by the U.S. Government & Military.

Discover the Truth at: <http://www.theblackvault.com>

P: 080

26 Jul 90

Summary of to find

The target is ~~now~~ currently located at $23^{\circ} 27' N$ $89^{\circ} 22' W$. The vessel is concerned with evading detection. It is transporting narcotics, which are located in one of two areas. The key to finding the contraband is an area where metal shavings / filings occur. Sense that something has been injected into the center mast and that the mast is considered expendable. It is to be cut in half. The injected material is white and dense. ~~The search area~~

If this is the location of the contraband, metal shavings are found around the ^{deck} base collar of the mast. The search area on the vessel is associated ~~with~~ in the rear ^{part of} the vessel near the engine. ^{A section of the part} The ~~two~~ part of the part side wall of this area has been packed by solid and dense ^{heavy} nylon bags in between the ~~struts~~ struts or ribs. The section containing the packages is very solid. If this is the location, metal shavings will be found at the base of this specific wall section.

Sense that a primary person (a man) on board is not aware what is on board. of what the vessel is actually carrying. A [name] man in Harrisburg PA is associated with this target in some way.

* An attempt had been made to clean up & remove all of the metal filings / shavings. However, remnants have worked themselves out in one of the two ~~at~~ spots.

PT - Mantle fuel
AV - bow of any vessel

00F
JTF-4
26 Jul 90
P:080
00F
0935

900726
90008

Miss BK

900726
900080



A - across, angle down,
angle forward, sharp
angle up, angle down,
angle up.

- semi soft
Mammals

B - structure

AOL BK
Fiberglass hull
Sail boat

A - hard
- mammals

B - structure

AOL BK
Chrome railing

A - motor
air

B - air

AOL BK

Sail (s)

3-masted schooner

AOL BK

KEEL

A -

AI BK

Makes me feel
as if I'm plunged
into deep, cold water

3)
- wampul
B- wood
AOL BK
WOODEN RUDDER

AOL SKETCHES

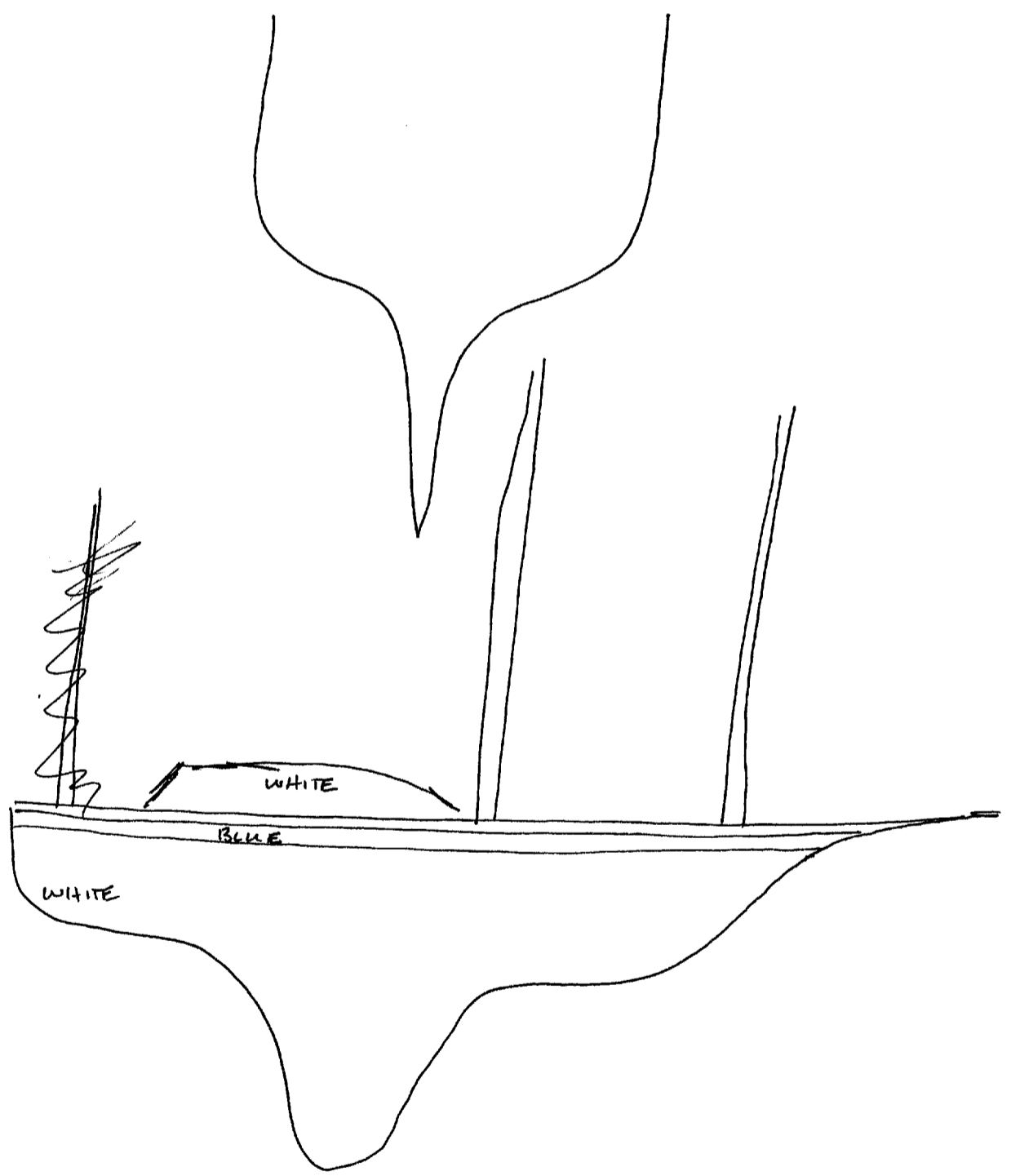

S2
White
Yellow
Green
shiny
hot
bright
red
big
full
flat
curved
deep (see)

AOL BK

N47

yellow smell

AOL BK
Lemons

Dry smell
Woody smell (see)

Coarse
rough
smooth
woven (see)

AOL BK
Canvas sails

Break
0950

52

D

AI

EI

T

I

AOL

A/S

[Location]

AOLBK

23° 27' N

89° 22' W

Metel Sharings

Blue Tuna fish

R

[Activity]

Green

square

wood

A/S

green wood
blocks

AOL

Govt Ammo
Boxes

crisp
crispy
black

Monette, barrel

rubber smell
reddish

engine area
nylon bags

heavy
rectangular

a man eating

D
AT EI T I AOC A/S

(Activity)

Swirling motion

AOC
VORTEX

faint
striped
parallel lines

Ceiling beam

A/S
wooden
deck

loading
detected

AOC
Nice man
in Harrisburg
PA.

scrubbing

Knife

solid

solid walls
packing in between
studs.

54 1/2 Man's not aware of anything.

54 1/2 Jaws that meet in one
of the wrists

white

dens

injected

54 1/2 Jaws that meet,
has been injected into
center part of that part
is cross-hatched expandable.

Cutting in
half

round

angle

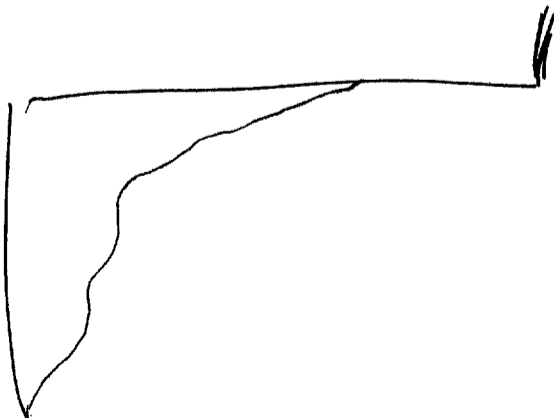

A/S

A/C
Wid globe

Solid

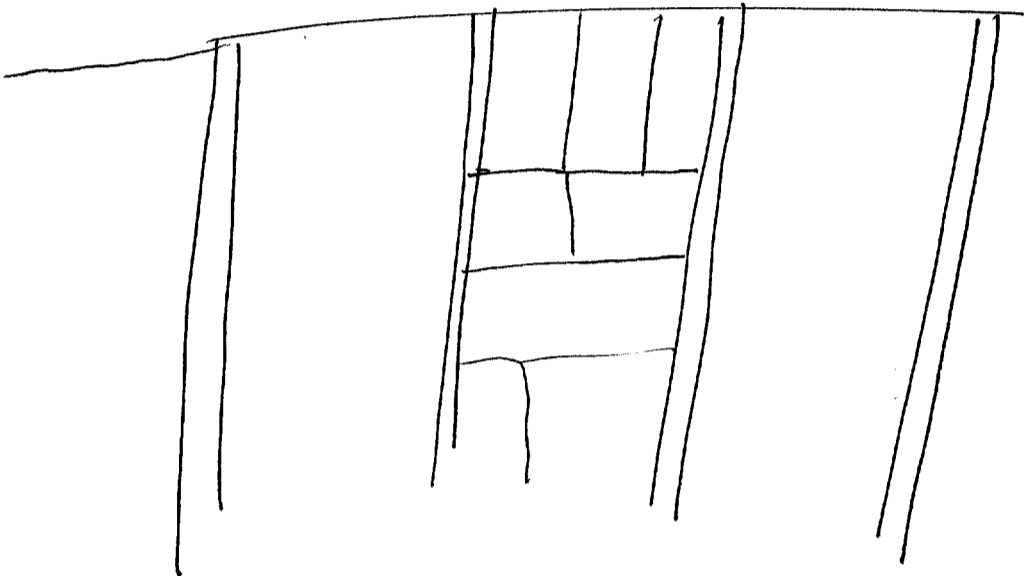

54 1/2 Metal shavings are present near area where something is densely packed.

A/S

Base of mast
Along port
edge of wall
w/ c eng in area

52

9

A/S

5-11/2 ^{Keel} Senses that person on board does not know about what is on board.
 ↑
 one man

5-11/2 Attempt was made to clean up & remove all of the metal filings/shavings; however, there are remnants in one of the two places.

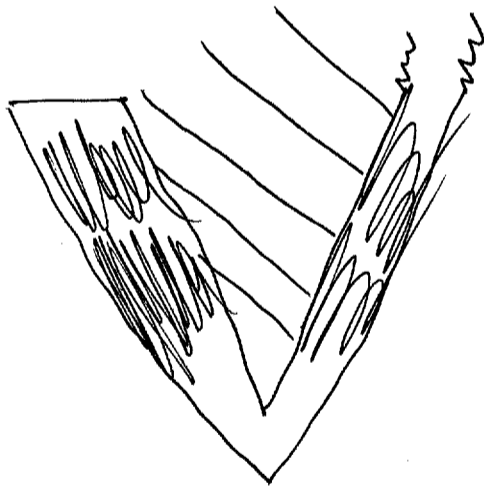

ET 1043