

REMOTE VIEWING SESSION DATA

* Remote Viewer : LB *
* Interviewer : FA *
* Observer(s) : _____ *
* _____ *
* _____ *
* Date : 07/27/85 *
* Starting time : 1303 hours, local *
* Site # : 185 *
* Acquisition by: (CRV) ERV PRV ARV BRV Other _____ *
* Working mode : (GT) HEM Other _____ *
* Feedback class: A B (C) *

067901
550820

* Ending time : 1411 hours, local *
* Notes : PI no AV Box Correns *
* Highest stage : III *
* Evaluation : + _____ *

* Actual site : Cheops' Pyramid *
* RV summary : B7 *
* _____ *
* _____ *

This document is made available through the declassification efforts
and research of John Greenewald, Jr., creator of:

The Black Vault



The Black Vault is the largest online Freedom of Information Act (FOIA)
document clearinghouse in the world. The research efforts here are
responsible for the declassification of hundreds of thousands of pages
released by the U.S. Government & Military.

Discover the Truth at: <http://www.theblackvault.com>

SG1J

FT. MEADE

29 JULY 85
1303 HRS

A.V. -
KEEP GETTING FLASHES
OF "BOXEY" CORNERS ON
SOMETHING.

67901
~~550820~~

A: RISING
CORNER
ROUCH

B: _____

MISS BK.

SZ: R004H

067901
~~550820~~

A: RISING

MISS BK.

067901
~~550820~~

MISS BK.

2

067901
~~550820~~

A: SMOOTH
HAND
CURVED
MANHOLD

B: _____

SZ: BLACK
SHINY
PLURAL
RIBBED
RIDGED
METALLIC FEEL.
WAVY FEELING (TOUCH)

} Ad - DRIVE.

067901
~~550820~~

A: RISING
SMOOTH
HAND
MANHOLD

PL

B: _____

067901
~~550820~~

A: ACROSS
SMOOTH
HAND
CURVED
DOWN
HAND
MANHOLD

CFB.

B: HAND?

3

067901
550820

A: ~~ACROSS~~
BACK
HAND
INNO
MOMMADO

PC.

B: _____

A: ACROSS
HAND
SMOOTH
MOMMADO

B: _____

S2: ~~VERY~~ SMOOTH CFB
STILL, NOT MOVING C

067901
550820

A: RISING
SMOOTH
HAND
MOMMADO

C

B: OBJECT

C

067901
550820

A: RISING
HAND
SMOOTH
MOMMADO

B: _____

A: CURVED
DOWN
INNO
HAND
SMOOTH
MOMMADO

B: _____

NO L BRK.

LIKE A RIDGE OF
KNUCKLES

4

60790

ABOUT

067901

550820

A: RISING
HARD
PLURAL
IMAGE
FLAT
LAYDOWN
UNKNOWN

B:

NOT RISE.
FEELING OF "LOOKING"
AT FAMILIAR SUBJECT
TOO CLOSE TO RECOG.

S2: TEXTURED

LADY

FLAT C

SLATS VASTO CFB

TILTS D

PEOPLE SOUNDS C

SQUEAKING " CFB

CLOSER-IN " "

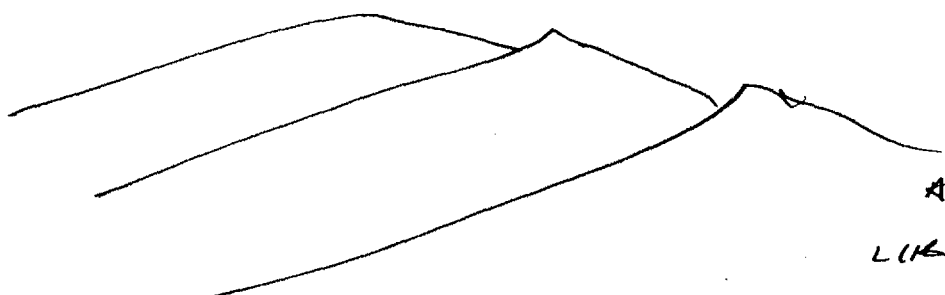

NOT SKETCH
WITH
LIKEA STEPS ON
SHINGLES
CLOSE-UP

(5)

SZ:	WIDE	C
	LOW	PL
	FLAT	CFB
	SHORT	"
	WIDE	PL
	OPEN	C

CONF BNC.
 SOUNDS OF WIDE OPEN
 AREA, w/ PEOPLE SOUNDS,
 BUT SOMEHOW CLOSED IN.
 LIKE MUFFLED FROM WALL.

DARK PLACES C
 SHORT (FRONT TO BACK) CFB
 WIDE C
 LOW
 NOISE ONLY TALK (STRUCTURE?) CFB

M22 BNC.
 WATER CANONS
 IN FT. WORTH.

②

067901
550820

A: RESIN
HARD
MANMADE C
B: STRUCTURE C

AZ: BROWN C
TAN -
DINT TASTE C
? FUNNY TASTE CFB
BRIGHT AREAS
DARK AREAS

ALL BULK.
VISUAL OF LIGHT/DARK
AREAS AS GEOMETRIC
(SQUARES, RECTANGLES)

VERTICAL C
FLAT CFB
BROWN PC
TEXTURED PC

ALL BULK.
TEXTURED LIKE
SANDSTONE.

SMOOTH/FLAT PC
MULTI-LEVELLED C

OPEN C
WATER SMALL N
HUMID FEELING CFB

SURROUNDED BY ~~SOLID~~ DIFFERENT C
RECESS OR CFB

STAIR-STEPED C
ALL BULK
STADIUM.

7

ADL DRIVE
FT. WORTH

PRIMARY

SECONDARY
STAIR-STEPS
LARGE

ARC.
TEXTURED
FLAT
SMOOTH

WIDE ✓

OPEN

GEOMETRIC ✓

SQUARE

TALL ✓

~~THICK~~

~~THICK~~

SLOPED ✓

HEAVY

THICK

SOLID

SITE IS A TALL, WIDE MANMADE, w/ STAIR-STEPS
STRUCTURE, THICK, SOLID CONSTRUCTION, HEAVY,
BROWN IN COLOR, GEOMETRIC IN DESIGN, +
MULTI-LEVELLED. J. J. J.

8

ADL BUK
HOTEL 4 STALL-STORM
PDR.

SL:	BUSBYW	C	
	HEAVY	SPANISH	CFB
	WARM	SPANISH	C
	HUMID	CFB	
	BAND	C	
	ANGLED	C	
	TILTOD	C	
	HAND	C	
	TALL	C	
	SQUARES	C	
	SLOPED	C	
	OLD	C	
	LARGE	C	
	SOLID	C	
	HEAVY	C	
	THICK	C	
	STONE	C	

ADL BUK.
PYRAMIDS.

ADL BUK
PYRAMIDS

ADL BUK.
INCA RUINS.

9

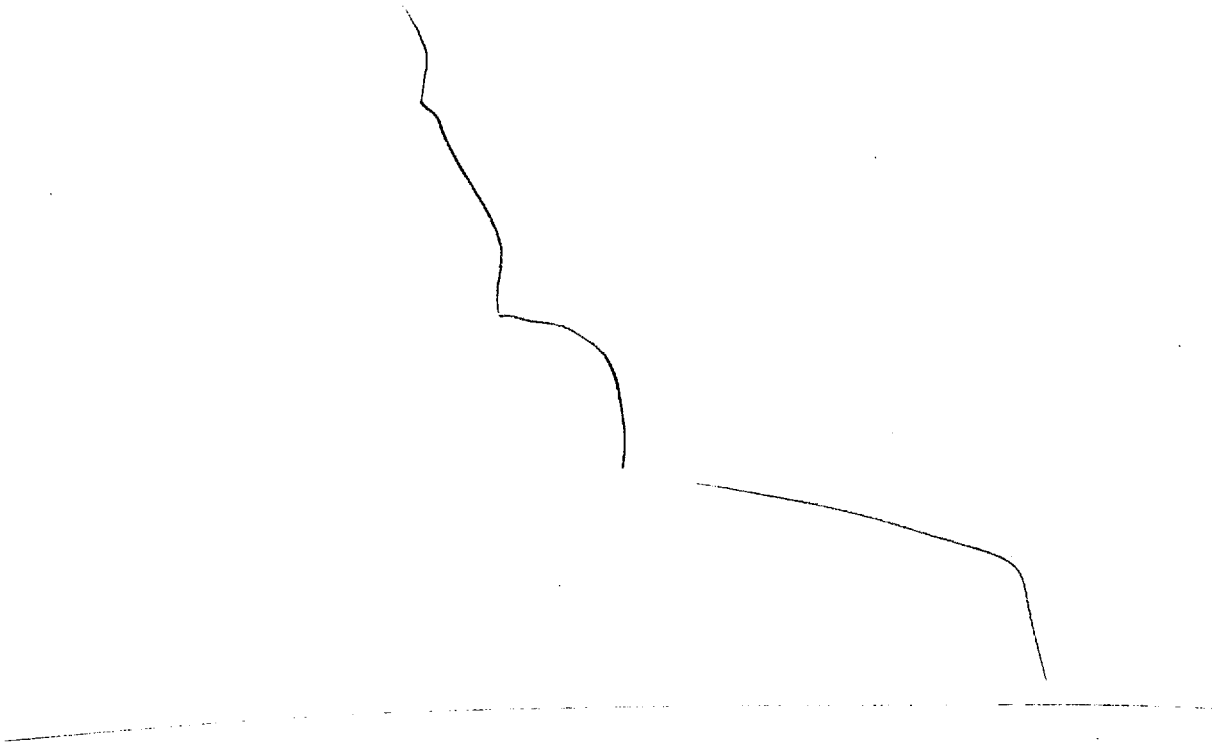

10



11

0185
018
850729

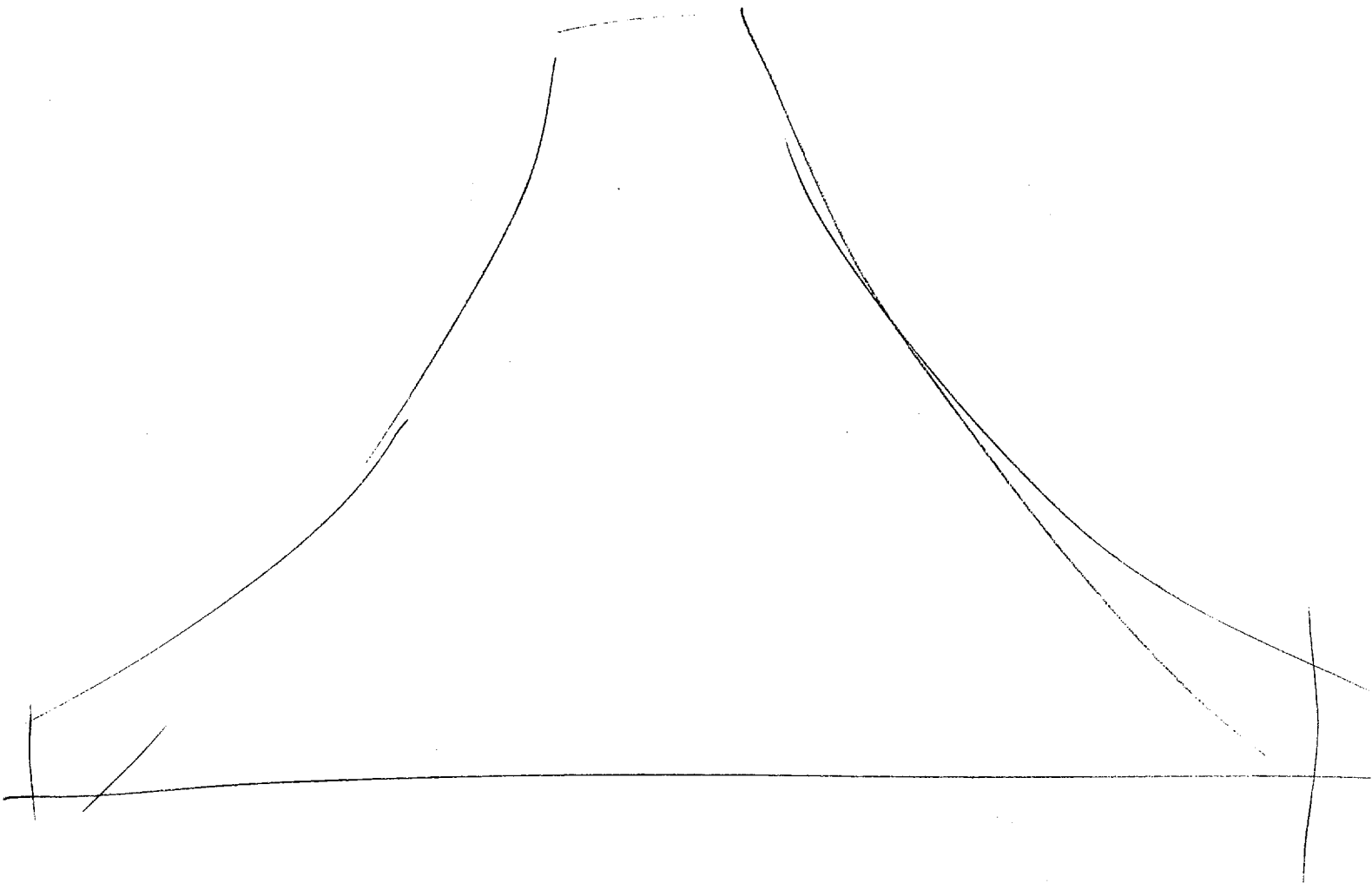

(12)

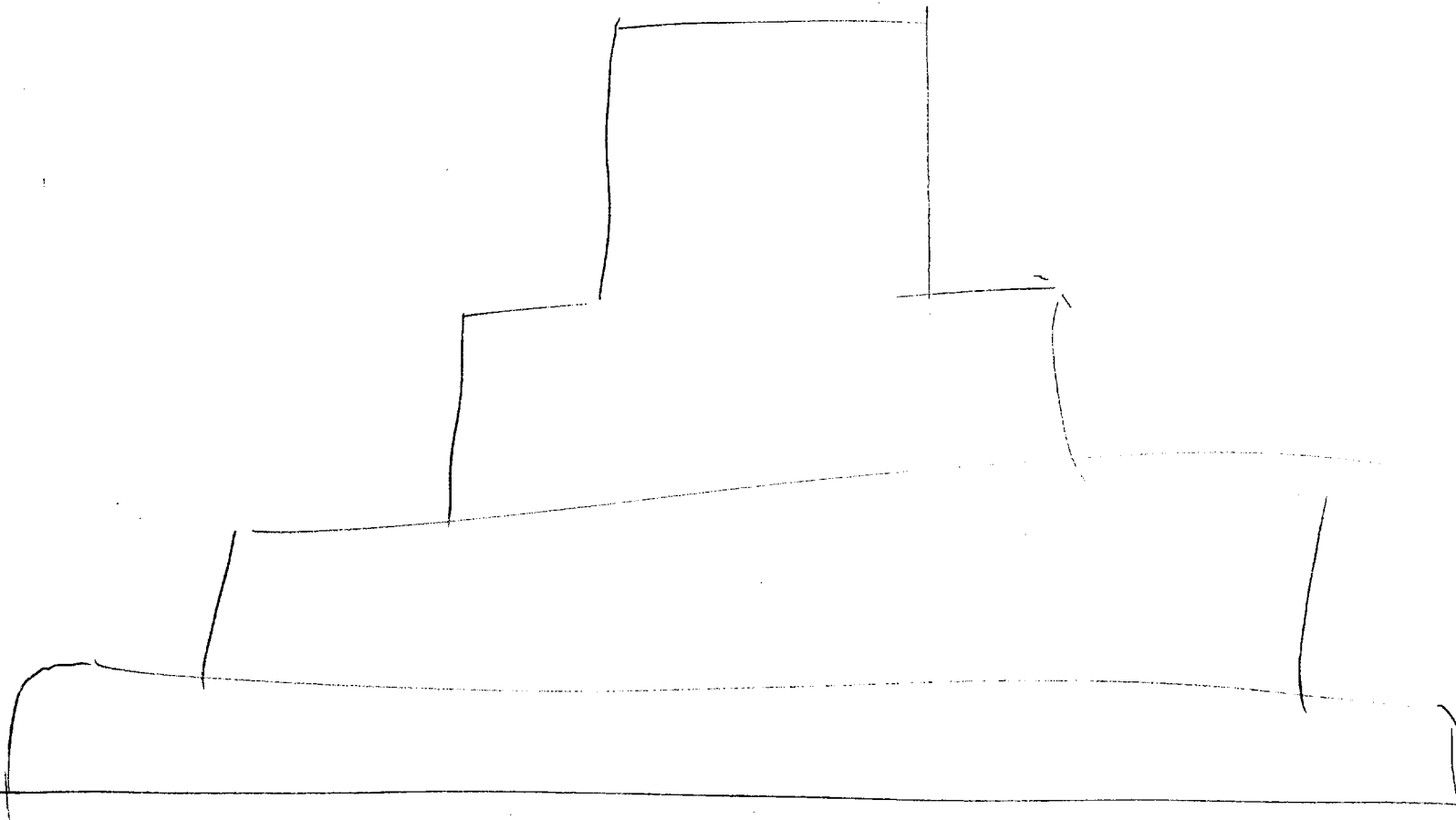

13

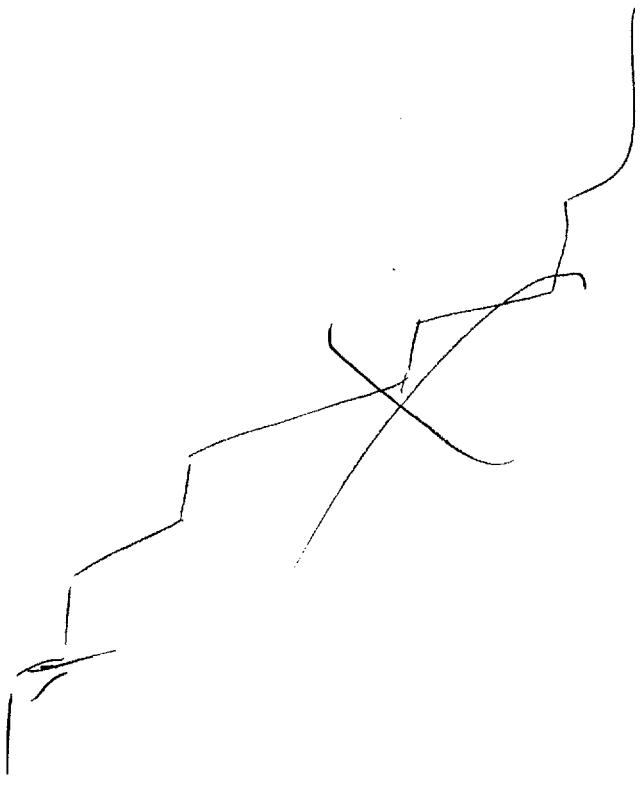

14

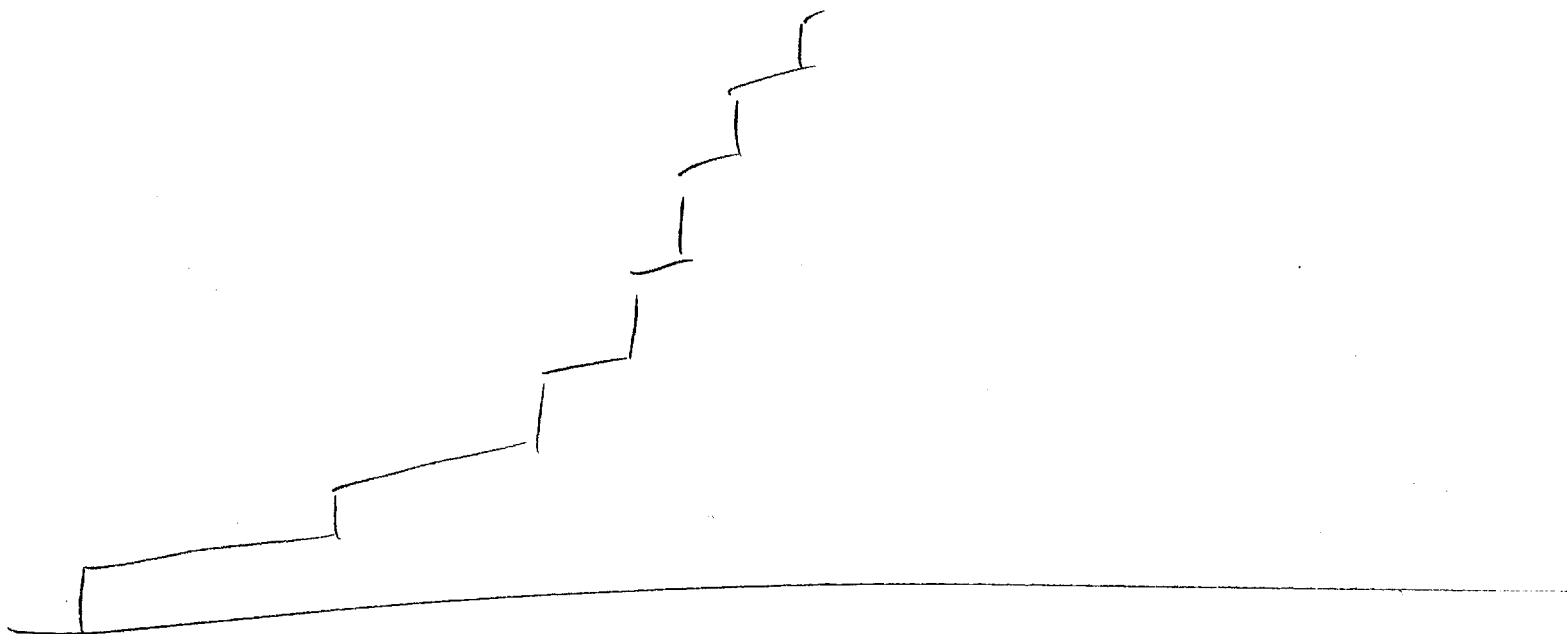

15

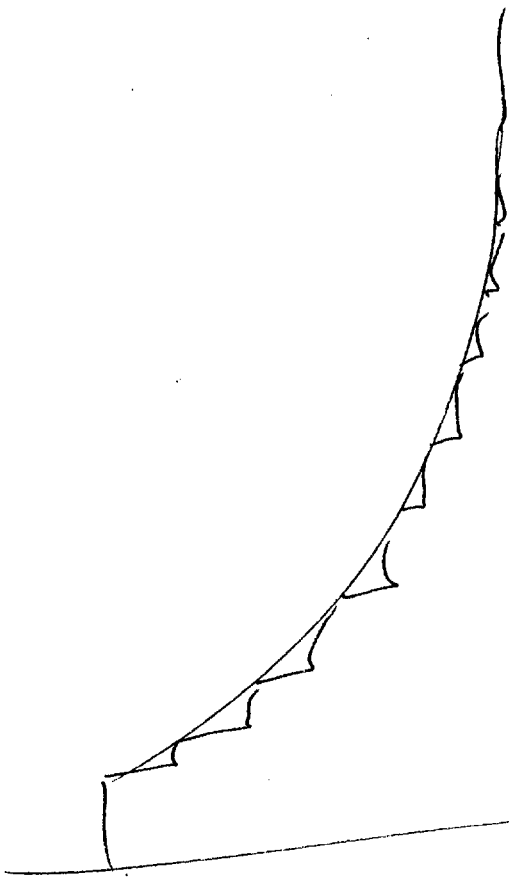

HOL DRIVES
AZTEC OR
SPANISH
HOL DRIVES
BUDDIST TEMPLE

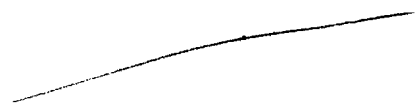
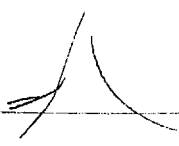

As per
MATTHEW...

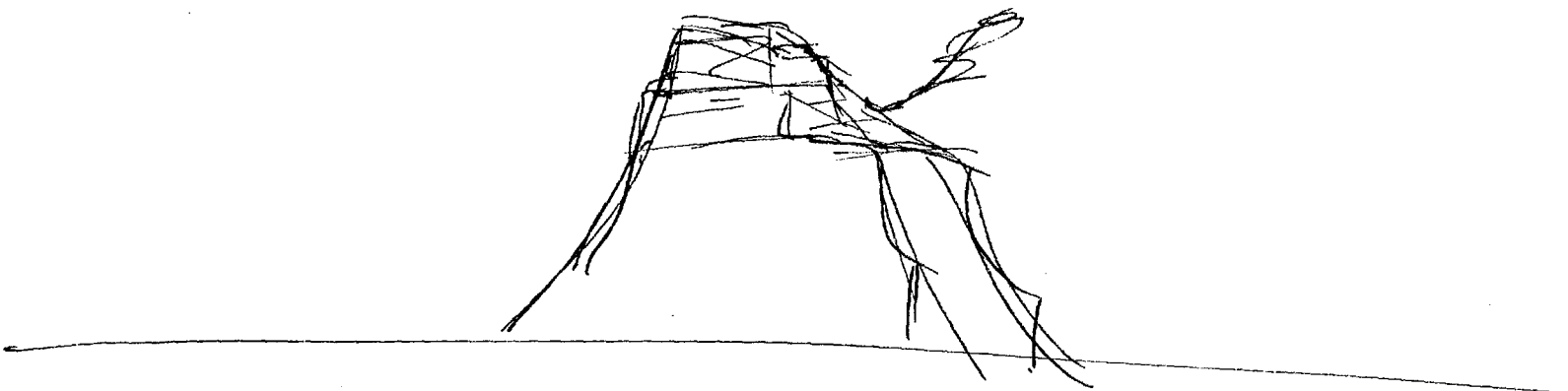

CAMP ONE.
SIDES FEEL DIFFERENT.
FEELS LIKE SHOULD
BE AN "INSIDE ANGLE"
SOMEBODY.

CAMP ONE.
CONFLICTING PROBLEMS.

18

ALL THE
LORDS TOGETHER
OF PISA

ALL THE
CHIEFS PYRAMID.

10

SOME THING
FLYING / IMPORTANT
ABOUT TOP.

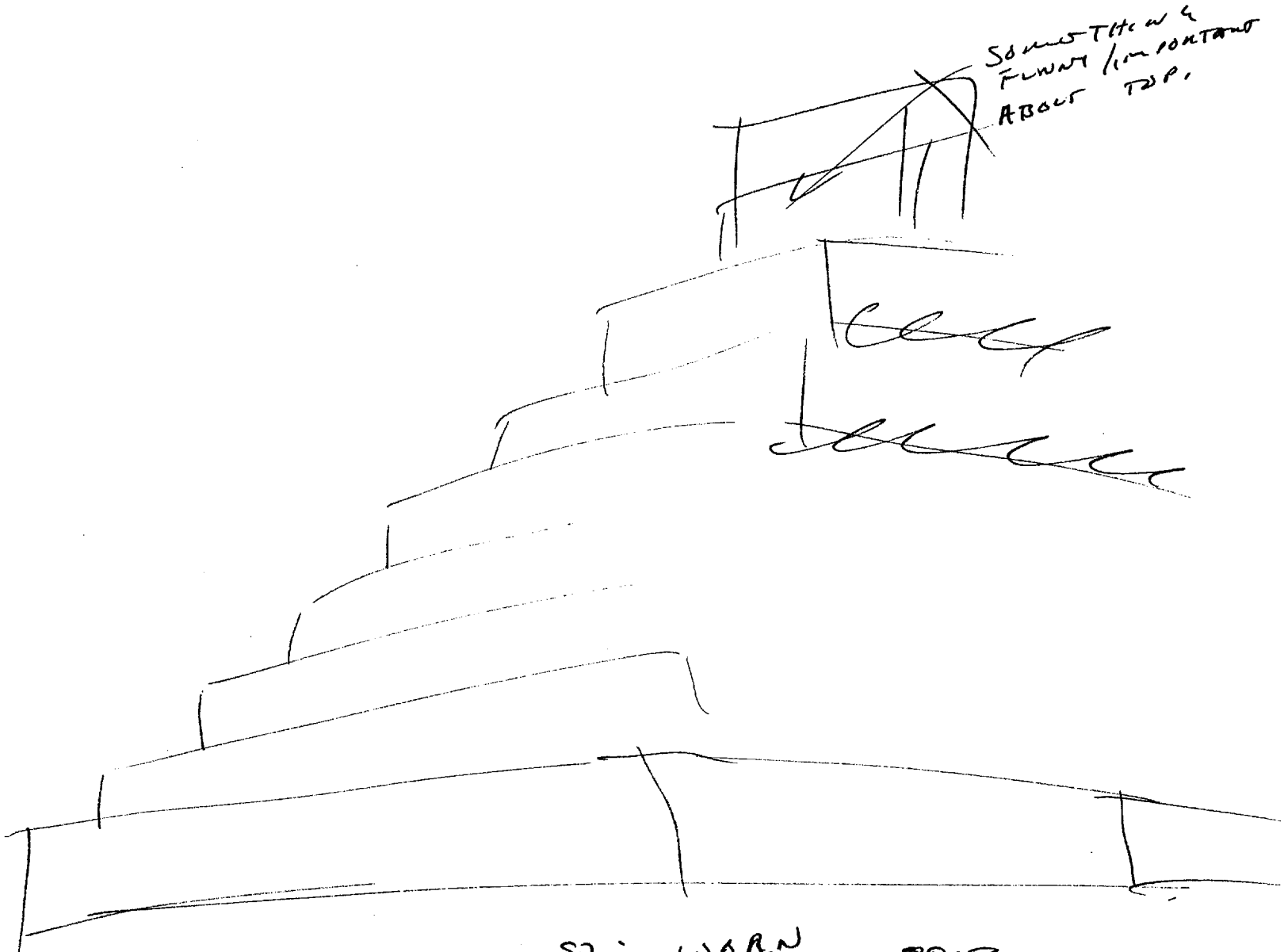

S2: WORN
SNOOD IN SPOTS

AND DRIVES
SNAKE HEADS (AZFOR)

SITS ON

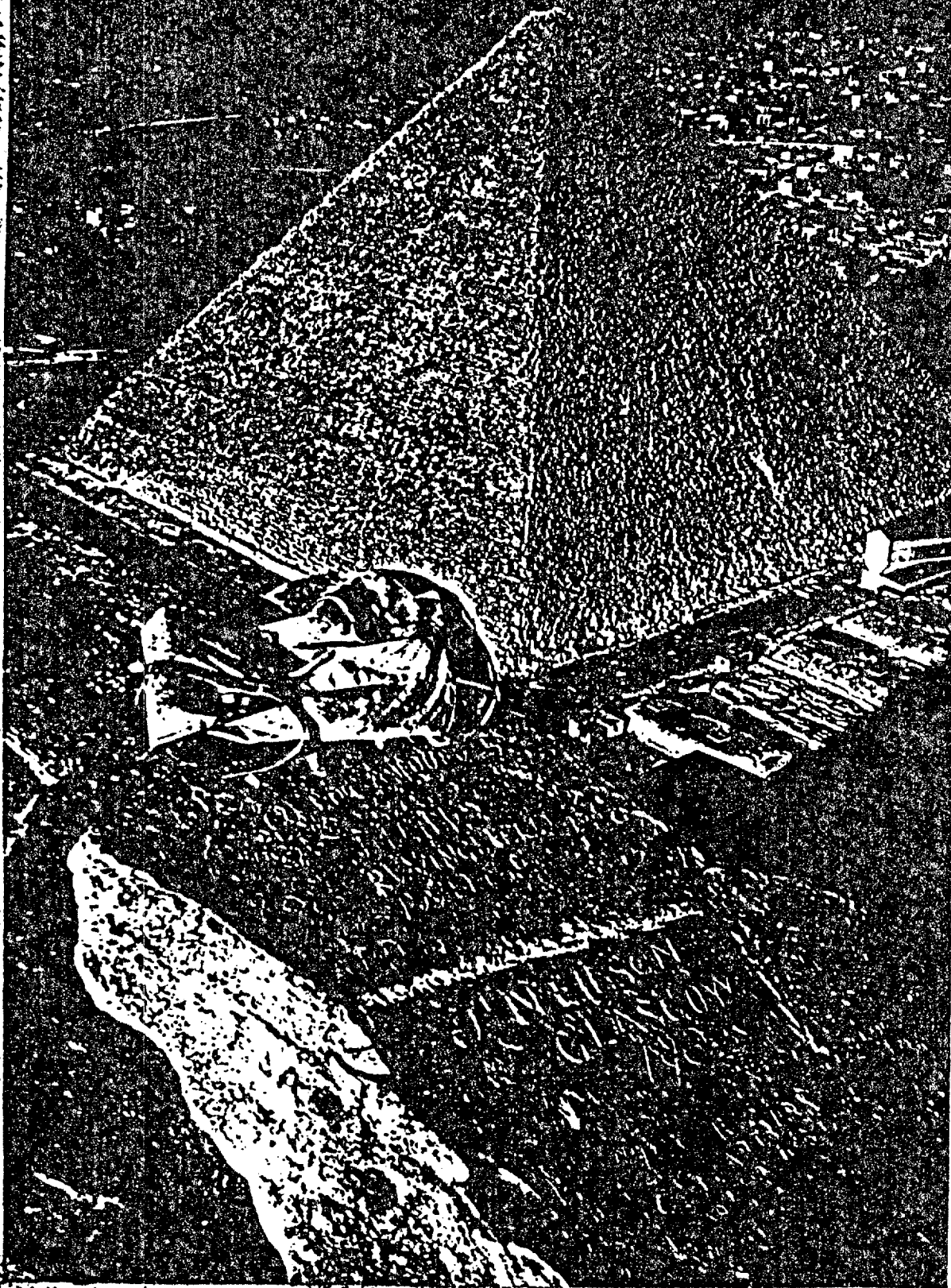

*Cheop's pyramid from summit
of Chephren's pyramid.*