

REMOTE VIEWING TRAINING SESSION

\*\*\*\*\*  
\*  
\*  
\* Remote Viewer : LB  
\*  
\* Interviewer : FA  
\*  
\* Observer(s) : \_\_\_\_\_  
\* \_\_\_\_\_  
\* \_\_\_\_\_  
\*  
\* Date : 02/04/85  
\*  
\* Starting Time : 1300 hours, local  
\*  
\* Site # : 0018  
\*  
\* Site Acquisit.: CRV (CRV ERV PRV ARV BRV Other \_\_\_\_\_)  
\*  
\* Working Mode : GT (GT HE Other \_\_\_\_\_)  
\*  
\* Feedback class: C ( A B C Other \_\_\_\_\_)  
\*  
\*\*\*\*\*

\*\*\*\*\*  
\*  
\* Ending time : 1322 hours, local  
\*  
\* Notes : 41 45'N 87 45'W  
\*  
\* Highest stage : 01  
\*  
\* Evaluation : +  
\*  
\*\*\*\*\*

\*\*\*\*\*  
\* DESCRIPTION OF SITE  
\* Actual : Chicago's front yard, Illinois  
\*  
\* RV summ.: B1=land, B2=land, B3=land (Conf Bk- sense of city nearby)  
\* B4=water-land/water interface, B12=ice, B15=structure, B16=  
\* city  
\*  
\*\*\*\*\*

This document is made available through the declassification efforts  
and research of John Greenewald, Jr., creator of:

# The Black Vault



The Black Vault is the largest online Freedom of Information Act (FOIA) document clearinghouse in the world. The research efforts here are responsible for the declassification of hundreds of thousands of pages released by the U.S. Government & Military.

**Discover the Truth** at: <http://www.theblackvault.com>

4 FEB 85  
1300 HAS  
FT MORRIS  
(FRED)

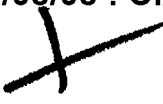

A: RISING  
HARD  
SLOPING DOWN  
LAND

B: MOUNTAIN  
ACROSS BACK  
MOUNTAIN

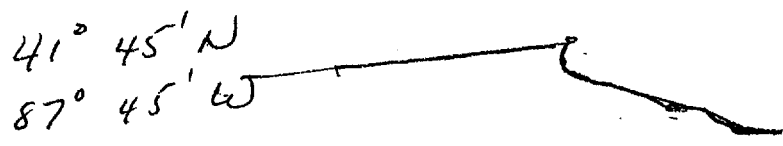

A: FLAT  
RISING  
HARD

B: LAND

A: DROPPING  
ROUGH  
HARD

B: LAND

CONFUSION BROKE  
SENSE OF CITY NEARBY

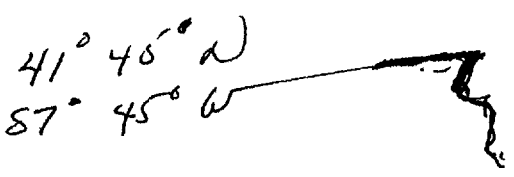

A: FLAT  
ANGLED  
DOWN  
SMOOTH

B: WATER

L/W INTERFACE

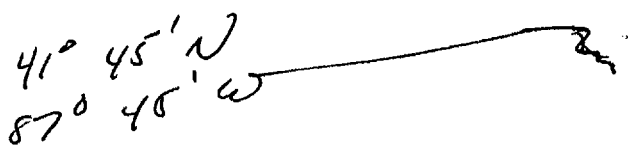

A: ACROSS  
FLAT  
SMOOTH  
HARD

B: LAND

A: CURVING  
ROUGH

WATER  
MOUNTAIN  
B: WATER CFR

41° 45' N  
87° 45' W



A: HARD  
FLAT  
B: LAND

BROOK  
ADL BROOK  
MOUTH OF RIVER

41° 45' N  
87° 45' W



A: FLAT  
HARD  
SMOOTH  
B: WATER C

41° 45' N  
87° 45' W



A: RISING  
HARD  
IRREGULAR  
B: LAND

41° 45' N  
87° 45' W



A: RISING  
ROUGH  
B: HILLSIDE  
MOUNTAIN  
A: SMOOTH  
SLOPING  
B: \_\_\_\_\_

41° 45' N  
87° 45' W

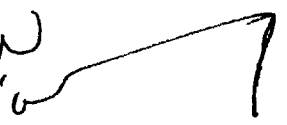

BROOK.  
A: SMOOTH  
ANGLE  
DOWN  
MANHOLE  
B: STRUCTURE PC

(3)

41° 45' N  
87° 45' W

A: FLAT

MISS BREAK

41° 45' N  
87° 45' W

A: FLAT  
STRAIGHT  
HAND  
MOUNTAINS

B: \_\_\_\_\_

ABC BREAK  
AUSDRIP ON ROAD.

41° 45' N  
87° 45' W

A: RISING  
DOWN  
SMOOTH  
MOUNTAINS

B: \_\_\_\_\_

41° 45' N  
87° 45' W



A: RISING  
FLAT  
STRAIGHT  
HAND

B: \_\_\_\_\_

A: FLAT  
HAND  
SMOOTH

B: ICE

A: ROCKY  
HAND

B: LAND

41° 45' N  
87° 45' W

A: RISING  
SMOOTH  
HAND

B: \_\_\_\_\_

AOL BROAD  
FOBLE FAMILIAL

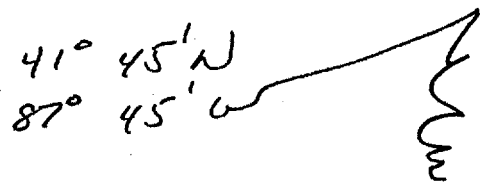

A: DOWN  
MANY  
SMOOTH  
HAND

B: MISS BROAD

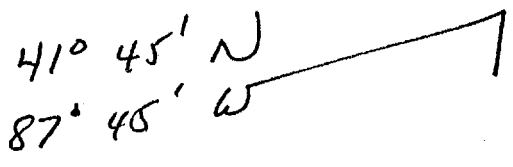

A: DOWN  
ANCO  
DOWN  
HAND  
MANHARD

B: STRUCTURE

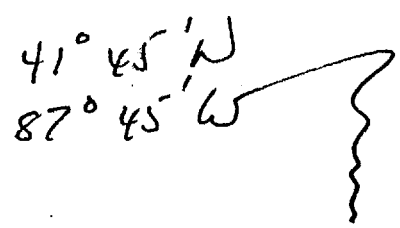

A: ANCO  
DOWN  
MANHARD

B: STRUCTURE

A: \_\_\_\_\_

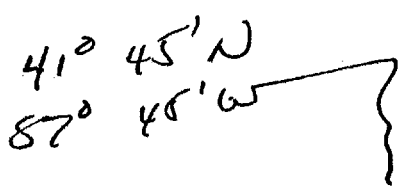

A: EVEN  
MANY  
ROBULON

~~---~~

A: DOWN  
ANCO  
DOWN  
SMOOTH  
HAND  
ROBULON

B: CITY

SITO OND  
1322

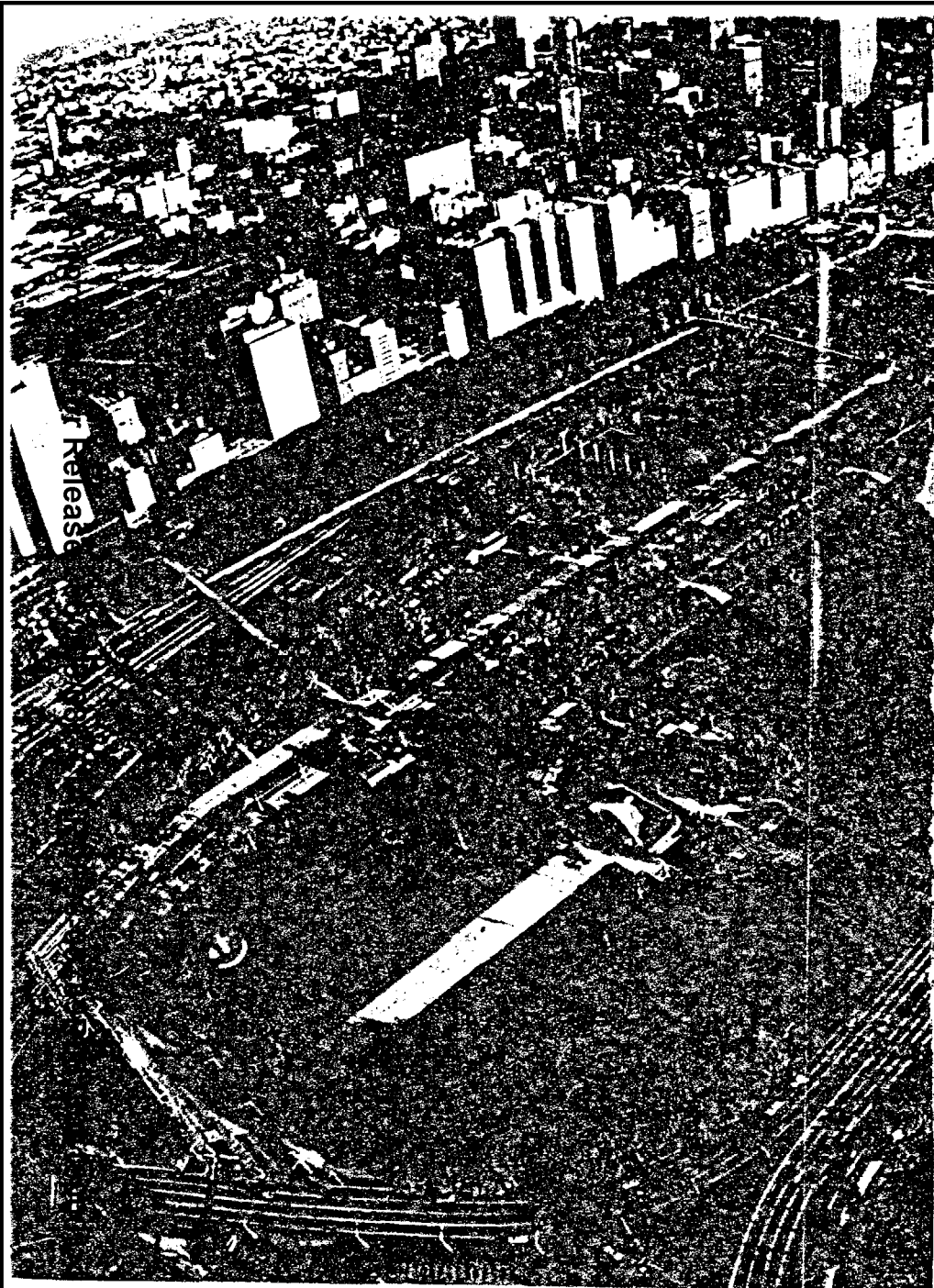

Chicago's "front yard," Grant Park is the centerpiece of the city's 29-mile lakefront and a gracious foreground for a skyline topped out by the 1,454-foot Sears Tower.

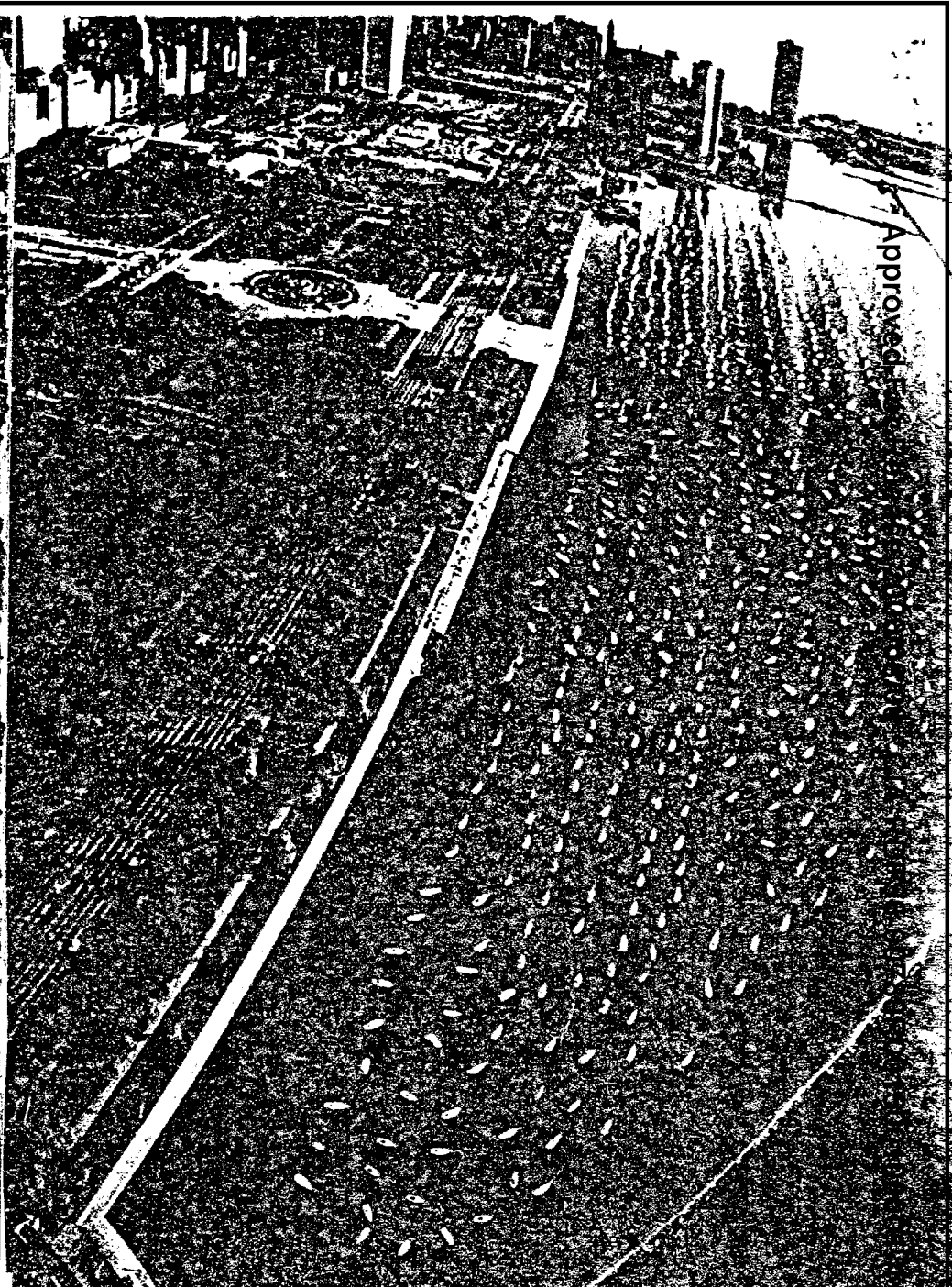

left: center. Dawn wakens the facades of Michigan Avenue, pleasure craft nestle like gulls inside breakwaters that stretch north to the Chicago River's outer lock.

CPYRIGHT

Approved

Release