

PROJECT: 648000/560585

Approved For Release 2000/08/08 : CIA-RDP96-00789R001601240001-7

START: 1305

DATE: 22 DEC 86

SANCTUARY: 1308

SESSION: .01

TARGET: 1312

SOURCE: 079

FINISH: _____

COORDINATE: 648000/560585

FRONTLOAD:

" NEW TARGET. REMEMBER TO LET ME KNOW WHEN YOU ARE IN SANCTUARY. ALSO REMEMBER TO ARRIVE ON TARGET AND INITIALLY "STAND BACK" FROM IT BEFORE MOVING CLOSER AND DESCRIBING ITS COMPONENTS "

* "VERY QUICK SANCTUARY - HYNABASIC VOICE VERY POOR. GAVE FULL 3 MINUTES OF FURTHER RELAXATION BEFORE TRYING TO MOVE INTO HNG STATE BETTER "

NOTES:

- ① FIRST DAY OF WINTER - V30 OUTSIDE
- ② NO KNOWN OR STATED INCLEMENCIES

DRAFT: _____

TYPING: _____

PROOF: _____

CORRECT: _____

OPS: _____

This document is made available through the declassification efforts
and research of John Greenewald, Jr., creator of:

The Black Vault



The Black Vault is the largest online Freedom of Information Act (FOIA) document clearinghouse in the world. The research efforts here are responsible for the declassification of hundreds of thousands of pages released by the U.S. Government & Military.

Discover the Truth at: <http://www.theblackvault.com>

2

TGT #165

→ 648000/560585...

★ Round, circular, massive circle, movement, breezy, hilly, rolling, OPENED AREA, TRIANGULAR,

→ Hilly, rolling

★ OUTSIDE

→ DESCRIBE The area

★ OPEN, OPEN, WINDY, breezy, open area, circular, triangular, ^{L9} Square

→ Circular, describe

★ NOT Hard, moving, windy

→ TRIANGULAR

★ PART OF joined with the square & one circle, massive large, big structure, monumental, people, moving, association with man

→ Square, lg Square

★ Square, structure, sloping, down, setting -

→ Association with a man

★ A man, "still living", movement, man, Hard, I can't focus - can't reach him now - women, working, feminine, women, caring, ending, women taking care of.

→ Pause, Focus now on the ~~structure~~ structure

★ IN A circle, monumental, square, circle, square, Triangular, Big, hard, stony, light, roundness, fencing.

2. () The target was the rustic home of Ulysses S. Grant, the 18th President of the United States. Now restored, the structure lies within a tourist park near St. Louis, MO. A secondary target was the Gateway Arch, a tall curved arch signifying the gateway to the West.

3. () Source began by describing a structure in a breezy, hilly area with a generally open feeling about it. This structure was correctly reported as being "square, sloping, monumental, fenced in by a "short (low)" fence, divided (room? or perhaps the effect of the stacked logs?, and associated with a man". Source further correctly described the purpose of this structure as being someplace to visit to, "look, to wander about," and to view "awards, medals and displays". In a trip back in time, Source correctly associated this structure with an important person who, "wore a blue uniform and was associated with a terrible war (the US Civil War of 1860+).

4. () After being returned to the current time period, Source was "moved" to the secondary target, the Gateway Arch, and correctly identified this site as being, "circular (the curved effect of the Arch or possibly the adjacent sports stadium), dedication, high, overwhelming, modern, two halves exactly like making the whole, a mirrored image (which very accurately describes the actual symmetry of the Arch). Some unrelated descriptives concerning the Arch were insignificant and had little effect on actual target recognition.

5. () Based on the very concise descriptives given by Source there can be no doubt that she was able to successfully acquire the proper sites and accurately describe the major components of the targets in such a manner that an analyst (or the Interviewer) would have no difficulty in correlating these perceptions to the actual target.

EVALUATION: { 6 }

SG1J

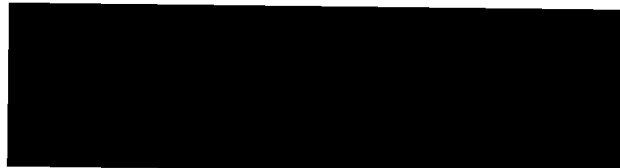

GS-12, DAC
Interviewer

113

- Describe the fencing
- ★ rounded, short, short fencing, rounded, division, divided, DIVISIONAL.
- Purpose of the structure
- ★ To look at, to wander, to think
- Pause - move inside the structure
- ★ woman, medals, olympian
- olympian, Row Data Analytic, medals describe
- ★ gold, bronze, awarding, celebrating, drinking, displaying, displays, significant, achieving -
- move outside, describe the age of this building
- ★ I don't know - not old - many important, not old feeling of work, feeling of working, testing, establishment, quiet, feeling of working -
- Pause; focus the structure - now area around the structure
- ★ structure big, alone, by itself, open areas around - people, walking, moving -
- Pause again - listen carefully - focus on the structure
- ★ 22 Dec 1986 - 60 BAK 110 year to 1876 - people holding hands, forming circles, dancing around - light in middle of circle, happiness, celebrating
- 22 Dec 1876 - Describe the man

4

- ★ Scientific, researching, looking for, proving that, pondering, wondering - tired, other people happy. Man, researching, alone, inside, small area,
- Pause again - focus while I speak - move back 15 more 1861 - Describe the man
- ★ Boom boom, weapons, weapons - warring - remembering, Blue, Blue, Blue, Military Association - Blue, Crossing of weaponry, keeping, keeping, remembering, war - Uniform is Blue - military -
- Pause stop reporting - Return to 22 Dec 1946 - at the structure - move 14.8 km N.E. Describe it - Today's date,
- ★ man, pointed, decorative, dressed - dressed - ~~director~~,
- Pause - move 14.8 km from the original site use today's date
- ★ circular, rounds, dedication, blocks, forming, rounded, creating - image - layered, blocks - High - layering - Triangle on top of triangle - Gold - pretty - overwhelming - layering, building - steps -
- Pause Describe this thing that interest me
- ★ Big, gold, structure, different, so different - modern, two halves separate parts, exactly alike, mirror image -
- Pause - - Return - To original -
- return to sanctuary -

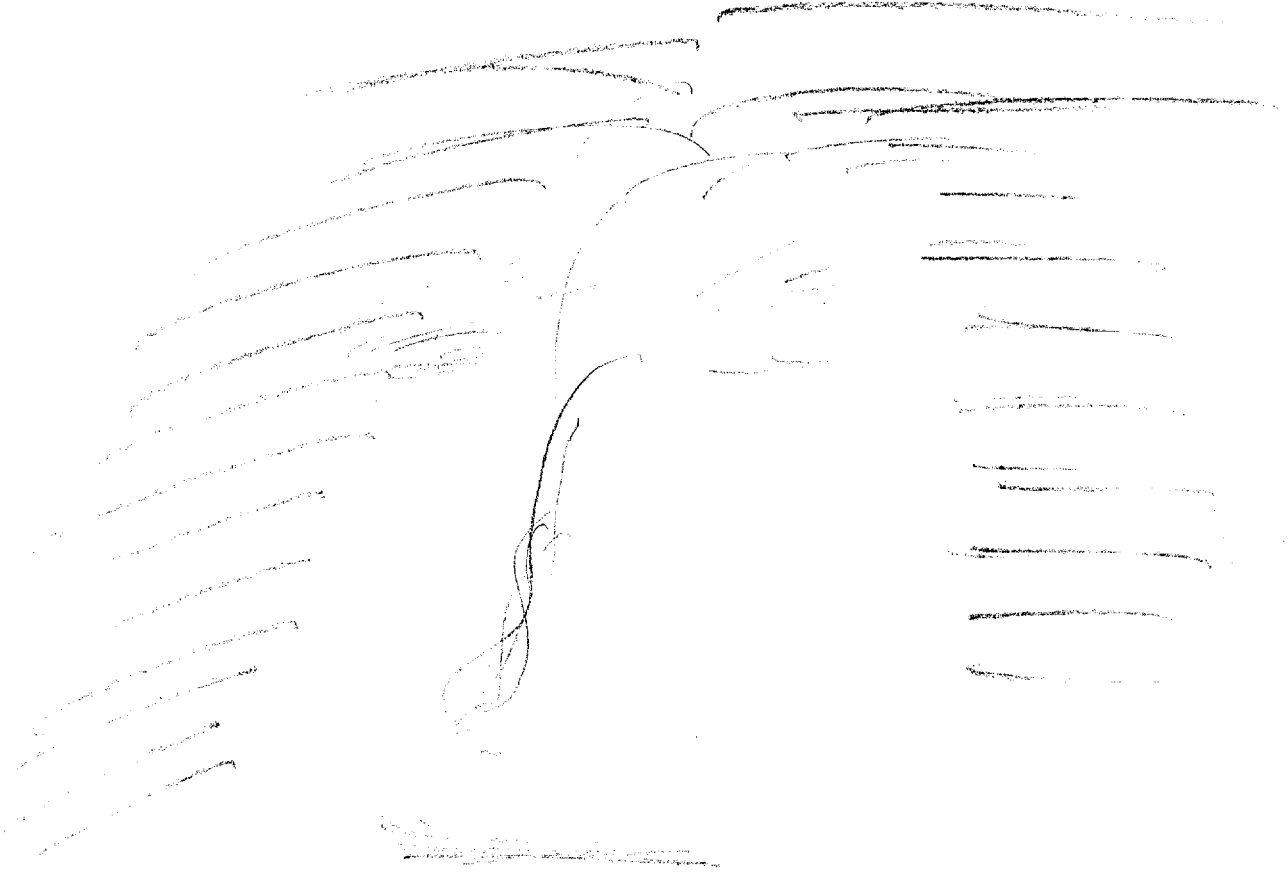

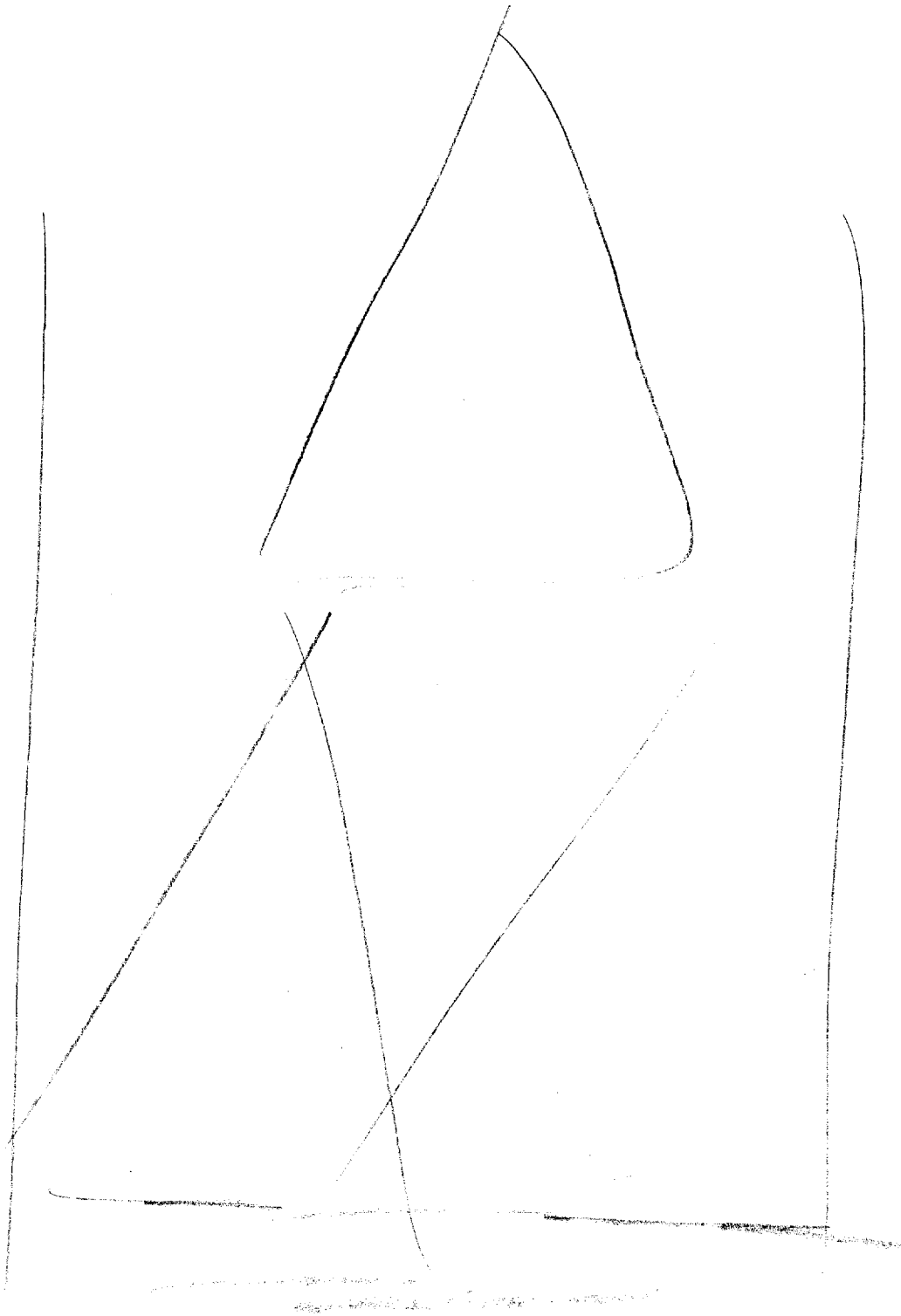

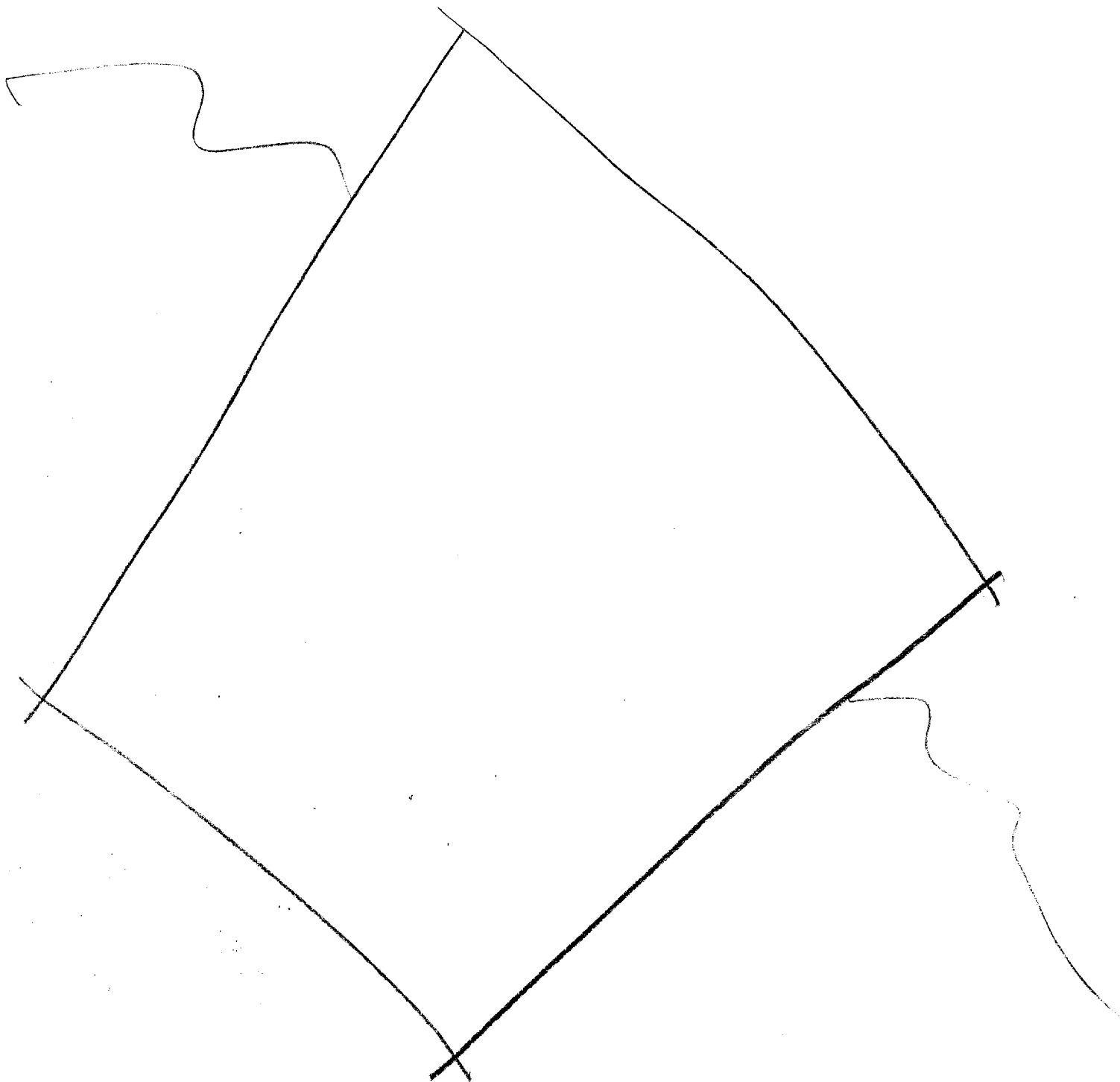

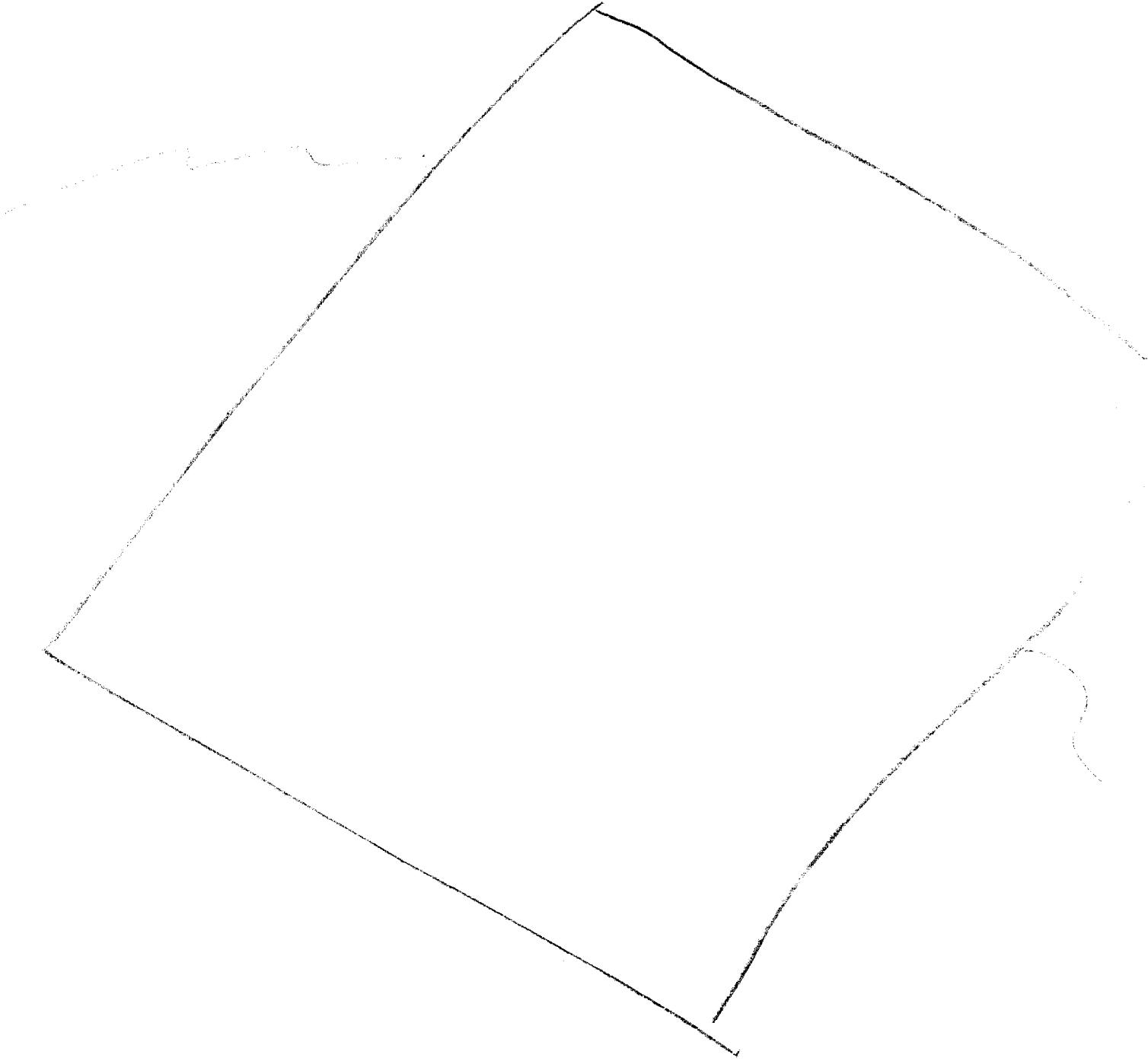

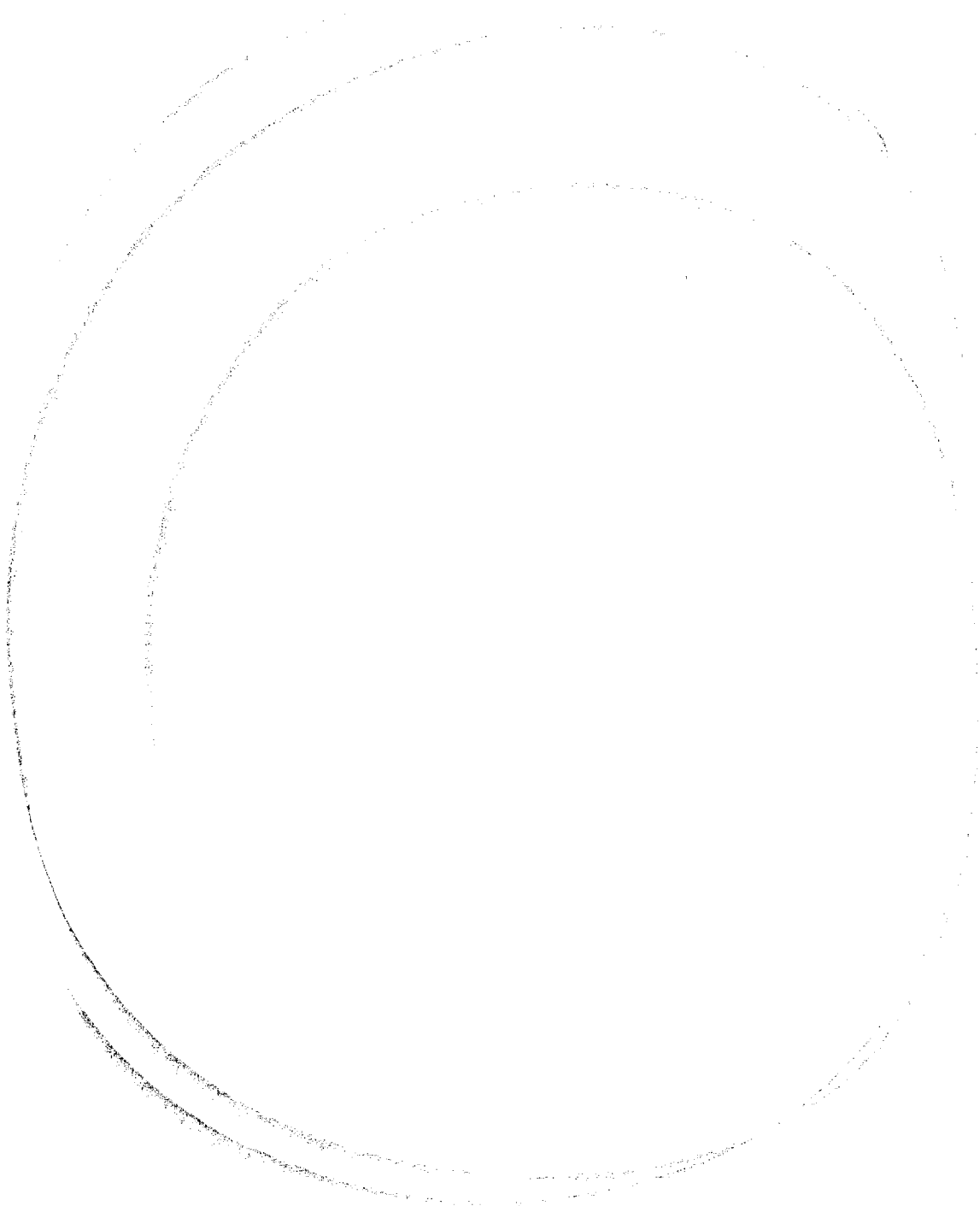





OLYMPIAN.

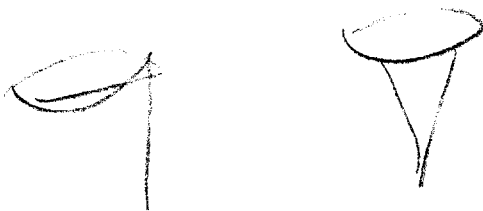

100 yrs ago

100 yrs ago

I first sensed that I was in an opened area. I sensed a circular movement. I sensed a large square on the ground stopping down or slanting down. I felt the structure was not old. I sensed women working in the structure and I sensed awards on display in the structure. I had a feeling of people working. I sensed that a man was somehow associated with this building. I also sensed a fencing of some sort. Not high, but short fencing.

When I went back 100 years, I sensed the man was alone in a small, closed area thinking, pondering, wondering and working and researching. I sensed people were happy and celebrating as they danced around a flame.

When I went back 125 years, I had a sense of a war and sensed weaponry & a blue uniform. I did not know if the man was in the war or if these were given to him or if they were souvenirs of his.

When back in this time, I was asked to move NE and I noted another structure which was new and had a layering effect. I sensed this structure had 2 halves alike and I sensed mirror imagery.