

OBJECT: ALBAN BIRN

Approved For Release 2000/08/08 : CIA-RDP96-00789R001601330001-7

START: 1308

DATE: 9 FEB 87

SANCTUARY: 1310

SESSION: 01

TARGET: 1313

SOURCE: 079

FINISH: 1405

COORDINATE: 774811/341001

FRONTLOAD:

" A NEW TARGET SO GIVE IT YOUR BEST "

NOTES:

- ① NO KNOWN OR STATED IN INCLEMENCIES
- ② WINDY, BURSTING DAY, TEMPS AT 40° BUT SEEMS COLDER DUE TO WIND, SOME FLURRIES OF SNOW

DRAFT: \_\_\_\_\_

TYPING: \_\_\_\_\_

PROOF: \_\_\_\_\_

CORRECT: \_\_\_\_\_

This document is made available through the declassification efforts  
and research of John Greenewald, Jr., creator of:

# The Black Vault



The Black Vault is the largest online Freedom of Information Act (FOIA)  
document clearinghouse in the world. The research efforts here are  
responsible for the declassification of hundreds of thousands of pages  
released by the U.S. Government & Military.

**Discover the Truth** at: <http://www.theblackvault.com>

2. (S/NF/SK) The target was Westminster Burying Grounds, Baltimore, Maryland. This quaint cemetery with its associated century old stone chapel and rectories is the final resting place for numerous Civil War military and civilian dignitaries. Perhaps most notably the great American author of the macabre, Edgar Allan Poe is interred at this site. Many of the ornate headstones bear historic eulogies and are reminiscent of a time past when the art of the tombstone was as important an artform as museum class items.

3. (S/NF/SK) Initially Source had little trouble acquiring what is believed to be the proper site and descriptives such as, "pieces cut out in designs, little, big, jutting, placed (position), fragmented", seemed to be references to the varying shapes of the headstones. Then an "unfortunate" incident occurred when Source, apparently seeking items of interest, "entered" a, "opening, long, slender, low to the ground, I can't stand up, I'm entering on my stomach, dirty, not for people to use but it's manmade, cold, dark, damp, dirty, only I can go in, I can't sit up, it sits in a wooded area..." Following this series of descriptives, Source had a very difficult time staying on target and tended to digress to describing individuals with somewhat unusual characteristics reminiscent of primitive natives, i.e. "men, harsh men, regimented, wear(ing) something around his neck, barbaric, primitive, takes nourishment from the woods..." These individuals were all associated with the concept of a large group of people "sleeping together in a large room", in cold, harsh, dark surroundings. Other concepts dealt with water images and people working around the water which may have been a description of the nearby Baltimore Harbor. In both cases, the data following the entry into the dark chamber, (believed to be a crypt or casket), was caused by trauma of actually being in a crypt and the subsequent avoidance mechanism to either stay away from the site or to report on the presence of corpses in more traumatically acceptable terms, i.e. "sleeping men in one area". In any case, the data provided was nevertheless very important in that it provided an indicator of this Source's methodology in handling the presence of death.

SGFOIA3

EVALUATION: { 6 }

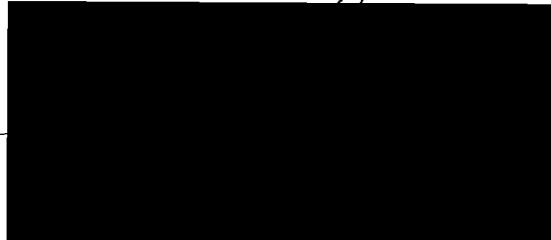

PAGE 2

→ 774 811 / 341001

★ CIRCLES, OVERLAPPING CIRCLES, ROUND MOVEMENT, CUTTING, MOVEMENTS, WATER NEARBY, NOT DEEP, LARGE LIGHTING, OVERLAPPING, DENSE, THICK, COVERINGS, OUTERS, CROSSING OVER, PIECES CUT UP, PEOPLE, MOVING BACK AND FORTH, MOVING ON PURPOSE, THINKING ABOUT THEIR MOVEMENTS, ANIMALS, PEOPLE MOVING DOWN, VERY CIRCULAR, CIRCLES JOINED, CONNECTING EACH OTHER, MASSIVE, THICK, PIECES CUT-OUT, ART

→ ART RAW DATA

★ PIECES CUT OUT IN DESIGNS, LITTLE, BIG, JUTTED INSIDE, PLACES IN, PLACED OUT, PUZZLING, LITTLE PIECES, BIG PIECES, FRAGMENTED, NOT FILLED IN, WINDY, ANIMALS HERE AND THERE BUT NOT IMPORTANT, FLYING, SOMETHING FLYING, VERY NEAR, UP CLOSE,

→ VERY NEAR RAW DATA

★ NEAR AN OPENING, LONG SLINDER OPENING, LOW TO GROUND, I CAN'T STAND UP, I'M ENTERING ON MY STOMACH, I CAN'T STAND UP DIRTY

→ TELL ME ABOUT THIS THING YOU ARE ENTERING

★ SQUARE, ROUNDED, DIRTY, IN AND OUT, OPENINGS, DIRTY

→ DESCRIBE YOUR IMPRESSIONS INSIDE THIS THING

★ DARK, COLD, DAMP, DARK, ONLY I CAN GO IN, BECAUSE IT'S NOT FOR PEOPLE, I CAN'T SIT UP, NOT FOR PEOPLE TO USE BUT IT'S MAN MADE. IT SITS IN AN AREA, WOODED, COLD, NOT ANY OTHER BUILDINGS, A WOODED AREA.

- FEEL THE INSIDE OF THIS THING
- ★ Hard, ice cold, squares, white, dome shape, very low  
not a good feeling, water, people in water, submerged  
in water, climbing, climb to get out of water,  
exploring, terrible work, always cold
- Continue to describe this area
- ★ green, green water, people climbing out of water,  
not for pleasure, discovering, a job to do, fish,  
The area, The water is larger, map
- You need to move back to the target that interests me
- ★ LIGHTER, light shooting out, The sun coming down,  
light over water, A wooded area, not for entertaining  
but for working, in water, heavy, heavy, heaviness-
- TELL ME ABOUT THE PLACE THAT INTERESTS ME
- ★ THICK, dense, twiling, overlapping, Thick dense, people  
involved, people sleeping, very hard conditions
- Hard conditions
- ★ NOT comfortable, sleeping together, regimented,  
sleeping at one time, strict
- TELL ME ABOUT THE AREA
- ★ ITS cold, dependency on each other, hard to get  
into and out of - Hard to make contact, very isolated -  
very isolated
- Find the place where the people are sleeping

4

- ★ Very big, cold, hard beds, They all sleep at one time because they have to, rules to live by, men, men, harsh men, empty, nothing hanging, echoing, hard floors, large and empty just for the purpose of sleeping -
- Find one of the persons who are sleeping
- ★ He's young, healthy, healthiness, well being, so tired now that you sleep - not bad, not good, no privacy, young, people sleep with their clothes on -
- Thank this person. Another person is sleeping who interest me Find him,
- ★ His older, he has something funny in his ears, ~~he's~~ he's listening, he is listening to outside - I'm taking the things out of his ears - he is older, he forgets things, he's funny, others laugh at him - he knows it, but he is happy, he is needed, he's over the other people, not in charge a little older
- Pause - Breath deep and relax - Find the person who is sleeping that interests me - tell me about this person -
- ★ Tall, slender, wears something around his neck, no shirt, thickness to him - a thinner man walks up to him, This man is older, a redness to him, rugged, hard worker, barbaric, primitive, loner, always alone, difficulty in communicating with others, always alone, he eats from the woods, nourishment from the woods - red is important - Gold & red are important - He was captured, he is different than the others, not civilized, the others are
- The others

5  
—

- ★ They wear clothes, They eat from inside - he is primitive, The others aren't, failing, failing, failing -
- Pause - IT IS NOW 9 FEB 87 - at another time someone here at this place was important to me Go to that time and describe that person -
- ★ Freedom, richness, water was cleaner, ~~from~~ man running, lighty, looking down over, looking at
- Wrong, This is not me, is not the person I am interested in, Go to the person I am interested in
- ★ He is wearing white, a white cloth draped over his body, teacher, taking the lead, talking to others in large group, he is shaking something in his hands, big man, sitting among others, but rising above others,
- Pause - stop reporting - 774811/341001 - Go to that area today - 9 FEB 87, describe that area
- ★ Circular, near water, dense, massive, windy, people, circle, bouncing, flying, clean water, Thick, a man, Big, heavy man, only parts of him, I can only see parts of him, he doesn't talk, he hides, quiet man, he won't talk, he won't give away, he won't go - doesn't talk to me others, doesn't have any clothes on -
- Leave this man - He does not interest me - tell me about the area
- ★ animals, scattered, crosses, crossing, its an open area, isolated, water, circles, 11m outside and its cold, boating - hunting, hard living, hard to live There - trees tall trees, circular affect, mounds, in the circle There is like a cutting

6

→ cutting is raw data

★ smoothness, but parts are taken out, almost perfect -  
ITS so circular I feel dizzy, bouncy, light, jumpy,

→ Sleeping people, tell me about them

★ Yes, Yes, laughing, a group, men, working, eating,  
sleeping, sleep, sleep, sleep in large cold room, hard,  
with... plain, plain - sleeping over each other -  
One piled on another -

→ Return now to your sanctuary



I felt ~~area~~ circles on top of circles, overlapping, overlaying, overlapping. I felt I was outside in a cold-wooded area. I felt animals scattered. I then felt I came upon water. In the wooded area, I came upon a man-made structure built low to the ground, with a domed entrance & I entered it on my stomach. I could not stand or sit in this structure. It felt. It was cold & damp & dark inside.

As I came to the water, I sensed people worked in the water. I sensed fish. But the water was not deep. It was green.

I kept getting the circle feeling & I felt like I was looking at a jigsaw puzzle. I felt that pieces were cut out. I then felt I was taking at art.

Then I sensed people. These people had to watch their movements, whatever work they did, they watched movements, they could not just ordinarily walk.

Then I sensed people - men, rugged men sleeping in a large room that ~~was~~ had nothing in it but beds, not a cozy room. I sensed that a group of people - men - ate, slept, & worked together.

I sensed one man had something in his ears. I sensed another man ~~was~~ walking up to a big, thick, naked

man. This man was a ~~to~~ from  
the ~~tree~~ trees. Primitive.

I then sensed a bumpy,  
jumpy feeling.

~~Coming back~~ Then I sensed  
sailing. I also felt  
something flying.

Coming back in time, the  
area was much cleaner,  
much brighter, much greener.

I sensed people. But I  
was not correct.

Coming back, I sensed  
sailing, hunting,

I kept seeing a  
big thick ~~no~~ naked  
man or felt the  
presence of one.

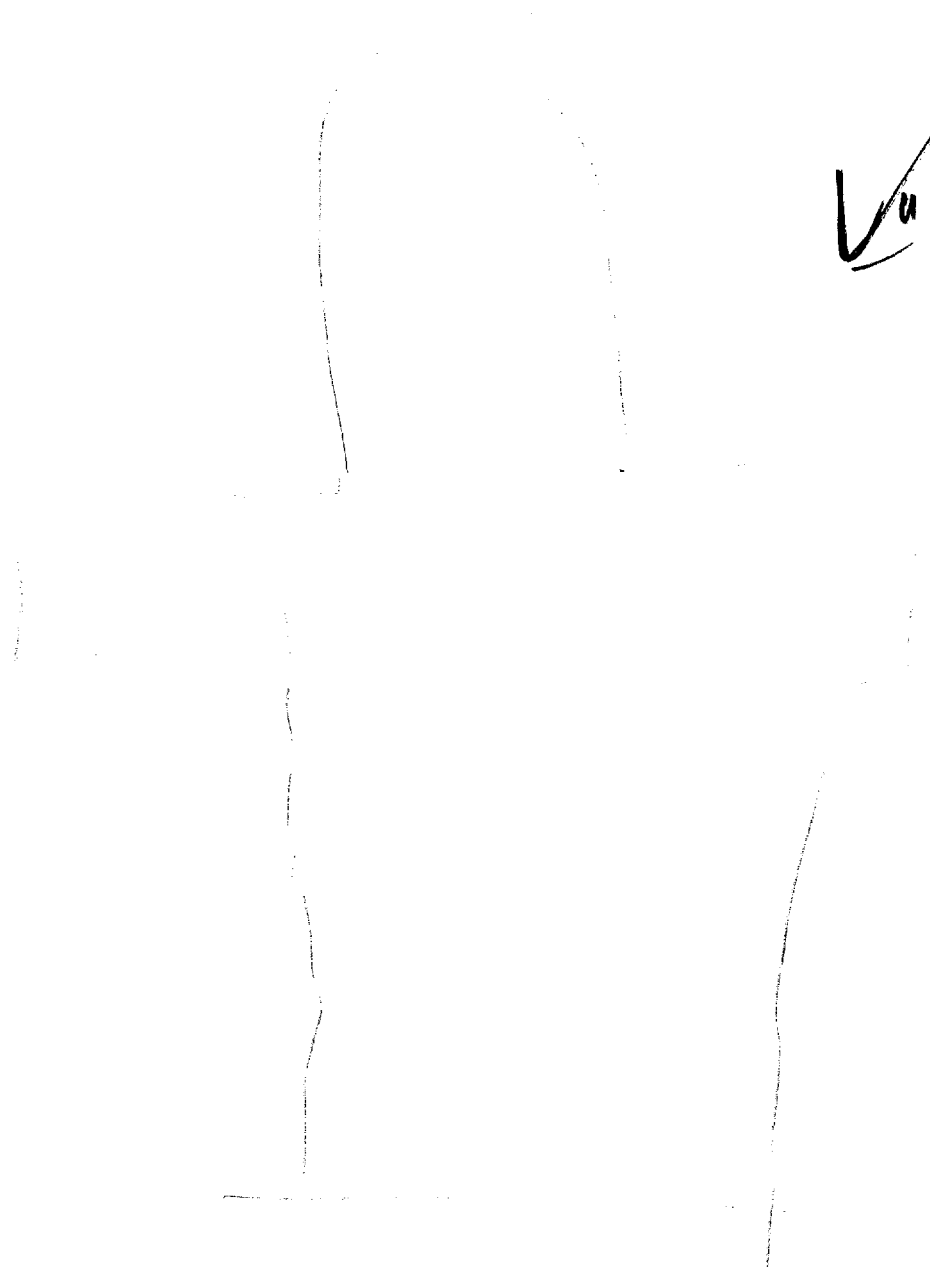

✓<sup>a</sup> EXCELLENT  
sketch of  
POES' Tomb

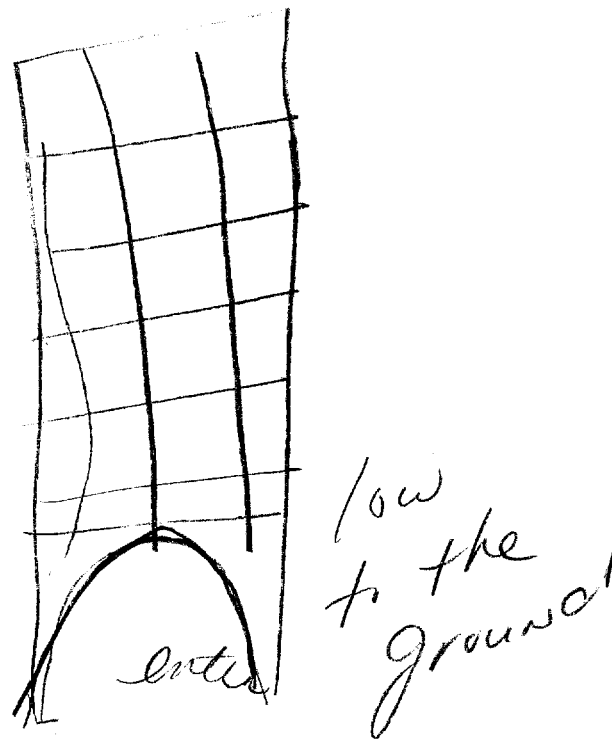

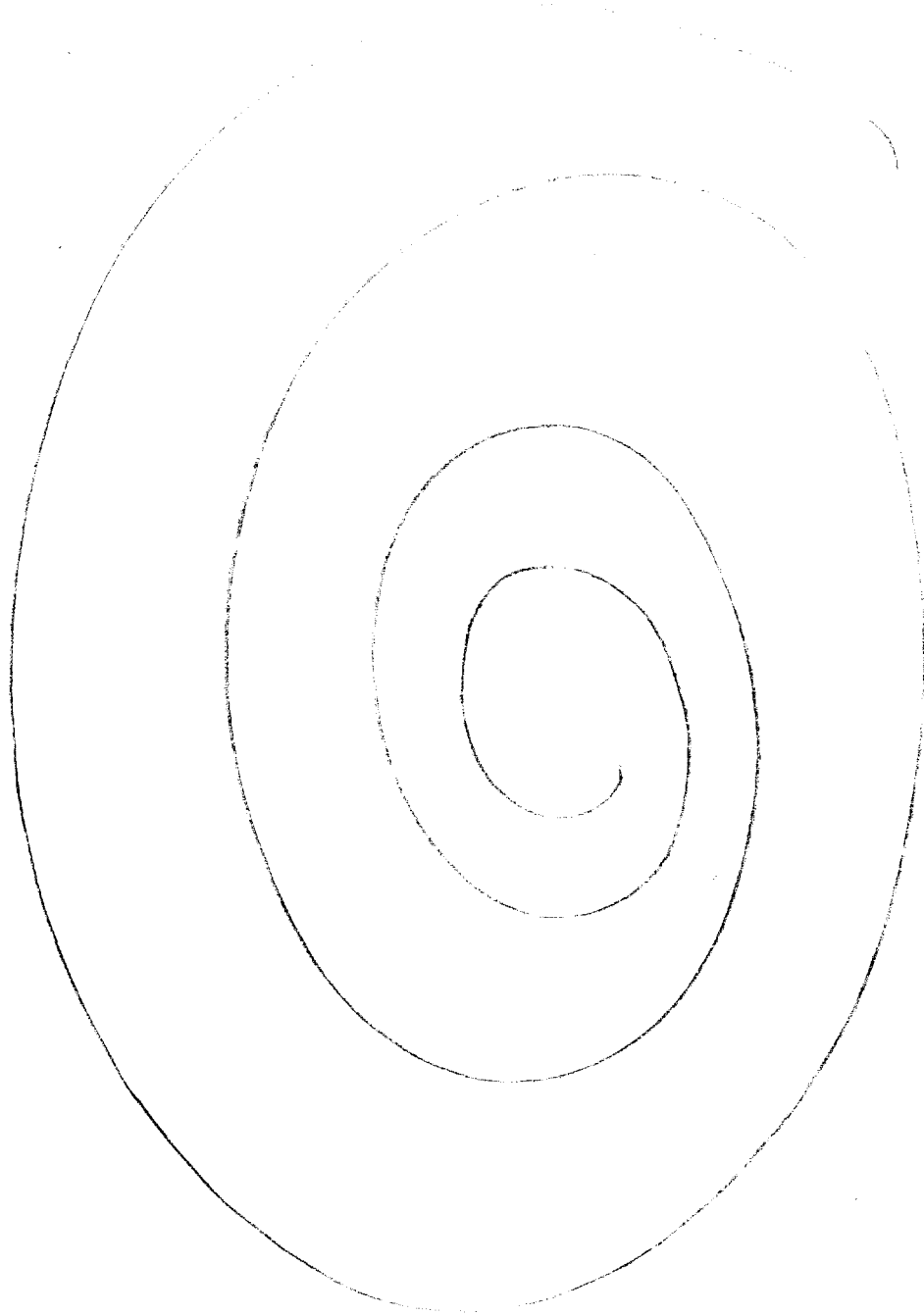

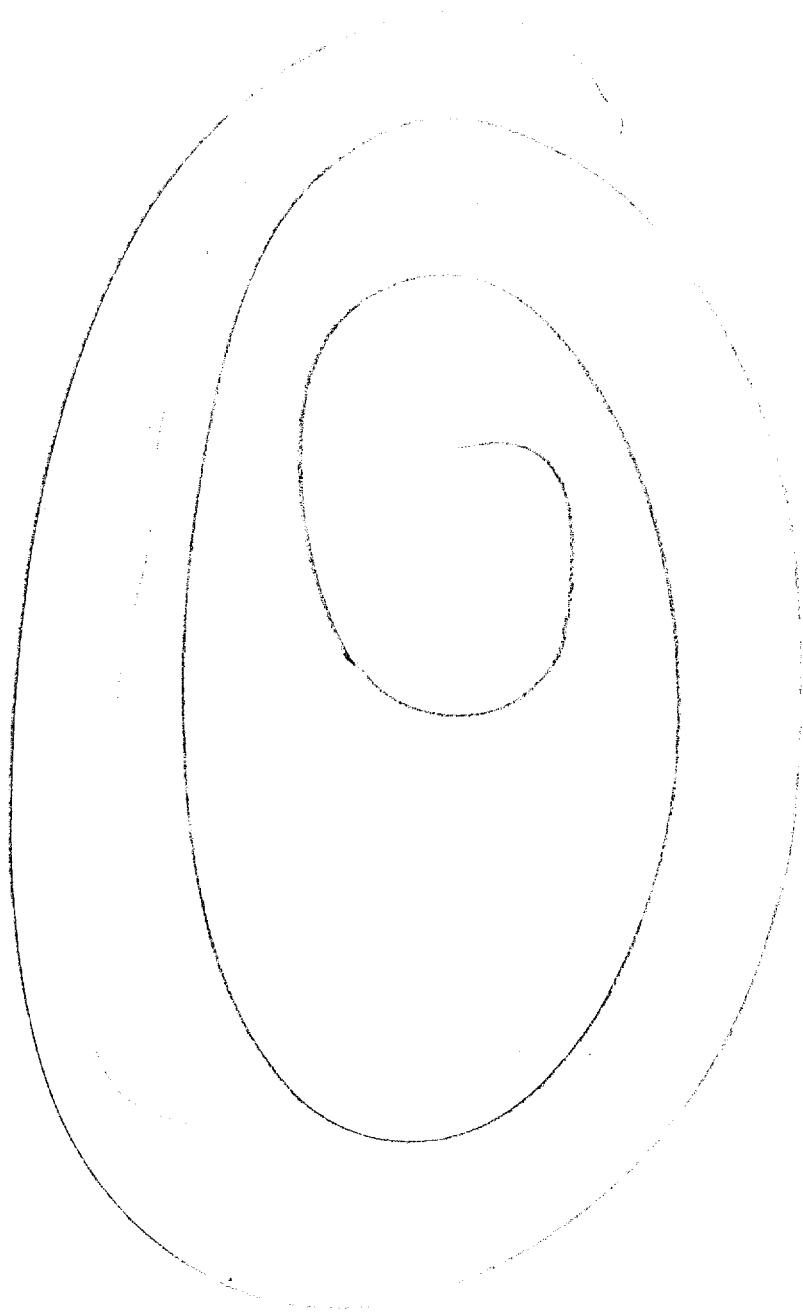

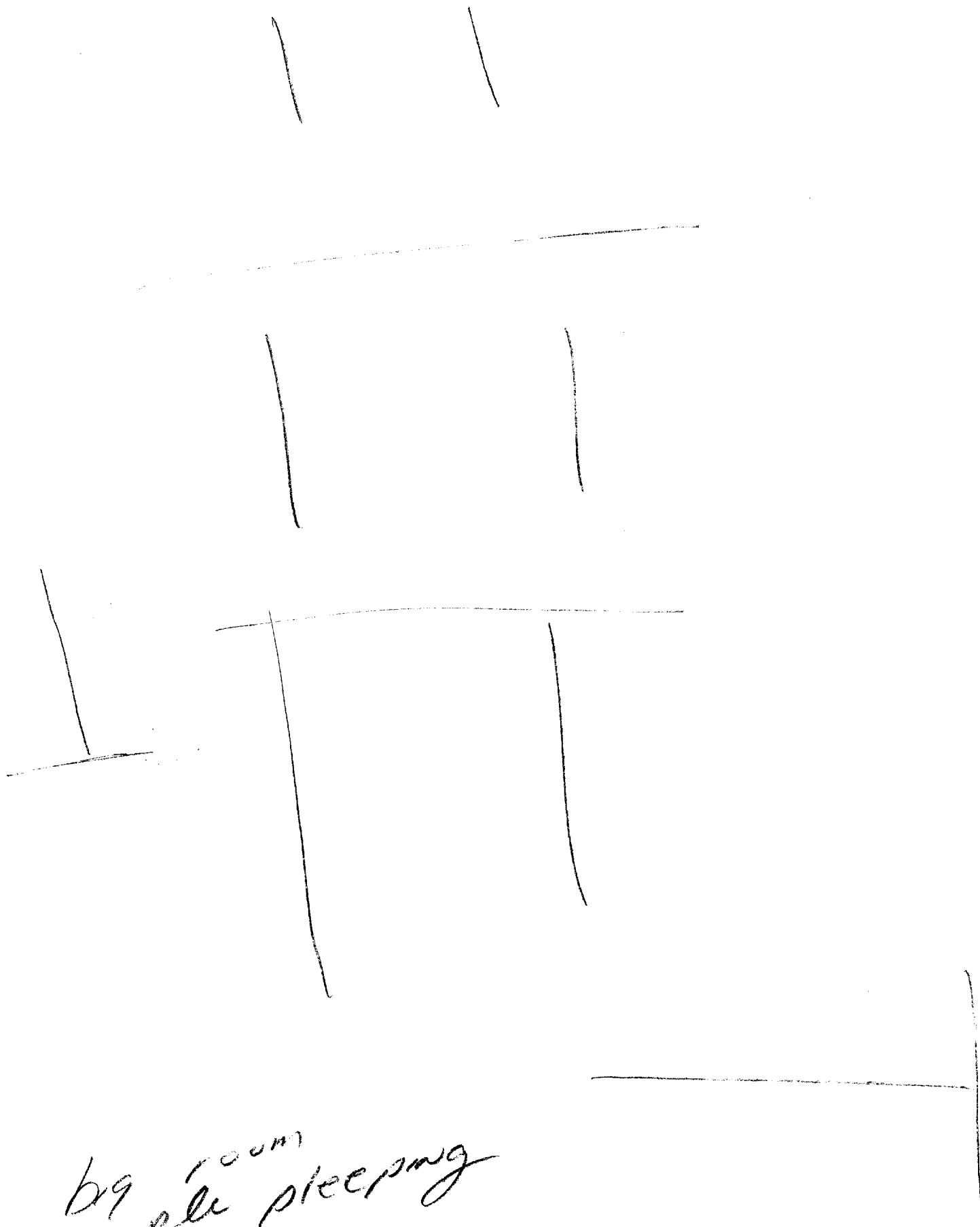

*big room  
people sleeping*

