

R: OPT 2
V: 049
D: 910301
T: 1349-1513
C: 01
M: Solo CRV

Summary of Information

The target consists of a country or rural setting with rolling green hills, several structures and an overall peaceful/restful feeling. It is reminiscent of a farm or ranch setting. Colors include green, blue, yellow, beige, brown and orange. The concept of "wrangley (?)" is apparent.

There is an alignment of disc-like objects as well as a group of bar-shaped figures. An nearby is jagged with brown irregularities.

There is a cylindrically-shaped object with alternating red, white and blue stripes. There is a grouping of pointed dark-colored objects which converge at a central point. It is very bright at this convergence.

There are clumps of dark brown objects intermingled with areas of exposed white/light sand or earth. There are shiny flashes of gold color associated with this specific location.

There are images of men wearing "cut-offs", a house partially hidden in the woods and a small, triangularly shaped metal sign on a post. The sign is red and white and sides along side of a disturbed area.

The structure has at least two sections to it; the smaller section is jibbed and has a rectangularly-shaped area that is shiny light gray on top. This section is adjacent to a larger wall.

This document is made available through the declassification efforts
and research of John Greenewald, Jr., creator of:

The Black Vault



The Black Vault is the largest online Freedom of Information Act (FOIA) document clearinghouse in the world. The research efforts here are responsible for the declassification of hundreds of thousands of pages released by the U.S. Government & Military.

Discover the Truth at: <http://www.theblackvault.com>

Another structure is wooden and has a fence associated with it. It is dusty, windy and beige/tan/brown here. There is the image of fences, rolling green, trees, wooden structures, a dusty area, openness and "very pretty".

There are one or two circular structures. The smaller one has a coarse, rough surface, a shimmering surface within and dampness associated with it. There is a water/wet smell as well as the smell of grass or straw. There is a brown taste. The section circular structure is tall and has a heavy feeling associated with it. There are pipe- or tube-like curving objects and a hollow ball-like object attached to the outside of the structure.

The letters "NAC" and "THR" are associated with the site.

There is a rumbling, dusty sound with objects like animals moving nearby. There are parallel lines on the ground reminiscent of tire tracks. There are black piles and these sometimes move (or are moved).

There are white objects present which are reminiscent of skulls, horns, etc.

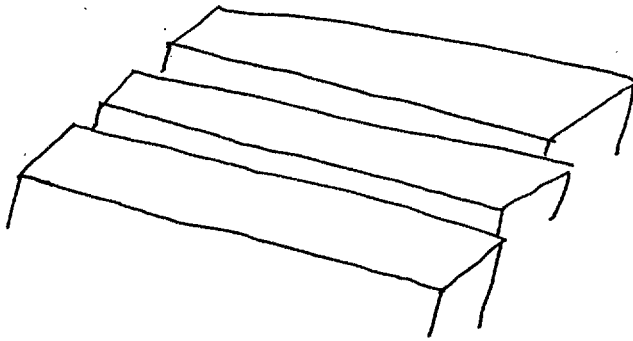

group of bar-shaped figures

stack or alignment of disc-like objects

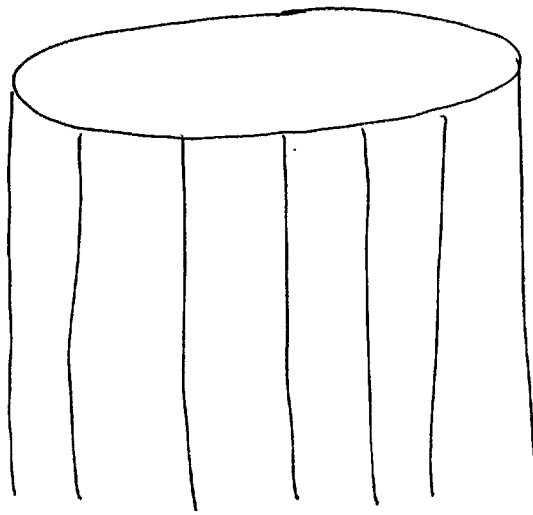
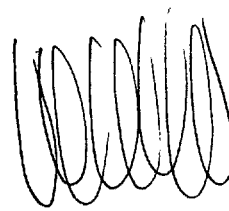

- Alternating red, white & blue stripes

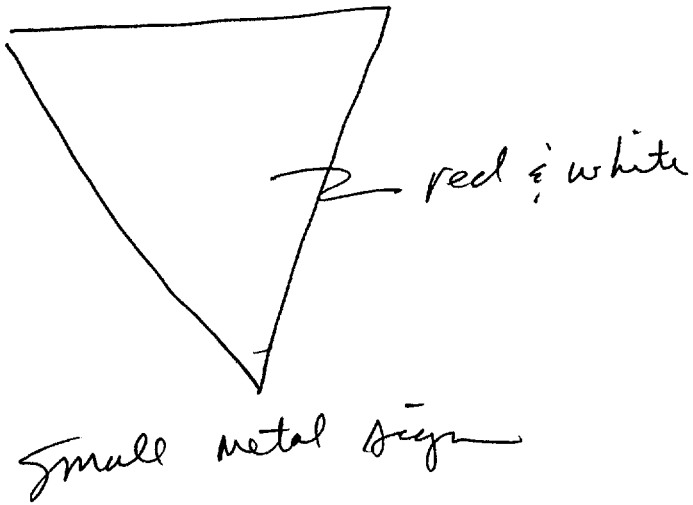
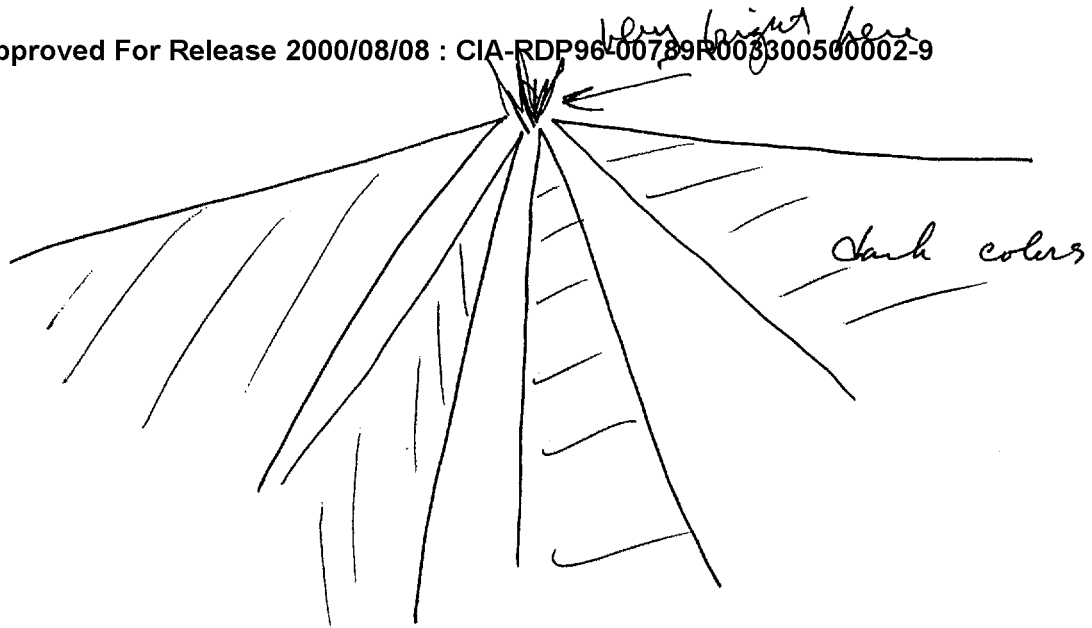

..
CC

Attached structures

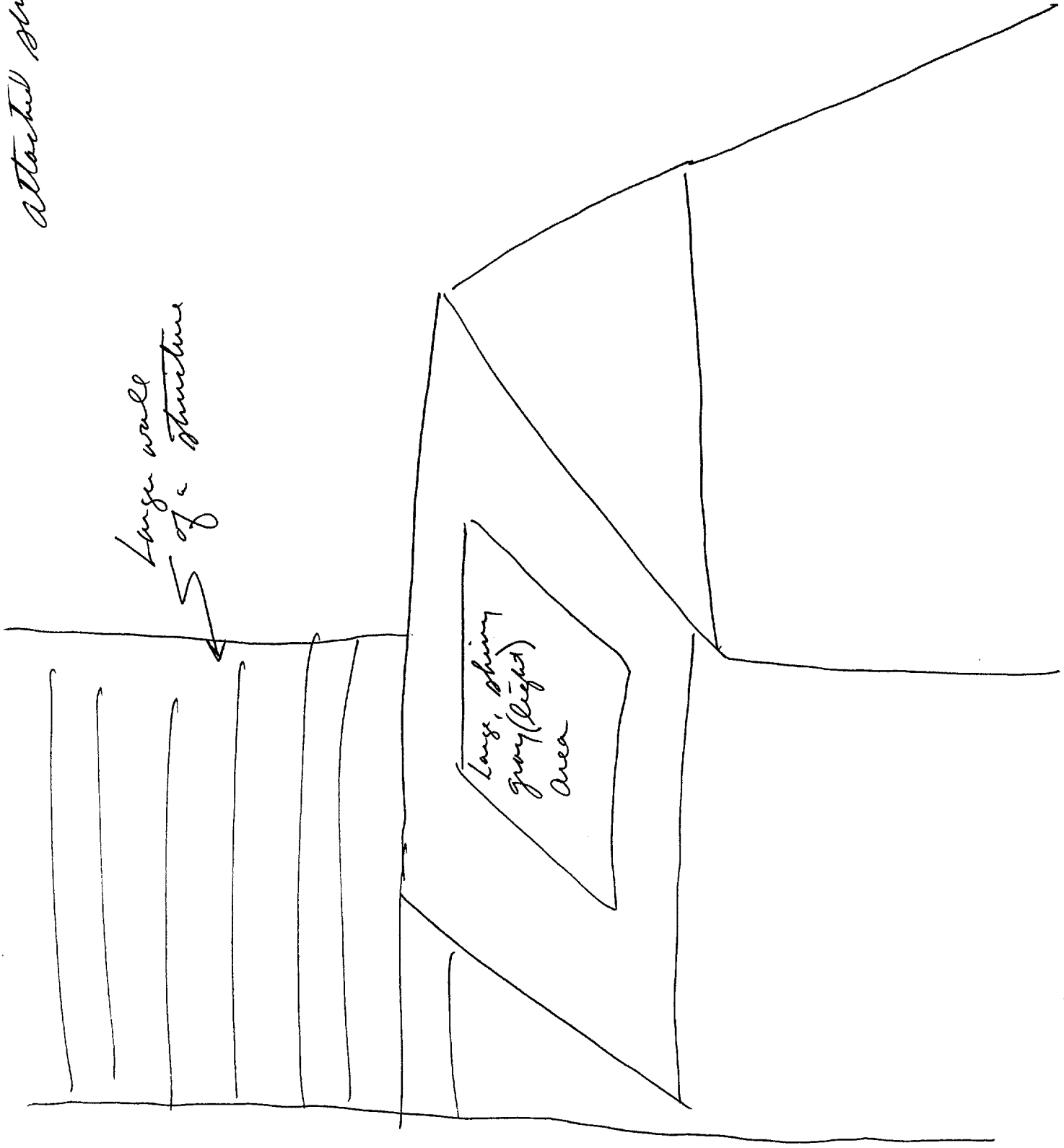

iii

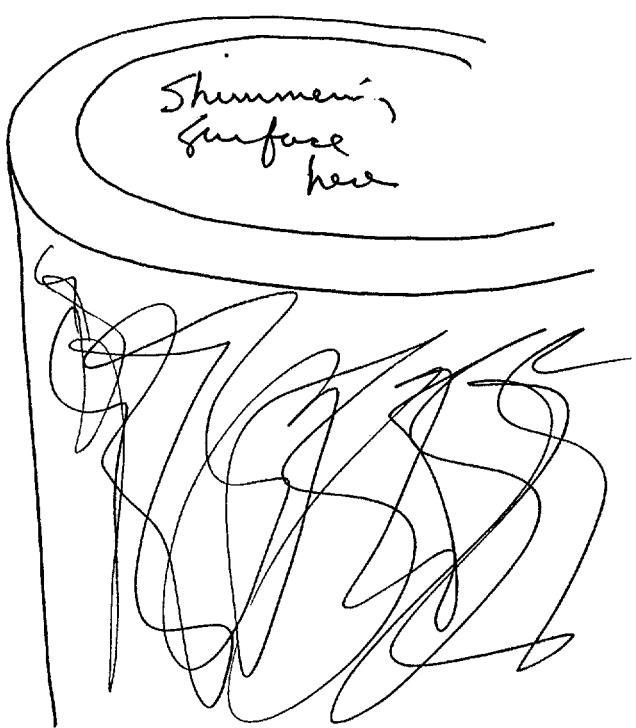

Shimmering surface here

* dangerous associated w/ this feature

rough, coarse surface

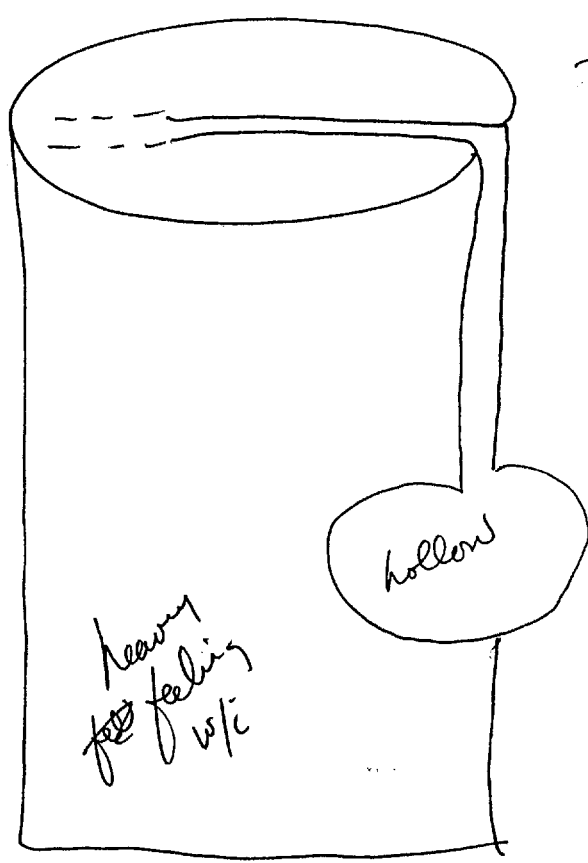

- 2d circular structure -

heavy ~~for~~ feeling w/c

hollow

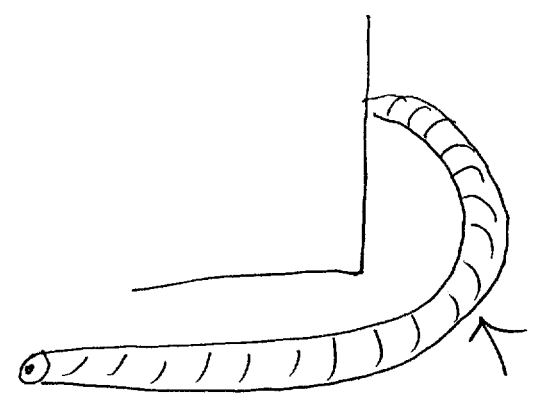

- rippled tube lying on ground

Circular structures -

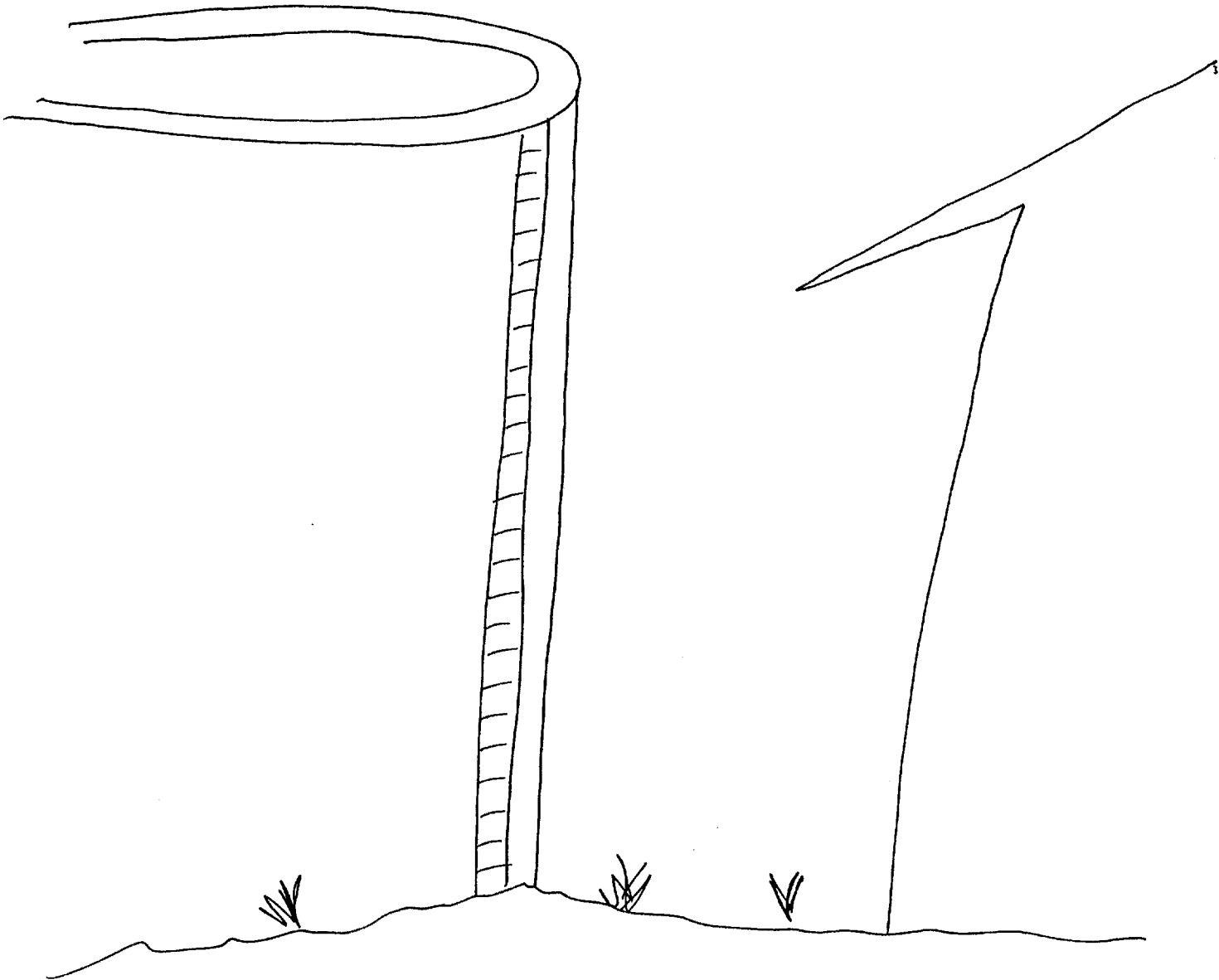

v