

~~SECRET~~

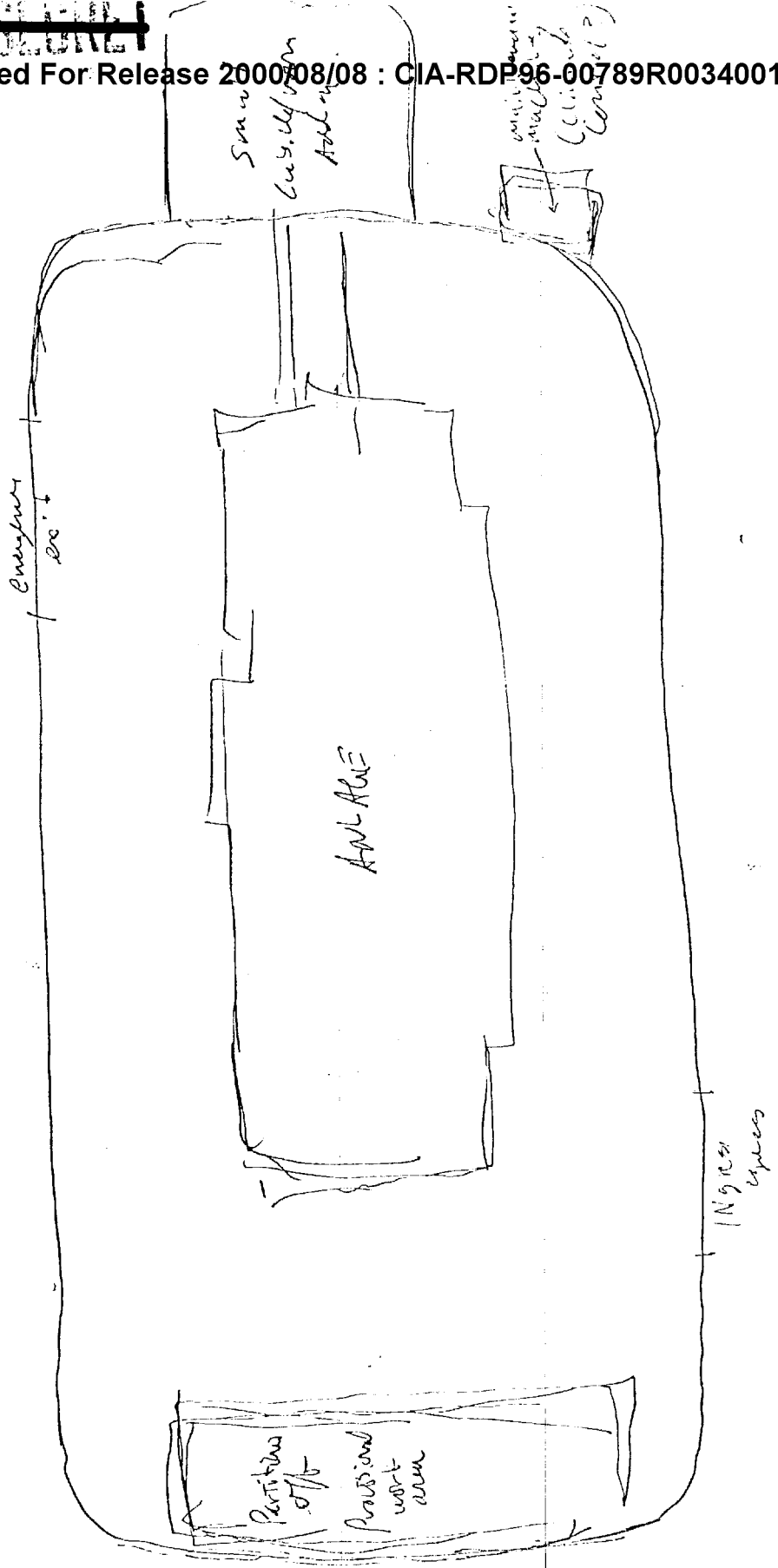

~~SECRET~~

This document is made available through the declassification efforts
and research of John Greenewald, Jr., creator of:

The Black Vault



The Black Vault is the largest online Freedom of Information Act (FOIA) document clearinghouse in the world. The research efforts here are responsible for the declassification of hundreds of thousands of pages released by the U.S. Government & Military.

Discover the Truth at: <http://www.theblackvault.com>

INSIDE!

angles
square
arch-like

dark

open
spacious

very
dark

entrance

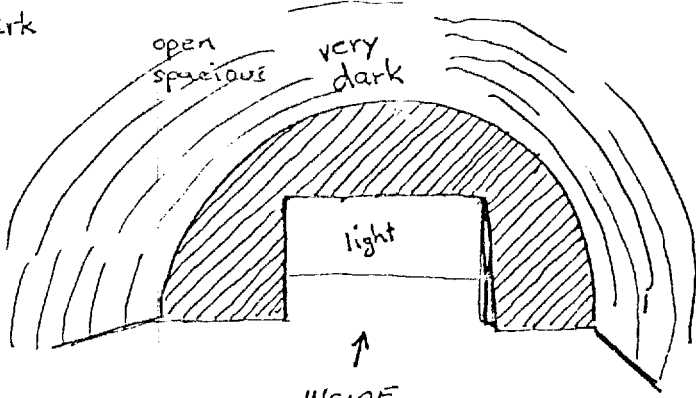

↑
INSIDE
LOOKING
OUT
X

ADL BREAK
LIKE THE INSIDE OF A
LARGE HANGAR/HANGARETTE
FOR AIRCRAFT

~~SECRET~~

second
structure

very soft ground

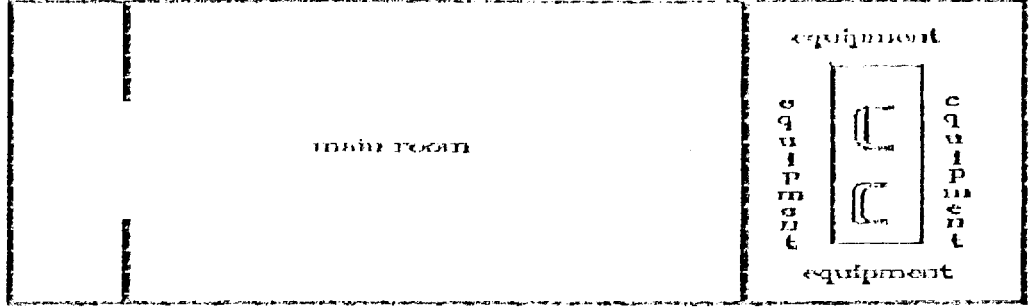

hard packed down ground

very soft ground

~~SECRET~~

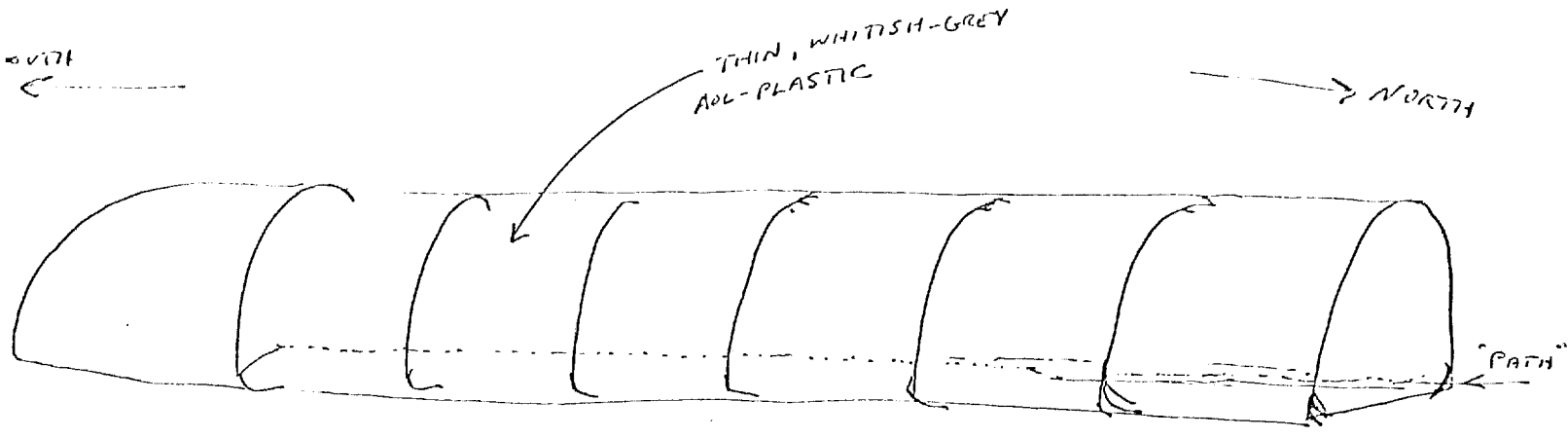

THIN, WHITISH-GREY
AOL-PLASTIC

EXIT
←

→ NORTH

PATH →

S₂ D AIL ET T I AOL a/s

[INSIDE]

S4 1/2 - idea of movement (people, etc) along a "path"; possible
to mean the west-facing side

AOL - walkway

[INSIDE]

MACHINE SOUND

VENTILATION
FRNS