

~~SECRET~~ NOFORN

PROJECT SUN STREAK

WARNING NOTICE: INTELLIGENCE SOURCES AND METHODS INVOLVED

PROJECT NUMBER: 8906 SESSION NUMBER: 02
DATE OF SESSION: 10 APR 89 DATE OF REPORT: 10 APR 89
START: 1000 END: 1110
METHODOLOGY: SOLO VIEWER IDENTIFIER: 011

1. (S/NF/SK) MISSION: Access and describe the nature, purpose, and key activities of the target. Copy of overhead photography is provided.

2. (S/NF/SK) VIEWER TASKING: See the sketch of the target building you provided in Session 01. From a suitable vantage point and utilizing the sketch as a point of reference, provide an overhead sketch of the target area.

3. (S/NF/SK) COMMENTS: No inclemencies noted. Note, copy of overhead photography was not provided to Viewer 011. A sketch of the overhead perspective is attached to this report. Viewer 011 will be tasked to provide data related to the cause of the blast sketched in Session 01.

4. (S/NF/SK): EVALUATION:

HANDLE VIA SKEET CHANNELS ONLY

~~SECRET~~ NOFORN

CLASSIFIED BY: DIA (DT)
DECLASSIFY: OADR

This document is made available through the declassification efforts
and research of John Greenewald, Jr., creator of:

The Black Vault



The Black Vault is the largest online Freedom of Information Act (FOIA) document clearinghouse in the world. The research efforts here are responsible for the declassification of hundreds of thousands of pages released by the U.S. Government & Military.

Discover the Truth at: <http://www.theblackvault.com>

~~SECRET~~ FOR 011

WORKING PAPER

DATE:

TASKER

1. YOU SOLO PROJECT OF 4 APR 89.
2. BACKGROUND: SEE YOUR TARGET BUILDING EXPRESSED IN FIGURE 1.
3. MISSION: UTILIZING THE TARGET BUILDING DESCRIBED IN FIGURE NUMBER 1, PROVIDE AN OVERHEAD PERSPECTIVE FROM A SUITABLE VANTAGE POINT AND DESCRIBE THE TARGET AREA. PROVIDE A CONCEPTUAL SKETCH IN SUPPORT OF YOUR FINDINGS. THANKS!

6

VIEWER 011
8/11/89
8966
562

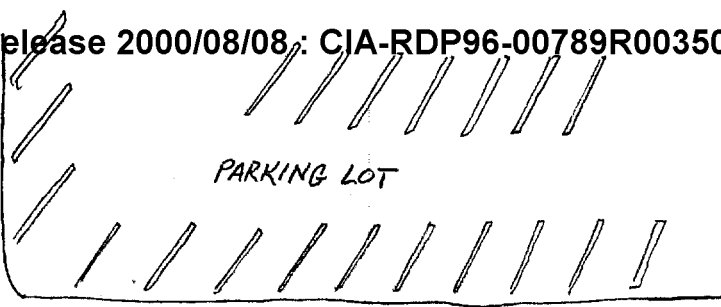
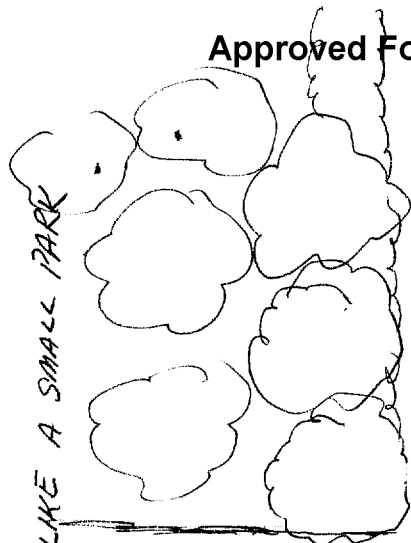

GRAVEL PATH



BENCHES

TREES & SHRUBS

OVERHANG
RAIN
ENTRANCE

10-12 STORY

3-STORY

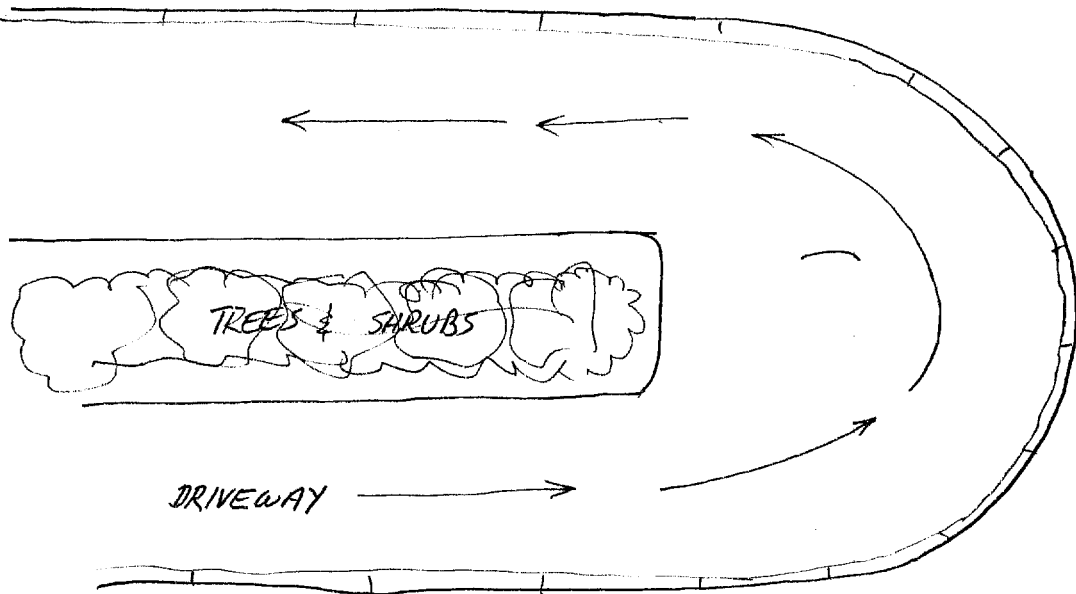
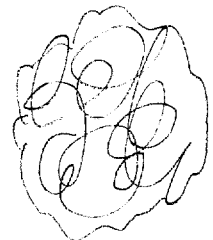
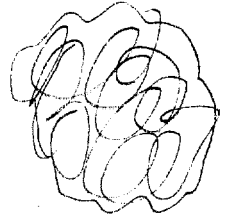

TREES & SHRUBS

DRIVEWAY

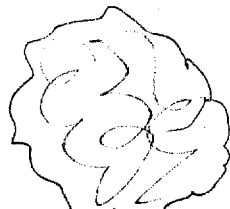

THE IMPRESSION OF
MEXICO CITY POPPED
IN, OUT OF NOWHERE

ENCLOSURE 3

800407
011
02

Unsollected
upheld to
fading

1

