

SECRET/NOFORN

PROJECT SUN STREAK

WARNING NOTICE: INTELLIGENCE SOURCES AND METHODS INVOLVED

PROJECT NUMBER: 9001-B	SESSION NUMBER: 01
DATE OF SESSION: 6 FEB 90	DATE OF REPORT: 9 FEB 90
START: 1302	END: 1348
METHODOLOGY: ERV	VIEWER IDENTIFIER: 011

SG1A

SG1A

1. (S/NF/SK) MISSION: Determine and describe the target location of a target personality identified

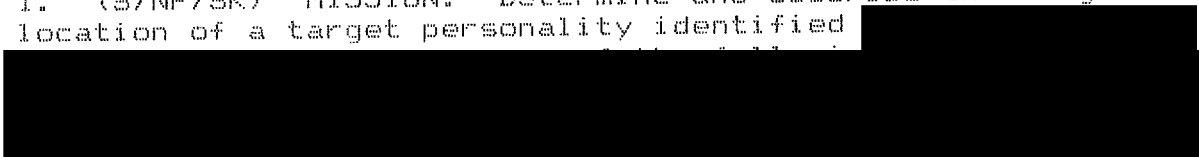

2. (S/NF/SK) VIEWER TASKING: Utilizing Encrypted Coordinates 641203/265551, describe the current residence of an identified target personality.

3. (S/NF/SK) COMMENTS: No inclemencies noted. A Summary of Information is attached to this report. Given the choice of determining if the target personality were "either at location a or location b", O11 elected to describe the current location of the target personality and allow the customer to make the determination whether such a description matched a location where the target personality may be using.

4. (S/NF/SK): EVALUATION: ?

5. (S/NF/SK) SEARCH EVALUATION:

HANDLE VIA SKEET CHANNELS ONLY

SECRET/NOFORN

CLASSIFIED BY: DIA (DT)
DECLASSIFY: OADR

Customer provides no answers to the query

This document is made available through the declassification efforts
and research of John Greenewald, Jr., creator of:

The Black Vault



The Black Vault is the largest online Freedom of Information Act (FOIA)
document clearinghouse in the world. The research efforts here are
responsible for the declassification of hundreds of thousands of pages
released by the U.S. Government & Military.

Discover the Truth at: <http://www.theblackvault.com>

~~SECRET~~

P 9081-B

D900206

Y011

S01

~~██████~~

SUMMARY OF INFORMATION

THE TARGET PERSONALITY IS RESIDING IN A ROOM/APARTMENT SITUATED OVER A SMALL CAFE. THIS CAFE IS LOCATED WITHIN A RURAL-LIKE VILLAGE AND OVERLOOKS A PARK-LIKE SQUARE. THIS VILLAGE IS ADJACENT TO A MAJOR HIGHWAY, ALONG WHICH IS A RURAL BUS ROUTE. TARGET PERSONALITY OFTEN USES THE BUS TO GET TO AND FROM FROM THIS LOCATION. HE NORMALLY CATCHES THE BUS AT THE BUS STOP AT ANNOTATION 7, SKETCH *3. THE BUS IS LIGHT-BLUE IN COLOR AND LOOKS LIKE AN OLD BEAT-UP SCHOOL BUS.

~~SECRET~~

~~SECRET~~

SKETCH * 1

INSIDE VIEW OF CAFE'

P

D 900208

V 011

S 01

M E R V

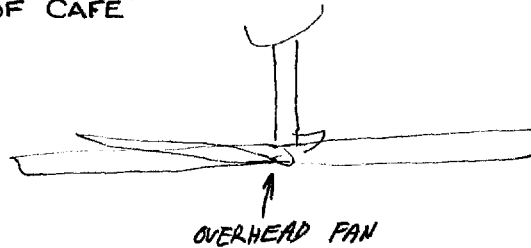

OVERHEAD FAN

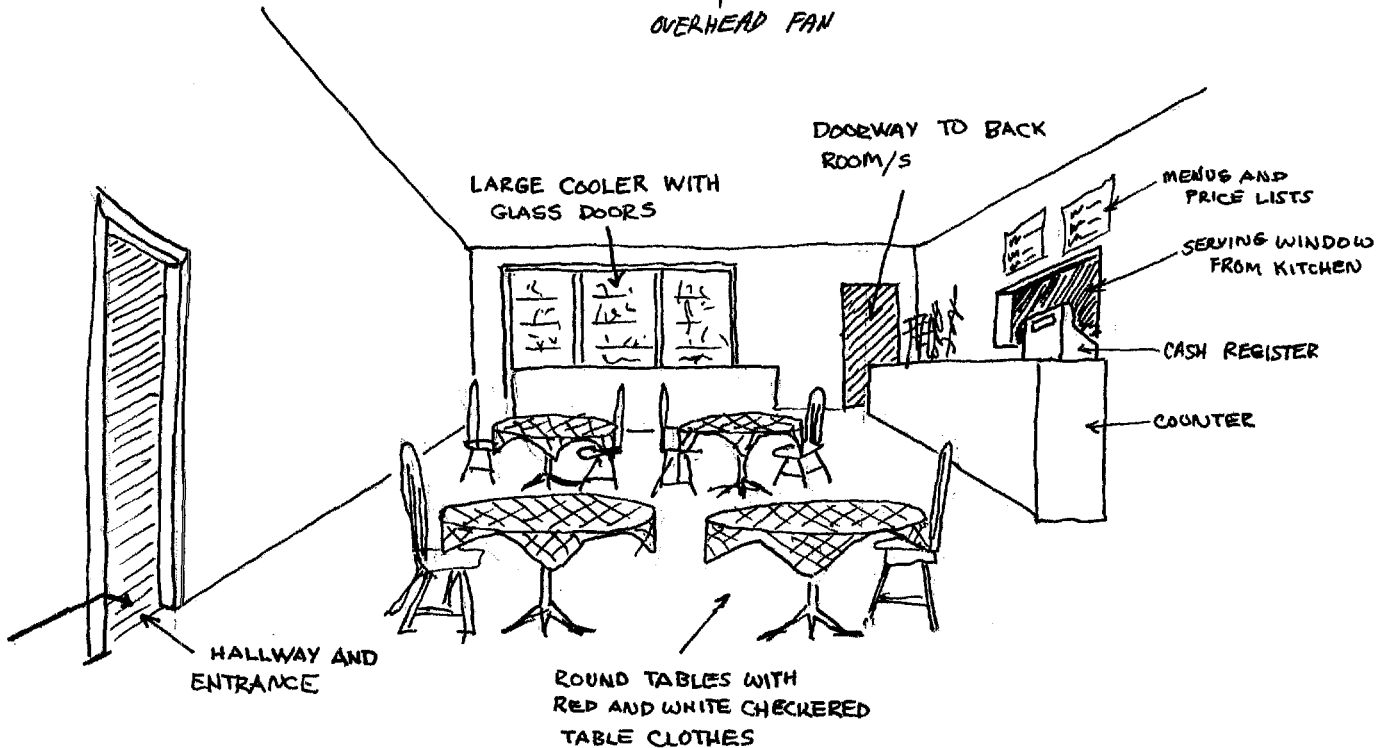

INSIDE OF CAFE'-LIKE RESTAURANT FROM THE BENCH/BOOTH AND TABLE LOCATED NEXT TO THE LARGE WINDOW, IN FRONT, WHICH OVERLOOKS THE PARK/VILLAGE SQUARE. THIS IS WHERE TARGET PERSONALITY USUALLY SITS. TARGET PERSONALITY LIVES UPSTAIRS FROM THIS ESTABLISHMENT.

~~SECRET~~

~~SECRET~~

SKETCH # 2

OVERHEAD VIEW OF TGT STRUCTURE AND IMMEDIATE AREA

P

D 900206

VOII

SOI

MERV

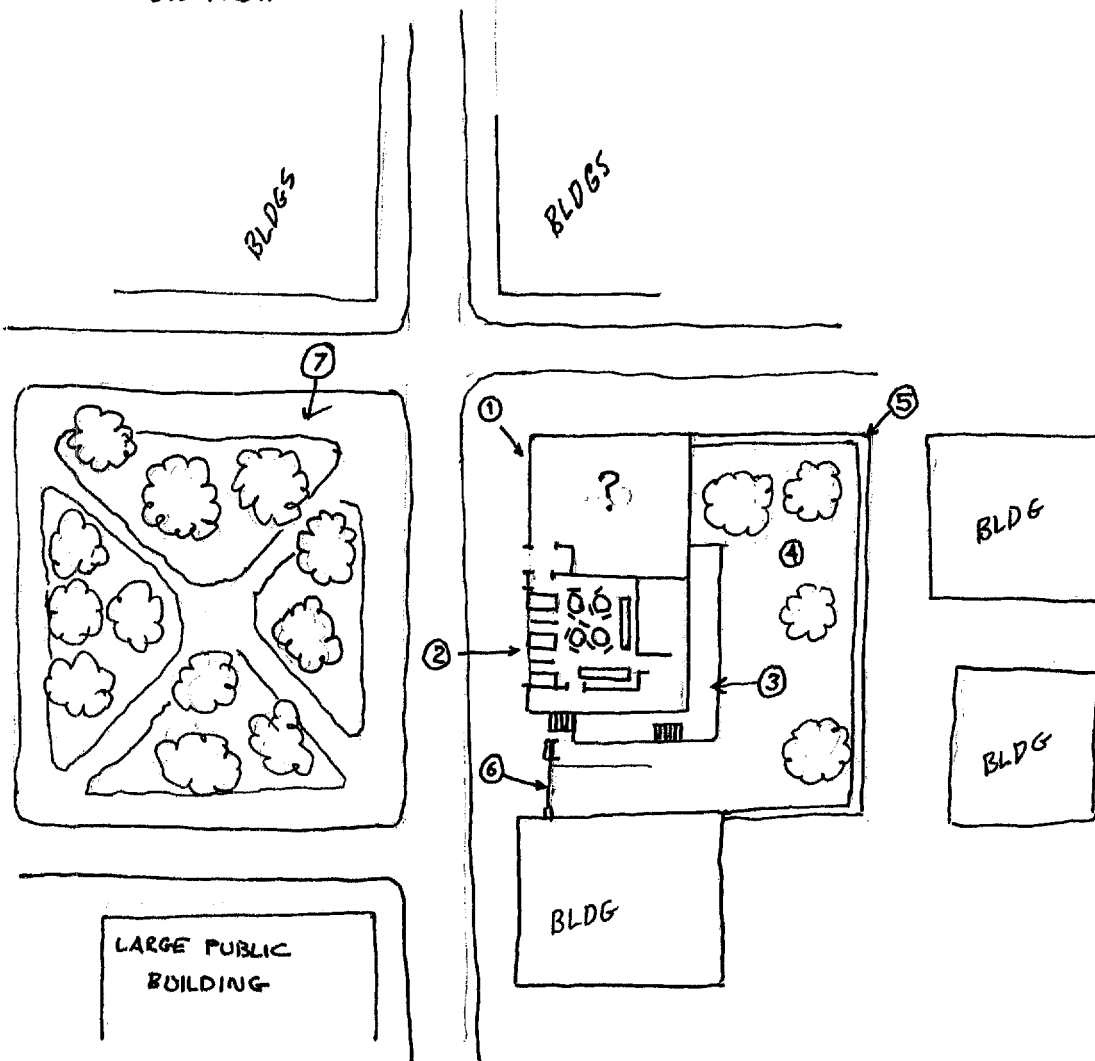

- ① TARGET STRUCTURE
- ② CAFE' WITH LRG WINDOW OVERLOOKING PARK-LIKE SQUARE (SEE SKETCH #1 FOR INTERIOR)
- ③ SECOND STORY PORCH/BALCONY (TARGET PERSON LIVES IN AN APARTMENT HERE)
- ④ COURTYARD
- ⑤ MASONRY WALL
- ⑥ DRIVEWAY WITH METAL GATE
- ⑦ PARK-LIKE SQUARE WITH BENCHES

~~SECRET~~

~~SECRET~~

SKETCH #3
OVERHEAD VIEW
OF VILLAGE

P
D 900206
V011
S01
MERY

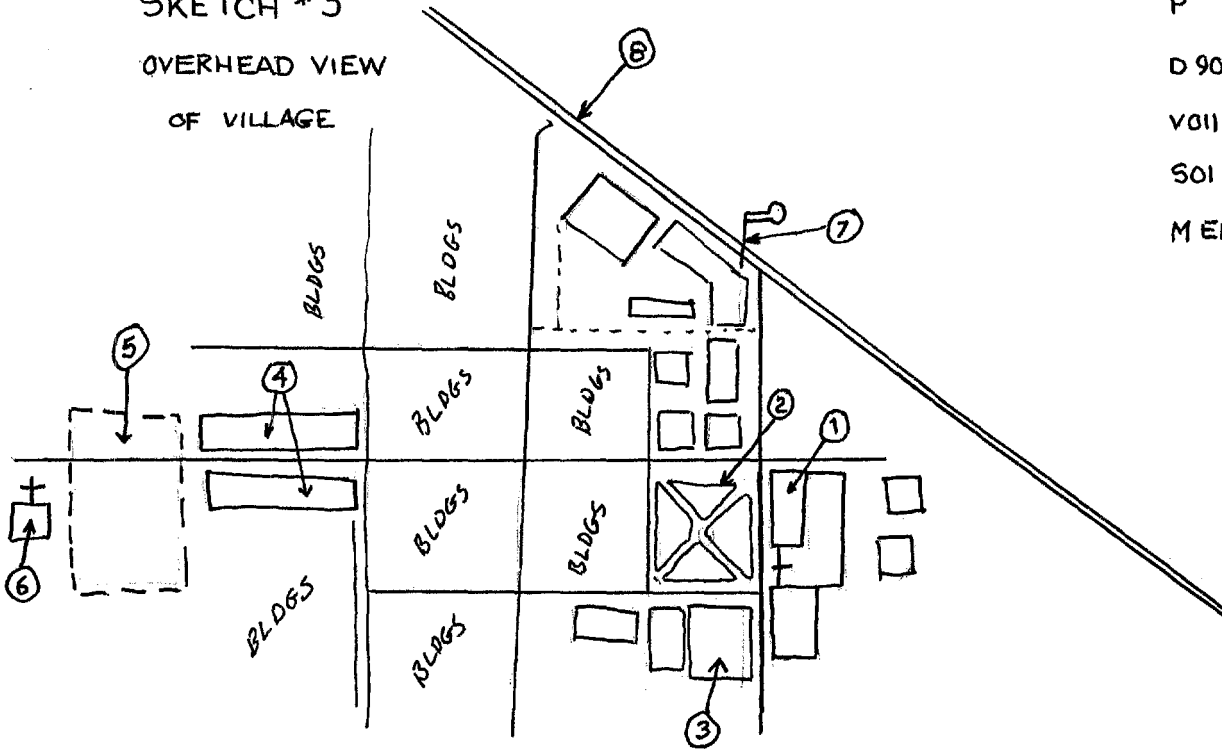

- ① TGT STRUCTURE WITH CAFE' AND 2ND STORY ROOMS/APARTMENTS (SEE SKETCHES #1 AND #2).
- ② PARK-LIKE SQUARE
- ③ MUNICIPAL BLDG
- ④ SHOPS AND STORES
- ⑤ OPEN MARKET PLACE
- ⑥ CHURCH
- ⑦ BUS STOP (RURAL RTE)
- ⑧ MAJOR ROAD/HIGHWAY

~~SECRET~~