

Paw
21 Jan 88
F. Mealy, md
EJ
1347

174
301
868 853



- A. wood
flat
hard
B. low
- A. up and
down
down
soft
B. straight
- A. by waves
down
wood
soft
B. level
- A. many and
soft
soft
- B. people

S2
bed
grass
blue
fresh smell
loud
clean
brown

This document is made available through the declassification efforts
and research of John Greenewald, Jr., creator of:

The Black Vault



The Black Vault is the largest online Freedom of Information Act (FOIA)
document clearinghouse in the world. The research efforts here are
responsible for the declassification of hundreds of thousands of pages
released by the U.S. Government & Military.

Discover the Truth at: <http://www.theblackvault.com>

pridely
hard
bumpy
pleasant smell
round
open
with
cup + drum

AI Bre
I like this
piece



2

W

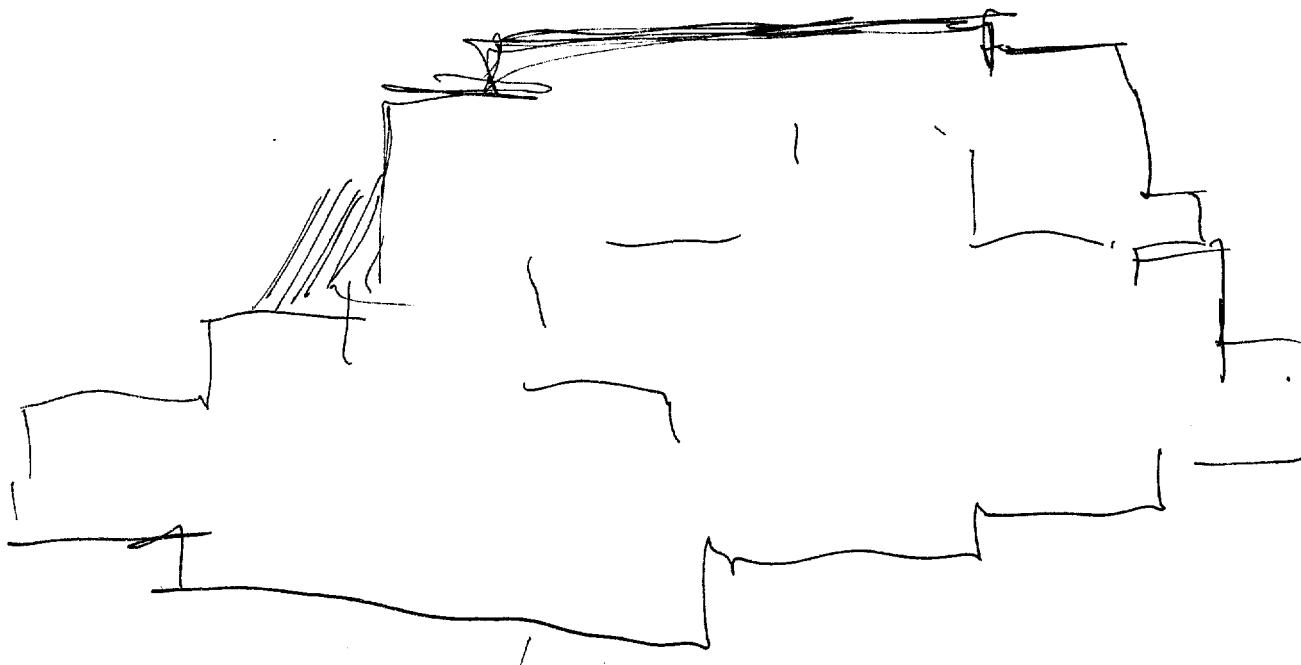
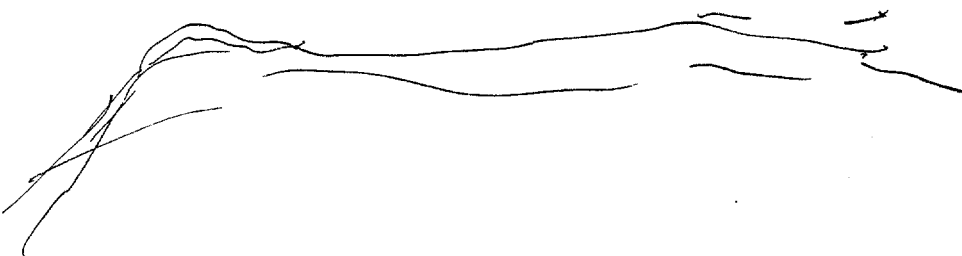

SZ

For
summary

angles
inclines
rectangles
solid
blanks
tool
work

dash
~~flat~~

flat

12 BK
heavy

Structure

composite

"no-nonsense"
businesslike

T

metal
concrete

round
square

for
nuclear
power plant

STRUCTURE

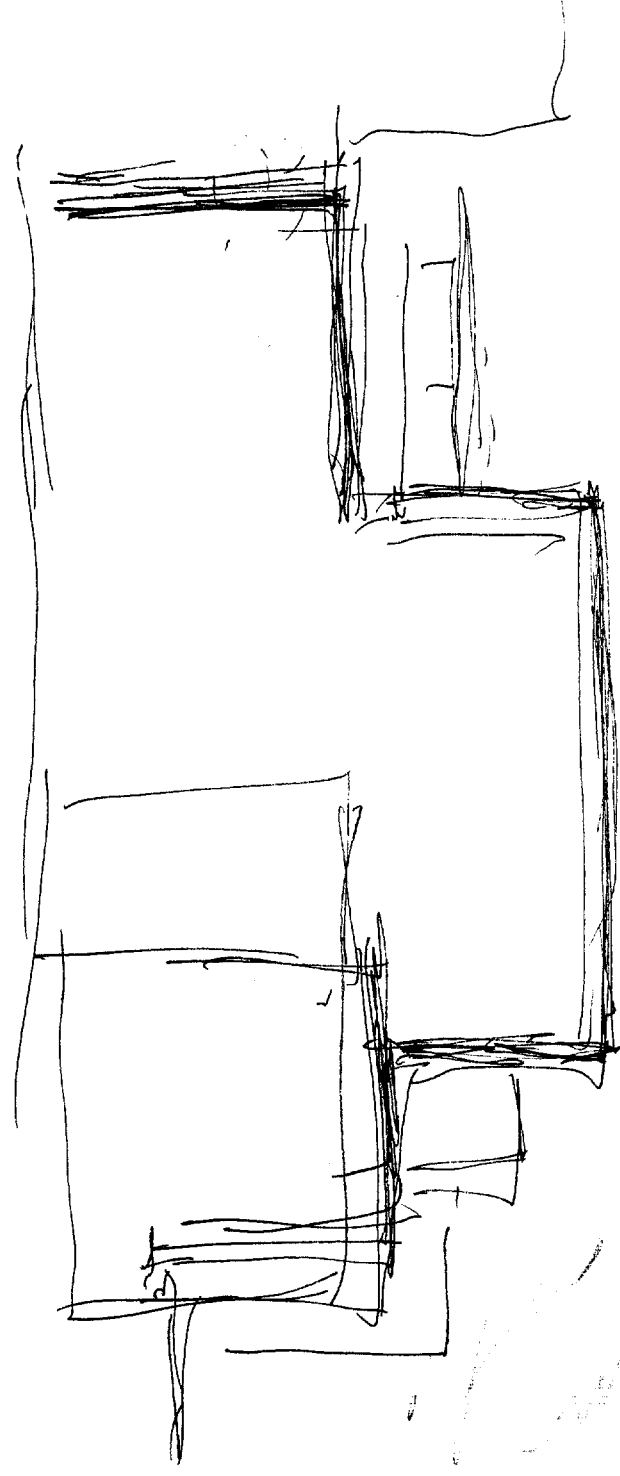

Large, grey, shiny structure
 with differing roof levels
 and modular components in an
 open station. All DME

SUI

3/2

yellow

shiny

smooth

rounded edges

level

heights

roots

5 1/2' Cont. at attached. setting. main part, differing - almost wooden - portions presents dim light, murky atmosphere, Creedes

Stades
stair

5 1/2' live' starts from weathering plant associated with a large complex.

APL BLC
past project
on document

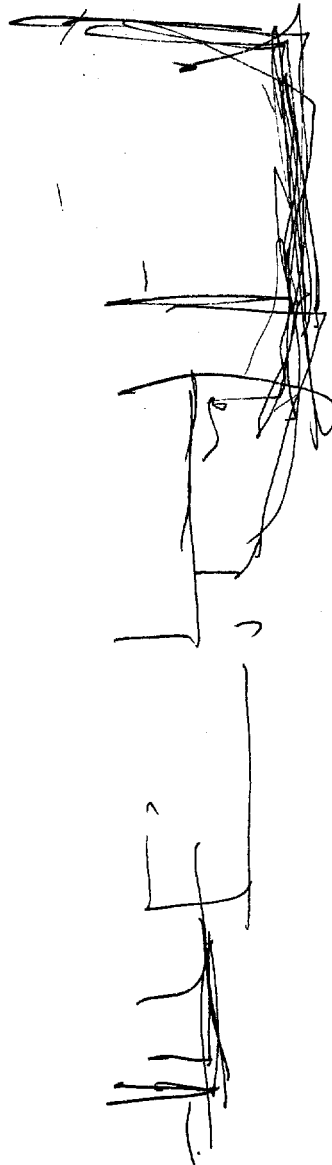

S2

D

02

FJ

T

I

ACL

ALS

SUI

open

cool
sweaty
intermittent
sun

grass
trees
structures

low
spruce

white
empty
red
green
yellow
smooth
grey
hazy

like
sidewalk
feel

white

5+1/2 small like pines/evergreens. Fresh air smell. Difference in land elevation

structures

open

spruce

curving
sub like residential area in mpr. with place of woods curving thru landscaped areas

SLI

7

HS

#02 BK - Impression that there was a document that was at the DITE that is missing & they think it's somewhere else & are looking for it.

Structure

brownish
grey

workshop

Feels "like" a house. Some however of other than residents are
- "like" an office a HQ or etc. in a converted dwelling
place. Sense of being brownish-grey stone concrete
on a slight elevation above a street curving along a
slight slope contour with fence around it & steps
leading to a door. 2 floors - other parts to
structure. Internal activities are not visible
to this level. It's "like" it's part of a large
federation/organization/agency - group of people bound
by common purpose & goal but more constraints
than just voluntary

light
blue

7a



010
8775 (14-21)
21 Jan 88

Masonry Structure in Residential area

SVI

S2

D

A2

E1

T

I

002

A6

Set 1/2 inside beltway, not new construction

object



Set 1/2 rounded, metal, thin-walled object secured to ceiling - J.F. overhead people go past + under it. Inside a structure

Seems to have sensors to do with president

7

rounded, metal, thin walled object secured to ceiling - people go by and under.

1419

018

8728(N-2)

21 Jan 88

TAB K

84

