

J 11 APR 89

SECRET/NOFORN

PROJECT SUN STREAK

WARNING NOTICE: INTELLIGENCE SOURCES AND METHODS INVOLVED

PROJECT NUMBER: ~~SUN STREAK~~ 226 SESSION NUMBER: 001
 DATE OF SESSION: 3 Apr 89 DATE OF REPORT: 10 Apr 89
 START: 1115 END: 1210
 METHODOLOGY: CRV VIEWER IDENTIFIER: 032

1. (S/NF/SK) MISSION: Pursue and successfully complete a Stage VI session on a selected site.

2. (S/NF/SK) VIEWER TASKING: Encrypted coordinates 297334/101019 (Bunker Hill Memorial).

3. (S/NF/SK) COMMENTS: Viewer successfully identified dimensional components of site, described many S IV items, and effectively utilized Stage VI time movement tools to report information from late 1700s of direct relevance to meaning and identification of site. ~~Handwritten notes and scribbles follow.~~

port

4. (S/NF/SK) EVALUATION:

Handwritten marks: a '4' and a large 'M' with a diagonal slash.

HANDLE VIA SKEET CHANNELS ONLY

SECRET/NOFORN

CLASSIFIED BY: DIA (DT)
DECLASSIFY: OADR

This document is made available through the declassification efforts
and research of John Greenewald, Jr., creator of:

The Black Vault



The Black Vault is the largest online Freedom of Information Act (FOIA) document clearinghouse in the world. The research efforts here are responsible for the declassification of hundreds of thousands of pages released by the U.S. Government & Military.

Discover the Truth at: <http://www.theblackvault.com>

WORKING PAPER

290406

VJ 632

na 01

SUMMARY OF INFORMATION

Site is a structure. The structure is made of stone or concrete. The dimensions of the structure are that it rises sharply from relatively flat sides or base supports. The actual construction materials appear to be oversized tan or white brick (see page 80). There is something that rises high and dark behind the structure -- off in the distance.

The structure is somewhat central to it's surroundings. It is used as a rallying point of sorts (SO/S like a library, city hall, theatre), it is something used or seen regularly.

There are ornate aspects to the decoration of the structure (see sketch page 2, day 2). It is older, probably late 1800 to early 1900 in construction. The purpose of the site seems to reflect related to art or remembrance of some event or person in history. The site is meant to preserve the memory of the event or persons.

There were perceptions of war, opposing forces in racing lines or ranks. There were trees, ramparts, emplacements, smoke and haze. I think that the structure is some kind of war memorial.

NO-NON

032

3 APR 89

1152

congested.

297334
101019

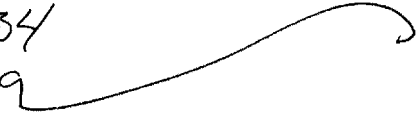

A. sloping up
shoond oandy
Hawl.
B. NOB

297334
101019



A. rising
shurpler
sloping down
Hawl M
B. structure

52

Breer
Blus
Whur
Fough
shoup
hins
Bumps.

Rough
square
small
Rough
Shooting
diagonal
corners
square
small

AI Bank
makes me feel
like I'm in
around some
small structure
all by itself.
lonely.

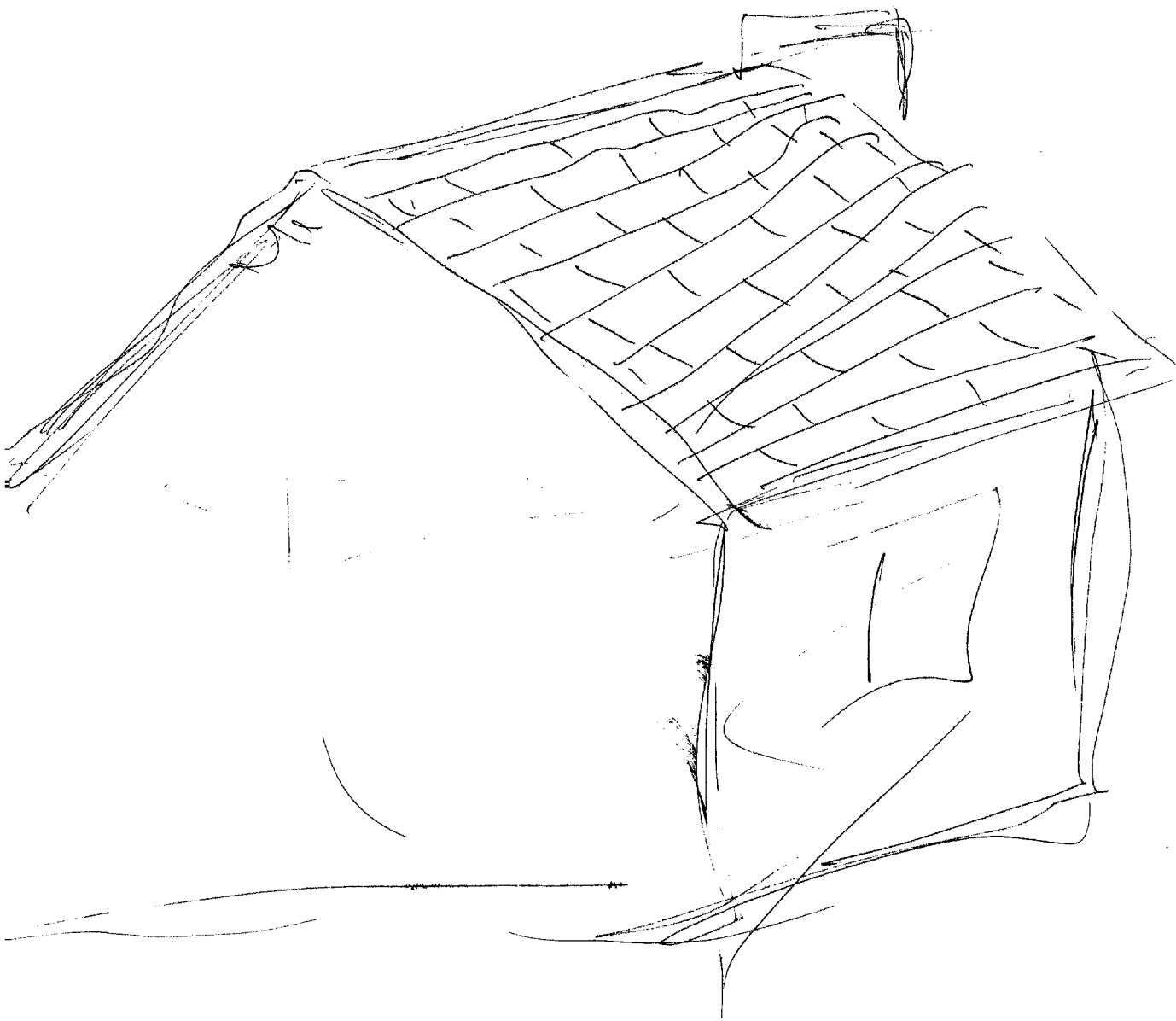

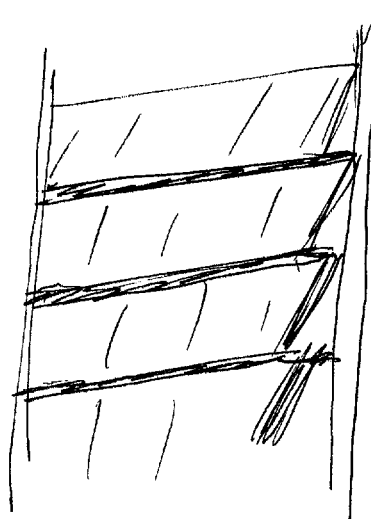
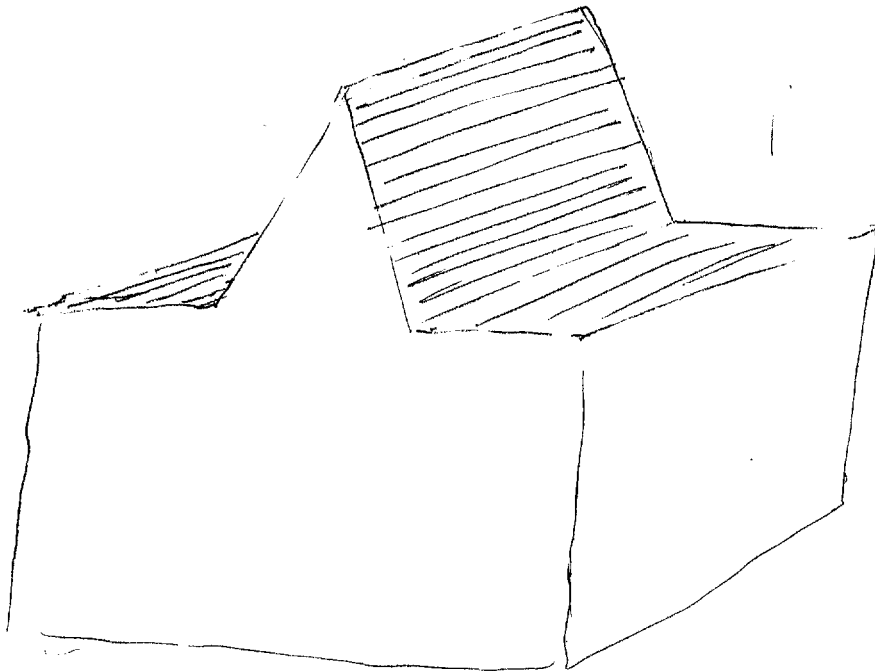

Shiny metallic object
w/ Jewels or brilliant
implants.

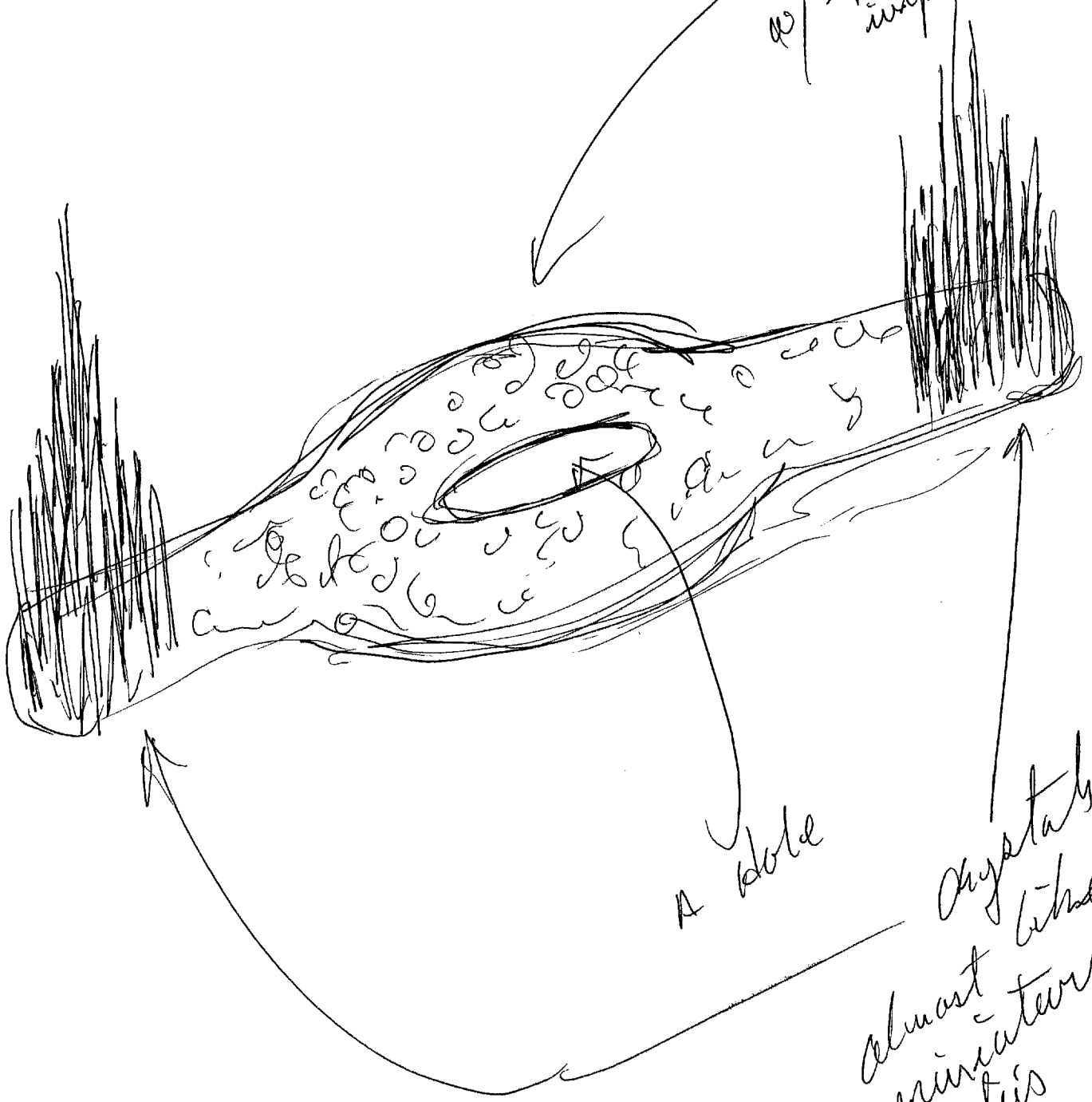

A hole

Crystals
almost like
minerals
artificial

52

D

AI

EI

I

I

vol/m

Routt
Zaldu

Tall
Pent
Dance
wide base
narrow
protrusions
ranks
overhangs
sloping
slip
corners

546 Angles inclining into angles - creating
an mltt. surfaced plane.

outsid -
Insid

Brick
Wood
Glass -

No Dist
Small
Church.

6.
AD/AS

SZ

D

DI

EI

T

I

hairs
rough

Brown
Red.

glass

grey

metal.

Small

smooth

avers
Banks.

ceramic
coils metal

sil stack
filament
like coils.

funnel
tubes.

54 1/2 - I perceive a structure that has
an elongated sloping roof, which
is curved and the length runs
from front to back.

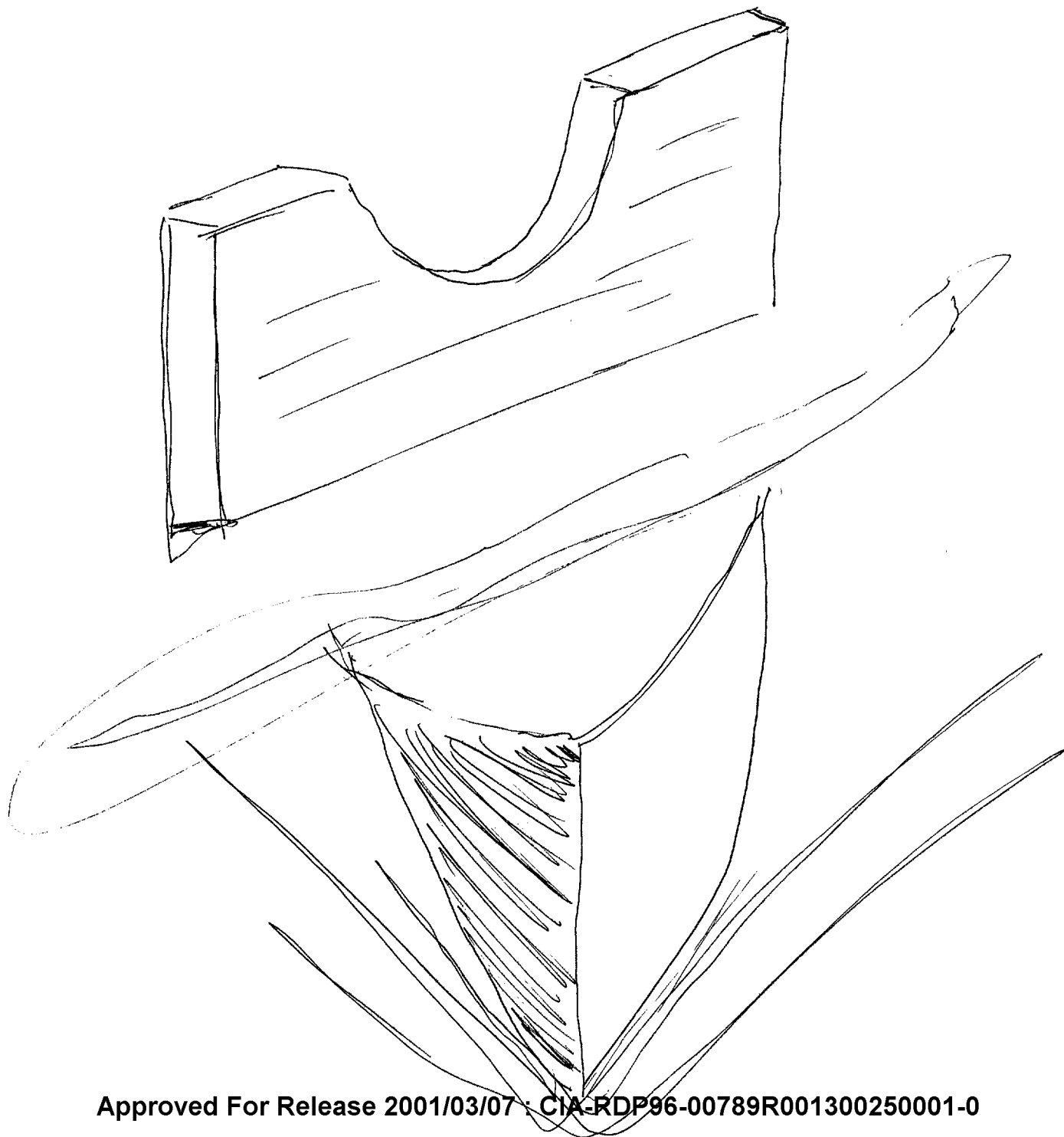

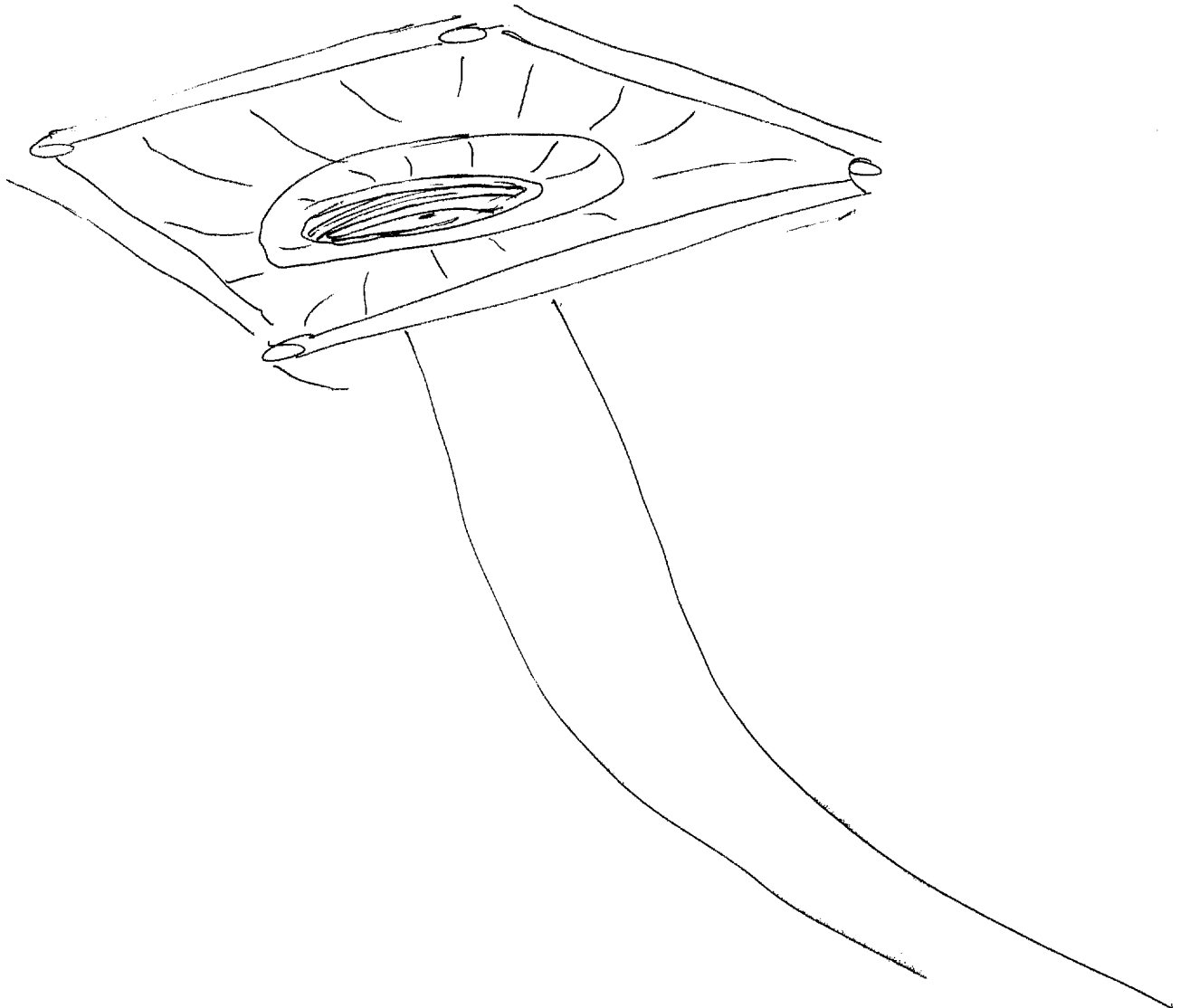

It tapers sharply on both sides and tapers out into flat sides or sections. The structure seems constructed of birch or some natural substance.

something rising high and dark beyond the structure - behind it.

mountains

structure is something central to surroundings - used perhaps nothing like a few hall like a city hall theater. something used outdoors frequently.

people.

STAGE 6

sz

Approved For Release 2001/03/07 : CIA-RDP96-00789R001300250001-0

I

8 A.
10/15

old,

derb.

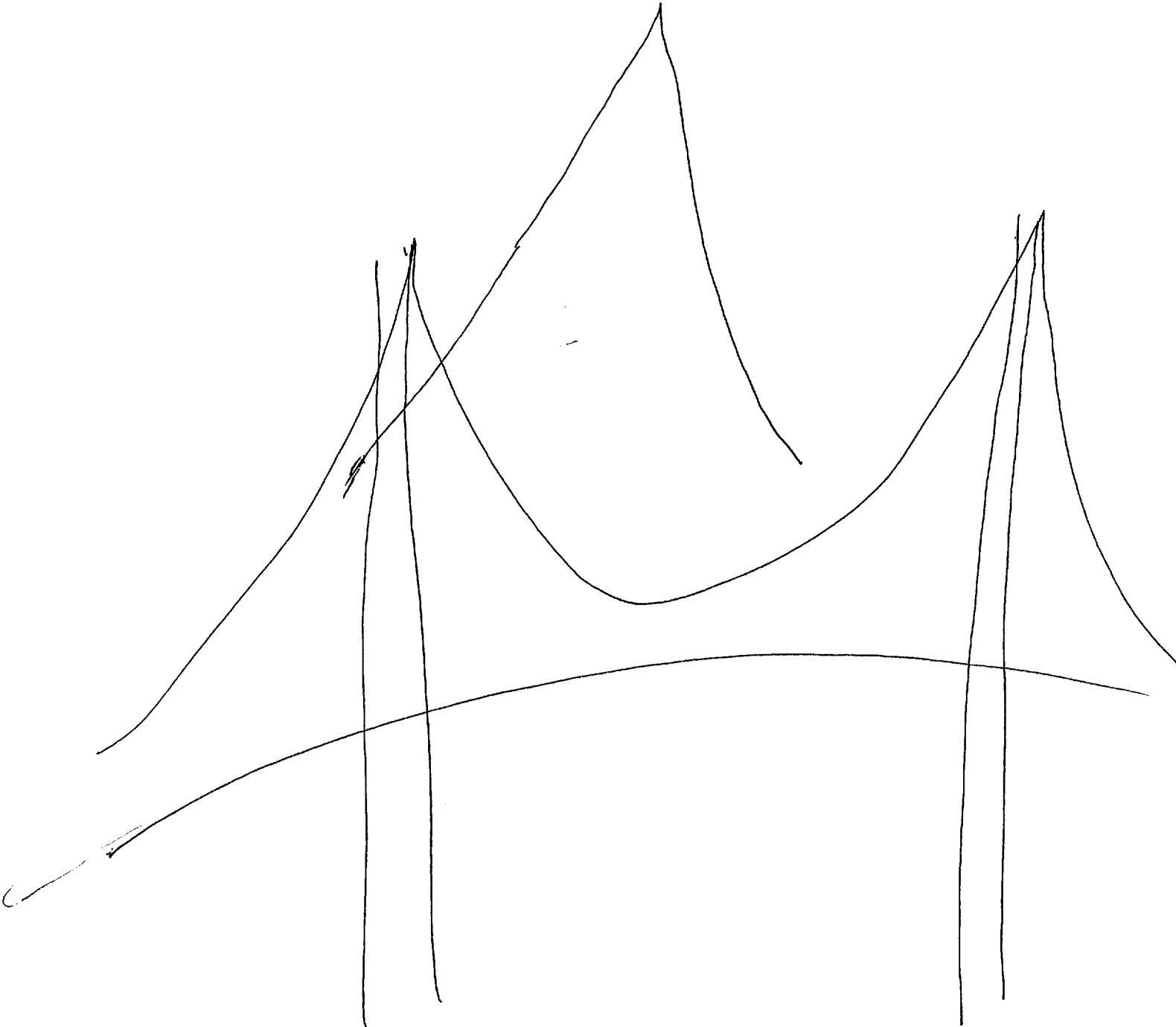

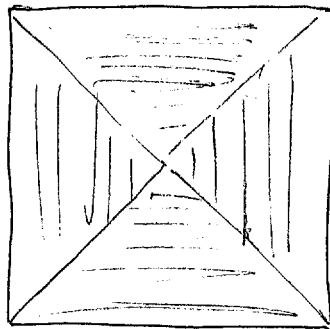

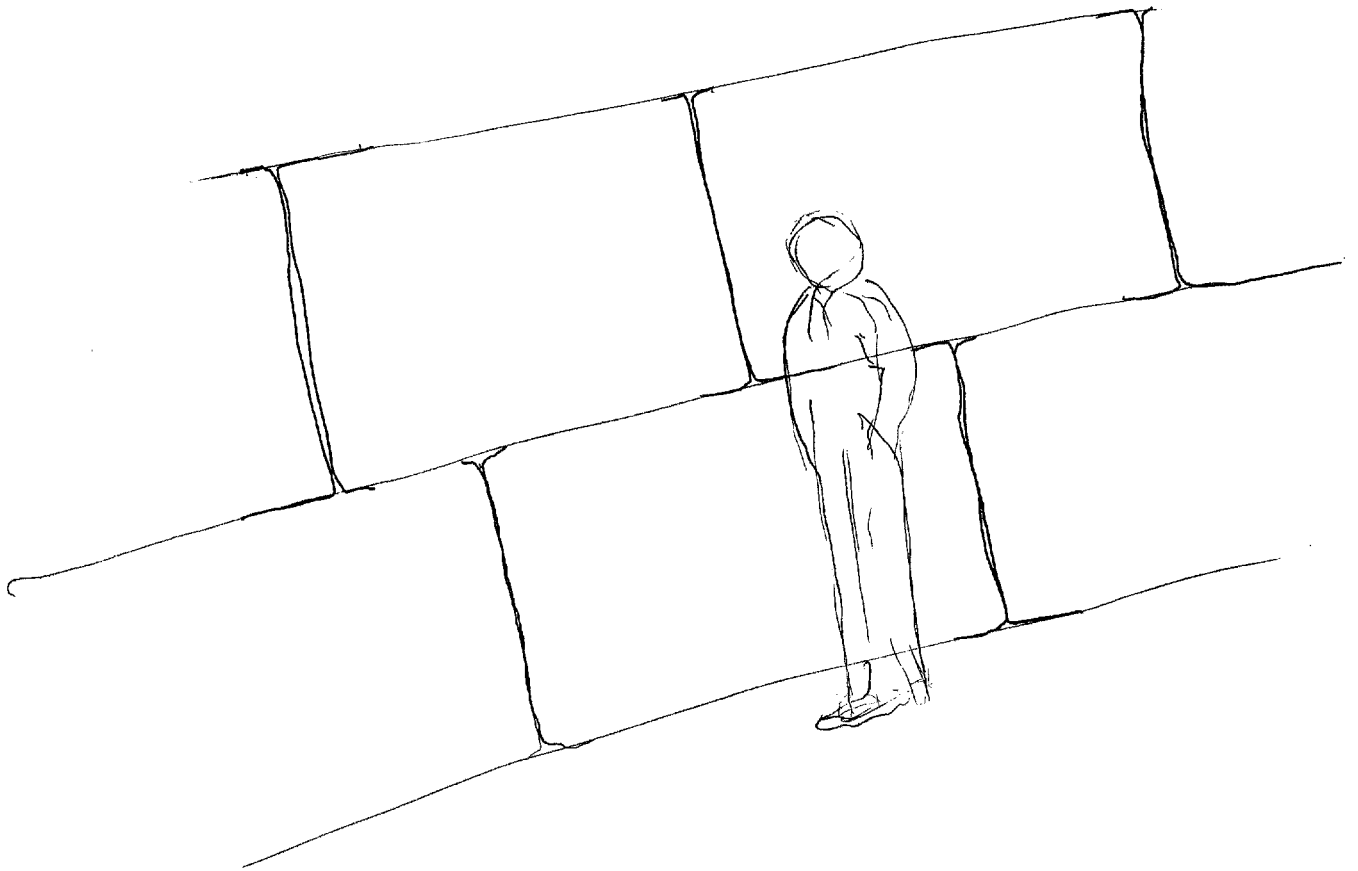

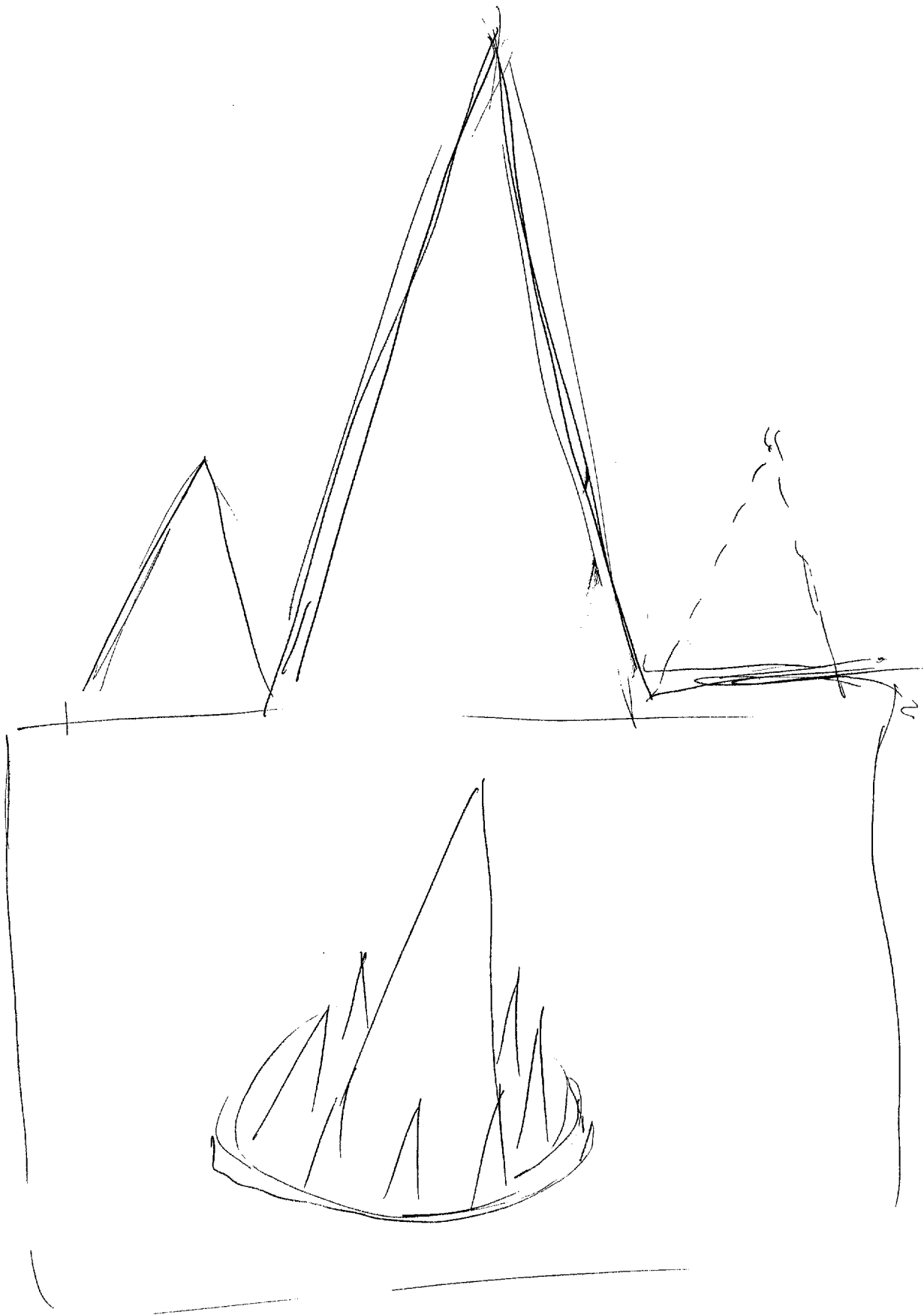

SZ

ROC/AS

[SITE]

TAN
RALF
ROBERT
COLD
PARCE
SOLD
HVE
HARD

Thick
dune
Hollow
180°
STARCHED
CUBES
CURVE
Vertical
diagonal

ORNATE
Adams.
GOTHIC
Historic
significant
Important
ARTISTIC
singular
Solo
solitaire

*WOL Signal
Sketch*

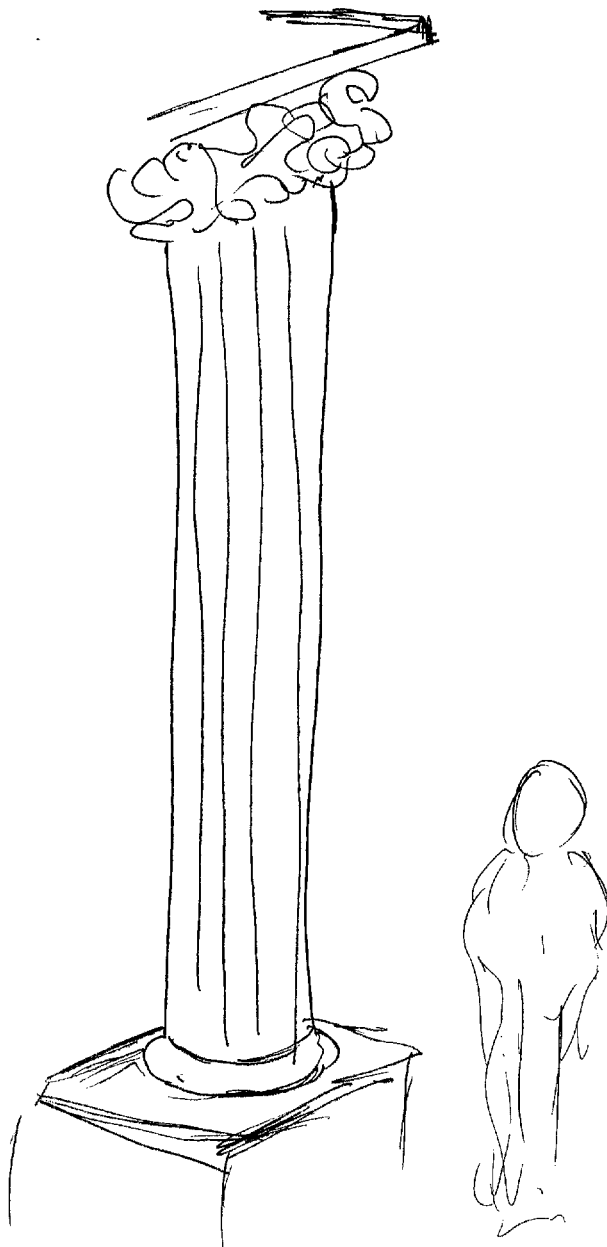

D

AI

EL

T

I

not/AS

st¹/₂ something art^{er}s about it full narrow
 portrayal of significant of somebody
 or something - meant to preserve
 the image, thought or idea.
 of person or event.

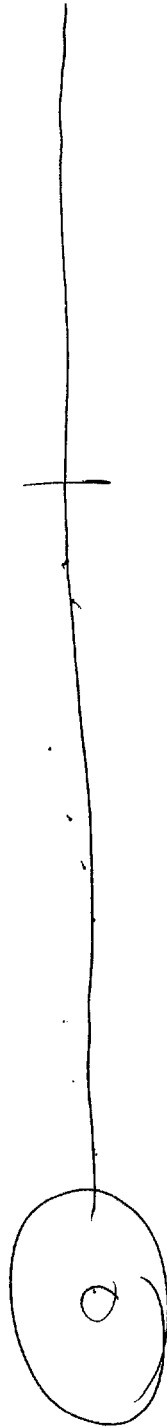

Time line

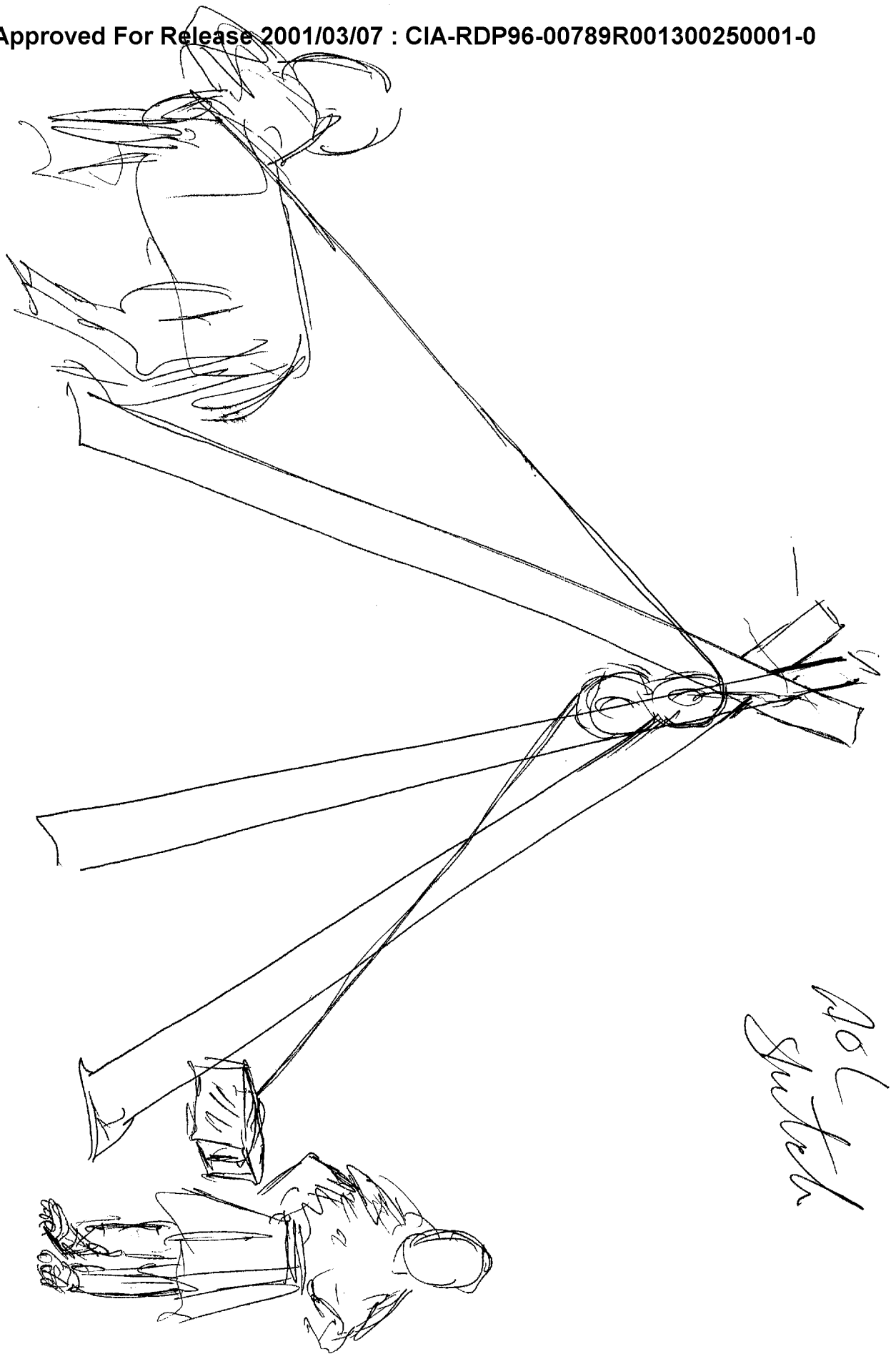

As L
Sutok

STAGE 6

SZ

D

AI

FI

T

I

AOL/AS

WAR
COMBAT

CIVIL WAR - AOL

SH¹/₂ Blue & Gray - him of men
being each other over open
terrain - Trenches - rolling
hills - Ramparts - emblems
smoke, fire, haze - 1800-1900

AOL - 3000
1800-1900

End
1/10

Is this some kind of war
memorial?

AOL SIGNAL
Switch

