

SG11

10/3/10 Jnl 86
Ed
FGGM

At domed structure
midway surrounding pool
with plan ceiling

70880
809908



Bush

This document is made available through the declassification efforts
and research of John Greenewald, Jr., creator of:

The Black Vault



The Black Vault is the largest online Freedom of Information Act (FOIA)
document clearinghouse in the world. The research efforts here are
responsible for the declassification of hundreds of thousands of pages
released by the U.S. Government & Military.

Discover the Truth at: <http://www.theblackvault.com>

5^r D AT EI T I ADL A/S

bluish-tinted glass

ADL - swimming pool

round

bubble-like

4" v- bright sunlight reflecting sun-glaring from a height.

pieces of stone

Red
Green
Blue

5² D AI EI T I AD A/S

Inside structure should be perceivable _____

A across
flat.
Other

B -

A across
flat.
Other

B -

A across
flat.
Other

B -

Antenna -
Almost like
intersecting
corridors

problem at the
entrance



5 ~~VI~~

5^r

D

AI

EI

T

I

AOL

AI S

guards in grey uniform
white patches on sleeve

historical display

exhibit of scientific /
technical photographs

under staircase

wide

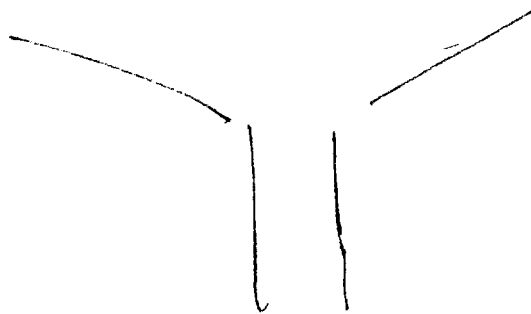

SVI

S²

D

AI

EI

T

I

AD-

AI/S

exhibit

satellite photography

rocket or launched

As per -
NASA

Chronological
progression of
advancements in
space technology
& phot-intell.

Capability
As per -
NPIC

Site is a building with a glass entrance,
has emblem (round with points As per like a
star) and guard personnel in grey
uniforms. The entrance contains a
display of photographs of scientific and
technical gear advancements in

Satellite photography. The building is more than one level as there is a center staircase that branches off in two directions.

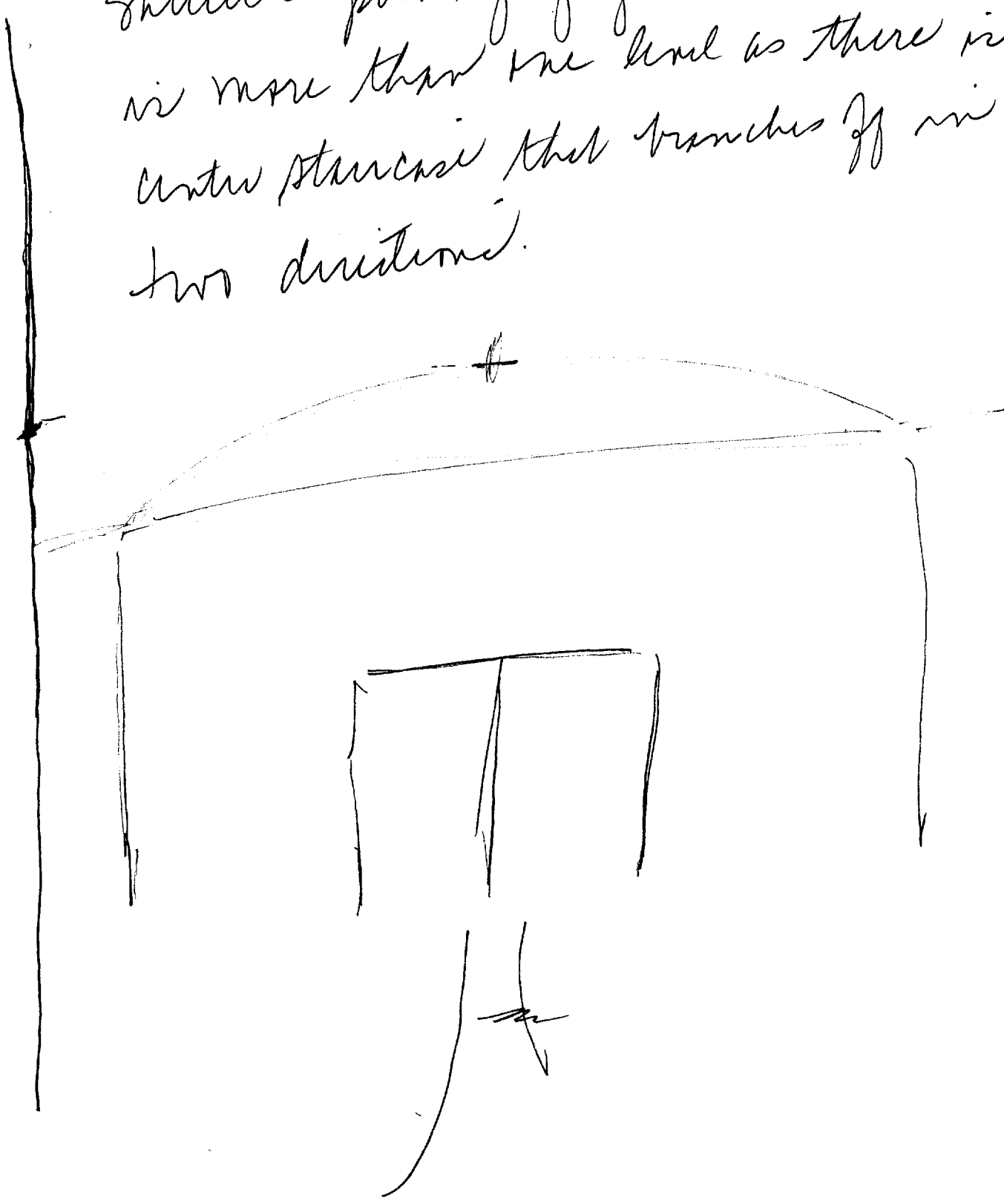

dark closed in feeling as a fresh-like a

There is something above the structure that
projected descending down the outside of
the building. It gives me a feeling of
being closed in but is dark. As I
moved horizontally from this point,
there is a perception of the open air
at approximately the center (AOI) like a
ventilation shaft.

1401