

TAVE

16 FEB 85
1335 HRS
FT. MEADE
(FREQ)

AOL BREAK -
VISUAL OF HALLWAY
WITH SOUND POORS.



A: RISING
~~FRONT~~
B: LAND

THIS CRITICAL
LOCATION IS
POSSIBLE



A: ACROSS
SAND OPA
ITEM
B: LAND

A: RISING
HOUND
HAND
B: LAND, HILL

SL: BLUE
WHITE
HAND WHITE

AOL BACK →
LIKE MARBLE.

POLISHED
HAND / POLISHED

AOL DRILL BR
LIKE MARBLE

AOL DRILL BK
MARBLE COLUMNS.

This document is made available through the declassification efforts
and research of John Greenewald, Jr., creator of:

The Black Vault



The Black Vault is the largest online Freedom of Information Act (FOIA)
document clearinghouse in the world. The research efforts here are
responsible for the declassification of hundreds of thousands of pages
released by the U.S. Government & Military.

Discover the Truth at: <http://www.theblackvault.com>

THE CRITICAL LOCATION



A: ACROSS UNDOWN

MISS BREAK

THE CRITICAL LOCATION

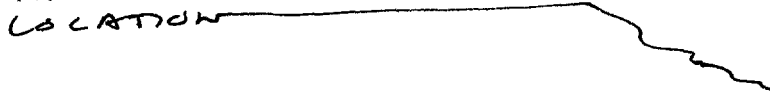

A: ACROSS FLAT HILL

B: _____

A: UNDOWN UNDOWN SMOOTH

B: _____

ACROSS SMOOTH LIKE POLISHED

THE CRITICAL LOCATION



A: DOWN UNDOWN HILL SMOOTH

B: HILL

THE CRITICAL LOCATION



A: FLAT ROUND DOWN HILL

B: HILL

525 HIGHER SORT OF HILL

COOL COLD CLEAR

3

~~SEE~~ PERCEPTION DIRECTION
TO FORM INTO A PICTURE
↓ WOULD THE IDEA OF
BEING ON TOP OF A
HILL.

THE CRITICAL
LOCATION 

A:

MISS BREAK
AND BREAK
AGAIN WITH TWO
COLUMNS, LIKE
CROSS COLUMNS.

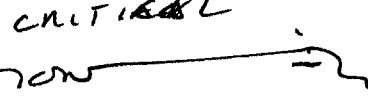
THE CRITICAL
LOCATION 

MISS BREAK.

THE CRITICAL
LOCATION 

A: HEAVY
WORK

B: 

S2: COOL
DARK
FRESH AIR
STARO AND
FRESH AIR
SMOOTH SMOOKS FUNNY,
QUIET
VERY QUIET.

AND BREAK
NOISY AT OTHER
TIMES.

THE CRITICAL
LOCATION

NOZ BREAK.
ROUND ON OUR
THINK - LADON
COLON.

WANTED TO MAKE
IT AN ASSESS OF
FABRICE SUB.

THE CRITICAL
LOCATION

MISS BREAK.

THE CRITICAL
LOCATION

MISS BREAK.

THE CRITICAL
LOCATION

A: ~~PLAT~~
DND
SHEETA

B: _____
D: ~~REJND~~
HND
SHEETA

B: ~~STRUCTURE~~ AS L BK.
I WANT TO MAKE
STRUCTURE "BAT"

(5)

1 FOOT LIKE THE PLACE IS A TOWN OF
SOME KIND - NOT A CITY BUT SMALLER - IN
AN ARABIC REGION - WITH BLDGS & GROUND MADE
FROM SOME MATERIAL - LIKE ADAMITE - ARID
PLACE - LACK OF VEGETATION. LIKE DESERT
TOWNS.

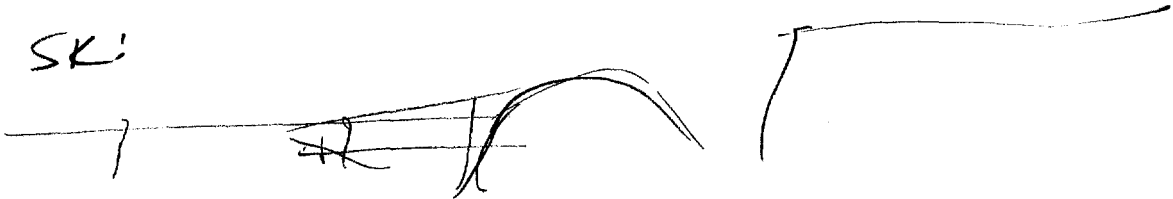

SK:

NO HIGH BLDGS - NO TOWNS,
LIKE WOULD BE ARABIC, BUT NOT, SPECIAL



BLDG

TOWN SURROUNDING LAND, BUT NOT
MUCH.



CRITICAL PART IN THE TOWN IS
A PLACE W/ POLISHED TILES, OLD
BLOCK - NOT FANCY. TILED AREA DOES NOT
FIT STYLE OF THE REST OF THE BLOCK.
SEEMS LIKE AN ADDITION OF A TWO
STORY BLOCK BUT NOT.

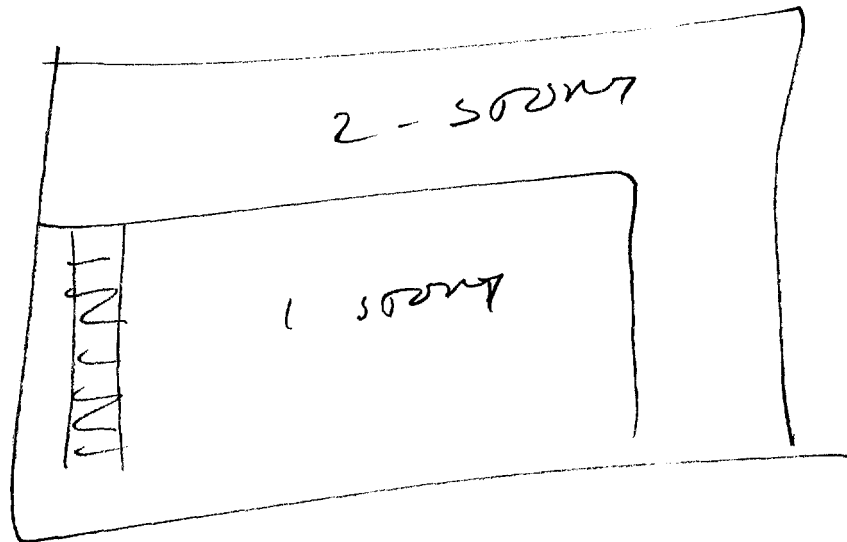
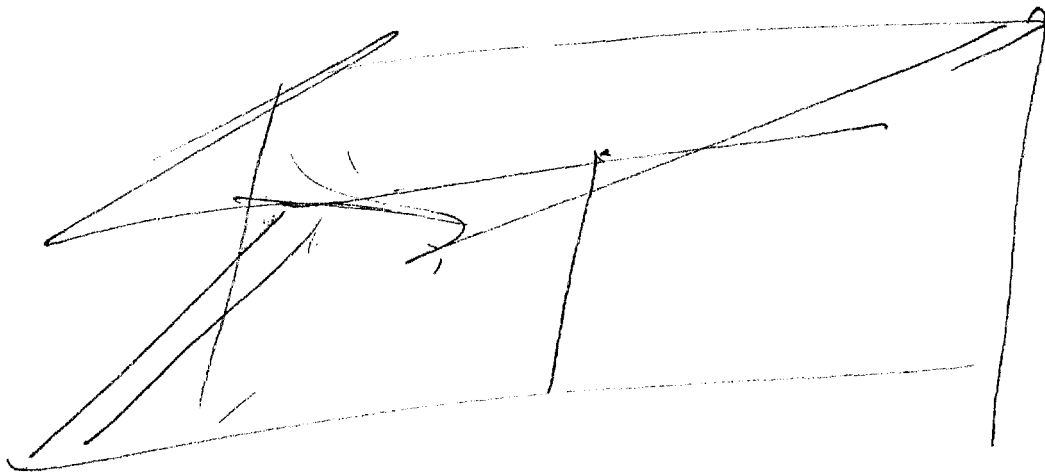

2

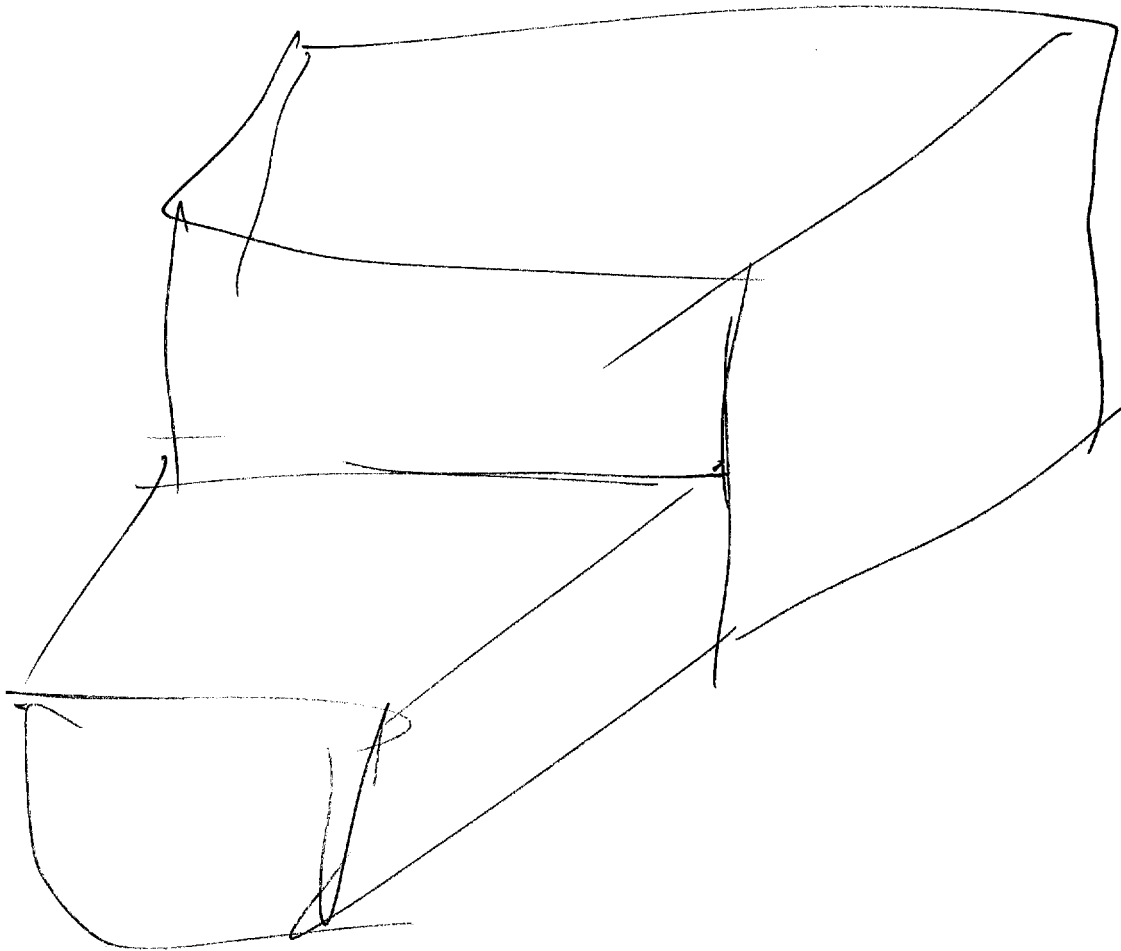

SIDE FEELS LIKE ONE STORY
PORTION OF WALL ATTACHED TO A 2-STORY
PORTION " " " "

8

2-500M PART IS MOST IMPORTANT.
 WAS A MAN SITTING IN UPPER
 PART. - FEELING OF RECENT SIGHT
 OF BADEL, AS YOU PASS THE
 FRONT. SINGLE ROOM - LEANS INTO
 ANOTHER ROOM, BUT ALSO HAS OUTSIDE DOOR.

MAN HAS ENGLISH FEATURES - IS
 JUST SITTING - DOING NOTHING. THINKING
 NOTHING AWAKE.

HE LOOKS OLD. TIRED, HURTS -
 MAYBE LEFT SIDE OF FACE, MAYBE KID.
 HEARD IS OK. THINKING OF WIFE.

9

FLASH OF WOUND + TWO OTHER MEN IN
ANOTHER PART OF BLDG NOT IN SAME
CIRCUMSTANCE.

BLDG HAS MANY ENTRANCES - PEOPLE
LIVE THERE, BUT ITS NOT A HOME. NOT
A WORK PLACE, LIBRARY, DOWNSTAIRS MAY
BE. NOT A MAIN PLACE, BUT A
SUBSIDIARY. LIKE AN OUTPOST.

BLDG IS LIKE LOT'S OF STAIRS
AROUND IT. ADDS ON STAIR BLDG,
OLD, BASICALLY SAME ST. SOMETHING IS
ROUND. A BLDG ON LIKE AN ~~ADDS~~
DOWN - SHARPOO DOWN ROBOT WITH BLDG.
DRY, CLEAR, WEATHER.

I KEEP TRYING TO MAKE THIS MAP, BUT
IT WNT. MORE LIKE LITTLE DOESNT TOWN
IN N.M. ON MEXICO. THAT STYLE.

10

VISUAL OF LADEN ROOF NEARBY.
MAY BE THIS BLDG. WHITE WALLS.
TILES.

SITE END.